



Item #1001 492 715
Model #HD28928

Use and Care Guide

LOW VOLTAGE FLOODLIGHT KIT

Please read and save these instructions

PACKAGE CONTENTS

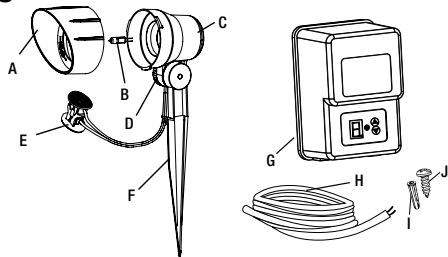

Part	Description	Quantity	H	Wire AWG16 SPT2W 50'	1
A	Lens cover	4	I	Plastic anchor	1
B	20W Halogen T3 Bi-Pin Bulb	4	J	Screw	1
C	Body	4			
D	Adjustment screw	4			
E	Connector	4			
F	Spike	4			
G	120W Transformer	1			

Assembly and Installation

INSTRUCTIONS PERTAINING TO A RISK OF FIRE, OR INJURY TO PERSONS
IMPORTANT SAFETY INSTRUCTIONS
Lighted lamp is HOT!

CAUTION: Safe for outdoor operation

WARNING: To reduce the risk of FIRE OR INJURY TO PERSONS:

WARNING: Turn off/unplug and allow to cool before replacing lamp.

WARNING: Lamp gets HOT quickly! Contact only switch/plug when turning on. Do not touch hot lens, guard or enclosure.

WARNING: Keep the lamp away from materials that may burn.

WARNING: Do not touch the lamp at any time. Use a soft cloth. Oil from skin may damage the lamp.

WARNING: Do not operate the luminaire fitting with a missing or damaged lens or bulb protector.

WARNING: Install in accordance with all local codes and ordinances.

Only for use with low voltage power units with a maximum output rating of 15V, 300W per secondary.

FOR LANDSCAPE LIGHTING SYSTEMS ONLY. OUTDOOR USE ONLY. THE DEVICE IS ACCEPTED AS A COMPONENT OF A LANDSCAPE LIGHTING SYSTEM WHERE THE SUITABILITY OF THE COMBINATION SHALL BE DETERMINED BY CSA OR LOCAL INSPECTION AUTHORITIES HAVING JURISDICTION.

UL LISTED UNDER MODEL # U201166

1 Attaching and installing the floodlight

WARNING: Never push the fixture into the ground by the lamp body (C) or use a hammer to insert the spike (F) into the ground.

- Carefully remove the fixture from its protective packaging.
- Remove the lens cover (A) by turning counterclockwise.
- Do not remove the lens from the lens cover.
- Insert the bulb (B) into the bulb socket. Use a soft cloth, as oil from skin may damage the lamp bulb.
- Replace the lens cover (A) on the body (C) by turning clockwise.
- Adjust the fixture's angle by loosening the adjustment screw (D) and retightening it.
- Ensure the lens points up and never towards the ground.

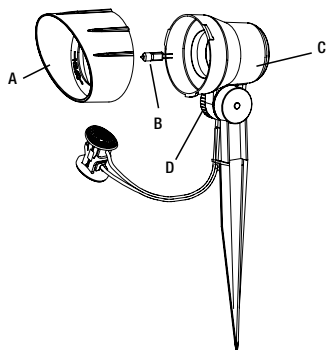

2 Connecting the wires

WARNING: The wire connector (E) contacts have sharp edges for piercing the main low voltage cable. To avoid injury, do not touch the metal contacts.

WARNING: Risk of Electric Shock. Install all luminaires 10 ft. (3.05 m) or more from a pool, spa or fountain.

CAUTION: The wire from the low voltage power unit shall be 12-16 AWG type underground low Energy Circuit Cable or SPT2W.

IMPORTANT:

- Protect the wiring by routing it in close proximity to the light fitting, or next to a building structure such as a house or deck.
- The landscape wire and connector can also be hidden under stone or buried under grass at a maximum depth of 6" (15.24 cm).
- Do not submerge fixture in water.

- Place the wire connector (E) on opposite sides of the low voltage cable (H) where the fixture will be located.
- Align and fit the main low voltage cable (H) vertically to the slot of wire connector (E) as shown.
- Press the wire connector (E) together until fully seated and locked around the cable (H). Pre-set prongs will pierce the cable insulation and establish contact. Turn on the power unit. If the light fixture does not turn on, repeat previous steps.
- Once the clip-on connector (E) is in place, wrap it with electrical tape for additional protection.
- CAUTION BE CAREFUL! THE WIRE STABS ARE VERY SHARP!
- After all fixtures are installed, turn on the transformer.

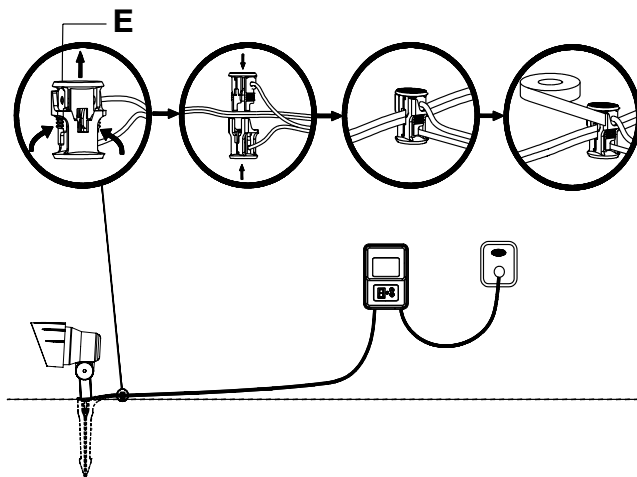

Assembly and Installation (Continued)

4 Installing the transformer

- This transformer is weatherproof and suitable for outdoor use.
- Install the transformer (G) at a level where the controls are visible and accessible.
- Do not install behind shrubs. It will affect the photocell.
- Photocell will not operate properly if installed too close to a nighttime light source.
- **MOUNT AT LEAST 12 INCHES (30CM) ABOVE GROUND**

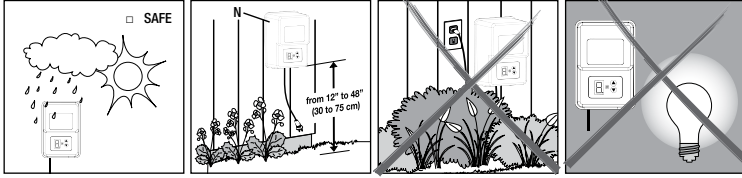

5 Connecting the cable to the transformer

- Remove the landscape wire (H) insulation 1/2 in. from both wires and twist ends.
- Insert wires under each terminal plate on the transformer (G) and tighten screws.
- Gently pull on the landscape wire to verify if the connection is strong.
- Verify that there are no loose cable strands.

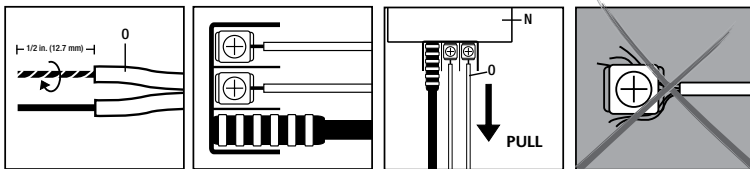

6 How to operate the transformer controls

PHOTOCELL

This component reacts to light conditions. It should not have direct contact with any other light sources. A 30 second delay may be experienced when light conditions change. To test the system during day time, simply cover the photocell with black tape.

DIGITAL TIMER CONTROLS

Use the UP and DOWN control buttons to select from the following settings:

- Power:** Whenever the is present, there is power on the low voltage side of the transformer.
- Constant power ON:** This switches the system on 24 hours a day.
- AUTO:** This switches the system on at dusk and off at dawn, automatically.
- AUTO TIMER:** This switches the system on at dusk and off after the selected number of hours.
- Flashing L Minor Overload:** The load on the transformer exceeds its capacity. Reduce the load by removing fixtures from the low voltage line. Failure to do so will reduce the lifetime of the transformer.

DISPLAY OFF - MAJOR OVERLOAD OR SHORT CIRCUIT

If the display is off and that the utility voltage is still present the transformer is majorly overloaded. The major overload feature will shut off the low voltage output of the power unit, if the circuit is overloaded with too many fixtures. This will result when the total wattage of all lights of the system exceeds 120 Watts. The major overload shut off will also happen if there is a short circuit in your garden lighting system. A short circuit can occur if the secondary cable connecting the fixtures to the power supply is cut or if the exposed ends touch a metal post or water. After you have determined and solved the problem, you can restart the operation by pressing the button. If the display is off and that the utility voltage is still present the transformer is majorly overloaded.



WARNING: To reduce the risk of FIRE OR INJURY TO PERSONS:



WARNING: Do not install within 10 ft. (3 m) of a pool, spa or fountain.



WARNING: There are no serviceable parts inside the power supply unit. DO NOT DISASSEMBLE.



WARNING: Do not submerge the transformer.



WARNING: Do not connect two or more transformers in parallel.



WARNING: Plug the power supply unit directly into a GFCI outlet that is marked "wet location".



WARNING: The maximum output of this transformer is 120 watts. Do not overload the transformer. Be sure that the total cumulative wattage of all 12 volt fixtures connected to the transformer is equal to or less than 120 watts.



WARNING: This garden light system must be installed in accordance with all local codes and ordinances. If you are experiencing problems, contact a qualified electrician.



WARNING: For use with 12 volt low voltage outdoor landscape lighting system only. Not for use with submersible light or pool/spa equipment.



WARNING: Do not use with a dimmer.



WARNING: Do not use an extension cord.

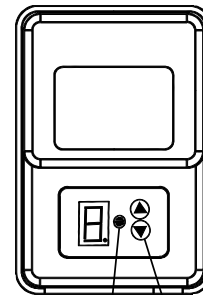

Photocell Digital timer controls

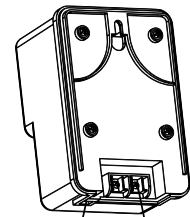

12V Output terminals
Input power cord

Care and Cleaning

- Clean the fixture with a soft, dry cloth.
- Do not use any cleaners with chemicals, solvents or harsh abrasives.

Troubleshooting

Problem	Possible cause	Solution
The fixture will not light	<ul style="list-style-type: none"> • There is no power. • There is a disconnection or break in the wire. • The transformer setting is incorrect. 	<ul style="list-style-type: none"> • Check that the power is on. • Check if there is a loose connection at the transformer screw terminal. • Check that the power switch is not in the OFF setting.
Only some lights work	<ul style="list-style-type: none"> • The problem here is with the fixture's connector or light bulb. 	<ul style="list-style-type: none"> • Check the connector to make sure the wire stabs have pierced the landscape wire. • To check a light bulb, exchange it with one from a fixture that is working (remember to be careful, as the bulbs can get very hot – also touch bulbs with a soft cloth only).

Warranty

WHAT IS COVERED

The manufacturer warrants this lighting fixture to be free from defects in materials and workmanship for a period of two (2) years from the date of purchase. This warranty applies only to the original consumer and only to products used in normal use and service. If this product is found to be defective, the manufacturer's only obligation, and your exclusive remedy, is the repair or replacement of the product at the manufacturer's discretion, provided that the product has not been damaged through misuse, abuse, accident, modifications, alterations, neglect or mishandling.

WHAT IS NOT COVERED

This warranty shall not apply to any product that is found to have been improperly installed, set-up, or used in any way not in accordance with the instructions supplied with the product. This warranty shall not apply to a failure of the product as a result of an accident, misuse, abuse, negligence, alteration or faulty installation, or any other failure not relating to faulty material or workmanship. This warranty shall not apply to the finish on any portion of the product, such as surface and/or weathering, as this is considered normal wear and tear.

The manufacturer does not warrant and specially disclaims any warranty, whether express or implied, of fitness for a particular purpose, other than the warranty contained herein. The manufacturer specifically disclaims any liability and shall not be liable for any consequential or incidental loss or damage, including but not limited to any labor / expense costs involved in the replacement or repair of said product.

Contact the Customer Service Team at 1-855-HD-HAMPTON or visit www.hamptonbay.com.

Cable Selection

12 VOLT TAP	Cable Length			
	Total Fixture Wattage	0-50 feet	51-100 feet	101-150 feet
0-60 Watts	16 AWG	16 AWG	14 AWG	
61-120 Watts	16 AWG	14 AWG	12 AWG	
121-180 Watts	14 AWG	12 AWG	NOT RECOMMENDED	
181-240 Watts	14 AWG	12 AWG	NOT RECOMMENDED	
241-300 Watts	12 AWG	NOT RECOMMENDED	NOT RECOMMENDED	
600W Transformer = (2X300) Watts	12 AWG	NOT RECOMMENDED	NOT RECOMMENDED	
900W Transformer = (3X300) Watts	12 AWG	NOT RECOMMENDED	NOT RECOMMENDED	

15 VOLT TAP	Cable Length			
	Total Fixture Wattage	0-50 feet	51-100 feet	101-150 feet
0-60 Watts	16 AWG*	16 AWG	16 AWG	
61-120 Watts	16 AWG*	16 AWG	12 AWG	
121-180 Watts	14 AWG*	14 AWG	12 AWG	
181-240 Watts	14 AWG*	14 AWG	12 AWG	
241-300 Watts	12 AWG*	12 AWG	NOT RECOMMENDED	
600W Transformer = (2X300) Watts	12 AWG*	12 AWG	NOT RECOMMENDED	
900W Transformer = (3X300) Watts	12 AWG*	12 AWG	NOT RECOMMENDED	

* NOT RECOMMENDED FOR HALOGEN LANDSCAPE LIGHTS

This data is provided as a general guideline. Actual performance will depend on the installation layout, the fixtures, and the condition of the cable. NOTE: Most LED landscape lighting fixtures can operate with full illumination from 9V down to as little as 6V. It is possible to have extended length runs with LED fixtures that go beyond the specifications shown in the guidelines above. Additional landscape lighting cable can be purchased at your local Home Depot store.