



EVAPORATIVE AIR COOLER

MODEL: SF-6 N25



INSTRUCTION MANUAL

Thank you for your purchase. Before using this product, please read this manual carefully and keep it for future reference.

Introduction

This is an air cooler with an attractive and luxurious appearance, unique features and easy operation. You could feel the cool wind of the air cooler during hot days. Enjoy using this air cooler in your home or office.

Working Elements

The Air Cooler absorbs warm air from the surrounding and converts it to cool air through the process of water evaporation (driven from the water pump to the cooling pads) and blown back to the surrounding by the air blower.

READ AND SAVE THESE INSTRUCTIONS

1. Make sure this appliance and the power cord has no physical damage before operating the unit. Please consult the authorized service center when in doubt.
2. Do not touch the power cord or plug with wet hands.
3. Do not touch the water in the tank when the unit is plugged into the electrical outlet.
4. Do not insert any object into the grille guard or spray liquid into openings to avoid damaging this appliance.
5. Unplug the unit when it is not in operation and before cleaning or moving.
6. Do not pull the plug while the power is on. Always ensure that the plug is fully inserted into the electrical outlet before operating it.
7. Do not remove the water tank when the unit is plugged in.
8. Do not add any chemical, metal ingredient into the water tank as these materials may damage the unit.
9. A safety water level switch will automatically shut off the ultrasonic transducer when water in the tank is below the minimum level. Please add water as needed.
10. This appliance must be used under the rated voltage and frequency as indicated in the rating label.
11. Do not disassemble, repair or modify this appliance on your own. Warranty will be void if repair is carried out by an unauthorized service center.
12. If the power cord is damaged, it must be replaced by the manufacturer or its service agent to avoid electrical hazard.
13. This appliance is not intended to be operated by persons (including children) with reduced physical, sensory or mental capabilities or lack of experience and knowledge unless they have been given supervision or instruction concerning the use of the appliance by a person responsible for their

safety.

14. Do not operate any fan with a damaged cord or plug. Discard fan or return to an authorized service facility for examination and/or repair.
15. Do not run cord under carpeting. Do not cover cord with throw rugs, runners, or similar coverings. Do not route cord under furniture or appliances. Arrange cord away from traffic area and where it will not be tripped over.

WARNING – To reduce the risk of fire or electric shock, do not use this fan with any Solid-state speed control device.

How to assemble the air cooler

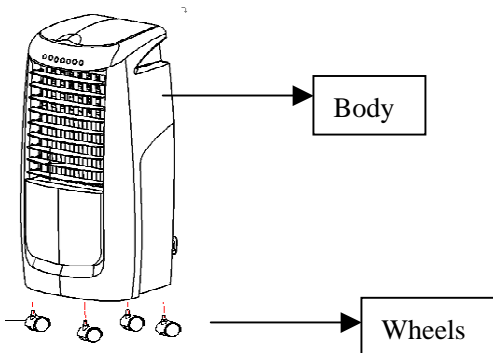

Position air cooler on a level floor, insert the wheels into the holes positioned on the bottom of the unit.

Parts Identification and Technical Specification

Model	SF-6N25
Voltage	120V
Frequency	60Hz
Power	65W
Water Tank	8.0L
Evaporation capacity:	550ML/H

Filling the Tank with water

Place the air cooler on a level ground and follow the steps below:

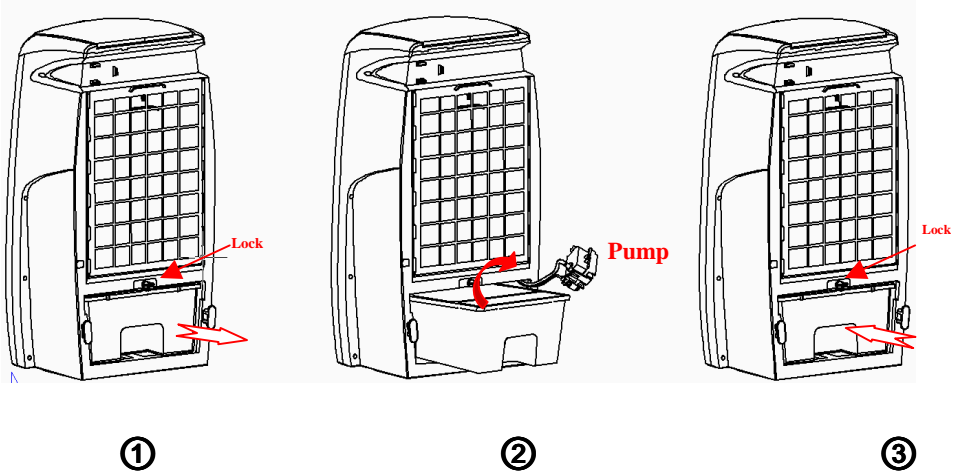

1. Rotate the water tank lock to horizontal position then pull out the water tank;

Picture ①

2. Raise the water pump frame when the water tank is pulled out around 3/4 way, then remove the tank completely to fill or when cleaning; Picture ②.

3. Fill the tank with clean water

4. Re-install the water tank and the water pump frame and push the tank into position;

5. Lock the water tank in place. Pic. ③

Operating the air cooler

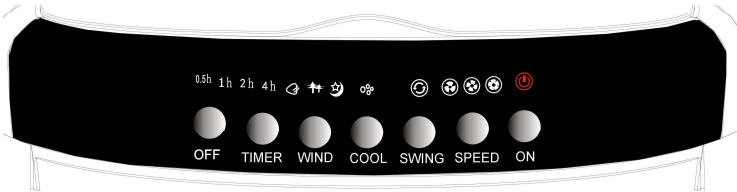

1. Insert plug into the electrical outlet and the power indicator will illuminate. Unit is now in standby mode.
2. **“ON”** button: Press to turn unit on. Fan operates in default “normal” mode.
3. **“WIND”** button: Press to select wind type.
“Normal”: Wind blows based on Low/Med/High speed.
“Natural”: Imitates the blow of natural wind based on strong and soft wind.
“Sleeping”: The first thirty minutes blows as strong and soft natural wind and becomes mid natural wind. The second thirty minutes it changes to soft natural wind.
4. **“SWING”** button: Press to active left-to-right oscillation. Press this button again to stop this function.
5. **“SPEED”** button: Press to select fan speed (Low-Mid-High), corresponding indicator light will illuminate.
6. **“COOL”** button: Press to turn on Evaporative Cooling function (the water pump starts running). The water circulates onto the cooling pad to allow warm air to be converted to cool air (warm air combined with water vapor).
Note: When there is not enough water in the tank, the cooling function will automatically shut off and the indicator will flash. Please turn off this function or add water. Once water is added, indicator will go off and cooling function will automatically resume.
7. **“TIMER”** button: Sets timer-off in increment of 0.5 hours. Timer can be set between 0.5 - 7.5 hours. Adding the numbers indicated equals the total time-off timer. For example, when the 0.5 and 1 indicators are illuminated, the timer has been set for 1.5 hours; when all indicators are lit (0.5, 1, 2 and 4), the timer has been set for 7.5 hours.
8. **“OFF”** button: Press and all functions turn off.
9. Remote control has the same functions as the control panel, for the exception that ON/OFF is one button (press once to turn on, press again to turn off). Remote must be aimed directly at the unit to function properly. If the remote control does not function properly, please check the battery condition.

Cleaning and Maintenance

1. Turn unit off and disconnect power.
2. Please clean the water tank and filter mesh every two weeks.
3. Please clean the cooling pad when it is visibly dirty or once a month (depending on the conditions of the surrounding area) to avoid build-up of dirt which may emit a foul odor and decrease efficiency.
4. Use a dry cloth to absorb remaining water on the atomizing cup, and dry it using a piece of soft cloth.
5. Pack this appliance properly and store it in a cool dry place if it is not to be used for a long period of time.

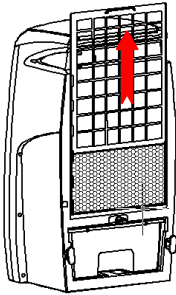

④

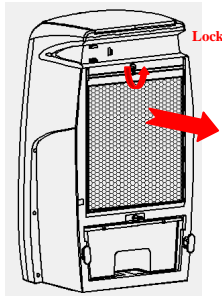

⑤

Cleaning:

1. Remove the plastic filter mesh by pulling upwards. Pic. ④
2. Rotate the lock to horizontal position and remove honeycomb pad. Pic. ⑤
3. Wash the plastic filter mesh in a mild detergent and warm water solution. Rinse with clean water.
4. Wash the honeycomb pad with clean water only. A soft brush may be used for cleaning.
5. Clean the water tank and remove residue build-up on the tank.



Your Guarantee

If this product is found to be faulty as a result of faulty materials or workmanship within one year from date of purchase, it will be repaired free of charge.

This guarantee is subject to the following terms:

- Sunpentown must be notified of the fault.
- Proof of purchase must be presented to Sunpentown's nominated representative.
- The warranty will be void if the product is modified, misused or repaired by an unauthorized person.
- The warranty after repair will not be extended beyond the original one-year period.
- All replacement parts will be new or reconditioned.
- Parts, which are replaced, become the property of Sunpentown.
- The warranty applies for the use of the product in the USA only.

What is NOT COVERED:

- Warranty does not include freight charges.
- Incidental or consequential damage caused by possible defects with this product.
- Damage to product caused by improper power supply voltage, accident, fire, floods or acts of nature.
- Failure of product resulting from unauthorized modifications to the product.
- Improper installation or failure to perform the necessary maintenance.

This GUARANTEE is in addition to your Statutory Rights

SUNPENTOWN INTERNATIONAL INC.

14625 Clark Ave, City of Industry, CA 91745

Tel: 800-330-0388

service@sunpentown.com

www.spt-usa.com