



Item #658484

Model #ALH19892K01

## USE AND CARE GUIDE

---

### NILES PARK LED LIGHTED DINING TABLE

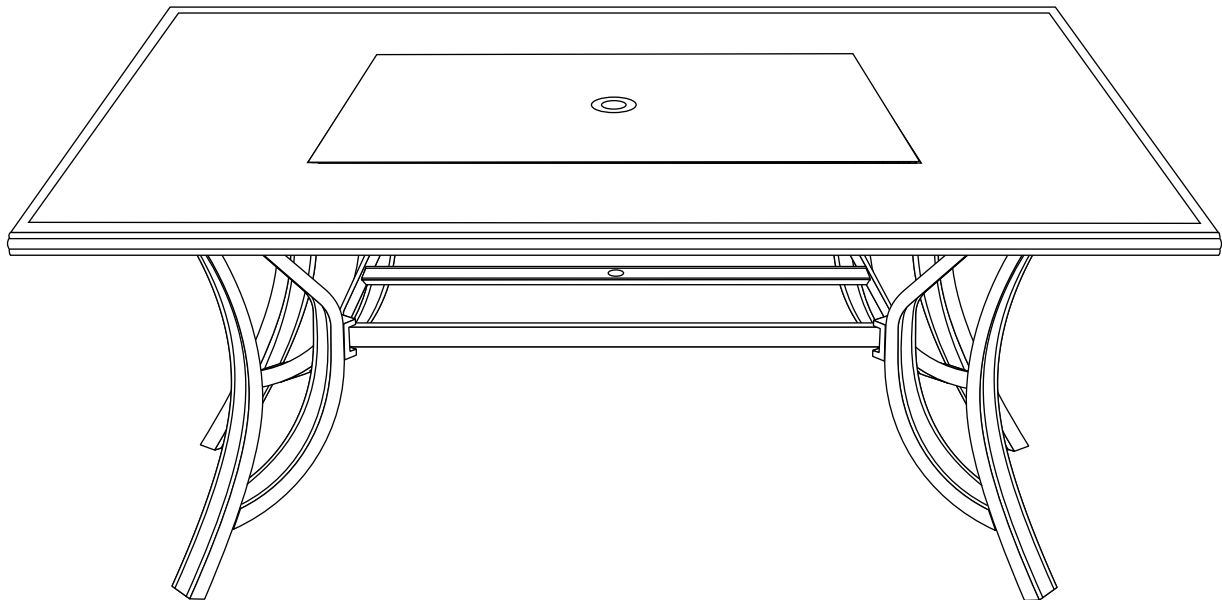

Questions, problems, missing parts? Before returning to the store,  
call Hampton Bay Customer Service  
8 a.m. - 6 p.m., EST, Monday - Friday

**1-855-HD-HAMPTON**

**HAMPTONBAY.COM**

---

#### **THANK YOU**

*We appreciate the trust and confidence you have placed in Hampton Bay through the purchase of this table.*

*We strive to continually create quality products designed to enhance your home.*

*Visit us online to see our full line of products available for your home improvement needs.*

*Thank you for choosing Hampton Bay!*

# Table of Contents

---

Table of Contents.....	2	Assembly.....	5
Warranty .....	2	Maintenance .....	6
What is Covered .....	2	Care and Cleaning .....	6
What is Not Covered .....	2		
Pre-Assembly .....	3		
Planning Assembly.....	3		
Hardware Included.....	3		
Package Contents.....	4		

# Warranty

---

## 3 Year Frame Limited Warranty

### What is Covered

We warrant the frame to be free of manufacturing defects to the original purchaser for three years.

### What is Not Covered

It remains the customer's responsibility for freight and packaging charges to and from our service center. This warranty does not cover commercial use, hardware, acts of nature, fire, freezing and abusive use. In addition, purchased parts are not covered under this warranty. We reserve the right to make substitutions with similar merchandise, if the model in question is no longer in production.

Contact Customer Care at 1-855-HD-HAMPTON or visit [www.HamptonBay.com](http://www.HamptonBay.com).

# Pre-Assembly

## PLANNING ASSEMBLY

Identify all parts packed in the carton against the parts list. Remove all protective materials. Place parts on a non-abrasive surface to avoid scratching. If you are missing any parts or are unsure how to proceed with the assembly, call our Customer Service Team at 1-855-HD-HAMPTON. Do not attempt assembly if any parts are missing or damaged.

Two people may be required to assemble the table.

Damage to welds or frames resulting from over tightened bolts or improper assembly is not covered under our warranty. Please read all instructions carefully before assembly. If you have any questions regarding your assembly, call our Customer Service Team at 1-855-HD-HAMPTON.

## HARDWARE INCLUDED



NOTE: Hardware not shown to actual size.

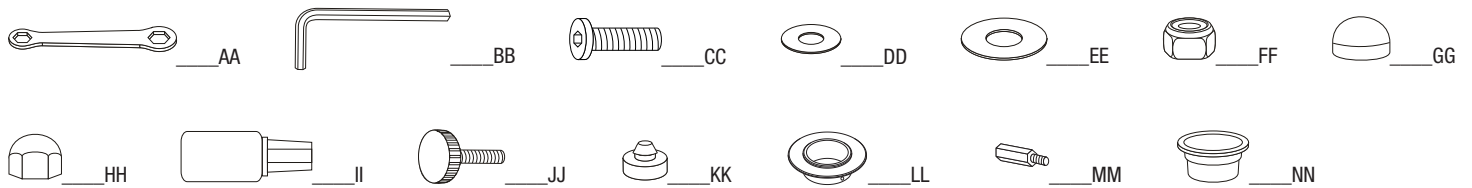

Part	Description	Order Part #	Quantity
AA	Hex Wrench	HW0009	1
BB	Hex Bolt Driver	HW0006	1
CC	1/4 in. x 40 mm Bolt	HW0086	4
DD	Ø6.5 x 1.0 mm Washer	HW0004	8
EE	Ø26 x Ø6.5 x 2.0 mm Washer	HW0594	4
FF	1/4 in. Nut	HW0014	8
GG	Bolt Cover	HW0105	4
HH	Nut Cover	HW0027	8
II	Touch-up Paint	G0003	1
JJ	Foot Cap (Preassembled)	FC0614	4
KK	Table Bumper (Preassembled)	G0199	10
LL	Umbrella Hole Protective Ring-1 (Preassembled)	G0330	1
MM	Umbrella Ring Bolt (Preassembled)	G0331	1
NN	Umbrella Hole Protective Ring-2 (Preassembled)	G0157	1

# Pre-Assembly (continued)

## PACKAGE CONTENTS

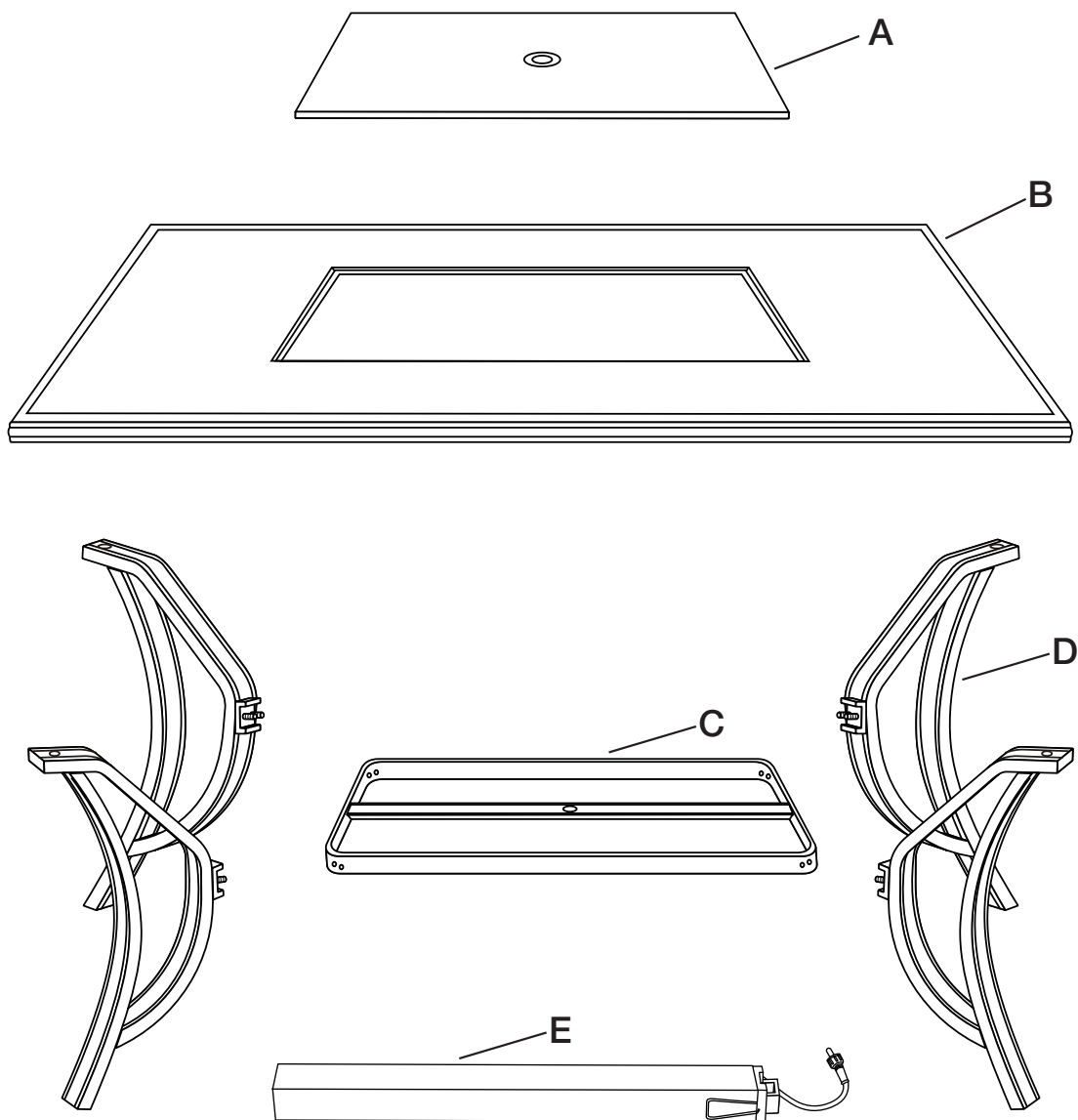

Part	Description	Order Part #	Quantity
A	Glass Top		1
B	Table Rim with Natural Stone	AT71913	1
C	Leg Connector Bracket	AT71914	1
D	Table Leg	AT71915	4
E	Batteries Box	AT71916	1

# Assembly

## 1 Attaching the table legs

- Place the tabletop (B) up-side down on a flat, solid surface.
- Attach a table leg (D) to the tabletop (B) using the bolts (CC) and washers (EE) as shown in the diagram.
- Guide the bolts (CC) through the holes in the table leg corner bracket and into the pre-drilled hole in the tabletop (B).
- Hand tighten three to four turns only. (Do not tighten completely.)
- Repeat for the other three legs.

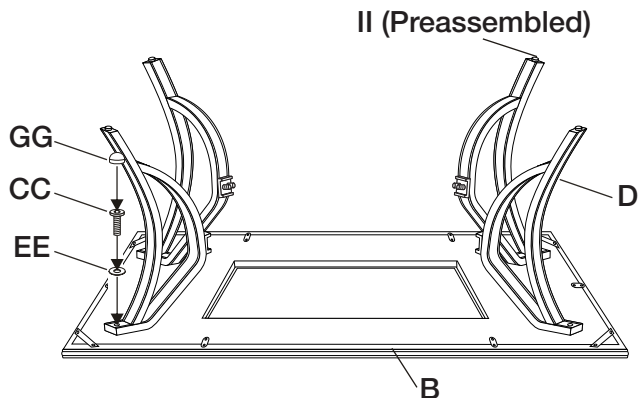

## 2 Attaching the leg connector bracket

- Add a leg (D) to the leg connector bracket (C) by guiding the bolts (CC) already in place on the table legs (D) through the holes in the leg connector bracket (C) as shown in the diagram.
- Add a washer (DD) and a nut (FF) to the end of each bolt.
- Hand tighten three to four turns only. (Do not tighten completely.)
- Repeat for the other three legs.

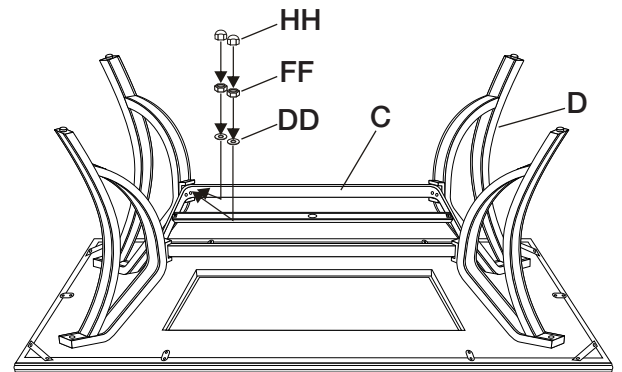

## 3 Tightening the nuts to the bolts

- Use the hex bolt driver (BB) and hex wrench (AA) to tighten all nuts (FF) and bolts (CC).
- Repeat until all bolts (CC) are tight. (Do not over tighten. Over tightening may strip bolts.)
- Cover all nuts (FF) and bolts (CC) with covers (GG and HH).

## 4 Attaching the batteries box

- Install batteries inside of the battery box. Attach the battery box (E) to the leg connector bracket (C) by using the magnet as shown in Fig.4a.
- Connect the power line on the battery box to the power plug on the leg connector bracket as shown in Fig.4b & 4c.
- Hand tighten only.

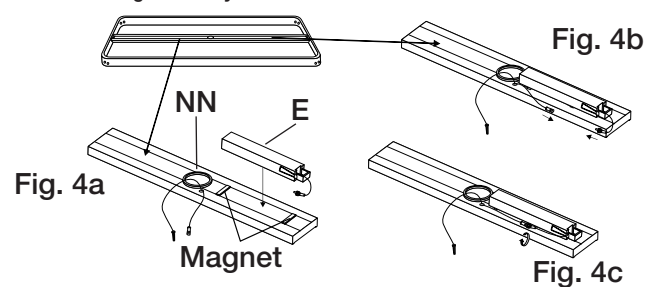

## 5 Turning the table

- With the help of another person, turn the table in the upright position. At this time, note the clear bumpers spaced evenly throughout the inside of the rim.
- Carefully place the glass top (A) inside the rim, resting on the clear bumpers as shown in the diagram.
- Attach the chip to the umbrella ring (LL) as shown in the diagram. Your LED table is now ready for use.

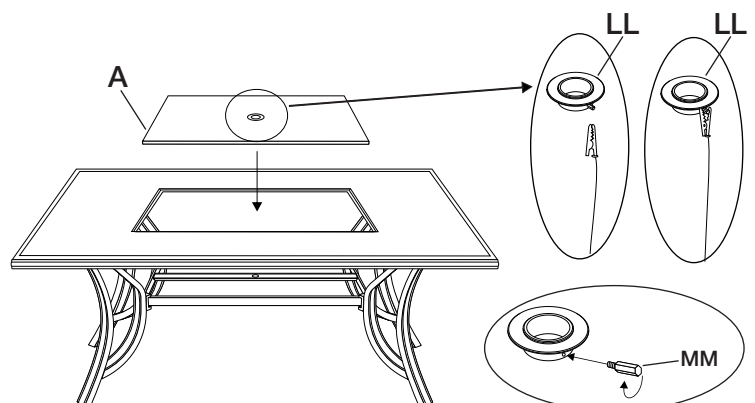

## Maintenance

---

Periodically clean and dry thoroughly. Be sure to drain any water accumulated inside the frame. To thoroughly drain the frame, remove the foot caps and tilt the frame, if necessary, to remove all water. This is critical. Water allowed to accumulate inside the frame and then exposed to sub-freezing temperatures can cause damage to the frame tubing. Such damage is not covered under the warranty. Always clean, drain, and dry thoroughly before storing for the winter. For best results, always store or cover your furniture when not in use. We recommend commercially available outdoor furniture covers. Any small nicks or scratches can be covered with a light application of touch-up paint.

## Care and Cleaning

---

Use mild soap and warm water. Do not use abrasive materials, cleansers, or bleach products. Rinse with clean water and dry thoroughly.



Questions, problems, missing parts? Before returning to the store,  
call Hampton Bay Customer Service  
8 a.m. - 6 p.m., EST, Monday - Friday

**1-855-HD-HAMPTON**

**HAMPTONBAY.COM**

Retain this manual for future use.