

The image shows two clear glass cups filled with a thick, pale yellow frozen yogurt. Each cup is topped with a generous amount of bright yellow lemon curd and a whole cinnamon stick is inserted into the yogurt. The cups are placed on a white lace doily against a light blue background.

GREEK FRO-YO MAKER

instruction manual & recipe guide

DASH



™



GREEK FRO-YO MAKER

Safety Guidelines	4-5
The Dash Greek Fro-Yo Maker	6
What's Inside.....	7
Setting Up Your Fro-Yo Maker	8-9
Using Your Fro-Yo Maker	10-11
Maintenance	12
Troubleshoot.....	13
Customer Support.....	14
Warranty.....	15

IMPORTANT SAFETY GUIDELINES

Please Read and Save this Instruction and Care Manual

When using electrical appliances, basic safety precautions should be followed, including the following:

- Remove all bags and packaging from appliance before use.
- Make sure the appliance is thoroughly cleaned before using.
- Make sure the appliance is turned off before unplugging the cord from the wall.
- Avoid contact with moving parts. Do not put your hands or other objects into the Fro-Yo Maker while it is in use.
- Appliance is not intended for children. Keep appliance away from children, especially when in use.
- Children should be supervised to ensure that they do not play with the appliance.
- The use of accessory attachments is not recommended by the appliance manufacturer, as it may result in fire, electric shock or personal injury.
- To prevent the risk of fire, electric shock, or personal injury, do not place the cord, plug, or unit near water or other liquids.
- Do not submerge Power Unit, Cord or Plug into water or any other liquid.
- Do not use the appliance if any of the parts are damaged.
- Do not place on or near a hot gas burner, hot electric burner, or in a heated oven.
- Do not operate any appliance with a damaged cord or plug or after the appliance malfunctions, or has been damaged in any manner.
- Do not submerge Power Unit, Cord or Plug into water or any other liquid.
- Do not use without Splash Guard or container in place.
- Do not puncture or heat the Fro-Yo Bowl.
- Do not leave the appliance unattended when in use.
- Unplug appliance prior to cleaning, adding or removing parts.
- When using any extension cords, check to see if the electrical rating of the wire is compatible with the appliance.
- When using the appliance, always check whether the voltage used is consistent with the nominal voltage of the appliance.
- To prevent freezer burn, always ensure that your hands are protected when handling the bowl, especially when first removing from freezer.

- To minimize risk of food borne illness, do not consume any Greek yogurt ice cream with raw ingredients that has been stored for over a week.
- Greek yogurt ice cream or sorbet that contains raw or partially cooked eggs should not be given to young children, pregnant women, the elderly or people who are generally unwell.
- This appliance is not intended for use by persons (including children) with reduced physical, sensory or mental capabilities, or lack of experience and knowledge, unless they have been given supervision or instruction concerning use of the appliance by a person responsible for their safety.
- This appliance is intended for household use only.
- StoreBound shall not accept liability for damaged caused by improper use of the appliance.



DASH GREEK FRO-YO MAKER

Congratulations! We hope you're excited to start making delicious, unprocessed Greek frozen yogurt at home with your new Dash Greek Mini Fro-Yo Maker.

BEFORE YOU START

Making frozen yogurt at home can be a fun & rewarding activity. The first few times you use your Dash Greek Fro-Yo Maker, you may want to experiment with different types of ingredients and recipes to see how these factors change the flavor of the frozen yogurt.

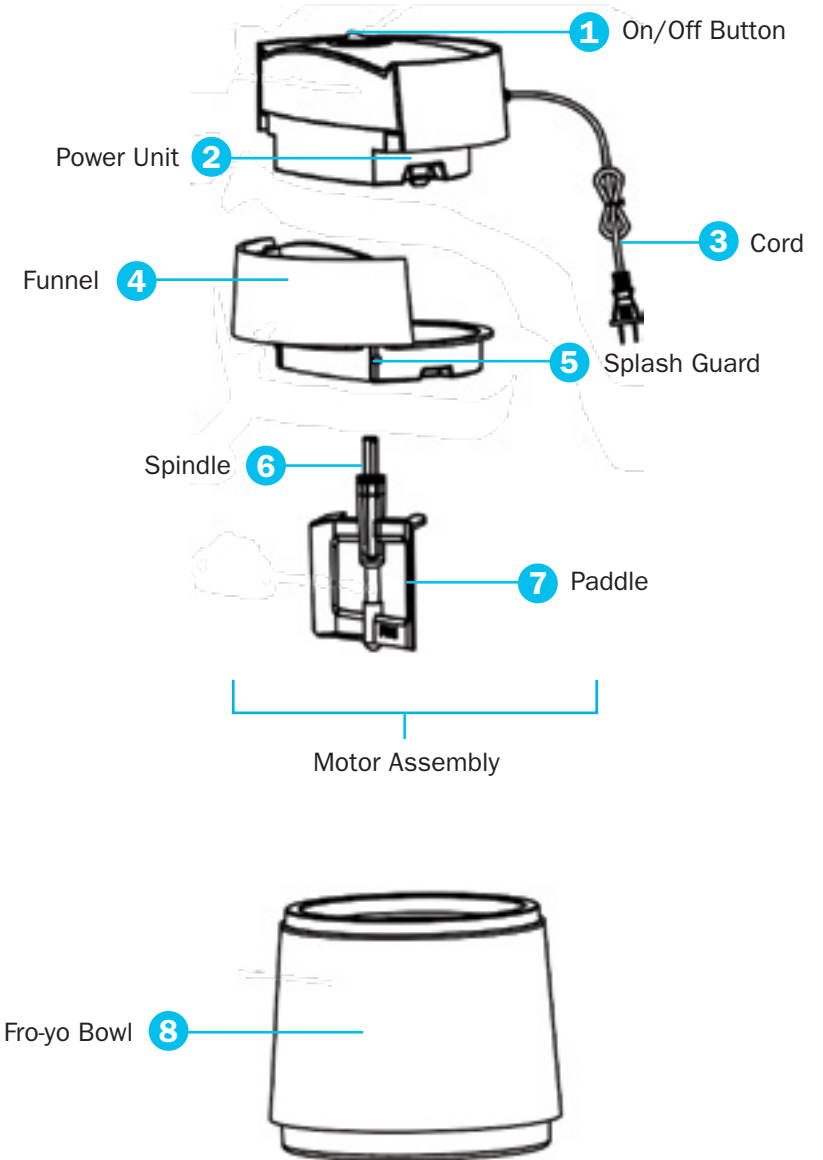

ASSEMBLY

IMPORTANT: The Fro-Yo Bowl must be placed in the freezer for 8 - 10 hours prior to use.
Tip: Make sure to clean your Dash Fro-Yo Maker and all its components prior to first use!



1. Insert the Power Unit into the Splash Guard. Make sure the two clips at the bottom of the Power Unit are locked into place.



2. Insert Spindle into the Power Unit until it clicks into place.



3. Insert the Paddle onto the end of the Spindle.

ASSEMBLY



4. Remove the Fro-Yo Bowl from the freezer and set on a clean, stable and dry surface. Remember, the Fro-Yo Bowl must be frozen for 8 – 10 hours before use.



5. Lower the Motor Assembly on top of the Fro-Yo Bowl. Turn the Motor Assembly clockwise to lock into position. Make sure the Splash Guard is securely attached.



6. You can now switch the Mini Fro-Yo Maker on by using the **ON/OFF** button located on top of the Power Unit.

Your Fro-Yo Maker must be turned on **BEFORE** filling with yogurt.

HOW TO MAKE FROZEN YOGURT

⚠ IMPORTANT NOTE: Make sure the Dash Greek Fro-Yo Maker is **ON** before adding your mixture into the bowl. This will prevent your ingredients from freezing instantly to the side of the Fro-Yo Bowl.

1. FREEZE THE BOWL

Before starting, make sure the Fro-Yo Bowl has been inside your freezer for at least 8 - 10 hours. Shake the Bowl - if you hear liquid moving inside, return the Bowl to the freezer until it has frozen solid.

2. START

Flip the Power Switch to the **ON** position to start the Paddle turning. Do not pour anything into the Fro-Yo Maker before switching it **ON**.

3. POUR IT IN

While the Fro-Yo Maker is **ON**, slowly pour the yogurt mixture through the Funnel and into the Fro-Yo Bowl.

4. LET IT CHURN

Allow the Fro-yo Maker to churn the mixture until frozen or when a desired consistency is reached. Depending on your recipe, this process can take 30 minutes or longer.

Make sure to let the Fro-Yo Maker churn nonstop throughout the entire process or the yogurt will instantly freeze to the inside of the Fro-Yo Bowl and the motor will not be able to churn it.

5. IT'S FINISHED!

Switch the Fro-Yo Maker **OFF** and wait until the Paddle has finished turning before removing the Splash Guard. Your frozen yogurt is now ready to eat!

Caution: To prevent damage to the unit, do not use any metal utensils to scrape yogurt from the Fro-Yo Bowl.



MAINTENANCE

After each use, the Fro-Yo Maker should be cleaned properly. Before moving or cleaning the unit, make sure the Fro-Yo Maker is unplugged.

NOTE: This appliance is NOT dishwasher safe. Do not submerge Fro-Yo Bowl or Power Unit in any liquid.

DISASSEMBLE

1. Switch your Fro-Yo Maker **OFF** and unplug the appliance before removing any parts.
2. Make sure the Paddle has come to a complete stop. Separate the Paddle by gently pulling it off the Spindle then remove the Splash Guard.
3. Squeeze the two clips at the bottom of the Power Unit until the Splash Guard is released.

CLEAN

IMPORTANT: Allow the Fro-Yo Bowl to reach room temperature before cleaning.

- Always make sure to turn off and unplug the appliance if left unattended and before assembling, disassembling or cleaning.
- Use warm, soapy water to wash the Paddle, Spindle or Splash Guard.
- Carefully wash the inside of the Fro-Yo Bowl and dry thoroughly. Do not submerge the Fro-Yo Bowl in water or other liquids.
- Wipe the Power Unit with a damp cloth and dry thoroughly.
- Never use any abrasive cleaning agents on the appliance as they may cause damage to the Fro-Yo Maker.

TROUBLESHOOTING

The yogurt is not freezing.

- The Fro-Yo Bowl was not cold enough. Make sure the Fro-Yo Bowl has been in the freezer for at least 8 - 10 hours. Do not remove the Bowl from the freezer until ready to use.
- The Fro-Yo Bowl may have a leak. Check to make sure the Fro-Yo Bowl is not damaged or punctured.

The paddle is jammed or will not spin.

- The Fro-Yo Maker must be in operation with the Paddle spinning **BEFORE** adding any yogurt to the Fro-Yo Bowl. The motor must be set in motion while the Bowl is empty. Then, the yogurt mixture should be poured through the Funnel Opening.
- Yogurt may have frozen to the sides of the Fro-Yo Bowl causing the Paddle to get stuck or stop moving. If this occurs, turn off the appliance, remove the Splash Guard and use a plastic or wooden utensil to scrape the frozen mixture off the sides. Manually mix the frozen areas into the rest of the mix then continue churning once again.
- The Fro-Yo Maker is equipped with a safety feature that automatically shuts off the machine if the motor overheats. This may occur if the mixture becomes too thick causing the motor to run for a long period of time. In the event of an automatic shut-off, simply switch the appliance off, unplug and allow it to cool. You may continue using the Fro-Yo Maker once the yogurt mixture has thinned.

TIPS & TRICKS

- The finished dessert will be a soft texture but if you wish for a firmer result, store the yogurt in a separate container inside the freezer for an hour.
- For faster results, refrigerate your ingredients prior to making your mixture.

CUSTOMER SUPPORT

If your device fails to function, please check the troubleshooting checklist on bydash.com. There may only be a minor problem that you can solve yourself.

For product support, warranty and maintenance related questions (other than cleaning), please contact StoreBound directly at: 1-800-898-6970 from 7AM - 7PM PST, Monday - Friday, or by email at info@storebound.com.

REPAIRS

DANGER! Risk of electric shock! The Dash Greek Fro-Yo Maker is an electrical appliance. Do not attempt to repair the appliance yourself under any circumstances.

Contact customer service regarding repairs to the device.

TECHNICAL SPECIFICATIONS

Model Number DIC001

Voltage 120V ~ 60Hz

Power Rating 7W

Capacity 0.8L

Stock#: MFYM-20131010V2

WARRANTY

STOREBOUND, LLC – 1 YEAR LIMITED WARRANTY

Your StoreBound product is warranted to be free from defects in material and workmanship for a period of one (1) year from the date of the original purchase when utilized for normal and intended household use. Should any defect covered by the terms of the limited warranty be discovered within one (1) year, StoreBound LLC will repair or replace the defective part. To process a warranty claim, contact customer care at 1-800-898-6970 for further assistance and instruction. A customer care agent will conduct troubleshooting in an attempt to fix any minor problems. If troubleshooting fails to fix the problem, a return authorization will be issued. Proof of purchase indicating date and place of purchase is required and should accompany the return. You must also include your full name, shipping address, and telephone number. We are unable to ship returns to a PO Box. StoreBound will not be responsible for delays or unprocessed claims resulting from a purchaser's failure to provide any or all of the necessary information. Freight costs must be prepaid by the purchaser.

Send All Inquires To: info@storebound.com

There are no express warranties except as listed above.

REPAIR OR REPLACEMENT AS PROVIDED UNDER THIS WARRANTY IS THE EXCLUSIVE REMEDY OF THE CUSTOMER, STOREBOUND SHALL NOT BE LIABLE FOR ANY INCIDENTAL OR CONSEQUENTIAL DAMAGES FOR BREACH OF ANY EXPRESS OR IMPLIED WARRANTY ON THIS PRODUCT EXCEPT TO THE EXTENT PROHIBITED BY APPLICABLE LAW. ANY IMPLIED WARRANTY OF MERCHANTABILITY OR FITNESS FOR A PARTICULAR PURPOSE ON THIS PRODUCT IS LIMITED IN DURATION TO THE DURATION OF THIS WARRANTY.

Some states do not allow the exclusion or limitation of incidental or consequential damages, or limitations on how long an implied warranty lasts, so the above exclusions or limitations may not apply to you. This warranty gives you specific legal rights and you may also have other rights, which vary from state to state.



STOREBOUND™

STOREBOUND MAKES PRODUCTS
THAT MAKE PEOPLE'S LIVES HAPPIER,
HEALTHIER, AND EASIER.

IF YOU'VE GOT A GREAT IDEA FOR A
PRODUCT, WE WANT TO HEAR ABOUT IT.
GO TO OUR WEBSITE AT STOREBOUND.COM