



Large Desk

Free Plans to build a Large Desk with 8 Drawers.



Materials and Tools

MATERIALS:

- 1-1/4" pocket hole screws
- 1" brad nails
- 1-1/4" brad nails
- 1-1/4" screws
- Edge banding, optional
- 8 drawer pulls
- 8 sets of 22" drawer slides
- Wood glue
- Sandpaper (100, 150, 220 grits)
- Finishing supplies (primer & paint, or stain, sealer)

TOOLS:

- Jigsaw, table saw, miter saw, or hand saw
- Pocket hole jig
- Brad nailer
- Drill
- Pencil, ruler, square
- Tape measure
- Sander
- Iron for edge banding
- Edge banding trimmer or craft knife

Lumber:

- One - 2' x 8' x 3/4" PureBond plywood project panel (for the top) (Walnut was used in the example)
- Two - 4' x 4' x 3/4" PureBond plywood project panel (for the remaining pieces)
- Four - 4' x 4' x 3/4" PureBond plywood project panel (for the drawer boxes)
- One - 4' x 4' x 1/4" PureBond plywood project panel (for the back)

Cut List:

- Sixteen - 3/4" PureBond Plywood project panel at 1-1/2" x 29-3/4" - Legs
- Eight - 3/4" PureBond Plywood project panel at 1-1/2" x 20-1/2" - Side Frames
- Four - 3/4" PureBond Plywood project panel at 20-1/2" x 24-1/4" - Side Panels
- Four - 3/4" PureBond Plywood project panel at 1-1/2" x 18-1/2" - Back Stretchers
- Two - 1/4" PureBond Plywood project panel at 19-1/4" x 24-1/2" - Back
- Ten - 3/4" PureBond Plywood project panel at 1-1/2" x 18-1/2" - Front Stretchers
- Four - 3/4" PureBond Plywood project panel at 1-1/2" x 24" - Center Stretchers
- Two - 3/4" PureBond Plywood project panel at 1-1/4" x 24" - Center Stretchers
- One - 3/4" PureBond Plywood project panel at 24" x 68" - Top
- Eight - 3/4" PureBond Plywood project panel at 16" x 20-1/2" - Drawer Box Bottoms
- Sixteen - 3/4" PureBond Plywood project panel at 4-1/2" x 20-1/2" - Drawer Box Sides
- Sixteen - 3/4" PureBond Plywood project panel at 4-1/2" x 17-1/2" - Drawer Box Fronts & Backs
- Eight - 3/4" PureBond Plywood project panel at 5-1/4" x 18-1/4" - Drawer Fronts



FEATURING
PureBond[®]
FORMALDEHYDE-FREE TECHNOLOGY



STEP 1

Notes:

Using edge banding to cover the exposed edges of the plywood is completely optional. It will be applied to the edges of the pieces before assembly.

Cut the pieces for the legs. There will be sixteen pieces cut, and they will be laminated together in pairs to form the leg. Spread glue on the face of one piece then layer the next piece on top. Wiggle it a little to create suction then secure together with 1-1/4" brad nails. When dry, apply edge banding to the exposed edges of the legs then trim the excess banding away.

STEP 2

Cut the pieces for the side frames and the panels. With the pocket hole jig set for 3/4" material, drill pocket holes in each end of the frame pieces as well as the two longer edges of the side panels. If using edge banding, apply it to one edge of each frame piece. This edge will face to the outside.

Attach the frame pieces to the panels with the pocket holes facing away from the panels using glue and 1-1/4" pocket hole screws. The back face of the panel will be flush with the back edge of the frame pieces. Attach the panel assemblies to the legs using glue and 1-1/4" pocket hole screws through the frame pieces.

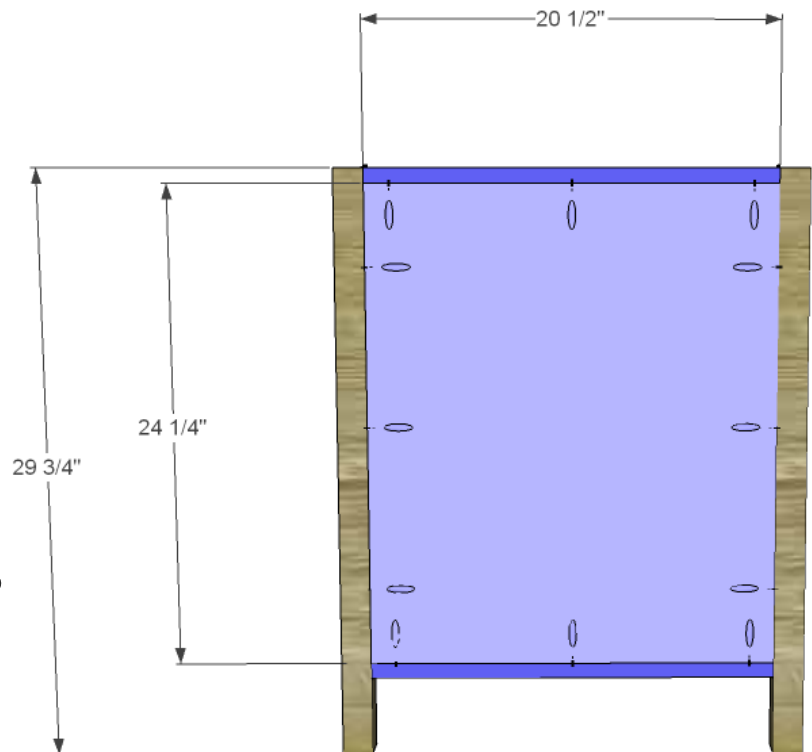



STEP 3

Cut the pieces for the back stretchers and drill pocket holes in each end. Position the stretchers so that the pocket holes on the upper stretcher face up and face down on the lower stretcher. Secure to the legs as shown using glue and 1-1/4" pocket hole screws.

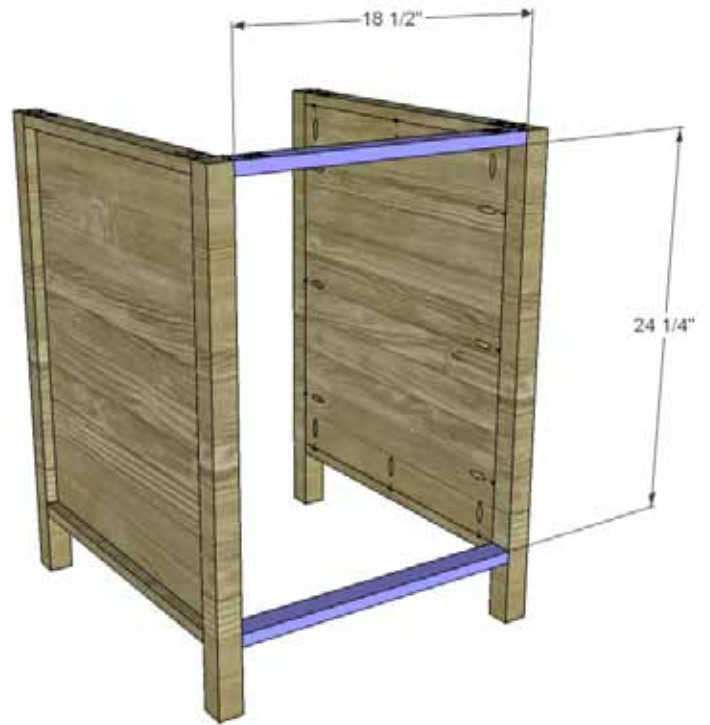

STEP 4

Cut the pieces for the back from the 1/4" material. Position the pieces so that they overlap the opening at the back then secure using glue and 1" brad nails.

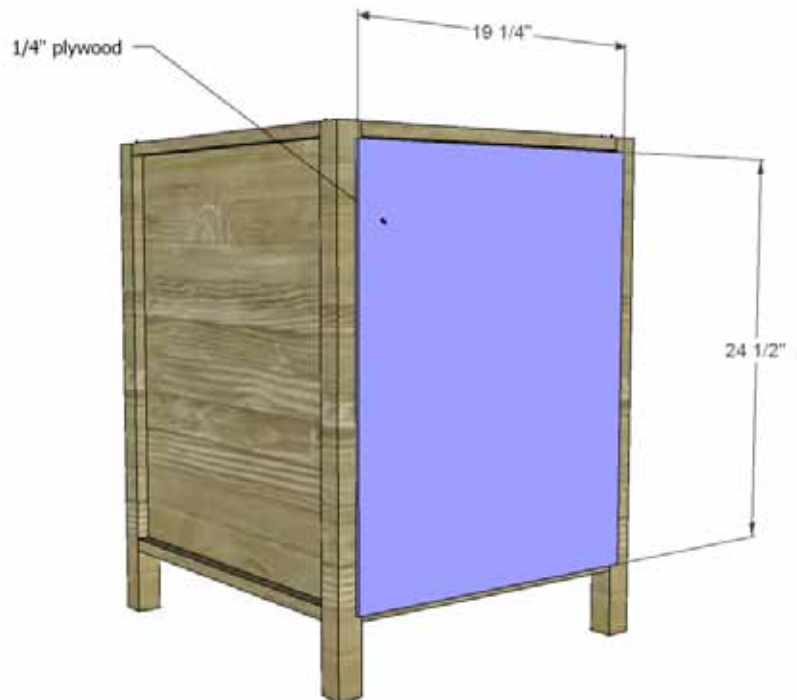



STEP 5

Cut the pieces for the front stretchers and drill pocket holes at each end. Position the stretchers so that the pocket holes on the upper stretcher face up and face down on the remaining stretchers. Secure to the legs as shown using glue and 1-1/4" pocket hole screws.

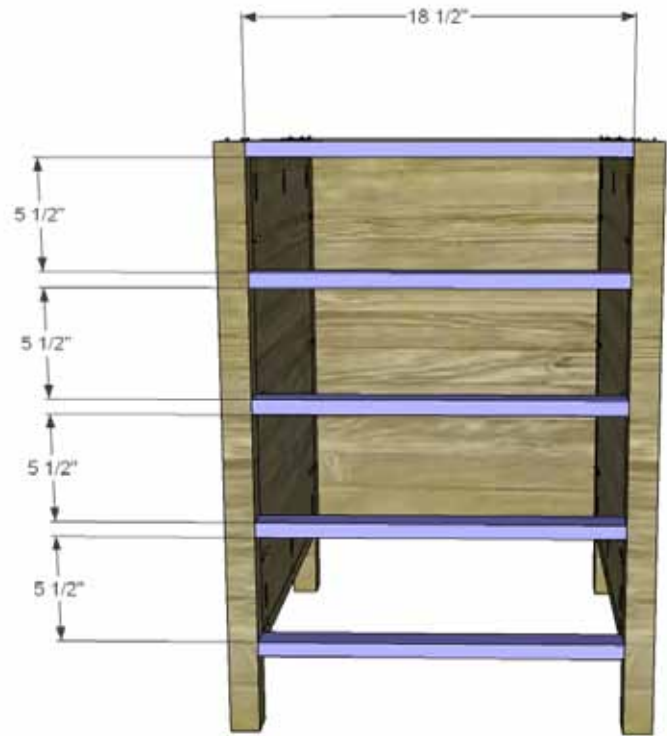

STEP 6

Cut the pieces for the center stretchers. Drill pocket holes in each end of the 1-1/2" wide pieces. Position the 1-1/4" pieces between two of the 1-1/2" pieces with the back face of the narrower piece flush with the back edges of the 1-1/2" pieces. Secure using glue and 1-1/4" brad nails.

The center stretchers will act as "bridges" to join the two drawer banks to each other. Secure the center stretchers to the legs using glue and 1-1/4" pocket hole screws at the top and bottom.

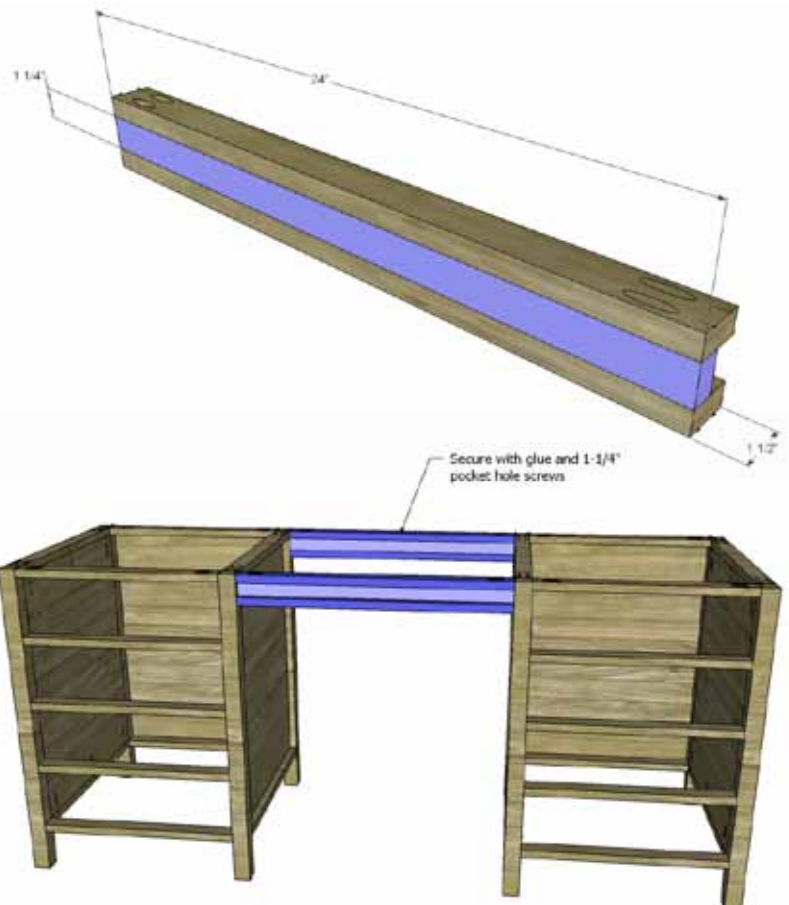



STEP 7

Cut the piece for the top. Apply glue to the top of each of the uppermost stretchers and position the top so that the front and sides overhang by 1/2" (the back will be flush). Secure in place using 1-1/4" screws through the underside of the upper stretchers into the underside of the top.

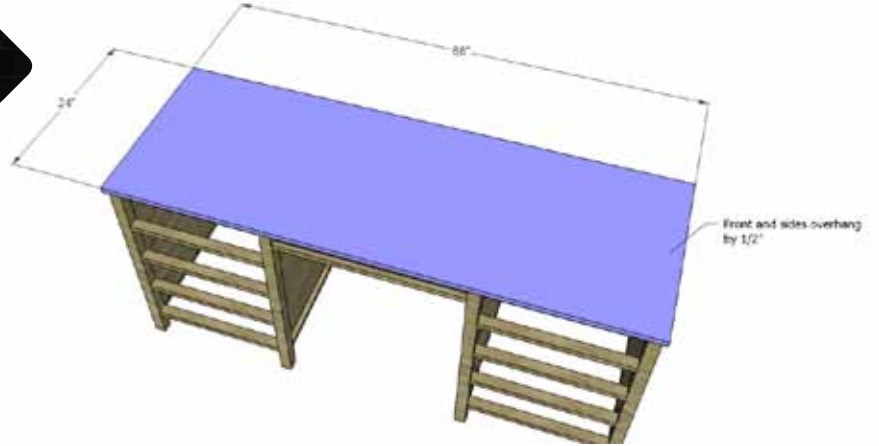

STEP 8

Cut the pieces for the drawer boxes. Drill pocket holes in each end of the side pieces as well as all four edges of the bottom. Secure the sides to the bottom using glue and 1-1/4" pocket hole screws.

Secure the front and back pieces to the sides and bottom using glue and 1-1/4" pocket hole screws.

Install the drawer slides according to the manufacturer's installation instructions locating them 3/4" back from the front edge to accommodate the inset drawer fronts.

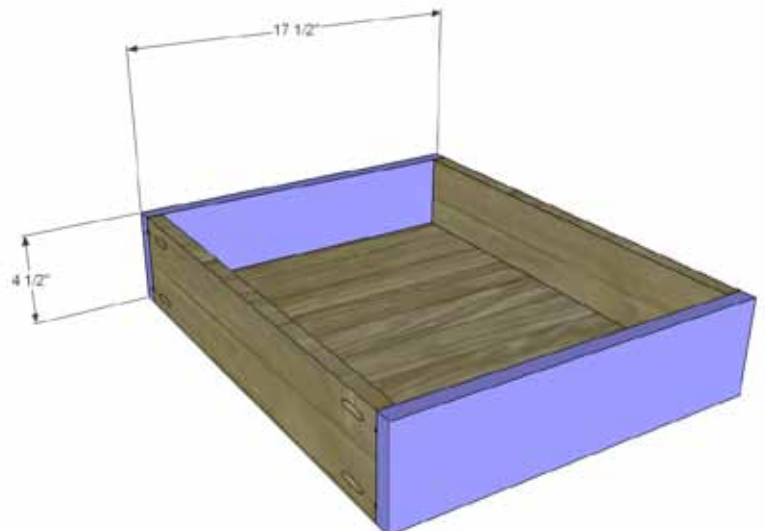
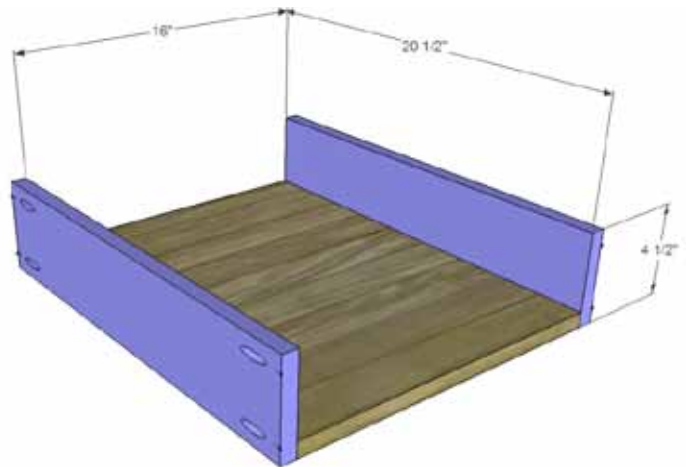



Large Desk



STEP 9

Cut the pieces for the drawer fronts. Mark the position for the cabinet pulls then drill the holes for them. There will be a 1/8" gap around all sides of the drawer fronts in the openings. Shim the drawer front in place, then drive a screw in each hole for the cabinet pull into the drawer box.

Open the drawer, then secure the front to the drawer box using 1-1/4" screws from the inside. Remove the screws from the holes drilled for the cabinet pulls, then finish drilling the holes. Install the cabinet pulls.

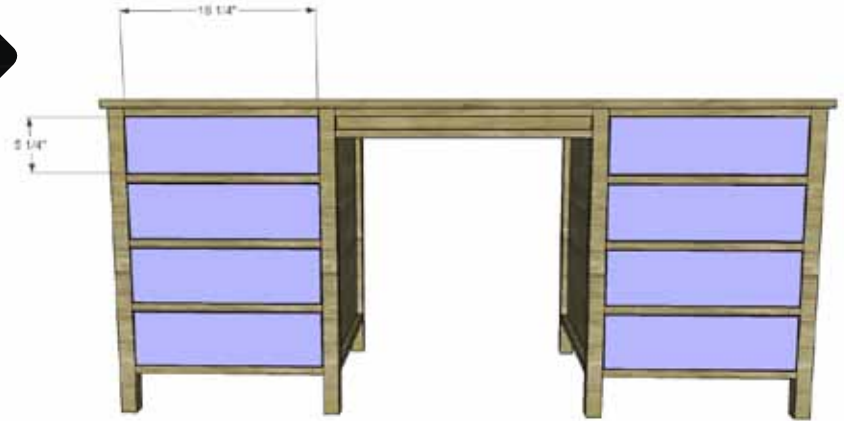

FEATURING

 PureBond.®

FORMALDEHYDE-FREE TECHNOLOGY

Available at most Home Depot stores.