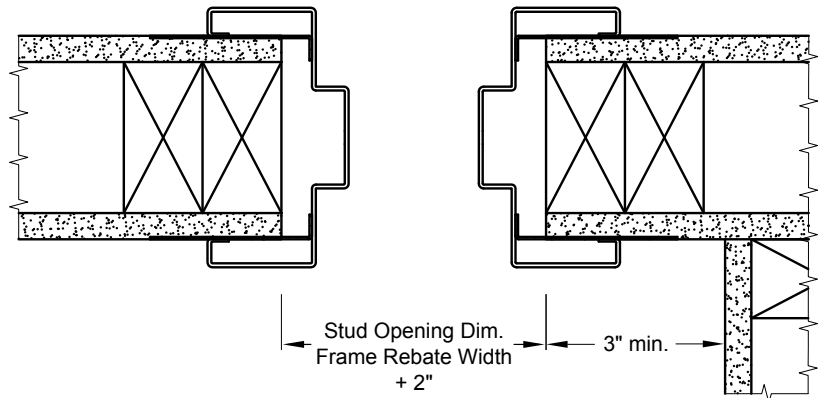

**Figure -"A"**

**NOTES:**

- The rough opening for knock down frames should be 2" bigger in width and 1" in height from frame rebate (Figure -"A").  
(i.e. for 3'0" x 6'8" door frame, rough opening should be minimum 38" x 81")
- A minimum of 3" is required from crossed wall to stud opening on partition wall (Figure -"B").

**TYPICAL PARTITION WALL CONDITION**



**Figure -"B"**

**INSTALLATION DETAILS**

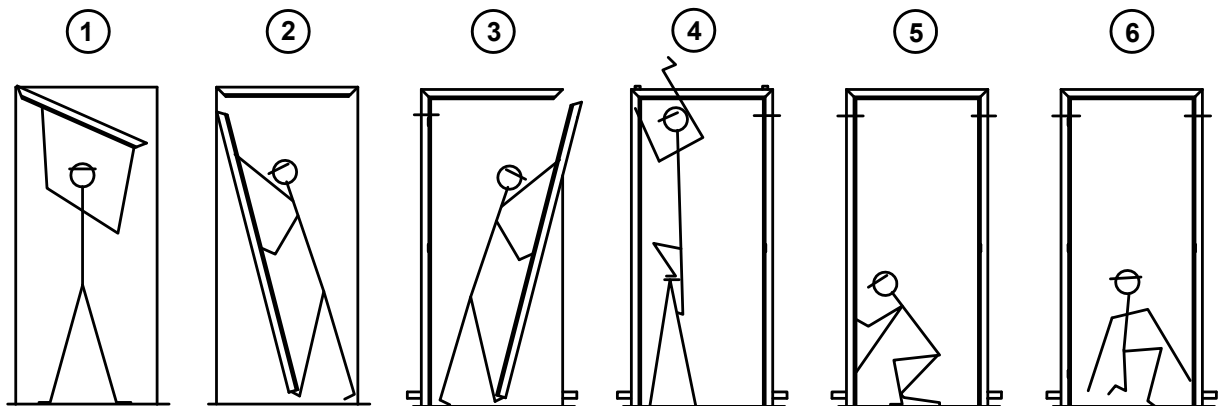

1 Install header.

2 Install hinge jamb. Ensure tabs on jamb are located through slots in header.

3 Install strike jamb in same manner as hinge jamb.

4 Pull down header and secure by bending over the jambs tabs.

5 Plumb hinge jamb, adjust tension anchor and secure strap and base anchors to studs.

6 Adjust strike jamb and head size. Square and adjust tension anchor. Secure strap and base anchors to studs.