

Replacing an entire fence can be an expensive and difficult task. Simpson Strong-Tie® offers a line of products designed to help make reinforcing fence posts easy and economical. The E-Z Base, E-Z Mender and E-Z Spike offer simple solutions for all types of fence post projects.

E-Z Spike (Model No. FPBS44)

- Allows easy installation of 4x4 wood posts without digging holes or pouring concrete.
- Can be used for a variety of applications where quick-to-install posts are needed.

E-Z Mender (Model No. FPBM44E)

- Allows easy repair of rotted or damaged 4x4 wood posts installed in concrete or dirt.
- Reinforces weakened wood posts without having to replace the post or the concrete.
- Sold individually. Use in pairs.

E-Z Base (Model No. FPBB44)

- Allows easy installation of 4x4 wood posts on existing concrete.

MATERIAL: 12 gauge

FINISH: Black powder-coat

INSTALLATION:

- See flier F-EZFPP (see page 228 for details).
- Attach post to E-Z Spike or E-Z Base with 8-1/4" SDS screws or 1/4" HDG lag screws and attach post to E-Z Mender using 6 HDG nails or screws per part.

NOTE: • Notwithstanding the terms of the Limited Warranty, Simpson Strong-Tie does not guarantee, represent or warrant that this product will perform under, or prevent or reduce damage caused by corrosion, any seismic, wind, atmospheric, or other load-producing event.

These products are approved for installation with the Strong-Drive SD Structural-Connector screw. See page 27 for more information.

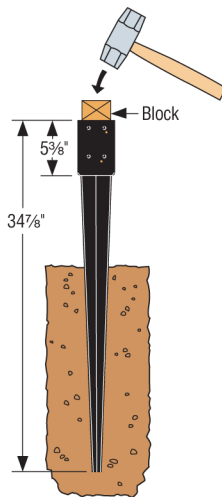

**E-Z Spike™
(FPBS44)**

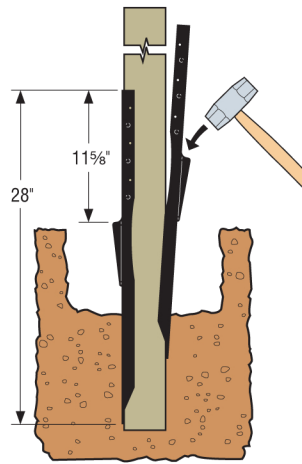

**E-Z Mender™
(FPBM44E)**

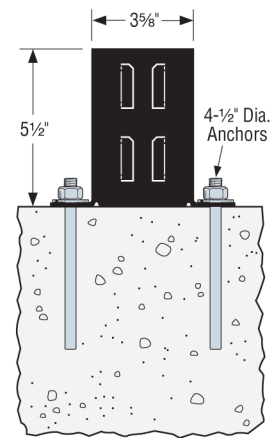

**E-Z Base™
(FPBB44)**

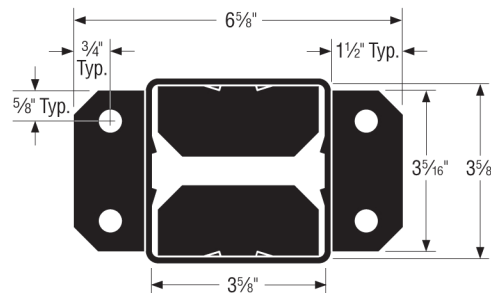

E-Z Base™ (FPBB44) Top View