

# 1A IPHONE® / IPAD® / ANDROID™ WIFI SETUP

1: Connect the power adapter to the camera and connect the other end to a power outlet. Do not connect the Ethernet cable.

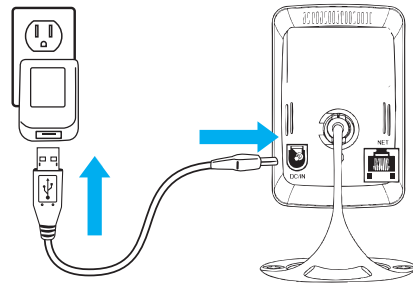

2: Connect your smartphone or tablet to your WiFi network.

3: Download the free **Lorex Ping** app, and tap the Lorex Ping icon to open the app.

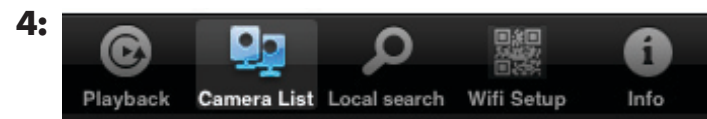

Press **Wifi Setup**



Then

Press **Next**



Enter the password for your WiFi network and press **OK**

A QR code appears on the screen with your WiFi network details.

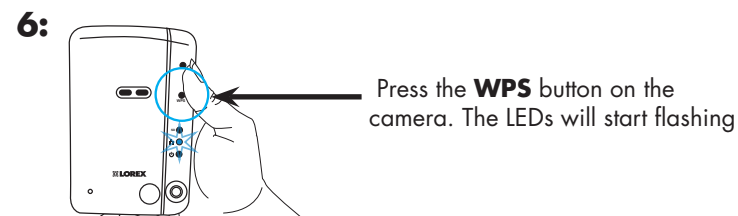

Press the **WPS** button on the camera. The LEDs will start flashing

7: Place your phone or tablet about 1ft (30cm) away from the camera.

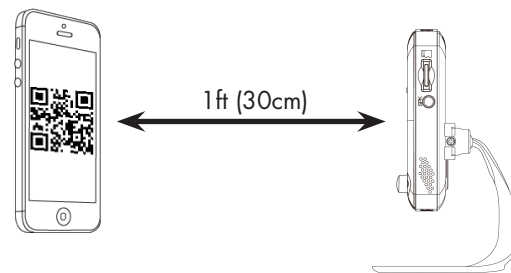

The camera scans the QR code on your device to connect to the WiFi network and beeps once it is successfully scanned. In a few seconds, the connection starts and a message appears on your device.

**NOTE:** If the QR code does not scan, complete option 1B and then complete the Optional WiFi setup instead.

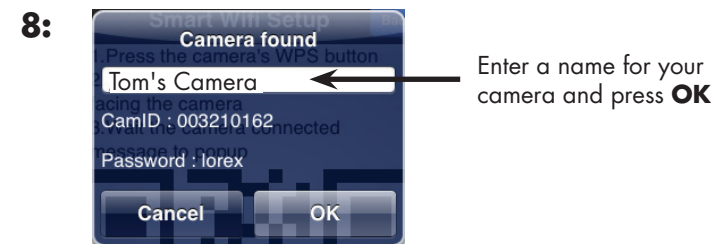

Enter a name for your camera and press **OK**

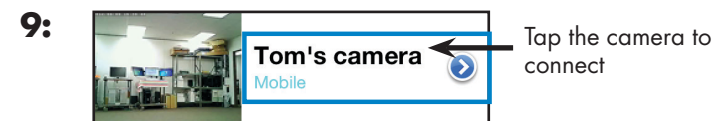

Tap the camera to connect

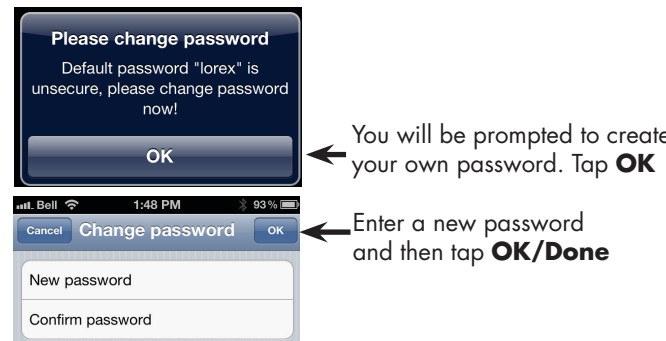

You will be prompted to create your own password. Tap **OK**

Enter a new password and then tap **OK/Done**

10: Tap the name of the camera in Camera List again to connect to the camera. Lorex Ping streams live video from your camera.

**NOTE** For security, a separate admin user name and password is required to change camera settings.

Default admin user name: admin  
Default admin password: \_\_\_\_\_ (leave blank)

# 1B IPHONE® / IPAD® / ANDROID™ ETHERNET SETUP

1: Connect the power adapter to the camera and connect the other end to a power outlet.

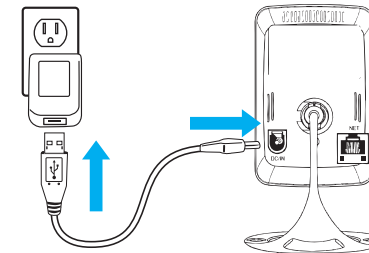

2: Connect an Ethernet cable (included) to the **NET** port on the camera and connect the other end to your router (not included).

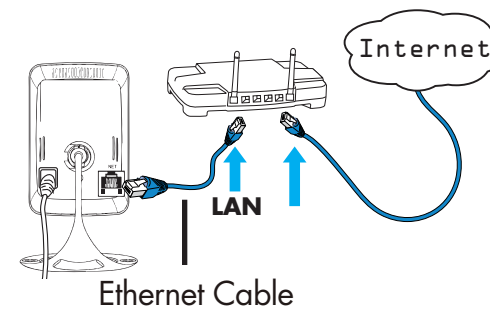

3: Download the free **Lorex Ping** app, and tap the Lorex Ping icon to open the app.



4: Press **+** to add a camera.

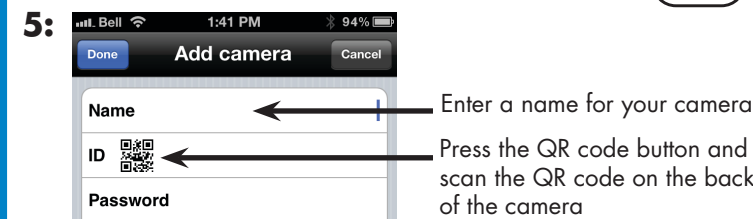

Enter a name for your camera

Press the QR code button and scan the QR code on the back of the camera

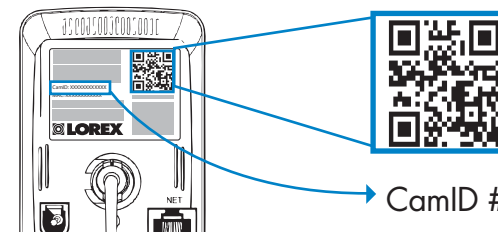

CamID #

Alternatively, you can manually enter the CamID found on the back of your camera.

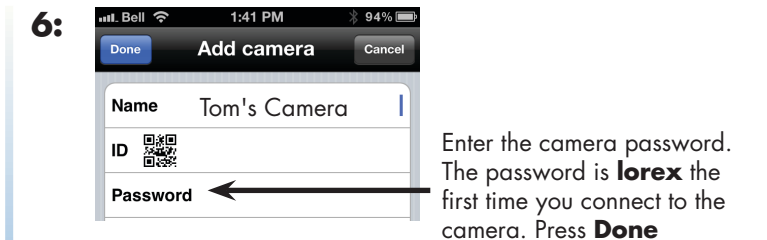

Enter the camera password. The password is **lorex** the first time you connect to the camera. Press **Done**

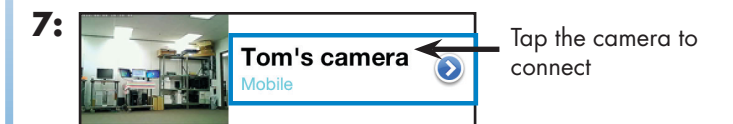

Tap the camera to connect

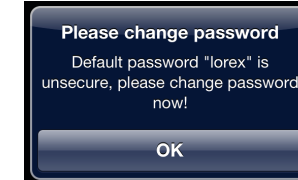

You will be prompted to create your own password. Tap **OK**

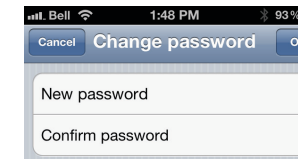

Enter a new password and then tap **OK/Done**

8: Tap the name of the camera in Camera List again to connect to the camera. Lorex Ping streams live video from your camera.

**NOTE** For security, a separate admin user name and password is required to change camera settings.

Default admin user name: admin  
Default admin password: \_\_\_\_\_ (leave blank)

## OPTIONAL WIFI SETUP

- 1: From the Camera List, tap
- 2: Tap **Camera Settings** and enter the admin user name/password above.
- 3: Tap **Network>WiFi Network**.
- 4: Slide **Wi-Fi** to **ON** or check **Wi-Fi** and select your WiFi network. Enter the password and tap **OK**. Wait for the update to complete.
- 5: Remove the Ethernet cable from the camera and it will connect to the WiFi network.

## 1C PC/MAC SETUP—CONNECTING THE CAMERA

**A:** Connect the power adapter to the camera and connect the other end to a power outlet.

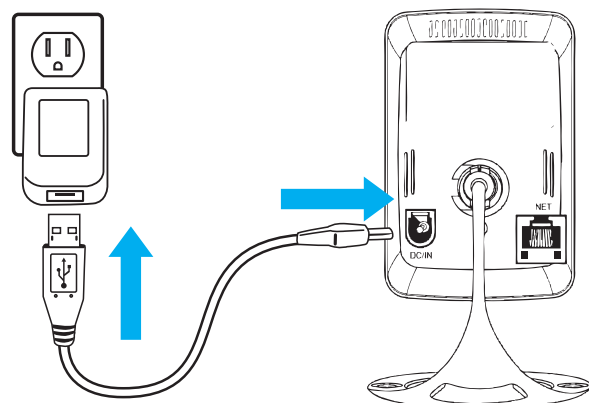

**B:** Connect an Ethernet cable (included) to the **NET** port on the camera and connect the other end to your router (not included).

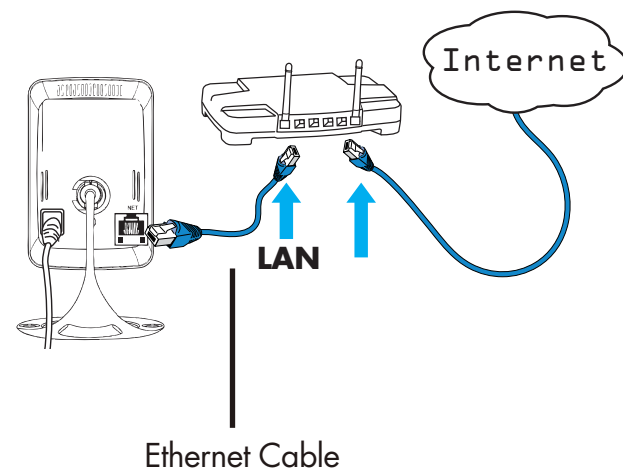

## OPTIONAL—WPS SETUP

Use these steps to set up WiFi if your router supports WPS.

**A:** Power on the camera.

**B:** Press and hold the **WPS** button on your router until the WPS light turns on.

**C:** Then, press the WPS button on the camera within 1 minute. The camera will automatically connect to your WiFi network and the blue Network LED on the camera will turn on.

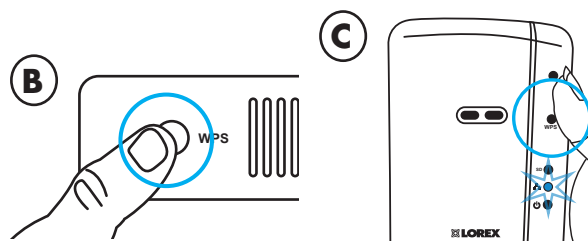

## 2 CONNECTING ON PC OR MAC

**A:** Install the L-View software from the CD or download from [www.lorextechnology.com](http://www.lorextechnology.com)

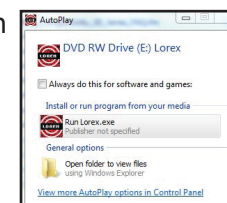

**B:** Double-click the L-View icon.



**C:** Click +

**NOTE:** Mac users, right-click **Camera List** and select **New Camera**.

**D:** Enter a camera name  
Enter the **camID** printed on the back of the camera  
Enter the camera password (default: **lorex**)  
Click **OK**

**E:** Click and drag the camera to a display screen to connect to the camera.



**F:** L-View will prompt you to create your own password for the camera. Click **OK**.

**G:** Create a new password for the camera and click **OK**.

**H:** Click and drag the camera to a display screen again to connect. L-View streams live video from your camera.

## 3 OPTIONAL—PC / MAC WIFI SETUP

**A:** Install L-View on a PC in your local network (must be connected to the same router as the camera) and connect to the camera.

**NOTE:** The camera must be connected to your router using an Ethernet cable before you can set it up to use WiFi.

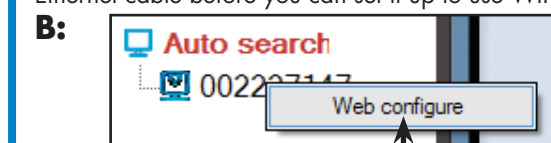

Right-click on the camera ID in the Auto Search area and click **Web Configure**.

**C:** Enter the camera admin user name and password. Click **Log in**.

**NOTE** Your camera admin user name and password differs from the password used to connect to your camera to view video.

**Default admin user name: admin**  
**Default admin password: \_\_\_\_\_ (leave blank)**

**D:** Click on **Network** and then **WiFi Security**.

**E:** Click **WiFi Scan** and select your WiFi network.

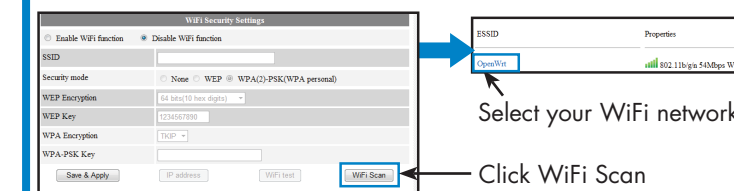

**F:** Enter WiFi Password (WPA-PSK or WEP)

Click **Save & Apply**

**G:** Click **WiFi Security** again and click **WiFi Test**.

When successful, Status will say Test Success. You may then disconnect the Ethernet cable from the camera. If unsuccessful, double check your wireless password and make sure your camera is close enough to the wireless router to get a good signal.

