

## BEFORE YOU BEGIN

### HOW TO USE THESE INSTRUCTIONS

Please read these instructions carefully to familiarize yourself with the required tools, materials, and installation sequences. Follow the sections that pertain to your particular installation. This will help you avoid costly mistakes. In addition to proper installation, read all operating and safety instructions.

All information in these instructions is based upon the latest product information available at the time of publication. Kohler Co. reserves the right to make changes in product characteristics, packaging, or availability at any time without notice.

### NOTES

- Observe all local plumbing and building codes.
- Prior to installation, unpack the new sink and carefully inspect it for damage. Return the sink to its protective carton until you are ready to install it.
- Inspect the waste and supply tubing; replace if necessary.



**CAUTION: Risk of personal injury or product damage.** Cast iron sinks are very heavy. Get help lifting the sink into place.

- For a replacement installation, make sure the existing cutout is the same size or smaller than the cutout for the new sink.
- **Please leave these instructions with the consumer;** they contain important care, cleaning, and warranty information.
- This fixture is not intended for undercounter installation. Kohler Company supplies an entire product line specifically designed for undercounter applications.

### TOOLS AND MATERIALS REQUIRED

- Sealant
- Safety glasses
- Pencil
- Tape measure
- Putty knife
- Plumbers putty
- Keyhole saw or saber saw
- Drill (1/2" dia. drill bit or larger)
- Adjustable wrench
- Pipe wrench
- Tubing cutter

# CUT-OUT INFORMATION

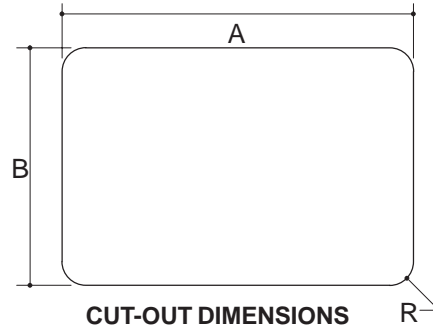

PRODUCT NAME	MODEL NUMBER	SINK O.D.	CUT OUT (A X B)	RADIUS (R)
<b>KITCHEN SINKS</b>				
Bakersfield	K-5832-*	31" x 22"	29-3/4" x 20-3/4"	1"
Bon Vivant	K-5911-*	48" x 21"	46-3/4" x 19-3/4"	1"
Brookfield	K-5942-*	33" x 22"	31-3/4" x 20-3/4"	1"
Brookfield 	K-5981-*	31-3/4" x 20-3/4"	30-1/2" x 19-1/2"	1"
Cantina	K-5850-*	43" x 22"	41-3/4" x 20-3/4"	2-1/4"
Cardamom	K-5881L/5881R-*	33" x 22"	31-3/4" x 20-3/4"	1"
Cilantro	K-5878-*	36" x 22"	34-3/4" x 20-3/4"	1"
Efficiency	K-5948-*	33" x 22"	31-3/4" x 20-3/4"	1"
Entrée	K-5988-*	33" x 22"	31-3/4" x 20-3/4"	1"
Epicurean	K-5904-*	43" x 22"	41-3/4" x 20-3/4"	1"
Executive Chef	K-5932-*	33" x 22"	31-3/4" x 20-3/4"	1"
Galleon	K-5982-*	38" x 22"	36-1/2" x 20-1/2"	2"
Hartland	K-5823-*	33" x 22"	31-3/4" x 20-3/4"	1"
Lakefield	K-5924-*	33" x 22"	31-3/4" x 20-3/4"	1"
Marsala	K-5922-*	33" x 22"	31-3/4" x 20-3/4"	1"
Mayfield	K-5955	25" x 20"	23-3/4" x 18-3/4"	1"
Mayfield	K-5964-*	25" x 22"	23-3/4" x 20-3/4"	1"
Meadowland	K-5802	25" x 22"	23-3/4" x 20-3/4"	1"
Trieste	K-5914-*	43" x 22"	Use template	Use template
Urbanite	K-5918-*	25" x 22"	23-3/4" x 20-3/4"	1"
<b>UTILITY/LAUNDRY SINKS</b>				
Glen Falls	K-6749-*	25" x 22"	23-1/2" x 20-1/2"	1"
Park Falls	K-6580-*	21" x 22"	19-3/4" x 20-3/4"	1"
River Falls	K-6703/04-*	25" x 22"	23-1/2" x 20-1/2"	1"
<b>ENTERTAINMENT SINKS</b>				
Addison	K-6552	13" x 13"	11-3/4" x 11-3/4"	1"
Aperitif	K-6560-*	16" x 19"	14-3/4" x 17-3/4"	2-3/8"
Entertainer	K-6558-*	22" x 18"	Use template	Use template
Napa	K-5847L/5847R/5847-*	18-3/4" x 20-7/8"	17-1/2" x 19-5/8"	1"
Sorbet	K-5901-*	15" x 15"	13-3/4" x 13-3/4"	2-1/8"

# INSTALLATION

## REMOVE EXISTING SINK

- Turn off the water supply to the faucet.
- Open the faucet valves; then disconnect the supply lines.
- Disconnect the drain assembly, and remove the trap.
- Remove the existing sink.

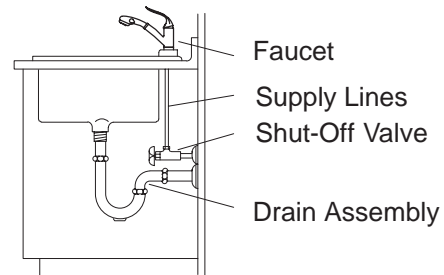

## INSTALL NEW SINK:

- Determine the desired location for the sink.
- For the Trieste (K-5914) or Entertainer (K-6558) sinks, use the template packed with the product to draw the cut line.
- For other sinks, draw the cut line based upon the measurements provided in the Cut-Out Information table on Page 2. Provide adequate clearance between the sink and backsplash. Double check your measurements.
- Drill a 1/2" pilot hole on the inside of the cut line.
- Carefully cut out the countertop opening with a saber or keyhole saw.

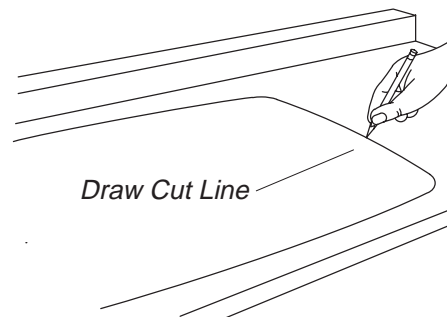

**CAUTION: Risk of personal injury or product damage.** Cast iron sinks are very heavy. Get help lifting the sink into place.

- Temporarily position the sink in the countertop opening.
- Either trace a pencil line, **or** apply a smooth, unbroken border of masking tape around the entire outside edge of the sink. Masking tape should be applied about 1/8" from the sink edge.
- Remove the sink from the countertop opening.

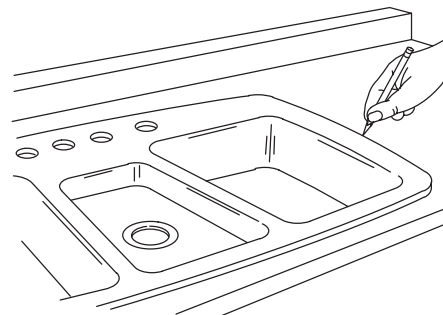

- Install the faucet and strainer(s) according to the instructions included with those products.
- Apply two beads of sealant between the countertop opening and the pencil line or masking tape border.
- Use a clean putty knife to evenly spread out the sealant.

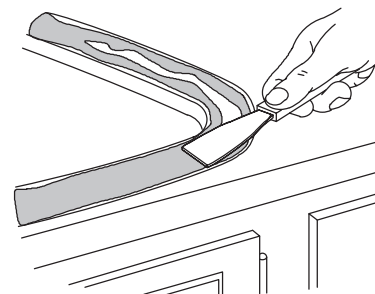

- Carefully position the sink in the countertop opening so the sink edges line up with the pencil line or masking tape border.
- Press down on the sink firmly and evenly.

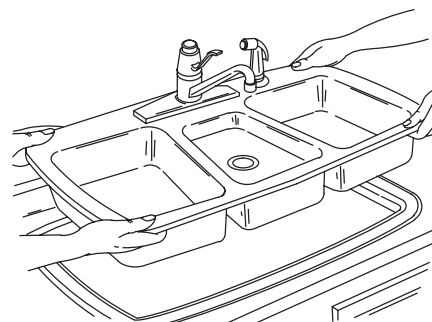

- Immediately wipe away any excess sealant, and fill any voids as needed.
- Verify that the sink has not moved out of position.
- Allow the sealant to cure at least 30 minutes before proceeding.

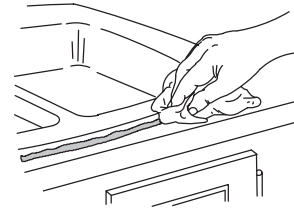

- Install the garbage disposal, if desired. Follow the instructions included with the garbage disposal.
- Connect the faucet supply lines.
- Connect the drain assembly.
- Open the faucet valves, and check for leakage.
- Clean up with a **non-abrasive** cleaner.

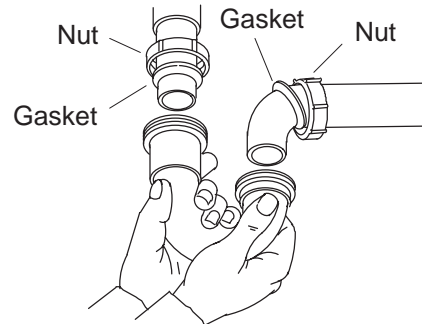

## IMPORTANT CONSUMER INFORMATION

### CARE AND CLEANING

Keep your cast iron sink looking new by rinsing it out thoroughly after each use. **Do not** regularly use abrasives on enameled cast iron, as this will eventually scratch and ruin the surface.

For stubborn stains such as metal marks, abrasives may be used sparingly. Avoid soaking dishes for very long periods of time, and refrain from leaving coffee grounds and tea bags in the sink.

### REQUESTING SERVICE

Please take a moment to familiarize yourself with the Kohler Warranty, its benefits, and limitations. Kohler Co. and its distributors support you with one of the largest Service Networks of its type. Here's what you need to do if you require service:

1. Contact the dealer or contractor who sold and installed the product. They should be able to solve any problems you may have.
2. If your dealer or contractor cannot solve the problem, they will contact or supply you with the name of the local Kohler Distributor and the:
  -  KOHLER TECHNICAL SPECIALIST
3. If you are unable to obtain warranty service through either your contractor or Kohler Co. distributor, please write us directly at Kohler Co., Attn: Customer Service Department, 444 Highland Drive, Kohler, WI 53044 U.S.A.
4. Include all pertinent information regarding your claim, including a complete description of the product, model numbers, colors, finishes, and the date the product was installed. Include a description of the problem, and a photocopy of your invoice for the products involved. Also give us the name of the contractor and distributor.

### LIFETIME LIMITED WARRANTY – CAST IRON

Kohler warrants this cast iron product to be free of defects in material and workmanship during normal residential use for as long as the original purchaser owns his/her home. Gloss reduction, scratching, staining or alkaline etching, of the finish over time due to use, cleaning practices or water or atmospheric conditions are not manufacturing defects but are indicative of normal wear and tear. This warranty is applicable to Kohler cast iron product manufactured after February 10, 2000.

If a defect is found in normal residential use, Kohler Co. will, at its election, repair, replace or make appropriate adjustment. Damage caused by accident, misuse, or abuse is not covered by this warranty. Improper care and cleaning will void the warranty. Proof of purchase (original sales receipt) must be provided to Kohler with all warranty claims. Kohler Co. is not responsible for labor charges, installation, or other consequential costs. In no event shall the responsibility of Kohler exceed the purchase price of the product.

To obtain warranty service, contact Kohler Co. through your Dealer or Plumbing Contractor, or by writing: Kohler Co., Attn: Customer Service Department, 444 Highland Drive, Kohler, WI 53044, USA, or by calling **1-800-4-KOHLER** from within the USA, **1-800-964-5590** from within Canada, or **001-877-680-1310** from within Mexico. Please be sure to provide all pertinent information regarding your claim, including a complete description of the problem, the product, model number, color and the date the product was purchased. Also include the name of your contractor or distributor and your original invoice.

If the product is used commercially, Kohler warrants the product to be free from defects in material and workmanship for one (1) year from the date of purchase as shown on the invoice or receipt with all other terms of this warranty applying except duration. **Any implied warranties for product used commercially, including that of merchantability or fitness for a particular purpose, are expressly limited in duration to the duration of the one year express warranty.**

**To the extent permitted by law, Kohler Co. disclaims all implied warranties including merchantability and fitness for a particular purpose. Kohler Co. disclaims any liability for special, incidental, or consequential damages.** Some states/provinces do not allow limitations on how long an implied warranty lasts or the exclusion or limitation of special, incidental, or consequential damages, so these limitations and exclusions may not apply to you. This warranty gives you specific legal rights. You may also have other rights which vary from state/province to state/province. This warranty is to the original purchaser only and excludes product damage due to installation error, product abuse, or product misuse, whether performed by a contractor, service company, or yourself. This warranty applies only for Kohler cast iron product installed in the United States of America, Canada and Mexico.

This is our exclusive written warranty.