

LED Downlight Instruction Sheet

ART REVISION #: 05

ART REVISION DATE: 08/09/2012

FINAL ART DATE: 08/09/2012

US SPEC #: A01-1105-2401

CHINA #: 324164225131

US PART #: 823187

| PRODUCTION NOTES: | | ARTWORK SPECIFICATIONS: | | | | |
|--|--|---|-------------------------------------|--|---|---|
| <ul style="list-style-type: none"> This proof indicates approximate color only. All colors print 100% unless otherwise indicated. All structure and holding lines do not print unless otherwise indicated. This is prepared as a color digital mechanical, no traps have been made. All trapping is the responsibility of the engraver and/or separator and/or printer. | | Date: 08/09/2012 | Project Name: LED Downlight Sticker | Brand: Philips LED | Product Name/Description: LED Downlight | File Name: 418772_Downlight Sticker_823186.ai |
| Account Rep: HM Production Artist: MG | | Component Type: Sticker | Die Line No.: | Product Number: 418772 | Artwork Program: AI CSS | Manufacturing Site: China |
| | | Version No.: 05 | Print Method: | Number Of Colors: 1 color (black/ink) | Bar Code No.: | Language: English |
| | | COLORS: Note: All colors for reference only, printer to use pre-approved color drawdowns when printing. | | MATERIALS & COATINGS: Note: Refer to applicable Component (PC) Specification for exact details/requirements on substrates and coatings/varnishes | | |
| | | Varnishes/Special Coatings: | Graphic Specialist: SH PCC | Packaging Engineer & Phone No: SH PCC | Agency: SH PCC | |
| PRINT SPECIFICATIONS: | | | | | | |
| COLORS: Black | | FONTS: Gill Sans Regular Gill Sans Bold Gill Sans Light Gill Sans Italic | | Gill Sans Bold Condensed Arial Bold Arial Regular | | PHILIPS |

PHILIPS 6" LED Recessed Downlight — RDL6 Installation Instructions

Recessed Housing and Dimmer Compatibility

The PHILIPS 6" LED Recessed Downlight is designed to be install in standard 6" insulated and non-insulated recessed downlight housings. For a list of compatible housings, please refer to www.philips.com/beautifullight.

This product is not compatible with all dimmers, for a compatible dimmer list please refer to www.philips.com/beautifullight. Minimum distance between edge of recessed fixture and top of the housing or other obstruction (see below figure).

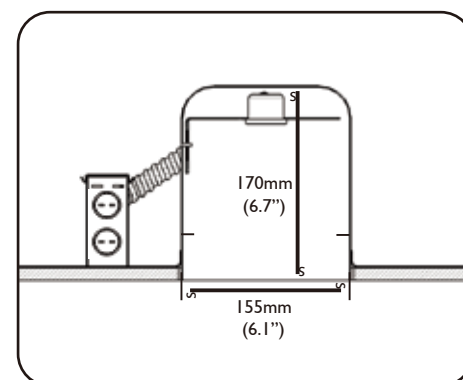

Warnings

The PHILIPS 6" LED Recessed Downlight is classified by Underwriters Laboratories with respect to FIRE and SHOCK hazards only.

- Risk of fire or electric shock – Install this kit only in the luminaries that have the construction features and dimensions shown in the photographs and/or drawings herein.
- Risk of electric shock – Do not use where directly exposed to water.
- Do not make or alter any open holes in an enclosure of wiring or electrical components during kit installation.
- To prevent wiring damage or abrasion, do not expose wiring to edges of sheet metal or other sharp objects on existing recessed housing.
- Risk of fire or electric shock. Do not alter, relocate, or remove wiring, lamp holders, ballasts, or any other electrical component.

Note: It may be necessary to remove a mounting plate that attaches the light socket to the inside of the existing housing for adequate clearance. Each lampholder shall be installed only in a base up orientation. Not all existing recessed housings that meet these requirements will be compatible with the PHILIPS 6" Recessed Downlight.

To Install

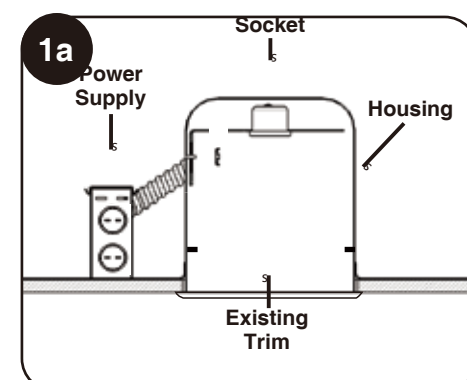

Step 1a

Make sure power is turned off at the source to the recessed housing(s). Disconnect power at the fuse or circuit breaker before installing or servicing. Let lamp cool to avoid electrical shock or burn. After lamp has cooled, carefully remove the existing lamp.

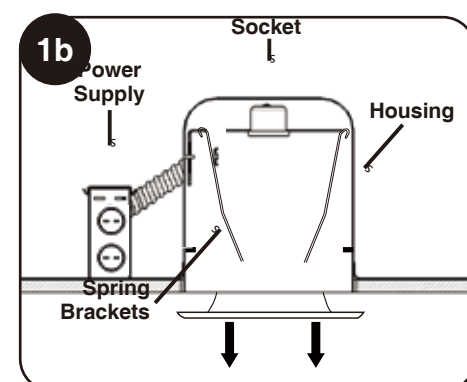

Step 1b

Remove the trim surrounding the existing housing, then remove the trim's torsion springs from the spring brackets in the recessed housing, revealing the existing socket.

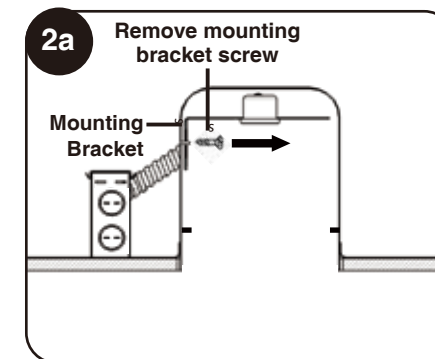

Step 2a

Locate the existing socket and any screws that prevent the socket mounting bracket from being removed. Unscrew and remove all screws or wingnuts on socket mounting bracket. (Figure 2a).

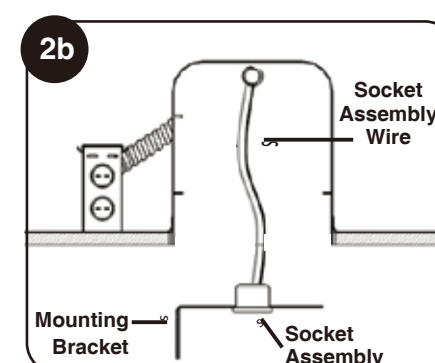

Step 2b

Remove all remaining brackets and/or mounting plates from the lamp socket. Now that the socket mounting bracket has been removed from the housing, gently pull down socket assembly out of housing as shown in Figures 2b.

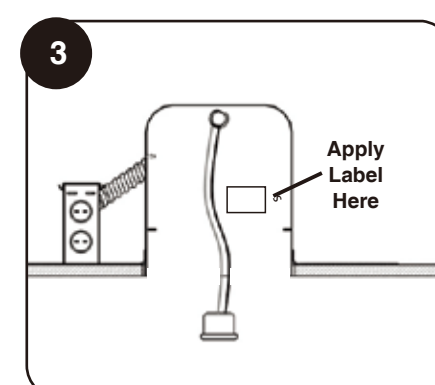

Step 3

Locate the label provided with the product and attach label onto the inside of existing housing. You are now ready to install the RDL6 fixture.

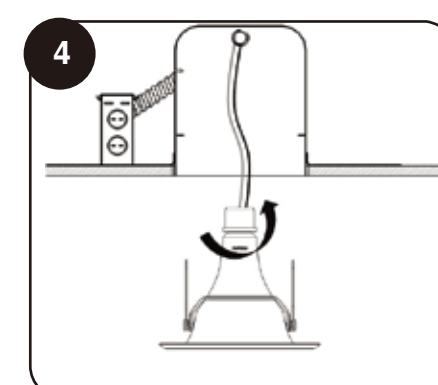

Step 4

Screw the base of the RDL6 into the hanging socket (Figure 4).

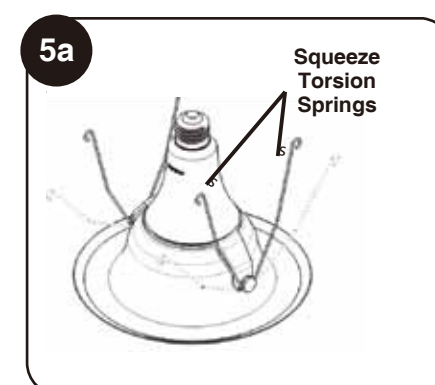

Step 5

Squeeze the torsion springs together as shown (Figure 5a) and install them into torsion spring brackets inside the recessed housing (Figure 5b).

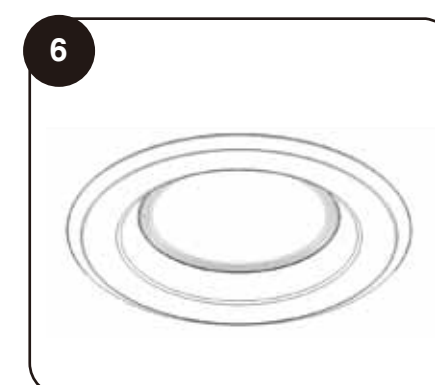
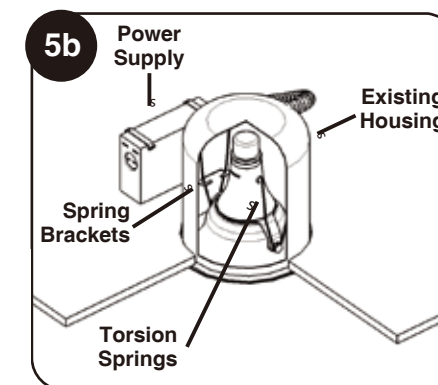

Step 6

Once the torsion springs are in the brackets, carefully push the RDL6 into the fixture until it is flush with the ceiling surface (Figure 6).

正反面印刷
215.6x278.2mm

正反面印刷
215.6x278.2mm