

PACKAGE CONTENTS

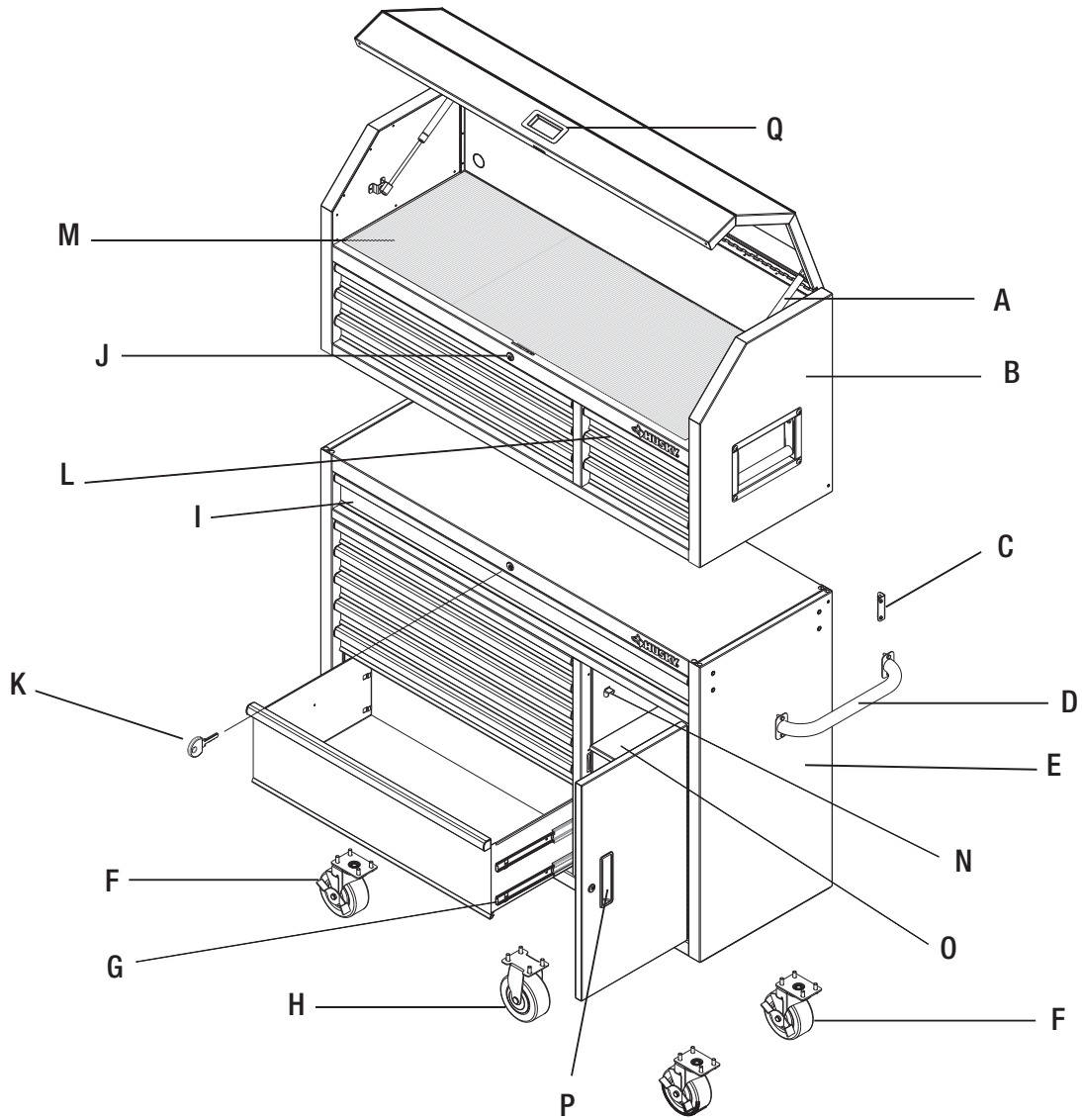

Part	Description	Quantity
A	Gas lift	2
B	Top chest	1
C	Bracket	2
D	Side handle	1
E	Rolling cabinet	1
F	Swivel caster with brake	4
G	Drawer slide (pair)	14
H	Regular caster	2

Part	Description	Quantity
I	Drawer	13
J	Lock	3
K	Key (set)	2
L	Husky badge	2
M	Drawer liner	14
N	Shelf clips	4
O	Shelf	1
P	Door pull	1
Q	Chest lid handle	1

# 1 Attaching the side handle

- Attach the side handle (D) to the rolling cabinet (E) using six bolts (AA).

 **NOTE:** The holes in the cabinet are tapped and do not require nuts.

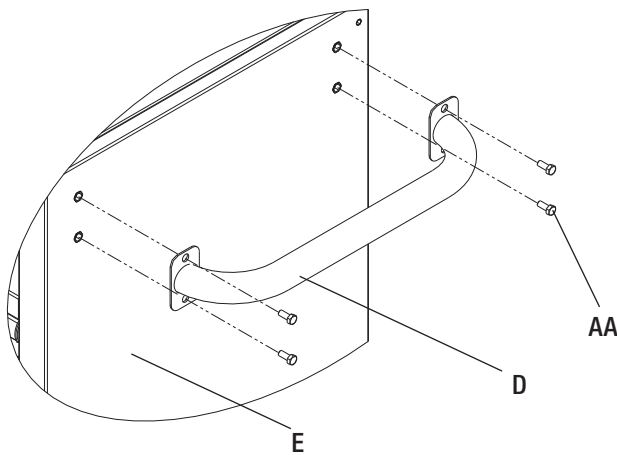

# 2 Installing the casters



**CAUTION:** Do not over tighten the screws.

- Ensure all cabinet drawers are securely locked into place using the key lock on the rolling cabinet (E).
- Lay the cabinet (E) on its back on top of the packaging material to protect the finish.
- Mount the four swivel casters with brake (F) to the rolling cabinet (E) using four bolts (CC) and washers (BB) per caster. The swivel casters with brake (F) should be installed on each end of the cabinet.
- Mount the two regular casters (H) to the center of the rolling cabinet (E) using four bolts (CC) and washers (BB) per caster.
- Tighten all bolts with a wrench.
- Return the rolling cabinet (E) to its upright position.

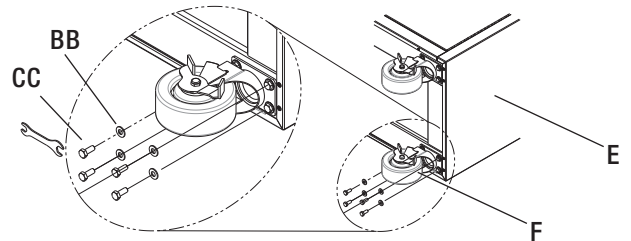

# 3 Placing the chest

 **NOTE:** Two people may be required to complete this step.

- Place the top chest (B) on top of the rolling cabinet (E).

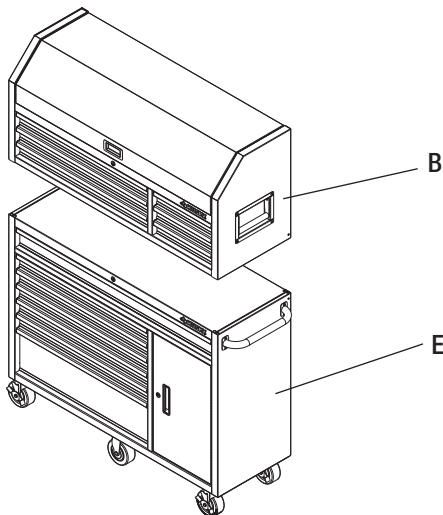

# 4 Installing the brackets



**NOTE:** The holes in the cabinet are tapped and do not require nuts.

- Attach the brackets (C) to the back of the product to secure the top chest (B) to the rolling cabinet (E). Place the brackets over the holes and secure with four screws (DD) per bracket.
- Tighten all screws securely with a screwdriver.

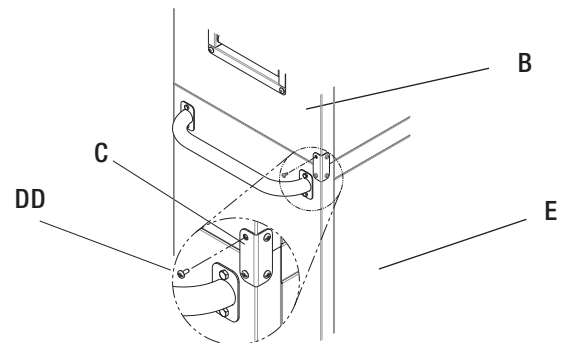

### 5 Installing the drawer liners

- Place the drawer liners (M) in appropriately-sized drawers and the chest lid area to protect the surface.

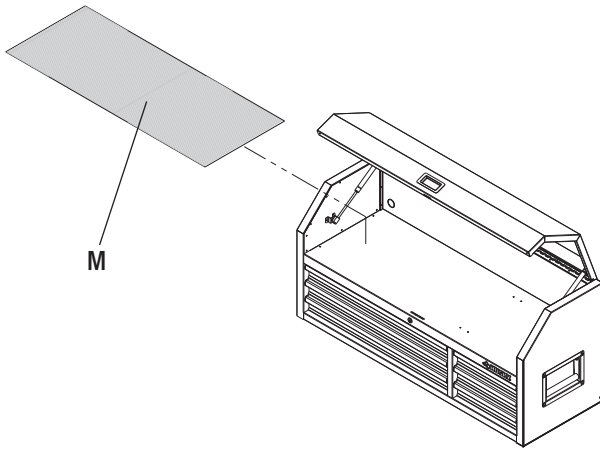

### 6 Installing the shelf brackets

- Install the four shelf brackets (N) inside the storage area at the desired shelf height location.
- Ensure all shelf brackets are aligned horizontally and are properly seated in the bracket slots.

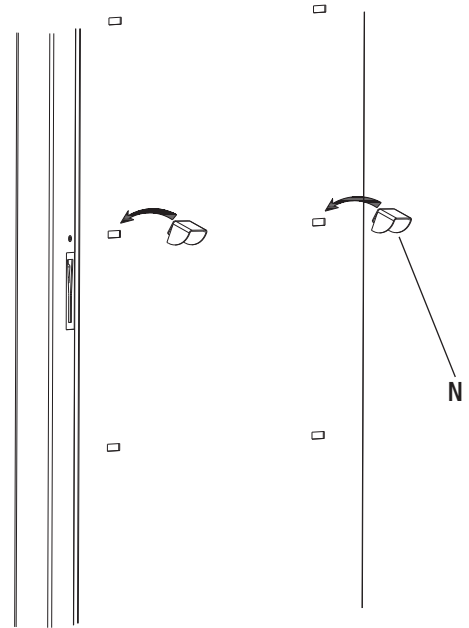

### 7 Installing the shelf

- Install the shelf (O) inside the storage area so that it sits on top of the four shelf brackets (N) flush and level.

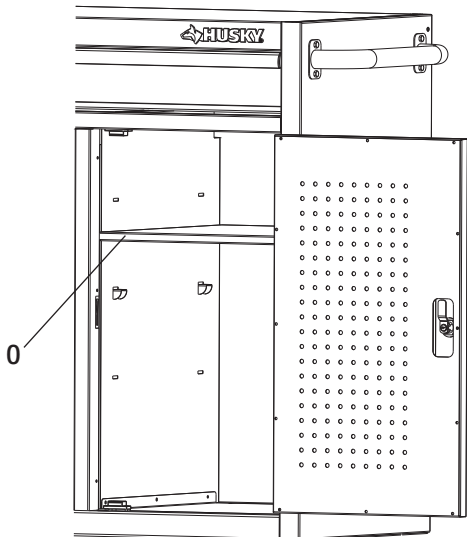

# 1 Locking and unlocking the unit



**IMPORTANT:** The drawers must be fully closed before locking / unlocking the unit.

- Insert the key (K) and turn it counterclockwise, one quarter turn to lock.
- Remove the key (K).
- Insert the key (K) and turn it clockwise, one quarter turn to unlock.
- Remove the key (K).



**NOTE:** Key codes for chest and cabinet will be different.

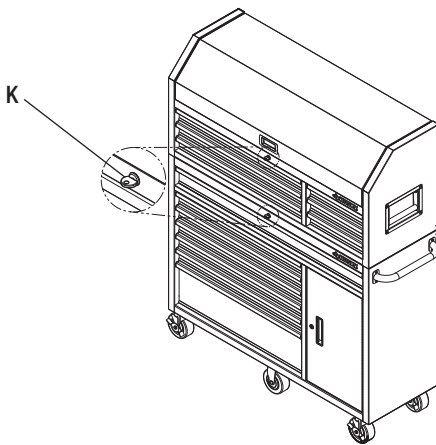

# 2 Removing the drawers

- Fully extend and empty the drawer.
- Depending on the slide, either lift or lower the release lever on both sides so the slides can ride over the stops. Pull out to remove.

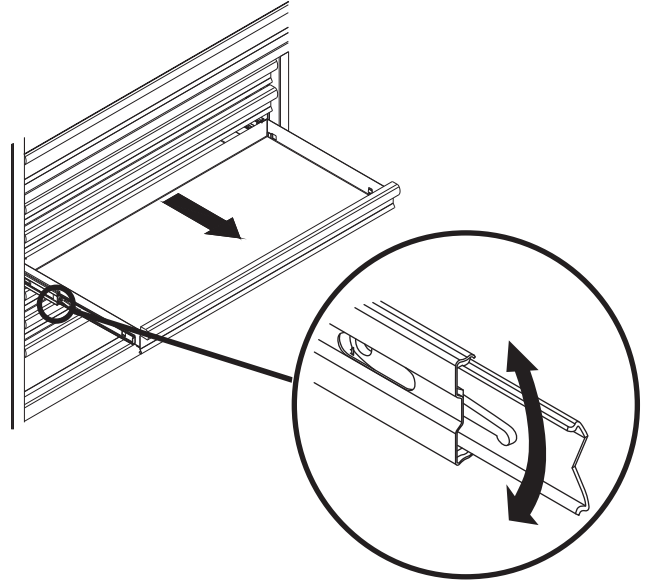

# 3 Installing the drawers

- Pull the slides and slide carrier out until fully extended.
- Hold the slide on the cabinet while aligning it with the slide on the drawer.
- Slightly insert one side and repeat for the other side.
- Slowly push the drawer until it is fully closed to engage the slide.
- Open the drawer and close it to verify proper operation.

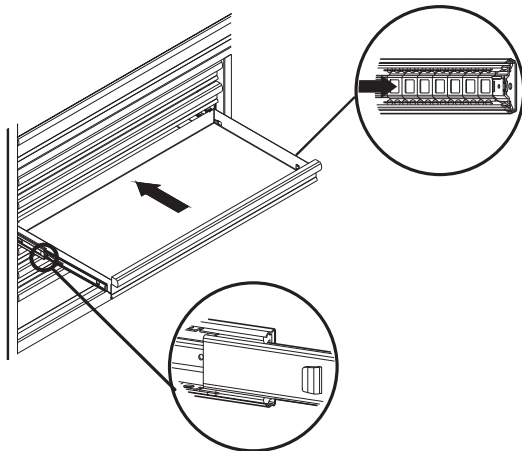

# 4 Preparing the electrical hole



**WARNING:** Be careful when putting your power cord through the hole since there may be sharp edges around the punched hole.

- A perforated hole is located in the back of the chest to allow for the use of a power cord while the chest top lid is closed.
- The perforation can be removed by pushing along the edge and twisting the disk until it pops free. Take care not to damage the cabinet around the perforation when punching the hole through.
- Use a metal file to smooth out any sharp edges around the hole to help prevent injury.

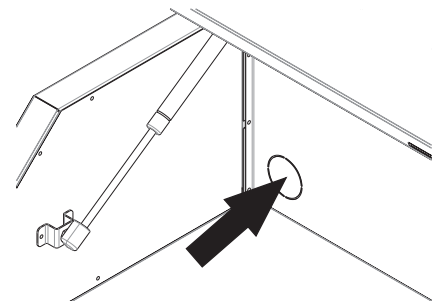

# 1 Maintaining the casters

- Grease the casters annually using high quality bearing grease.

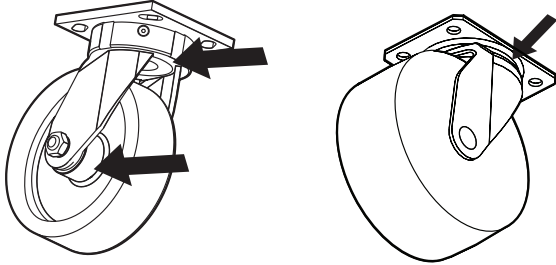

# 2 Maintaining the drawers

- Periodically clean the drawer trim and inside the drawers with a mild detergent and water.
- Remove grease and oil with a standard, nonflammable cleaning fluid.
- The use of drawer liners is recommended to protect the finish inside the drawers and make the drawers easier to clean. Drawer liners can be cleaned with soap and water.
- Lubricate the slides semi-annually with grease or equivalent.

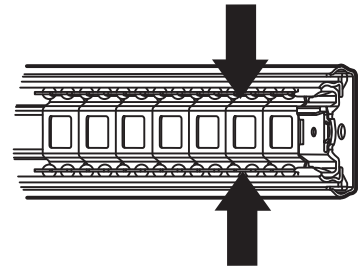

# Care and Cleaning

- This steel product has been coated with industrial powder coating for a durable finish.
- To help protect the powder coated finish, do not allow harsh chemicals (oil, grease, or other chemical) to remain on the powder coating surface.
- Use a glass cleaner (Windex® or equivalent product) to clean and maintain all surfaces of powder coating.