

Carbide Drill Bits For Concrete and Masonry

Carbide Drill Bits

Our carbide-tipped drill bits are premium quality, professional-grade tools manufactured in Germany to the highest industry standards. They are designed to meet precise tolerance requirements and incorporate proprietary features that enhance durability, drilling speed and usability. Regular and quad head bit and solid-tipped tip configurations are available. Shank styles include SDS-Plus®, SDS-Max, Spline, and Straight.

FEATURES AND BENEFITS:

Uniformly-brazed carbide inserts result in longer bit life

- Most bits contain a centering tip that facilitates easy spot drilling
- Chromium-nickel-molybdenum steel alloy body ensures hammering quality and extended service life
- Heat-treatment procedures and shot peened finish increase surface hardness, drilling speed, reduces drill bit wear and improves resistance to bending forces
- Drill bits conform to ANSI Standard B212.15

ADDITIONAL ATTRIBUTES FOR SDS-MAX, SPLINE AND SELECT SDS-PLUS BITS:

Chisel-shaped drill bit head penetrates the material and directs concrete dust into the multi-flute spiral

- Patented, high-volume, multi-flute spiral quickly channels concrete dust from the hole to improve drilling speed
- Proprietary flute geometry reduces vibration and optimizes impact energy transfers from the rotary hammer into the drill bit tip which enhances drilling speed and durability and reduces noise, stress and vibration on the operator

QUAD HEAD FEATURE:

(Available in SDS-PLUS, SDS-MAX and Spline Shank)

All the features of single cutter bits plus Quad Head dual cutter design to improve durability and drilling speed. The high volume, double helix of Quad Head bit is produced with the patented, high-performance, reinforced core flute to maximize energy transfer.

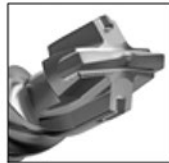

Quad Head^{dx}

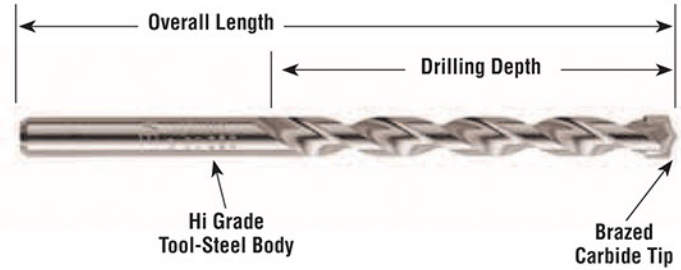

Simpson Strong-Tie® Drill Bits come in various shank styles to fit virtually any drill or rotohammer.



SDS MAX®

SDS PLUS®

Spline

Straight

'A' Taper

Drill Bits



Drill Bit Tool Selection Guide

SDS-PLUS

Fits all current and older SDS PLUS rotohammers from AEG, Black & Decker, Bosch, DeWalt, Hitachi, Hilti, Kango, Makita, Metabo, Milwaukee, Porter Cable, Ramset, Red Head, Ryobi, Skil

SDS-MAX

Fits all current and older SDS MAX rotohammers from Black & Decker, Bosch, DeWalt, Hitachi, Hilti, Kango, Makita, Metabo, Milwaukee

Spline

Fits all current and older Spline rotohammers from AEG, Black & Decker, Bosch, DeWalt, Hitachi, Kango, Makita, Metabo, Milwaukee, Ramset, Red Head, Ryobi

The following are registered trademarks:
 AEG® – AEG Power Tool Corp.
 Bosch® – Robert Bosch Power Tool Corp.
 SDS Plus® and SDS Max® are registered

trademarks of Robert Bosch Power Tool Corp.
 B&D® – Black and Decker US, Inc.
 Hilti® – Hilti of America, Inc.
 Hitachi® – Hitachi Power Tools USA, Ltd.

Kango® – Kango Wolf Power Tools, Inc.
 Makita® – Makita USA, Inc.
 Metabo® – Metabo Corp.
 Milwaukee® – Milwaukee Electric Tool Corp.

Porter Cable® – Porter Cable Corporation
 Ramset® – Illinois Tool Works
 Red Head® – Illinois Tool Works
 Ryobi® – Ryobi America Corporation

SDS-PLUS® Drill Bits For Concrete and Masonry



SDS-PLUS® Shank Bits

Dia. (in.)	Drilling Depth (in.)	Overall Length (in.)	New Model No.
5/32	2	4 1/4	MDPL01504
	4	6 1/4	MDPL01506
3/16	2	4 1/4	MDPL01804
	4	6 1/4	MDPL01806
	6	8 1/4	MDPL01808
	8	10	MDPL01810
	10	12	MDPL01812
	12	14	MDPL01814
7/32	4	6 1/4	MDPL02106
	6	8 1/4	MDPL02108
	14	16	MDPL02116
1/2	18	20	MDPL02120
	2	4 1/4	MDPL02504
	4	6 1/4	MDPL02506
1/4	6	8 1/4	MDPL02508
	9	11	MDPL02511
	12	14	MDPL02514
	14	16	MDPL02516
5/16	4	6 1/4	MDPL03106
	10	12	MDPL03112
3/8	4	6 1/4	MDPL03706
	8	10	MDPL03710
	10	12 1/4	MDPL03712
	16	18	MDPL03718
7/16	22	24	MDPL03724
	4	6 1/4	MDPL04306
1/2	10	12 1/4	MDPL04312
	4	6 1/4	MDPL05006
5/8	8	10 1/4	MDPL05010
	10	12 1/4	MDPL05012
	16	18	MDPL05018
	22	24	MDPL05024
3/4	4	6 1/4	MDPL05606
	10	12 1/4	MDPL05612
	16	18	MDPL05618
7/8	6	8	MDPL06208
	10	12	MDPL06212
	16	18	MDPL06218
	22	24	MDPL06224
1 1/16	6	8	MDPL06808
3/4	6	8	MDPL07508
	8	10	MDPL07510
	10	12	MDPL07512
	16	18	MDPL07518
1 3/16	22	24	MDPL07524
	6	8	MDPL08108
2 7/32	6	8	MDPL08408
7/8	6	8	MDPL08708
	10	12 1/4	MDPL08712
	16	18	MDPL08718
1	8	10	MDPL10010
	16	18	MDPL10018

SDS-PLUS® Shank Bit
 SDS-Plus bits use an asymmetrical-parabolic flute for efficient energy transmission and dust removal.



SDS-PLUS® Shank Bits - Retail Packs

Dia. (in.)	Drilling Depth (in.)	Overall Length (in.)	Quantity (per pack)	Model No.
5/32	4	6 1/4	25	MDPL01506-R25
	2	4 1/4	25	MDPL01804-R25
3/16	4	6 1/4	25	MDPL01806-R25
	6	8 1/4	25	MDPL01808-R25
	8	10	25	MDPL01810-R25
	10	12	25	MDPL01812-R25
	12	14	25	MDPL01814-R25
7/32	4	6 1/4	25	MDPL02106-R25
	6	8 1/4	25	MDPL02108-R25
	8 1/4	11	25	MDPL02111-R25
1/4	2	4 1/4	25	MDPL02504-R25
	4	6 1/4	25	MDPL02506-R25
	6	8 1/4	25	MDPL02508-R25
	8 1/4	11	25	MDPL02511-R25
5/16	4	6 1/4	25	MDPL03106-R25
3/8	4	6 1/4	25	MDPL03706-R25
	10	12 1/4	25	MDPL03712-R25
1/2	4	6 1/4	25	MDPL05006-R25
	10	12 1/4	25	MDPL05012-R25
5/8	6	8	20	MDPL06208-R20



SDS-PLUS® Quad Head® Drill Bits

Dia. (in.)	Drilling Depth (in.)	Overall Length (in.)	Model No.
3/4	6	8	MDPL07508Q
	10	12	MDPL07512Q
	16	18	MDPL07518Q
7/8	6	8	MDPL08708Q
	10	12	MDPL08712Q
	16	18	MDPL08718Q
1	8	10	MDPL10010Q
	16	18	MDPL10018Q
1 1/8	8	10	MDPL11210Q
	16	18	MDPL11218Q

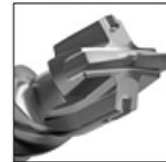

Quad Head®



Solid-tip carbide drill bit

Titen® Screw Drill Bit/Driver Product Data

Dia. (in.)	Drilling Depth (in.)	Overall Length (in.)	For Screw Dia. (in.)	Model No.
5/32	2 3/8	5	3/16	MDPL01505H
	3 1/8	6	3/16	MDPL01506H
	4 1/8	7	3/16	MDPL01507H
3/16	2 3/8	5	1/4	MDPL01805H
	3 1/8	6	1/4	MDPL01806H
	4 1/8	7	1/4	MDPL01807H

1. Product is sold individually.

Titen Screw Drill Bit/Driver - Bulk Packs

Dia. (in.)	Drilling Depth (in.)	Overall Length (in.)	For Screw Dia. (in.)	Model No.
5/32	2 3/8	5	3/16	MDPL01505H-R25
	4 1/8	7	3/16	MDPL01507H-R25
3/16	2 3/8	5	1/4	MDPL01805H-R25
	4 1/8	7	1/4	MDPL01807H-R25



Special hex adaptor (included with the Titen® Screw installation kit) allows the Titen installation tool to slide over the bit and lock in, ready to drive Titen concrete and masonry screws. Rotohammer must be in rotation-only mode before driving screws.

SDS-MAX® / Spline Drill Bits For Concrete and Masonry

SDS-MAX® and SDS-MAX Quad Head^{4x} Shank Bits

Dia. (in.)	Drilling Depth (in.)	Overall Length (in.)	Model No.
3/8	7 1/2	13	MDMC03713
	7 1/2	13	MDMX05013
1/2	15 1/2	21	MDMX05021
	7 1/2	13	MDMX05613
3/16	15 1/2	21	MDMX05621
	7 1/2	13	MDMX06213Q
5/8	15 1/2	21	MDMX06221Q
	30 1/2	36	MDMX06236Q
	15 1/2	21	MDMX06821Q
3/4	8	13	MDMX07513Q
	17	21	MDMX07521Q
	31	36	MDMX07536Q
13/16	17	21	MDMX08121Q
7/8	8	13	MDMX08713Q
	17	21	MDMX08721Q
1	8	13	MDMX10013Q
	17	21	MDMX10021Q
	31	36	MDMX10036Q
1 1/16	18	23	MDMX10623Q
1 1/8	12	17	MDMX11217Q
	17	21	MDMX11221Q
1 3/16	18	23	MDMX11823Q
1 1/4	10	15	MDMX12515Q
	18	23	MDMX12523Q
	31	36	MDMX12536Q
	12	17	MDMX13717Q
1 3/8	18	23	MDMX13723Q
	18	23	MDMX15023Q
1 3/4	18	23	MDMX17523Q
2	18	23	MDMX20023Q

Model numbers ending with "Q" denote Quad Head^{4x} bits

**SDS-MAX®
Shank Bit**

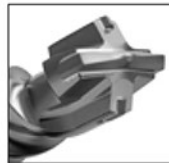

Quad Head^{4x}
Model numbers ending with "Q" denote Quad Head^{4x} bits.

Spline Shank Bits

Dia. (in.)	Drilling Depth (in.)	Overall Length (in.)	Model No.
3/8	5	10	MDSP03710
	8	13	MDSP03713
	11	16	MDSP03716
7/16	8	13	MDSP04313
1/2	5	10	MDSP05010
	8	13	MDSP05013
	11	16	MDSP05016
	17	22	MDSP05022
	22	29	MDSP05029
3/4	31	36	MDSP05036
	8	13	MDSP05613
	11	16	MDSP05616
9/16	18	23	MDSP05623
	5	10	MDSP06210
5/8	8	13	MDSP06213
	11	16	MDSP06216
	17	22	MDSP06222
	24	29	MDSP06229
	31	36	MDSP06236
1 1/16	8	13	MDSP06813
	11	16	MDSP06816
3/4	5	10	MDSP07510
	8	13	MDSP07513
	11	16	MDSP07516
	17	22	MDSP07522
	24	29	MDSP07529
7/8	31	36	MDSP07536
	11	16	MDSP08716
	17	22	MDSP08722
	31	36	MDSP08736
1	11	16	MDSP10016
	17	22	MDSP10022
	31	36	MDSP10036
1 1/8	11	16	MDSP11216
	17	22	MDSP11222
1 1/4	11	16	MDSP12516
	17	22	MDSP12522
1 3/8	11	16	MDSP13716
	17	22	MDSP13722
1 1/2	11	16	MDSP15016
	17	22	MDSP15022
1 3/4	17	22	MDSP17522
2	17	22	MDSP20022

Spline Shank Bit



Spline Shank Bits continued on the next page.

SDS-PLUS® Solid-Tip Carbide Drill Bits

Model No.	Diameter (in.)	Total length (in.)	Drilling Depth (in.)
MDPL01804S	3/16	4 1/4	2
MDPL01806S	3/16	6 1/4	4
MDPL01808S	3/16	8 1/4	6
MDPL01812S	3/16	12	10
MDPL02506S	1/4	6 1/4	4
MDPL02508S	1/4	8 1/4	6
MDPL02512S	1/4	12	10
MDPL03106S	5/16	6 1/4	4
MDPL03112S	5/16	12	10
MDPL03706S	3/8	6 1/4	4
MDPL03712S	3/8	12 1/4	10
MDPL05006S	1/2	6 1/4	4
MDPL05012S	1/2	12 1/4	10
MDPL05606S	9/16	6	4
MDPL05612S	9/16	12	10

Spline / Straight Shank Drill Bits For Concrete and Masonry



Spline Shank Quad Head^{4x} Bits

Dia. (in.)	Drilling Depth (in.)	Overall Length (in.)	Model No.
5/8	5	10	MDSP06210Q
	11	16	MDSP06216Q
	17	22	MDSP06222Q
	24	29	MDSP06229Q
	31	36	MDSP06236Q
11/16	11	16	MDSP06816Q
3/4	5	10	MDSP07510Q
	11	16	MDSP07516Q
	17	22	MDSP07522Q
	24	29	MDSP07529Q
	31	36	MDSP07536Q
7/8	11	16	MDSP08716Q
	17	22	MDSP08722Q
1	11	16	MDSP10016Q
	17	22	MDSP10022Q
	31	36	MDSP10036Q
1 1/8	11	16	MDSP11216Q
	17	22	MDSP11222Q
1 1/4	11	16	MDSP12516Q
	17	22	MDSP12522Q
	31	36	MDSP12536Q
1 3/8	11	16	MDSP13716Q
	17	22	MDSP13722Q
1 1/2	17	22	MDSP15022Q
1 3/4	18	23	MDSP17523Q
2	18	23	MDSP20023Q

Spline Shank Bit

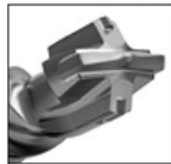

Quad Head^{4x}

Straight Shank Bits

Dia. (in.)	Drilling Depth (in.)	Overall Length (in.)	New Model No.
1/8	1 3/8	3	MDB01203
	1 1/16	3 1/2	MDB01803
3/16	4	6	MDB01806
	2 1/8	4	MDB02504
1/4	4	6	MDB02506
	10	12	MDB02512
	2 3/4	4 3/4	MDB03104
5/16	4	6	MDB03106
	4	6	MDB03706
3/8	10	12	MDB03712
	4	6	MDB04306
1/2	4	6	MDB05006
	10	12	MDB05012
	22	24	MDB05024
5/8	3 1/2	6	MDB06206
	10	12	MDB06212
	22	24	MDB06224
3/4	4	6	MDB07506
	10	12	MDB07512
7/8	4	6	MDB08706
	10	12	MDB08712
1	4	6	MDB10006
	10	12	MDB10012

Straight Shank Bit



1. Bits have recessed shank to fit Titen® screws and other masonry screw installation tools. They also work in three-jaw style chucks.

Straight Shank Bits - Single Bit Retail Blister Packs - Cartons of 25

Dia. (in.)	Length (in.)	Model No.
5/32	3 1/2	MDB15312-RB
	4 1/2	MDB15412-RB
3/16	3 1/2	MDB18312-RB
	4 1/2	MDB18412-RB
	5 1/2	MDB18512-RB



Drill Bits

'A' Taper Shank Bits

Dia. (in.)	Drilling Depth (in.)	Overall Length (in.)	Model No.
1/2	7	9	MDA05007
5/8	7	9	MDA06207
3/4	16	18	MDA07516

'A' Taper Bit



Straight Shank Bits - Retail Packs

Dia. (in.)	Drilling Depth (in.)	Overall Length (in.)	Quantity (per pack)	New Model No.
1/8	1 3/8	3	25	MDB01203-R25
	1 1/16	3 1/2	25	MDB01803-R25
3/16	4	6	25	MDB01806-R25
	2 1/8	4	25	MDB02504-R25
1/4	4	6	25	MDB02506-R25
	10	12	25	MDB02512-R25
5/16	2 3/4	4 3/4	25	MDB03104-R25
	4	6	25	MDB03106-R25
3/8	4	6	25	MDB03706-R25
1/2	4	6	25	MDB05006-R25
5/8	4	6	20	MDB06206-R20