

Ceramic Heater

With Thermostat

Owner's Manual



English

Model
HPG15-M

Hunter
SINCE 1886

TABLE OF CONTENTS

Introduction.....	3
Safety and Warnings.....	3
Important Instructions.....	3
Parts of the Heater.....	5
Operating Instructions.....	5
Pilot Light.....	5
Tip-over Switch.....	6
Thermal Protection System.....	6
Maintenance.....	6
Storage.....	6
Trouble Shooting.....	6
Technical Support.....	7
Warranty.....	7

INTRODUCTION

Thank you for choosing the Hunter Ceramic Heater. This manual gives you complete instructions for using your heater.

SAFETY AND WARNINGS

READ CAREFULLY BEFORE ATTEMPTING TO ASSEMBLE, INSTALL, OPERATE OR MAINTAIN THE PRODUCT DESCRIBED. PROTECT YOURSELF AND OTHERS BY OBSERVING ALL SAFETY INFORMATION. FAILURE TO COMPLY WITH INSTRUCTIONS COULD RESULT IN PERSONAL INJURY AND/OR PROPERTY DAMAGE!
SAVE THESE INSTRUCTIONS FOR REFERENCE.

NOTE: When switching on the appliance for the first time, allow it to run at full power for approximately two hours to get rid of the unpleasant odour. Make sure that the room in which the appliance is located is well ventilated during this operation. It is normal for the appliance to emit small cracking sounds when you turn it on the first time. Do not be alarmed.

IMPORTANT INSTRUCTIONS

When using electrical appliances, basic precautions should always be followed to reduce the risk of fire, electric shock, and injury to persons or property, including the following:

1. Read all instructions before using this heater.
2. This heater is hot when in use. To avoid burns, do not let bare skin touch hot surfaces. Use handles when moving this heater. Keep combustible materials, such as furniture, pillows, bedding, papers, clothes and curtains at least 3' (0.9 m) from the front and top of the heater and keep them away from the sides and rear. Keep the rear grille away from walls or drapes so as not to block the air intake.
3. Extreme caution and supervision is necessary when any heater is used by or near children or pets, and whenever the heater is left operating and unattended.
4. Always unplug heater when not in use.
5. Do not operate heater with a damaged cord or plug or after the heater malfunctions, or has been dropped or damaged in any manner. Discard heater or return to an authorized service facility for examination and/or repair.
6. Do not use outdoors.
7. This heater is not intended for use in bathrooms, laundry areas and similar indoor locations. Never locate heater where it may fall into a bathtub or other water container.
8. Do not run cord under carpeting. Do not cover cord with throw rugs, runners, or similar coverings. Do not route cord under furniture or appliances. Arrange cord away from traffic area and where it will not be tripped over.
9. To disconnect the heater, turn control to OFF, then remove the plug from the outlet.
10. Do not insert or allow foreign objects to enter any ventilation or exhaust opening as this may cause an electric shock or fire, or damage to the heater.



11. To prevent a possible fire, do not block air intakes or exhaust in any manner. Do not use on soft surfaces, like a bed, where openings may become blocked.

12. A heater has hot and arcing or sparking parts inside. Do not use it in areas where gasoline, paint, or flammable liquids are used or stored.

13. Use this heater only as described in this manual. Any other use not recommended by the manufacturer may cause fire, electric shock, injury to persons, or other damage to property.

14. Ensure the heater is on a stable, secure surface to eliminate the potential of tipping it over.

15. To prevent overload and blown fuses, be sure that no other appliance is plugged into the same outlet (receptacle) or into another outlet (receptacle) wired into the same circuit.

16. It is normal for the heater's plug and cord to feel warm to the touch. A plug or cord which becomes hot to the touch or becomes distorted in shape may be a result of a worn electrical outlet. Worn outlets or receptacles should be replaced prior to further use of the heater. Plugging heater into a worn outlet/receptacle may result in overheating of the power cord or fire.

17. Always plug heaters directly into a wall outlet/receptacle. Never use with an extension cord or relocatable power tap (outlet/power strip).

18. Check your heater cord and plug connections. A loose fitting outlet can cause the plug to overheat or cause a fire. Be sure plug fits tight in the outlet. Check frequently during use to make sure plug and outlet are not hot. If so, discontinue using heater and have outlet replaced by a qualified electrician.

19. Note: Heaters draw more current than small appliances, overheating of the outlet may occur even if it has not occurred with the other appliances.

20. Check that neither the appliance nor the power cable has been damaged in any way during transportation.

21. Make sure that no pieces of polystyrene or other packaging material have been left between elements of the appliance. It may be necessary to clean the appliance.

22. Connect to properly polarized outlets only.

23. This appliance has a polarized plug (one blade is wider than the other). To reduce the risk of electric shock, this plug is intended to fit in a polarized outlet only one way. If the plug does not fit fully in the outlet, reverse the plug. If it still does not fit, contact a qualified electrician. Do not attempt to defeat this safety feature.

CAUTION: TO PREVENT ELECTRIC SHOCK, MATCH WIDE BLADE OF PLUG TO WIDE SLOT, FULLY INSERT.

DANGER-HIGH TEMPERATURES MAY BE GENERATED UNDER CERTAIN ABNORMAL CONDITION. DO NOT PARTIALLY OR FULLY COVER OR OBSTRUCT THE FRONT OF THIS HEATER.

**FOR HOUSEHOLD USE ONLY
SAVE THESE INSTRUCTIONS**



PARTS OF THE HEATER

Parts of the heater

- | Parts of the heater | Symbols |
|-----------------------|--------------------------------------|
| 1. Thermostat Control | ⏻ Power Off |
| 2. Pilot Light | 🔥 Low Heat Setting |
| 3. Power Control | 🔥 High Heat Setting |
| 4. Safety Grille | 🌀 Low Heat Setting with Oscillation |
| (Figure 1) | 🌀 High Heat Setting with Oscillation |

(Figure 2)

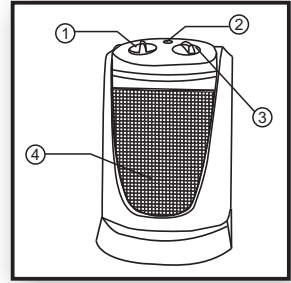

Figure 1

OPERATING INSTRUCTIONS

- Set the heater on a dry, level surface.
- Make sure the Power Control is in **⏻** (off) position. Plug cord into any standard 120 V AC outlet. **(Figure 2)**
- Set the Thermostat Control all the way to **⊕** (maximum). **(Figure 3)**
- Set the Power Control to **🔥** for fast warm up of a room. Once the room is comfortable, select **🔥** to reduce electrical consumption and to prevent the room from becoming too warm. **(Figure 2)**
- Your heater is equipped with an oscillation feature. If you want to obtain a wider area of heat circulation, turn the Power Control to **🌀** or **🌀**. **(Figure 2)**
- This heater is equipped with a thermostat function to control the temperature output. To increase the heat output, turn the Thermostat Control clockwise to **⊕**. To reduce the heat output, turn the Thermostat Control counterclockwise to **⊖**. **(Figure 3)**

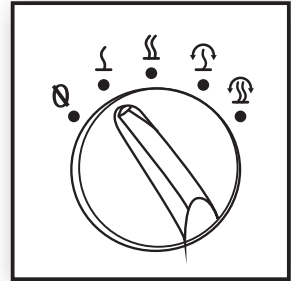

Figure 2

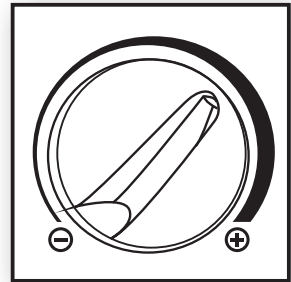

Figure 3

PILOT LIGHT

This fan heater is equipped with a Pilot Light, which glows whenever the heater is plugged in and turned on. It will continue to glow even if the thermostat has cycled the heating elements off. This feature is to prevent you from being unaware that the heater is in operation.

TIP-OVER SWITCH

This heater is equipped with a safety tip-over switch, which is located on the bottom of the heater. This feature cuts the main power to the heater if it gets knocked over. If the heater does tip over, simply stand it upright in order to resume operation.

THERMAL PROTECTION SYSTEM

This heater includes an Overheat Protection System that shuts the unit off when the unit reaches extremely high temperatures. If this occurs, turn the heater off and unplug it. Do not attempt to repair or adjust any electrical or mechanical functions on this unit.

MAINTENANCE

1. Turn the Power Control to **0** (off) position and unplug the heater before moving or cleaning.
2. Interior dust can often be removed by using a vacuum cleaner with a crevice tool attachment.
3. To clean the enclosure, use a clean, soft and lightly damp cloth to gently wipe off the dirt from the surface of the unit. Be sure not to wet the Heating Element and the switches. Allow the unit to dry completely before use.
4. Do not use cleaning liquid or other chemicals to spray on the unit.

STORAGE

1. Perform the cleaning procedures described above.
2. Wipe all parts dry.
3. Pack the heater in a plastic bag and store it in a cool, dry place. We recommend that you store the heater in its original carton.

TROUBLE SHOOTING

If your heater fails to operate:

- Make sure the electrical outlet or circuit breaker is working.
- Check for obstructions. If you find an obstruction, turn the heater OFF, and UNPLUG THE UNIT. Carefully remove the obstruction and follow the reset instructions.
- The thermostat might be set too low. Turn the thermostat knob clockwise until the heater restarts.

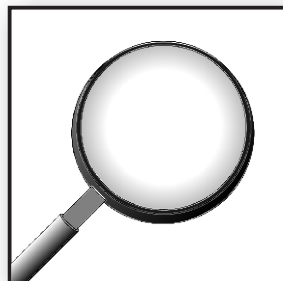
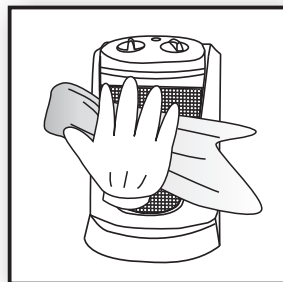

TECHNICAL SUPPORT

If you have any additional questions or problems with your Hunter Heater, please call:

USA: 1-888-880-3267

Hours of operation are from 8:00 am to 5:00 pm Monday to Friday, Eastern Time. You may also reach us online at www.HunterHomeComfort.com.



WARRANTY

Hunter Home Comfort makes the following limited warranty to the user or consumer purchaser of this Hunter heater:

If your Hunter heater motor fails at any time within three years after the date of sale to you due to a defect in material or workmanship, labor to repair the defect will be provided free of charge at our nearest service center or our Service Department in Marietta, Georgia. You will be responsible for labor costs after this three years period. The foregoing limited warranty applies only to the motor itself, and does not apply to electronic controls such as remote controls, remote control receivers or transmitters used in conjunction with the motor. These electronic control items are included in the one year limited warranty below.

If any part of your Hunter heater other than the motor fails at any time within one year after the date of sale to you due to a defect in material or workmanship, we will repair or, at our option, replace the defective part free of charge for parts and labor performed at our nearest service center or at our Service Department in Marietta, Georgia.

IF THE USER OR CONSUMER PURCHASER CEASES TO OWN THE HEATER, THIS WARRANTY AND ANY IMPLIED WARRANTY WHICH THEN REMAINS IN EFFECT, INCLUDING BUT NOT LIMITED TO ANY IMPLIED WARRANTY OF MERCHANTABILITY OR FITNESS FOR A PARTICULAR PURPOSE, ARE VOIDED. NO WARRANTY, EXPRESSED OR IMPLIED, INCLUDING ANY WARRANTY OF MERCHANTABILITY OR FITNESS FOR A PARTICULAR PURPOSE, IS MADE IN RESPECT TO THE GLASS GLOBES OR LIGHT BULBS OR THE FINISH ON ANY METAL PORTION OF THE HEATER. THIS WARRANTY IS IN LIEU OF ALL OTHER EXPRESS WARRANTIES. THE DURATION OF ANY IMPLIED WARRANTY, INCLUDING, BUT NOT LIMITED TO ANY IMPLIED WARRANTY OF MERCHANTABILITY OR FITNESS FOR A PARTICULAR PURPOSE, IN RESPECT TO ANY HUNTER HEATER MOTOR OR OTHER HEATER PART, IS EXPRESSLY LIMITED TO THE PERIOD OF THE EXPRESS WARRANTY SET FORTH ABOVE FOR SUCH MOTORS AND OTHER PARTS.

This warranty is voided if your Hunter heater is not purchased and used in the USA.



This warranty excludes and does not cover defects, malfunctions or failures of any Hunter heater which were caused by repairs by persons not authorized by us, use of parts or accessories not authorized by us, mishandling, improper installation, modifications, or damage to the Hunter heater while in your possession, or unreasonable use, including failure to provide reasonable and necessary maintenance.

To obtain servicing, contact the nearest Hunter authorized service center or the Hunter Home Comfort Service Department, 2260 Northwest Pkwy., Suite I, Marietta, Georgia 30067. Please contact us before shipping your heater to us. If we authorize you to ship it to us, you will be responsible for all insurance and freight or other transportation charges to our factory service center. We will return your Hunter heater freight prepaid. Your heater should be properly packed to avoid damage in transit since we will not be responsible for any such damage. Proof of purchase is required when requesting warranty service. The purchaser must present sales receipt or other document that establishes proof of purchase.

IN NO EVENT SHALL HUNTER HOME COMFORT BE LIABLE FOR CONSEQUENTIAL OR INCIDENTAL DAMAGES.

SOME STATES DO NOT ALLOW LIMITATIONS ON HOW LONG AN IMPLIED WARRANTY LASTS OR THE EXCLUSION OR LIMITATION OF INCIDENTAL OR CONSEQUENTIAL DAMAGES SO THE ABOVE LIMITATION MAY NOT APPLY TO YOU. THE WARRANTY GIVES YOU SPECIFIC LEGAL RIGHTS AND YOU MAY ALSO HAVE OTHER RIGHTS WHICH VARY FROM STATE TO STATE.



Hunter
SINCE 1886

2260 Northwest Pkwy., Suite I, Marietta, GA 30067

Hunter is a trademark of the Hunter Fan Company and is used under license to Hunter Home Comfort.

Printed in China