

Solid Vinyl GutterCover



Easy Installation Instructions

CAUTION: Wear safety glasses and leather gloves while installing this product. Always exercise appropriate care when working from a ladder. Follow all tool and ladder manufacturer's instructions and safety recommendations.

Tools & Safety Equipment Needed:

Safety glasses, leather gloves, tin snips and a ladder.

- 1** Make sure you clean your gutters and downspouts before installation of the Solid Vinyl Gutter Cover. You should flush the entire gutter system with a hose, making sure water is flowing freely from the bottom of the downspout without any water backing up in the gutter.

Using the **Gutter Getter®** cleaning scoop (with flexible conforming tip) to make cleaning easy.

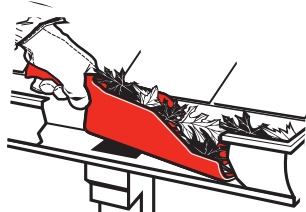

- 2** **Fits standard 4 in., 5 in. and 6 in. gutters.** Before installing the first gutter guard, notch the back edge (A) and the front edge (B). Next, bend the end section down to create an end cap. This will help prevent birds and other animals from nesting in the gutter.

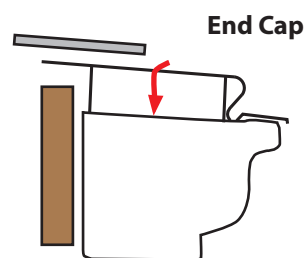
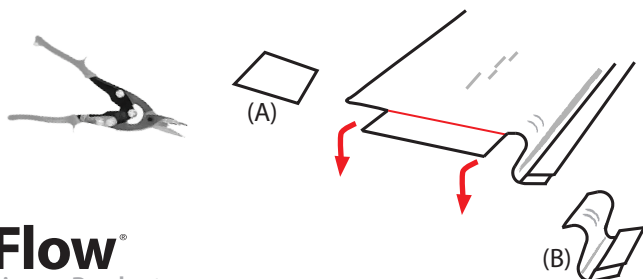

3 Starting at one end of the gutter, install the gutter guard by slightly lifting the shingles and sliding the gutter cover under the shingle. If the starter row of shingles are fastened to the roof deck slide the guard between the layers. (Note: Check your local building codes for any special installation requirements) Pull the front edge forward to engage with the lip of the gutter. If necessary a flathead screwdriver can be used to help pull the guard forward.

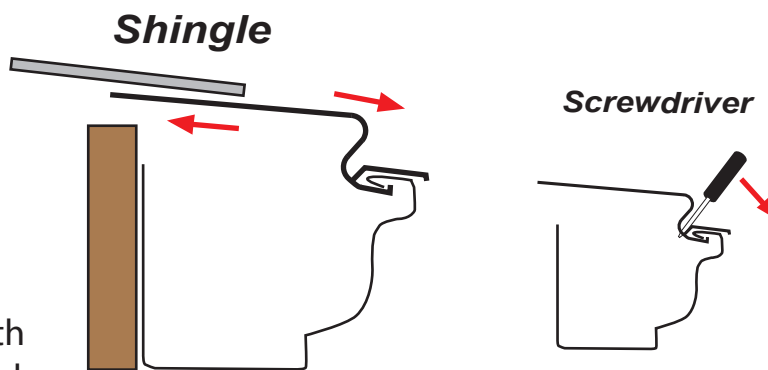

4 To overlap the gutter covers, cut a notch from the front edge. As you install each section simply overlap the end with the previous section.

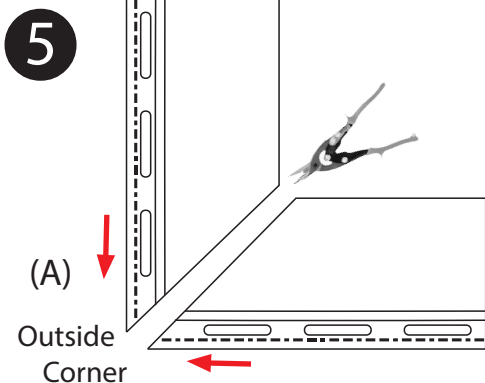
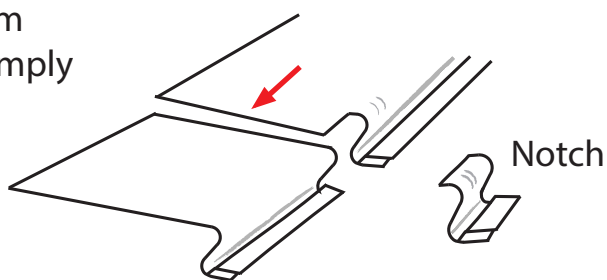

For outside corners (A) or inside corners (B), mitre cut both adjoining sections. Notch the front edge of one section to create an overlap.

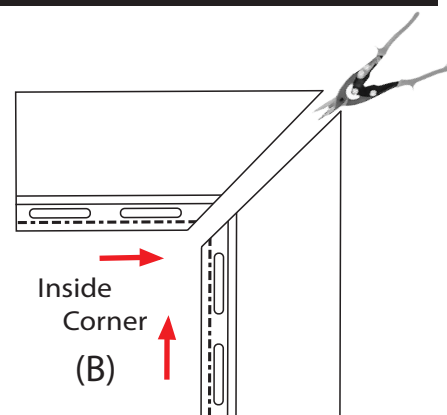

6 At the end of the gutter, cut the last gutter cover an extra 2 inches longer than the end of the gutter. Cut a notch on the back edge of the gutter guard (A) and on the front edge (B). Bend the end section down to create the end cap.

