

BELLEZZA WATERFALL

PARTS LIST

1 – PUMP

3 – ANCHORS WITH SCREWS

1 – MOUNTING

BRACKET

1 – LOW VOLTAGE LIGHT

3 – WOOD SCREWS

TOOLS REQUIRED

LEVEL

PENCIL

PHILLIPS SCREWDRIVER

MOUNTING THE BELLEZZA

Note: This wall bracket can be mounted without studs. If you encounter a stud while mounting the wall bracket, use the provided wood screw. Use easy anchors for the holes without studs. Each easy anchor holds up to 50lbs.

1. HOLD MOUNTING BAR TO THE WALL (THE TOP OF THE MOUNTING BAR SHOULD ANGLE AWAY FROM THE WALL AND THE HOLES WILL BE TOWARD THE WALL). MARK CENTER HOLE ON THE WALL (THE TOP OF THE BELLEZZA WILL BE APPROXIMATELY 17" ABOVE THE CENTER HOLE AFTER MOUNTING). FIGURE A
2. TO INSTALL EASY ANCHOR, GENTLY TAP THE TIP INTO THE DRYWALL, AND SLOWLY SCREW THE ANCHOR THE REST OF THE WAY. BE CAREFULL NOT TO OVER TIGHTEN AS SHOWN IN FIGURE B.
3. MOUNT THE WALL BRACKET WITH THE CENTER SCREW INTO THE EASY ANCHOR FROM STEP 3.
4. LEVEL THE MOUNTING BRACKET AND MARK HOLES OF THE SIDES. FIGURE C
5. TURN THE BRACKET 90 DEGREES, INSTALL SIDE ANCHORS. FIGURE D
6. TURN BRACKET BACK TO LEVEL AND INSTALL SCREWS, TIGHTEN ALL THREE SCREWS. FIGURE E
7. LIFT UNIT INTO PLACE AND ENGAGE BRACKETS BY LOWERING THE BELLEZZA ONTO THE WALL BRACKET. FIGURE F



FIGURE A



FIGURE B

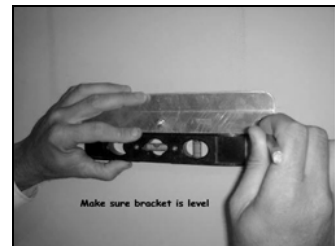

FIGURE C

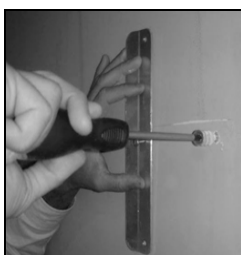

FIGURE D



FIGURE E



FIGURE F

TURN YOUR BELLEZZA ON

1. AFTER MOUNTING YOUR BELLEZZA TO THE WALL, FILL WITH WATER.
NOTE: WATER LEVEL MUST BE MAINTAINED AT LEAST 1" ABOVE PUMP. IF WATER LEVEL DROPS BELOW TOP OF PUMP, DAMAGE TO THE PUMP MAY OCCUR.
2. PLUG BOTH LIGHT AND PUMP INTO AN OUTLET.
3. ENJOY!

NOTES:

ONLY THE LIGHT PORTION IS TO BE SUBMERGED INTO THE WATER. THE TRANSFORMER, PLACED ON THE BACK OF THE UNIT, CANNOT BE PUT IN THE WATER AND MUST BE LEFT OUT OF THE RESERVOIR.

CARE AND MAINTENANCE

FILL THE BASIN WITH WATER AND PLUG INTO A STANDARD ELECTRICAL OUTLET.

DO NOT ATTEMPT TO MOVE THE DISPLAY ONCE IT IS FILLED WITH WATER. EMPTY THE BASIN BEFORE REMOVING FROM THE WALL. MAINTAIN THE WATER LEVEL BY FILLING TO 2" BELOW THE TOP EDGE OF THE BASIN ABOUT ONCE A WEEK. WATERFALLS THAT ARE PLACED NEAR AIR CONDITIONING VENTS AND INTAKES WILL EVAPORATE AT A FASTER RATE. DO NOT OPERATE IF LOW ON WATER. IF HARD WATER IS A PROBLEM IN YOUR AREA, THE USE OF DISTILLED WATER WILL GUARANTEE THE BEST RESULTS. IT IS RECOMMENDED TO DRAIN THE RESERVOIR ABOUT ONCE EVERY THREE MONTHS AND REFILL WITH CLEAN WATER. BE CAREFUL NOT TO GET CLEANING AGENTS INTO THE WATER.

LIMITED WARRANTY

Bluworld of Water warrants this product to be free from defects in material and workmanship for one (1) year from the original date of purchase by the consumer. This warranty is limited to the replacement of defective parts or components. In addition, the submersible pump is warranted by its manufacturer for a period of one (1) year against defective material and workmanship. All claims must be presented to the manufacturer along with the original purchase receipt to verify a valid warranty period. Bluworld of Water will not be responsible or liable for any damage caused by negligence or misuse, goods damaged in transit, or improper set up, installation or assembly by the purchaser. Bluworld will, upon written notification thereof, take commercially reasonable steps to correct such defects, at Bluworld sole option, by suitable repair, replacement, or refund. Please read all instructions carefully. *Notice: Glass mirrors and plastics have prevalent characteristics such as bubbles, mirror rubs, slight discolorations, blurs, and hairline scratches. These are to be expected, as they are inherent qualities that meet or exceed federal specifications DD-G-451D.*

THANK YOU FOR PURCHASING A BLUWORLD™ WATERFEATURE. OUR ARTISTIC DESIGNS AND SUPERIOR WORKMANSHIP BRING WATERFEATURES DESIGNED FOR A LONG-TERM DECORATIVE EFFECT, TO PRODUCE RELAXING SOUNDS AND TO PROMOTE A HEALING ENVIRONMENT. WE HOPE YOU WILL ENJOY YOUR DESIGNER WATERFEATURE.

SHOULD YOU EXPERIENCE ANY PROBLEMS, PLEASE DO NOT RETURN TO RETAILER.

CALL 1-888-499-5433 AND ASK FOR CUSTOMER SERVICE FOR A QUICK SOLUTION TO YOUR PROBLEM.