



**Phoenix™ 3.5" Digital Wireless Security Video Monitor**  
**Phoenix™ 3,5po Moniteur vidéo sécurité**  
**sans fil numérique**



**Manual / Manuel**



**CAUTION:** Keep small parts away from children.

**ATTENTION:** Gardez les petites pièces hors de la portée des enfants.

# SAFETY INSTRUCTIONS



**CAUTION: Keep small parts away from children.**



**Strangulation Hazard:** Children can become entangled in cords. Power cords should be kept more than 3 feet away from a child's reach at all times.



**This product is not a toy and should be kept out of children's reach.**



**This product contains small parts. Exercise care when unpacking and assembling the product.**



**Read and Keep Instructions:** All the safety and operating instructions should be read before the video monitor is operated.



**This product cannot replace responsible adult supervision.**

**Water and Moisture:** This product is designed for indoor use only. The unit should not be exposed to rain, moisture, dripping or splashing. No objects filled with liquid should be placed on top of, or beside the product, such as a glass or vase. This item should not be used near water.

**Non-Use Periods:** Always unplug the AC adapters from the wall outlets during long periods of non-use.

**Ventilation:** This monitor should not be used on a bed, sofa, rug or similar surface that may block the ventilation openings, or be placed in an enclosed area, such as a bookcase or drawer that may impede air flow.

**Keep Away from Sources of Heat:** This unit should not be exposed to direct heat sources such as a candle, fireplace, radiator, heat register, stove or other appliance that emits heat. The unit should not be left in direct sunlight.

**Power Source:** This unit should only be used with the AC power adapters included in this package (rated 6V 800mA).

**Damage Requiring Service:** This unit should be serviced by qualified personnel only when:

- a. Objects have fallen or liquid has been spilled into the product
- b. The units have been exposed to rain
- c. The units do not appear to operate normally or exhibits a distinct change in performance
- d. The units have been dropped or the enclosure damaged



This device complies with part 15 of the FCC Rules. Operation is subject to the following two conditions:

- (1) This device may not cause harmful interference.
- (2) This device must accept any interference received, including interference that may cause undesired operation.

## **FCC WARNING**

This equipment has been tested and found to comply with the limits for a Class B digital device, pursuant to Part 15 of the FCC Rules. These limits are designed to provide reasonable protection against harmful interference in a residential installation.

This equipment generates, uses and can radiate radio frequency energy and, if not installed and used in accordance with the instructions, may cause harmful interference to radio communications. However, there is no guarantee that interference will not occur in a particular installation. If this equipment does cause harmful interference to radio or television reception, which can be determined by turning the equipment off and on, the user is encouraged to try to correct the interference by one or more of the following measures:

- Reorient or relocate the receiving antenna.
- Increase the separation between the equipment and the receiver.
- Connect the equipment into an outlet different from that to which the receiver is connected.
- Consult the dealer or an experienced radio/TV technician for help.

## **IC STATEMENT / DÉCLARATION IC:**

This Class B digital apparatus complies with ICES-003. / Cet appareil numérique de la classe B est conforme à la norme NMB-003 du Canada.

This device complies with Industry Canada licence-exempt RSS 210 standard(s). Operation is subject to the following two conditions: (1) this device may not cause interference, and (2) this device must accept any interference, including interference that may cause undesired operation of the device.

Le présent appareil est conforme aux CNR 210 d'Industrie Canada applicables aux appareils radio exempts de licence. L'exploitation est autorisée aux deux conditions suivantes : (1) l'appareil ne doit pas produire de brouillage, et (2) l'utilisateur de l'appareil doit accepter tout brouillage radioélectrique subi, même si le brouillage est susceptible d'en compromettre le fonctionnement.

Changes or modifications not expressly approved by the party responsible for compliance could void the user's authority to operate the equipment.



Please visit our website at [www.defender-usa.com](http://www.defender-usa.com) for information about your product's warranty.

We take quality very seriously. That is why all of our products come with a one-year warranty from the original purchase date against defects in workmanship and materials. If you have warranty or support issues, please contact us using any of the following methods:

**Web:** [www.defender-usa.com](http://www.defender-usa.com)

**Support:** [www.defender-usa.com/support](http://www.defender-usa.com/support)

**DEFENDER Canada**  
4080 Montrose Road  
Niagara Falls, ON  
Canada L2H 1J9

**DEFENDER USA**  
60 Industrial Parkway #Z64  
Cheektowaga NY  
USA 14227

#### Warranty Terms

1. DEFENDER® products are guaranteed for a period of one year from the date of purchase against defects in workmanship and materials. This warranty is limited to the repair, replacement or refund of the purchase price at DEFENDER's option.
2. This warranty becomes void if the product shows evidence of having been misused, mishandled or tampered with contrary to the applicable instruction manual.
3. Routine cleaning, normal cosmetic and mechanical wear and tear are not covered under the terms of this warranty.
4. The warranty expressly provided for herein is the sole warranty provided in connection with the product itself and no other warranty, expressed or implied is provided. DEFENDER assumes no responsibilities for any other claims not specifically mentioned in this warranty.
5. This warranty does not cover the shipping cost, insurance or any other incidental charges.
6. You **MUST** contact DEFENDER at [www.defender-usa.com/support](http://www.defender-usa.com/support) before sending any product back for repair. You will be sent a Return Authorization form with return instructions. When returning the product for warranty service, please pack it carefully in the original box with all supplied accessories, and enclose your original receipt or copy, and a brief explanation of the problem (include RA #).
7. This warranty is valid only in Canada and the continental U.S.
8. This warranty cannot be re-issued.

# TABLE OF CONTENTS

SAFETY INSTRUCTIONS .....	2
FCC STATEMENT .....	3
WARRANTY .....	4
WHAT'S INCLUDED .....	7
BUTTONS AND CONNECTIONS - MONITOR .....	8
BUTTONS AND CONNECTIONS - CAMERA .....	10
SETUP .....	11
SD card installation .....	11
Battery installation .....	11
Connecting Power to the Monitor / Charging Battery .....	12
Connecting Power to the Camera .....	12
Get the Most Out of Your Rechargeable Battery .....	13
Screen Icons .....	14
OPERATION .....	15
Turn the Monitor ON/OFF .....	15
Pairing the Camera(s) and Monitor .....	15
Placement of the Monitor .....	16
Placement of the Camera .....	16
Mounting the Camera on a Tabletop Safely .....	16
Mounting the Camera on a Wall Safely .....	16
Night Vision .....	17
Adjusting the Camera Angle - PTZ .....	17
Volume .....	18
Using the 2-Way Talk Intercom .....	18
Using the Zoom function .....	19
Changing the camera view .....	19
Setting an Alarm Alert - Part 1 .....	20
Setting an Alarm Alert - Part 2 .....	20
Using Power Save Mode .....	21
Setting the Brightness .....	21
Taking a picture .....	22
Recording Video .....	23
Viewing Saved Photos & Videos - Monitor .....	24
Viewing/Deleting VIDEO - Monitor .....	25
Viewing Saved Photos & Videos - Computer .....	25

# TABLE OF CONTENTS

Viewing Saved Photos & Videos - Computer .....	26
Settings .....	26
SD Card formatting .....	27
Firmware update (unused) .....	27
Factory reset .....	28
Setting the date/time .....	29
Sound Sensitivity LED ring.....	30
180° Image Flip .....	31
Contacting Customer Support.....	31
<b>TROUBLESHOOTING.....</b>	<b>32</b>
<b>MAINTENANCE.....</b>	<b>32</b>
<b>SPECIFICATIONS.....</b>	<b>33</b>

# WHAT'S INCLUDED

- Night Vision PTZ Camera
- Video Monitor
- Rechargeable Battery
- 2 Power Adapters
- Mounting Hardware
- Quick Start Guide
- 1 Year Warranty
- Lifetime Customer Support



This product is intended for indoor applications only.

This product contains small parts. Exercise care when unpacking and assembling the product.

DEFENDER® does not endorse any DEFENDER® products for illegal activities. DEFENDER® is not responsible or liable in any way for any damage, vandalism, theft or any other action that may occur while a DEFENDER® product is in use by the purchaser.

We reserve the right to change models, configuration, or specifications without notice or liability. Product may not be exactly as shown.

©2013 DEFENDER®. All rights reserved. DEFENDER®, the DEFENDER® logo and other DEFENDER® marks may be registered. All other Trademarks are the property of their respective owners.

# MONITOR

## FRONT / SIDE

- 1. LOCK / UNLOCK BUTTON**  
Disables ALL function buttons in the LOCK position
- 2. LCD SCREEN**
- 3. 2-WAY TALK**  
Press and hold to talk, release to listen
- 4. PAN & TILT BUTTON**
- 5. MENU**
- 6. MICROPHONE**
- 7. COLOR-CHANGING LED RING**  
Changes color with sound intensity/battery charge
- 8. SELECTION / ZOOM BUTTON**
- 9. DIRECTIONAL ARROWS / VOLUME CONTROL**

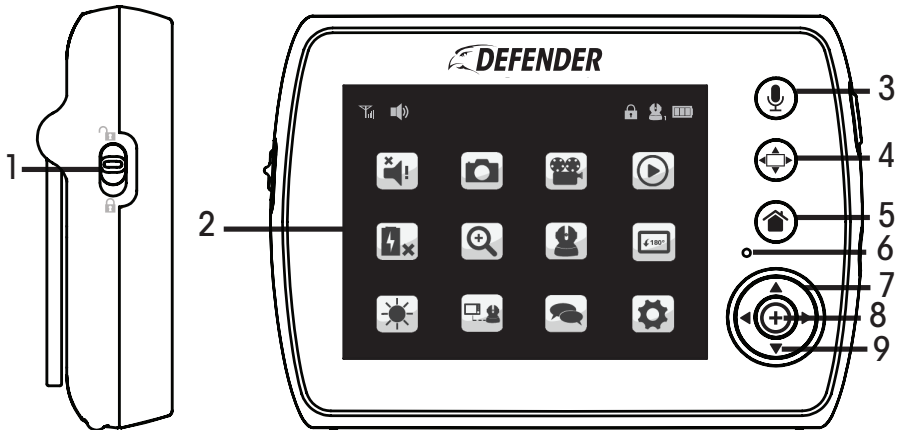



## BACK / SIDE

1. POWER & SCREEN ON/OFF
2. POWER INPUT
3. ANTENNA  
Extend to improve signal
4. TABLE STAND
5. SPEAKER
6. BATTERY COMPARTMENT

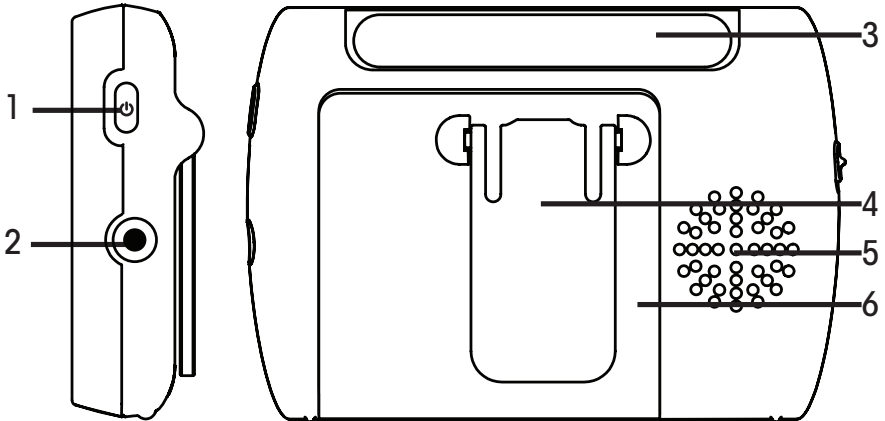

# CAMERA

1. PTZ CAMERA
2. MICROPHONE
3. POWER LED
4. NIGHT VISION LIGHT SENSOR
5. ANTENNA
6. POWER INPUT
7. POWER ON/OFF
8. SPEAKER

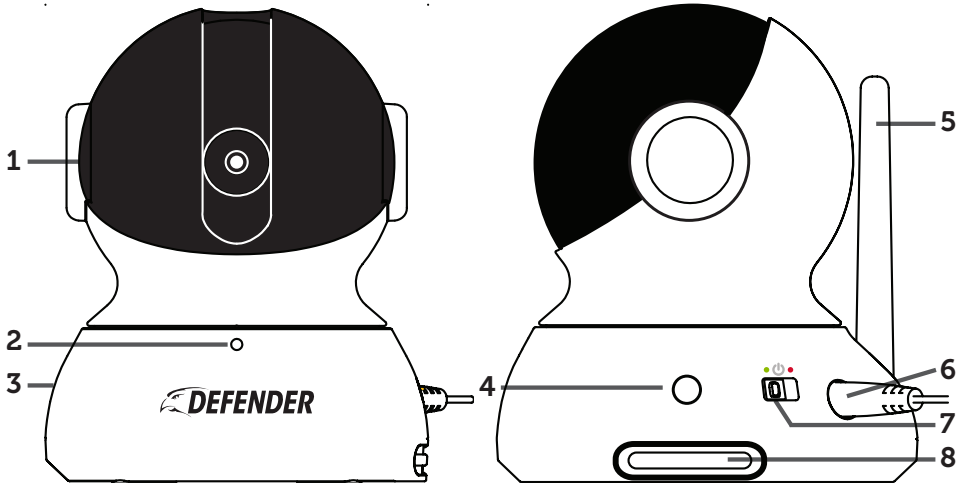

## LET'S GET STARTED!

### SD Card Installation

1. Gently remove the BATTERY COMPARTMENT COVER on the back of the monitor by sliding down.
2. Slide the silver bracket to the right to unlock the MicroSD card holder. Remove the MicroSD card from the SD card adapter and insert the MicroSD card in the bracket as shown - slide the silver bracket to the left to lock the MicroSD card into place.

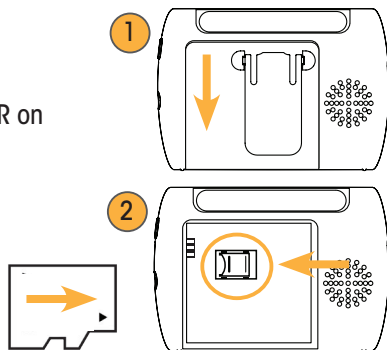

**NOTE:** The monitor can support a Micro SD card UP TO 32GB.

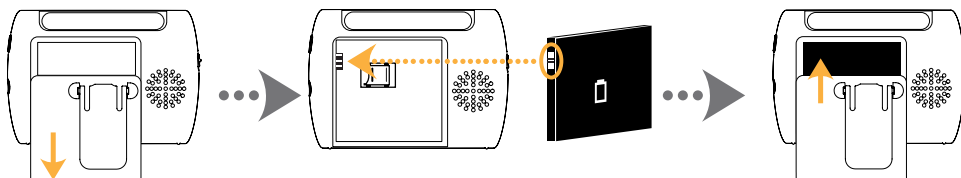

### Battery Installation

1. Gently remove the BATTERY COMPARTMENT COVER on the back of the monitor by sliding down.
2. Insert the battery; the battery connectors on the battery should line up with the connectors inside the battery compartment.
3. Slide the BATTERY COMPARTMENT COVER back into place.
4. For extended periods of non-use, please remove battery from monitor.



# SETUP

## Connecting Power to the Monitor / Charging Battery

1. Connect the small end of power adapter marked **MONITOR**  into the DC input on the side of the monitor as shown in the diagram. Connect the other end of the adapter into an available wall outlet. For safety reasons, **ONLY** use the adapters included in the package.
2. Press and hold the **POWER**  button on the side of the monitor to turn the monitor ON.
3. The icon in the top right corner of the main screen will show you the battery power status.
4. The LED Ring on the front of the monitor also indicates the battery power status.

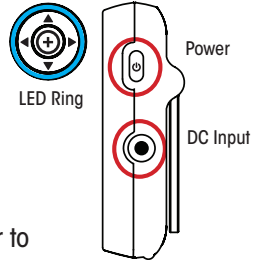



**SOLID BLUE = BATTERY FULLY CHARGED**  
**QUICK FLASHING BLUE = BATTERY LOW**

**SLOW FLASHING BLUE = BATTERY CHARGING**  
**FLASHING PINK = PAIRING UNSUCCESSFUL**



## Connecting Power to the Camera

1. Connect the small end of the power adapter marked **CAMERA**  into the DC input on the back of the camera base as shown in the diagram. For safety reasons, **ONLY** use the adapters included in the package.
2. On the side of the camera, slide the **POWER** switch  **LEFT** to the ON position. The **POWER LED** will light up.

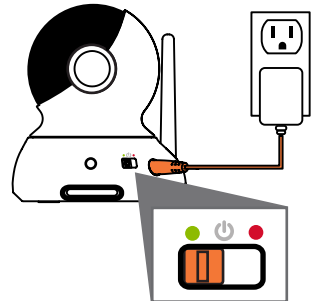

## Get the Most Out of Your Rechargeable Battery



- Fully charge battery (4 hours) before first use.



- To maximize battery life, charge battery before battery is fully drained.



- Avoid extreme heat or cold as this will affect the life of the battery.



- Turn LCD screen OFF; press POWER  button on the side of the monitor ONCE.



- Set Power Save Mode: After 45 seconds of inactivity, monitor enters standby/sleep mode.



- Set Adjustable Brightness: Decreasing screen brightness will extend battery life.

Battery life of 24 hours based on 10 audio activations while in power save mode. Battery lasts an average of 6 hours with continuous audio/video usage.

# SCREEN ICONS

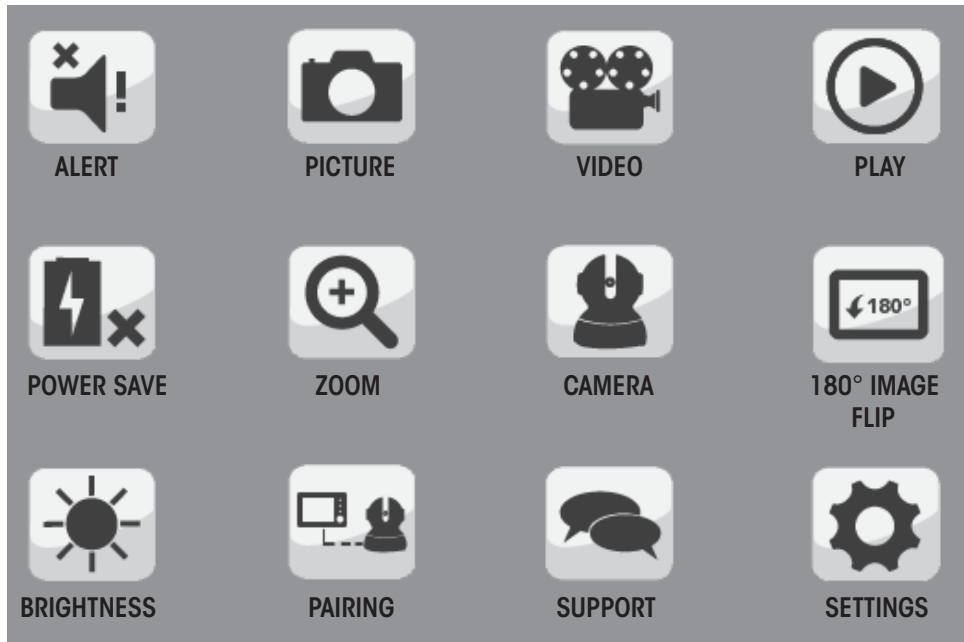

## SIGNAL STRENGTH



## VOLUME



## BATTERY STRENGTH





## POWER SAVE MODE



## 2-Way Talk



## Turn the MONITOR ON/OFF

- Press and hold the POWER  button on the side of the monitor to turn the monitor ON.
- Press and hold the POWER  button again to turn OFF the monitor.

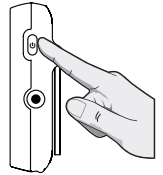

## Pairing the Camera(s) and Monitor

The camera and monitor come paired (connected) to each other automatically. However, if upon opening this package the devices do not automatically connect and transmit, you may do so manually.

\*\*To pair additional cameras, repeat steps 1 to 4 and be sure to assign a different camera number to each additional camera.

Note: Before you begin pairing, be sure to have the monitor and the camera(s) side by side.

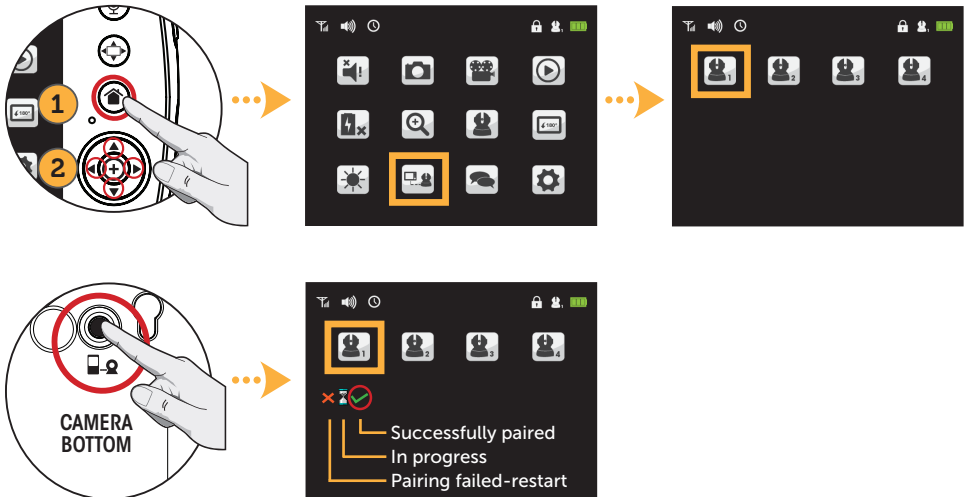

# OPERATION

## Placement of the Monitor

This monitor can be placed on a tabletop.

- You can place the monitor on a tabletop by using the retractable table stand on the back of the monitor. When not in use, simply tuck the table stand away into the back of the monitor until you hear a "click".

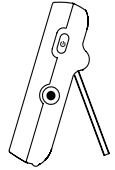

## Placement of the Camera

This camera can be placed on a tabletop or hung on the wall above the area being monitored.

- Place the camera within 15 feet of the area being monitored for best picture results.
- Do not place objects within 2 feet of the field of vision of the camera as the night vision will not activate correctly if objects are too close.

## Mounting the Camera on a Tabletop Safely

1. Place the camera on a tabletop no less than 3 feet away from area being monitored.
2. Feed the power cord down the back of the table or use wall clips (not included) to secure the cord away so children cannot reach it.
3. Plug in the power cord, check the monitor to ensure that you are getting a clear view of the area you are monitoring and there are no obstructions.

## Mounting the Camera on a Wall Safely

Before drilling the holes, it is important to check the reception and camera positioning in the intended location on the wall.

1. Pre-drill two holes in the wall using a 3/16", 4.8mm drill bit.
2. Insert wall anchors (not included) into each hole and tap gently with a hammer until the anchor is flush with the wall.
3. Insert a screw (not included) into each wall anchor and tighten until the screws only stick out about a 1/2 inch.
4. Plug the power cord into the power input of the camera.
5. Locate the wall mounting holes on the bottom of the camera base.
6. Slide the holes over the screws sticking out of the wall.
7. Confirm that the camera is secure, if it is loose you may have to tighten the screws more.
8. Use wall clips (not included) to secure the cord to prevent tripping and so children cannot reach it.
9. Connect the other end of the adapter into an available wall outlet.



## Night Vision

The camera is equipped with NEW Invisible IR (infrared) LEDs which keeps the room dark. The LEDs are located on the front of the camera and allow you to see up to 15 feet in complete darkness allowing you to monitor your room discretely in the dark without drawing attention to your camera. The night vision LEDs will activate automatically when the Light Sensor on the camera detects that the light levels are too low.

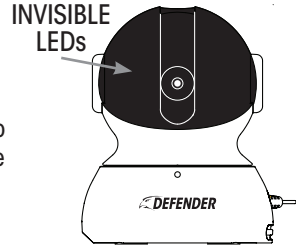

Night vision range up to 15ft under ideal conditions. Objects at or beyond this range may be partially or completely obscured, depending on the camera application.

## Adjusting the Camera Angle - PTZ

The camera is equipped with Pan / Tilt / Zoom (PTZ). You can adjust the angle 300° degrees horizontal and 110° degrees vertical from the center facing position.

- Press HOME  to return to exit PTZ mode and return to LIVE view.

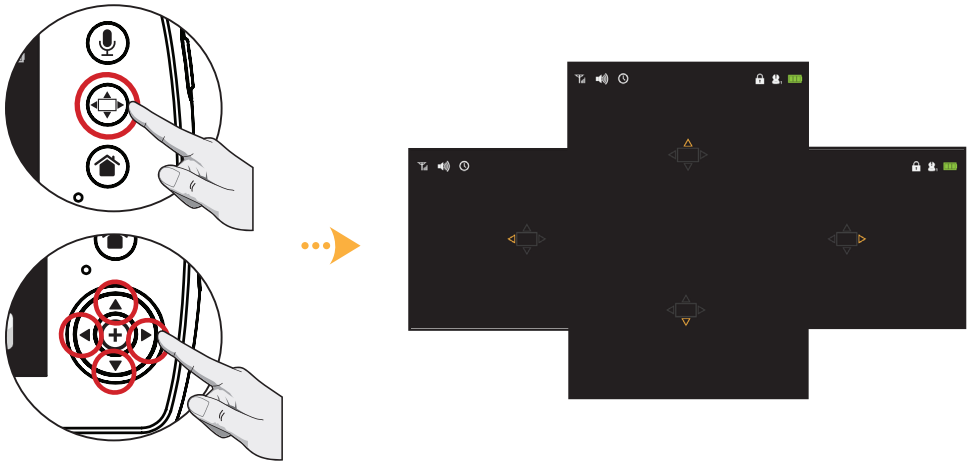

# OPERATION

## Volume

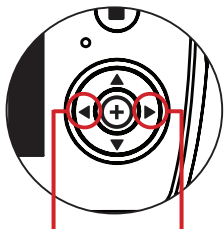

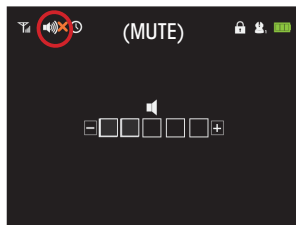
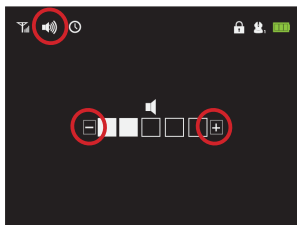

Decrease / Increase



Note: Placing the monitor and camera too close together will create feedback. DECREASE or MUTE the volume and move the camera away from the monitor.

## Using the 2-Way Talk Intercom

With the simple press of a button you can communicate with family members, staff and visitors from anywhere on your property.

1. To talk, press and hold the  button on the front of the monitor and release to listen.
2. To talk when using multiple cameras, select the camera in the MENU and press the  button, release to listen.

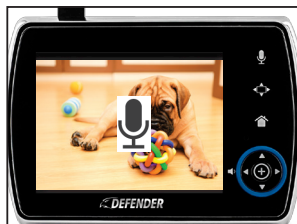
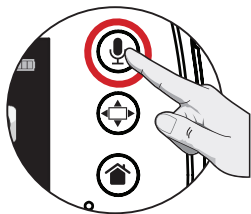

## Using the ZOOM function

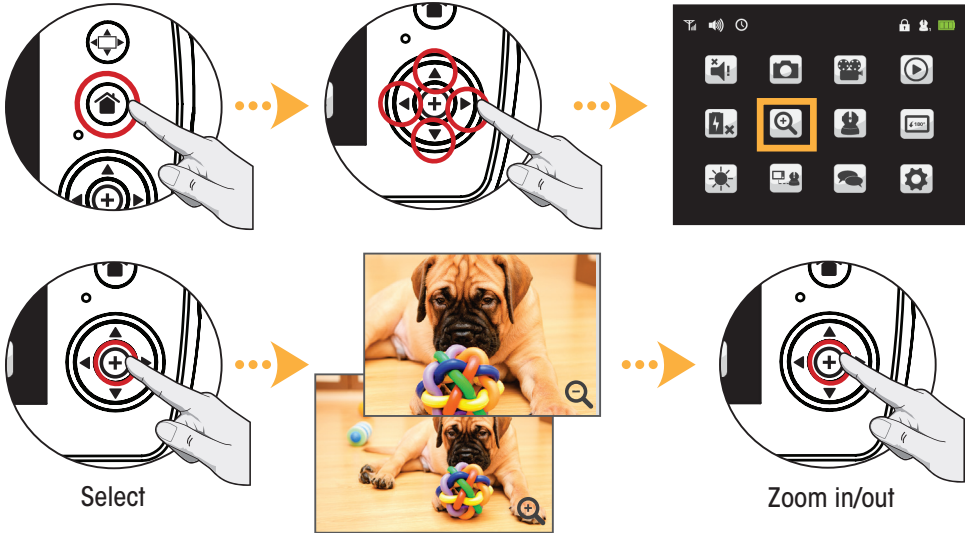

## Changing the Camera View

- When in Quad View, volume +/- and PTZ functions default to camera 1.
- Press SELECT (+) once desired camera view is selected.
- Press HOME (🏠) to return to return to LIVE view.
- Select (📺) to cycle through cameras 1 through 4 and press the HOME (🏠) button once. Each camera view will appear for 6 seconds per camera.

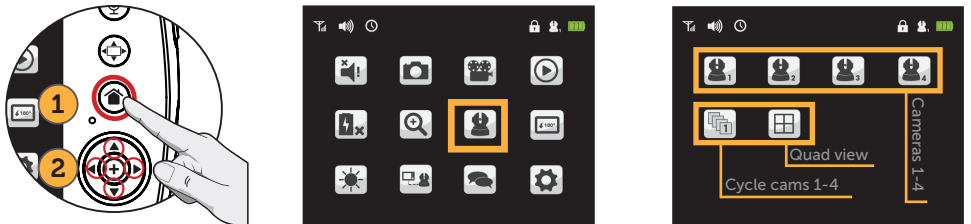

# OPERATION

## Setting an Alarm Alert - Part 1

Choose from three different Alarm Alerts that can be triggered by movement.

- Press SELECT (+) once ALARM 1, 2 or 3 is selected.
- Press HOME (🏠) to return to return to LIVE view.

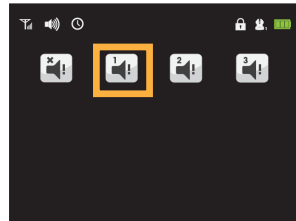
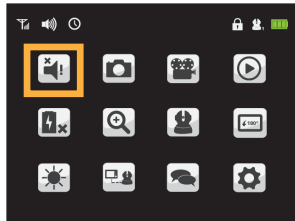
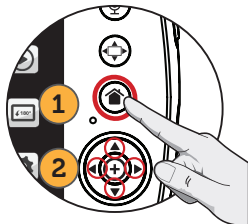

## Setting an Alarm Alert - Part 2



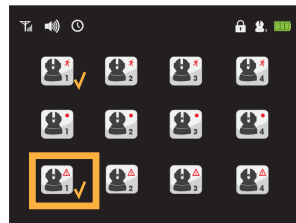
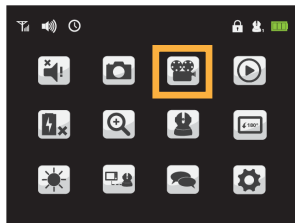
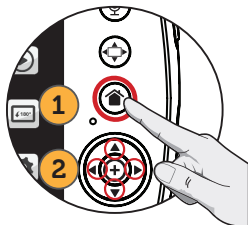

Choose 1 or up to 4 cameras that can be triggered by movement and provide an Alarm Alert once movement is detected.

- Press SELECT (+) once your camera(s) is(are) selected.
- Press HOME (🏠) to return to return to LIVE view.



Note: Having the unit record only when motion is detected will conserve micro SD card memory.

## Using Power Save Mode

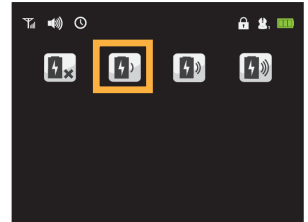
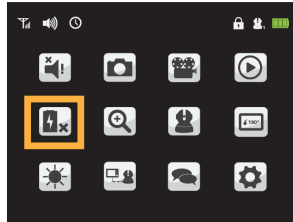
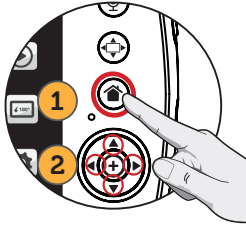

When in Power Save Mode, the monitor enters standby/sleep mode after 1 minute of inactivity. When sound is detected, the screen changes to live view. There are 4 levels of sensitivity: Off , Low , Medium  and Sensitive .

- To access live view manually when the screen is off, press the POWER button ONCE.
- Power Save Mode extends the battery life over 24 hours.
- Press HOME  to return to return to LIVE view.



## Setting the Brightness

Brightness Mode sets the brightness of the the screen. Selecting lower Brightness Modes also extends the battery life.

- Press SELECT  once to make your selection.
- Press HOME  to return to return to LIVE view.

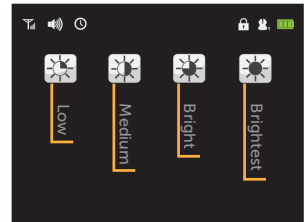
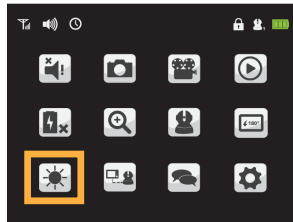
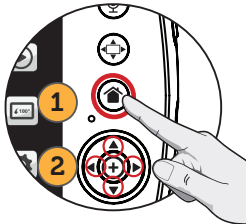





# OPERATION

## Record Video & Snap Photos Instantly

Capture precious moments as they are happening with your choice of recorded video or still photos on the included micro SD card. No need to scramble for a camera!





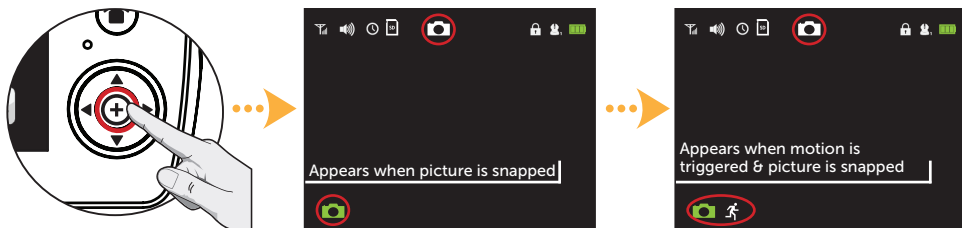
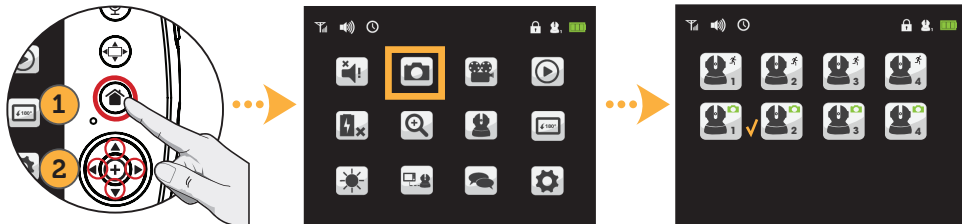

### Taking a picture

- Select  to snap a picture only when motion is triggered or
- Select  to manually snap a picture.
- Press SELECT  once to make your selection.
- Press HOME  to return to return to LIVE view. Press SELECT  to snap picture manually.



Select Icon /  
Take picture  
manually

## Recording Video

- Select  to capture 1 minute video only when motion is triggered or
- Select  to manually capture video.
- Select  to capture 1 minute video when motion is triggered & sound an Alarm Alert.
- Press SELECT  once to make your selection.
- Press HOME  to return to return to LIVE view. Press SELECT  to start/stop video manually.

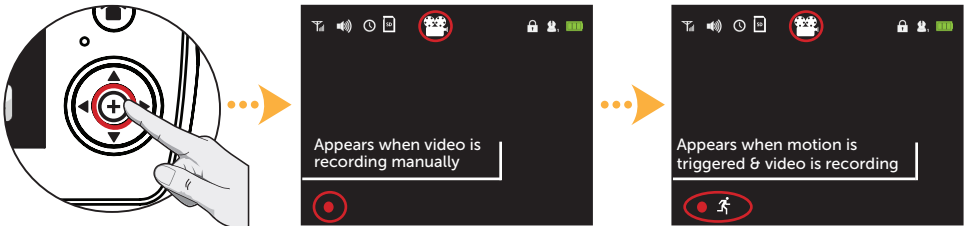
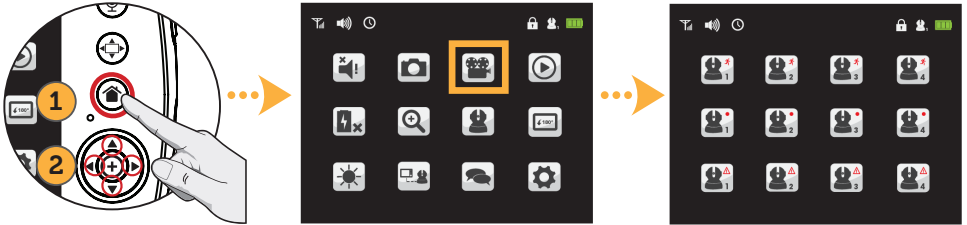

Select Icon /  
Start & Stop video  
manually

Please Note: Alarm Alerts must also be set to be sure alarm is heard when motion is triggered. See "Setting an Alarm Alert" section of the manual.

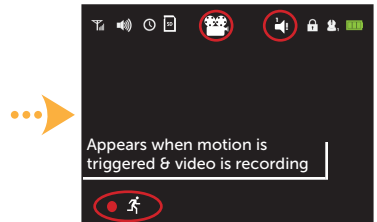

# OPERATION

## Viewing Saved Photos & Videos - Monitor

You can view your saved photos and videos that are on the included SD card from the monitor or on your computer using the included SD Card Adapter.

## Viewing/Deleting PICTURES - Monitor

- Press SELECT (+) once to make your selections and view JPEG.
- Use ◀▶▲▼ to navigate through files; (+) to SELECT.
- Press HOME (🏠) to return to return to previous screen or LIVE view.

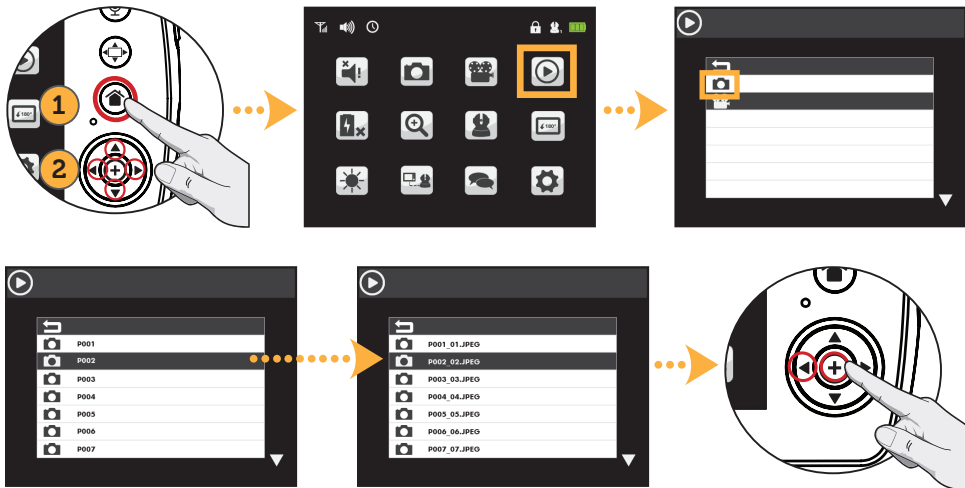

Press ◀ to delete,  
press (+) to Select/Delete;  
press 🏠 to Deselect



## Viewing/Deleting VIDEO - Monitor

- Press SELECT (+) once to make your selections and view video file.
- Use ◀▶▲▼ to navigate through files; (+) to SELECT.
- Press HOME (🏠) to return to return to previous screen or LIVE view.

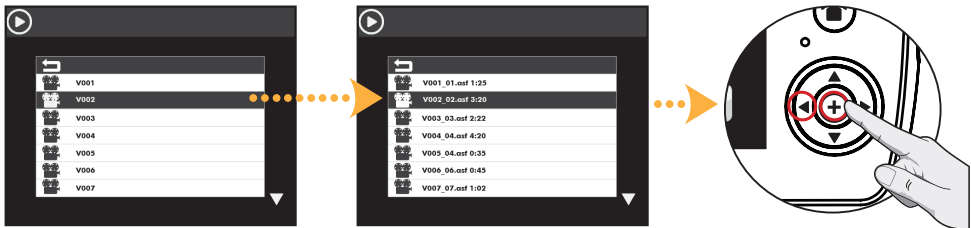
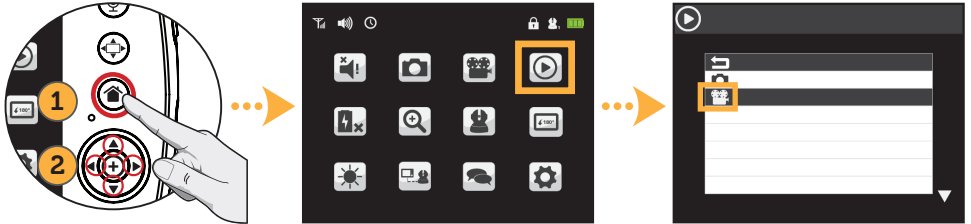

Press ◀ to delete,  
press (+) to Select/Delete;  
press 🏠 to Deselect

# OPERATION

## Viewing Saved Photos & Videos - Computer

You can view your saved photos and videos that are on the included SD card from your computer using the included SD Card Adapter.

Note: If you do not have an SD card slot on your computer, an SD Card Reader (not included) will be required.

1. Turn the monitor off and remove the battery cover on the back of the monitor. Remove the battery to expose the Micro SD card.
2. Slide the silver bracket to the right, releasing the bracket and remove the Micro SD card.
3. Place the Micro SD card in the SD Card Adapter provided and insert the SD Card Adapter in your computer or SD Card Reader.

## Settings

Allows you to view remaining space on your SD Card, format the SD card, restore your monitor to factory default settings, set the time, change the LED Ring color on the front of the monitor and update firmware (Authorized Servicing only).

### SD Card space available

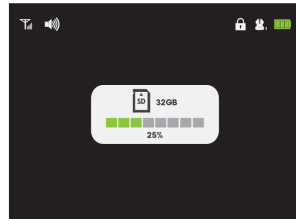
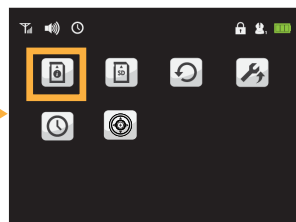
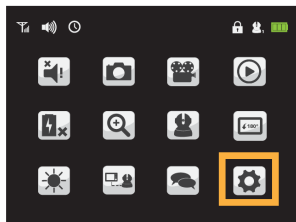
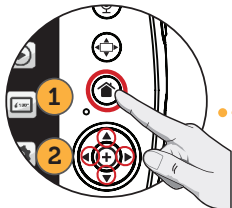

## SD Card formatting

- Press SELECT  once to make your selections.

Note: ONCE YOU HAVE FORMATTED YOUR SD CARD, ALL OF YOUR SAVED PICTURES/VIDEO WILL BE ERASED.

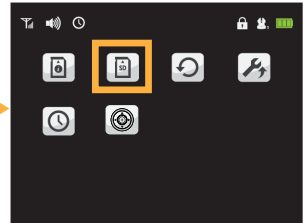
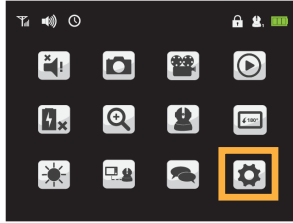
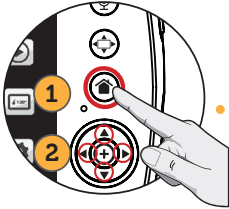

DELETE PICTURES/VIDEO

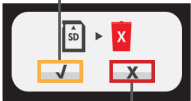

CANCEL / EXIT FORMATTING  
OR PRESS 

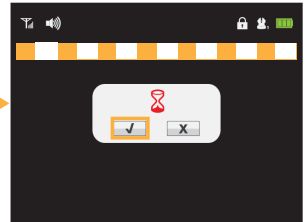
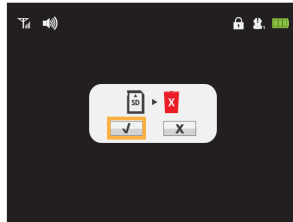

## Firmware update (unused)

- Only to be used by Authorized Service Representatives.

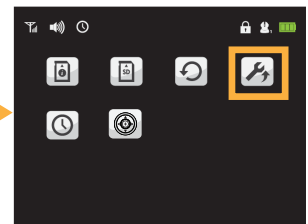
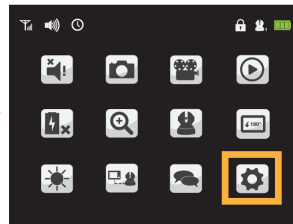
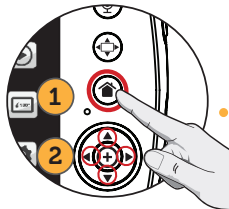

# OPERATION



## SD Card formatting

- Press SELECT  once to make your selections.

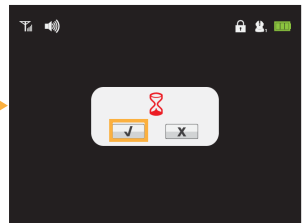
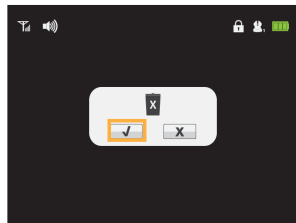
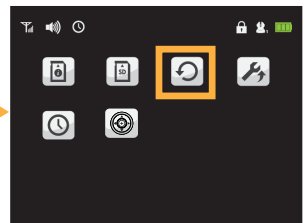
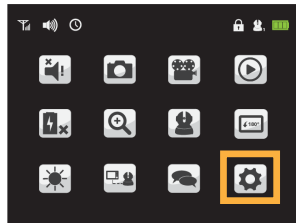
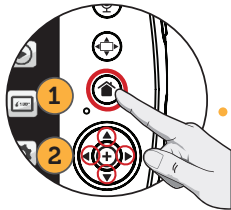



Note: ONCE YOU HAVE RESET TO FACTORY SETTINGS, ALL OF YOUR CUSTOMIZED SETTINGS WILL BE ERASED.

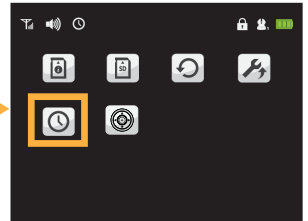
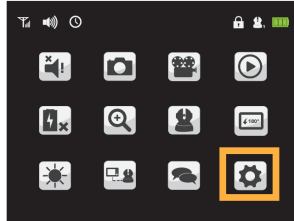
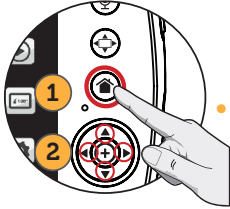

## Setting the date/time

- Press SELECT  once to make your selections.
- Press HOME  to return to return to previous screen or LIVE view.



Use   move left/right;  
use   to increase/  
decrease numbers.

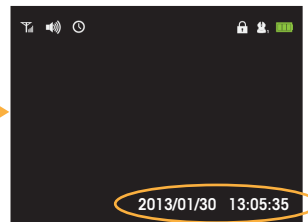
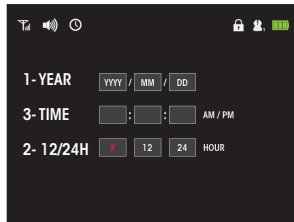

- Set YYYY/MM/DD
- Select 12 or 24 hour clock display
- Set TIME



# OPERATION

## Sound Sensitivity LED ring

Sound Sensitivity LED ring allows you to display the sensitivity of the sounds that the camera picks up. The LED Ring on the front of the monitor indicates how loud the sound in the room is with colors. You can also set it to remain blue or turn it off completely.

- Press SELECT  once to make your selection.
- Press HOME  to return to return to LIVE view.

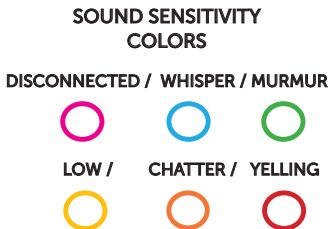
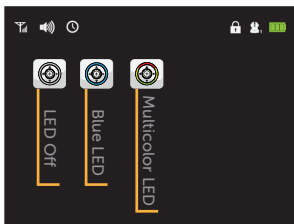
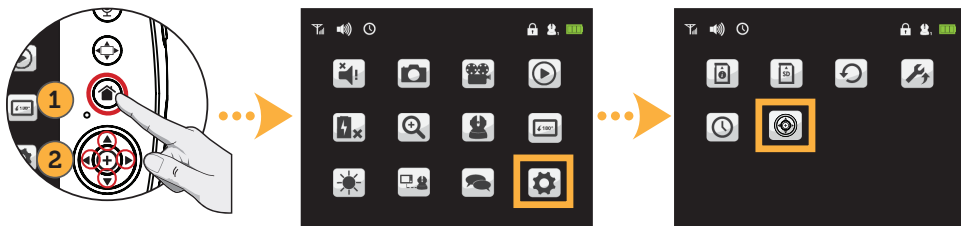

## 180° Image Flip

The 180° Image Flip feature is used when mounting a camera to the ceiling upside down. This will allow you to invert the image and properly view the picture on your monitor.

- Press SELECT (+) once to make your camera selection.
- Press HOME (🏠) to return to return to LIVE view.

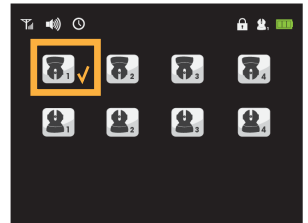
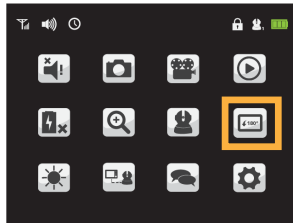
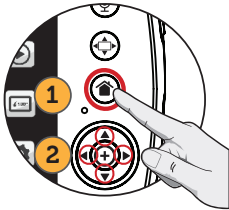

## Contacting Customer Support

Customer Support is just a click away whenever you need it! Our customer support team can be reached by online live web chat or on our website at [www.defender-usa.com/support](http://www.defender-usa.com/support). Our experts will be happy to assist you in English, French and Spanish.

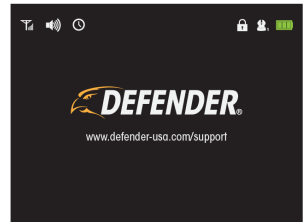
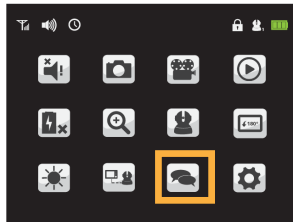
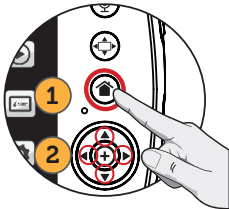

# TROUBLESHOOTING

ISSUE	POSSIBLE SOLUTION
Equipment does not function	<ul style="list-style-type: none"><li>• Confirm that the camera and monitor are ON</li><li>• The battery may be depleted; charge battery</li><li>• The power adapters may not be properly connected</li></ul>
No reception	<ul style="list-style-type: none"><li>• Camera and monitor may not be properly paired; follow PAIRING instructions</li><li>• Camera may be too far away from the monitor</li><li>• Extend the antenna on the monitor</li></ul>
Reception Interference (static)	<ul style="list-style-type: none"><li>• The camera and monitor may be too far apart</li><li>• The battery power may be too low</li><li>• Other electronic devices may be interfering with the signal</li><li>• The camera or monitor may be placed too close to many metal objects</li></ul>
Feedback (screeching, static)	<ul style="list-style-type: none"><li>• The camera and monitor may be too close together</li><li>• The volume on the monitor may be set too high</li></ul>
Noise (static, beeping)	<ul style="list-style-type: none"><li>• Battery power may be too low</li></ul>
The buttons are not working	<ul style="list-style-type: none"><li>• LOCK/UNLOCK Button is in LOCKED position; move to UNLOCK position</li></ul>
Picture works but there is no sound	<ul style="list-style-type: none"><li>• Volume setting may be too low</li></ul>
Picture is black and white	<ul style="list-style-type: none"><li>• Night vision LEDs may be ON; increase the amount of light in the room being monitored</li><li>• Remove any objects within 2 feet of the field of vision of the camera</li></ul>
The rechargeable battery will not charge	<ul style="list-style-type: none"><li>• The power adapters may not be connected</li><li>• Battery pack may not be properly connected inside the battery compartment; reinstall battery</li></ul>

## Maintenance

- Clean the surfaces of the camera and monitor with a soft, lint-free cloth
- If the units become dirty, use a lightly damp cloth to wipe surfaces, taking care to not allow water into any openings
- Never use cleaning agents or solvents



# SPECIFICATIONS

MONITOR		MONITOR	
Monitor Type	TFT LCD	Microphone	Yes
Screen Size	3.5in / 8.9cm	2-Way Talk	Yes
Resolution	320x240	Alarm Alerts	Yes
Frame Rate	25 FPS	Battery Type	Li-Ion
LCD Brightness	Adjustable: 0,1,2,3,4	Battery Capacity	1700 mAh
Frequency	2.4GHz	Battery Connection	Charging Contact
Private Signal	Yes	Battery Life (video+audio on)	6 hours
Technology	Digital FHSS	Battery Life (LCD off)	7 hours
No. of hop/sec	300	Battery Life (Power Save)	Up to 24 hours
No. of hopping channels	19	Battery Low - Visual Warning	Yes
Channel bandwidth	3.375 MHz	Battery Low - Audible Warning	Yes
Data Rate	3 Mbps	Power Save Mode	Yes
Max Transmission Range	750ft	Key Lock	Yes
Optimum Transmission Range	200ft	Touch Panel Keys	Yes
Expandable	Up to 4 Cameras	Housing Material	ABS Plastic, Chrome Plating
Micro SD Recording / Capacity	Yes, up to 32GB	Power Adapter Input	100~240VAC
Record Photo / Video	Yes	Power Adapter	6V 800mA DC
Zoom	2x	Limited charge voltage	4.2V
Quad Screen	Yes	Operating Temperature	32°F-122°F / 0°C-50°C
Scan View	Yes, 8 seconds/camera	Dimensions	4.5" x 1" x 3.25" 11.4cm x 2.54cm x 8.2cm
Speaker	Yes	Weight	0.55 lbs

# SPECIFICATIONS

CAMERA		CAMERA	
Image sensor	CMOS	Housing Material	ABS Plastic
Resolution	640 x 480	Wall Mountable	Yes
Viewing Angle	50 Degree	Power Adapter Input	100~240VAC
Focal Length	2.8mm	Power Adapter	6V 800mA DC
Optimal Focal Distance	2-10ft / 0.6-3m	Operating Temperature	32°F-122°F / 0°C-50°C
PTZ	Yes	Dimensions	3.5" x 4" x 4.5" 8.9cm x 10.16cm x 11.4cm
Range of Motion - Horizontal	300	Weight	0.55 lbs
Range of Motion - Vertical	110		
Frequency	2.4GHz	FCC	
Private Signal	Yes	FCC ID: SMH-30018BU	
Technology	Digital FHSS	FCC ID: SMH-30018PU	
Max Transmission Range	750ft / 228.6m		
Optimum Transmission Range	200ft / 60.96m	IC	
Number of IR LEDs	8	IC: 4593A-30018BU	
IR Wavelength	940nm	IC: 4593A-30018PU	
Night Vision Distance	15ft		
Battery Operable	No		
Microphone	Yes		
Speaker	Yes		