

MOTION CHAIR

PART LIST

- A. THE SEAT OF CHAIR 1
- B. THE BACK OF CHAIR 1
- C1. LEFT ARM 1
- C2. RIGHT ARM 1
- L. ALLEN WRENCH 1
- M. BASE 1

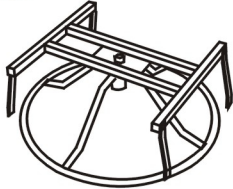

M (VIEW FACING THE ITEM)

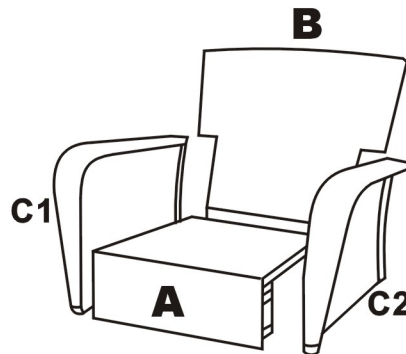

HARDWARE

- D. LOCKING NUT 8
- E. WASHER 8
- F. CAP FOR NUT 8
- G. WRENCH 1
- H. BOLT 2
- I. SMALL WASHER 2
- J. CAP FOR BOLT 2
- K. SMALL ALLEN WRENCH 1

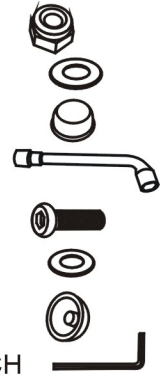

ASSEMBLY INSTRUCTION

1. TO PREVENT ANY DAMAGE, PLEASE PUT ALL PARTS ON A SOFT SURFACE DURING ASSEMBLY.
2. REMOVE PLASTIC PROTECTIVE CAPS.
3. EVERY NUT OR BOLT NEEDS TO BE WITH A WASHER "E" OR "I".

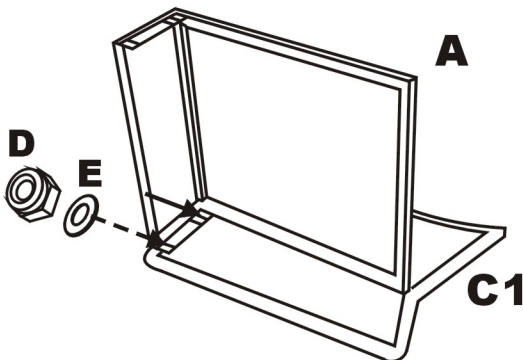

1. PLACE ARM "C1" ON THE FLOOR AS SHOWN.
2. PLACE THE SEAT "A" OVER THE 2 BOLTS ON THE ARM "C1".
3. FASTEN IT USING LOCKING NUTS "D" AND HAND TIGHTEN.

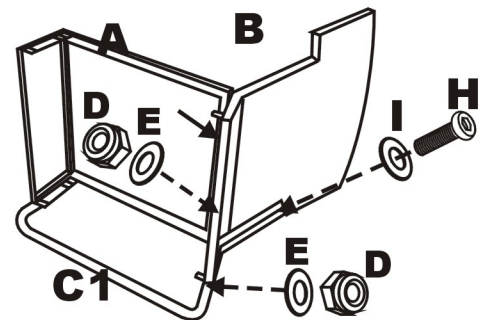

1. PUT BACK OF CHAIR "B" ONTO THE 2 BOLTS ON SEAT "A" AND 1 BOLT ON ARM "C1". FASTEN USING LOCKING NUTS. MAKE SURE TO INSERT THE PIN ON THE BACK OF THE CHAIR "B" INTO THE HOLE ON ARM "C1" FASTEN WITH BOLT "H".

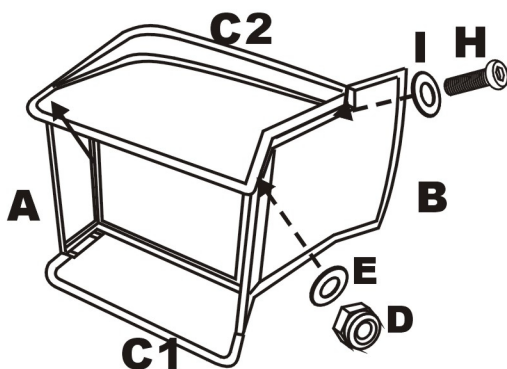

1. REPEAT STEP 1 FOR THE OTHER ARM AND MAKE SURE LINE UP THE EXTENSION ON THE BACK OF CHAIR "B" TO HOLE ON ARM "C2".

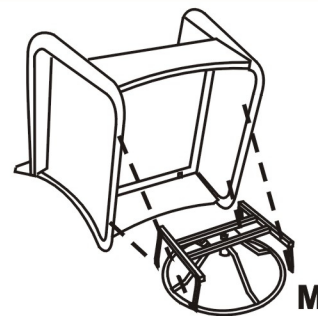

1. CHECK AND MAKE ADJUSTMENT IF NEEDED. THEN FULLY TIGHTEN ALL THE NUTS WITH WRENCH "G" AND BOLTS WITH ALLEN WRENCH "K".
2. COVER NUTS WITH CAPS "F" AND BOLT WITH CAPS "J".
3. TIGHTEN PART "M" USING ALLEN WRENCH "L".