

## **⚠ WARNING**

Do not use an electric screwdriver during installation.



## **⚠ WARNING**



This Manufacturer advises that no lock can provide complete security by itself. This lock may be defeated by forcible or technical means, or evaded by entry elsewhere on the property. No lock can substitute for caution, awareness of your environment, and common sense. Builder's hardware is available in multiple performance grades to suit the application. In order to enhance security and reduce risk, you should consult a qualified locksmith or other security professional.

## **Installation Instructions**

### **Replace the old lock with the new one**

To replace the old lock with this product on the same door, please confirm the backset for the latch and the specifications for the face plate match. Please also refer to the following instructions to adjust the backset and face plate to match the existing door's specifications.

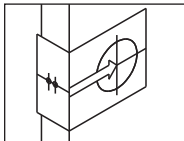

The distance between the edge of the door to the center of the hole is the latch backset. The adjustable latch provides two choices of backsets 2-3/8" (60mm) and 2-3/4" (70mm). Change the backset for the latch according to the illustration.

### **Latch Backset Adjustment**

Rotate the latch case to the right for a backset of 2-3/4" (70 mm).  
Reverse the direction for a backset of 2-3/8" (60 mm).

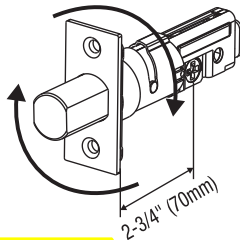

## **WARNING:**

This Manufacturer advises that no lock can provide complete security by itself. This lock may be defeated by forcible or technical means, or evaded by entry elsewhere on the property. No lock can substitute for caution, awareness of your environment, and common sense. Builder's hardware is available in multiple performance grades to suit the application. In order to enhance security and reduce risk, you should consult a qualified locksmith or other security professional.

**For assistance or warranty information:  
Kwikset product**

1-800-327-5625, USA & CANADA

## Install new lock on the new door

To install this product on a new door, please go through the following steps to drill the hole.

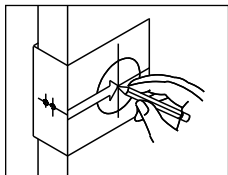

### Mark the Door with Template

Select the height and backset as desired on the door face; use the template as an indication to mark the center of the circle on the door face and the center of the door edge.

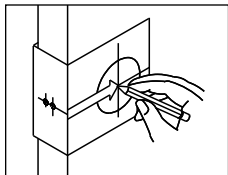

### Drill Holes

Using the marks as a guide to drill a hole  $\varnothing 2\text{-}1/8\text{'}$  (54mm) through the door face for the lockset, then a hole of  $\varnothing 1\text{'}$  (25.4mm) for latch.

# Start the installation

## 1. Install latch

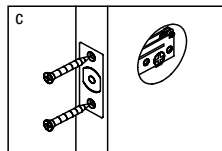
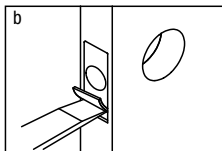
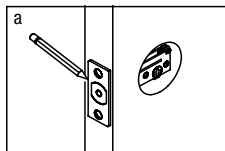

- Insert the latch and lay the faceplate against the door edge. Use a pencil to mark its perimeter, then take out the latch.
- Chisel out the portion you've marked with pencil for about 1/8" (3 mm) deep. Score the area within the borders as clearly and precisely as possible. Ensure the plate can fit flush with the door edge surface.
- Insert the latch and tighten it with screws.

Note: please use "tapping screws" for a metal door.

## 2. Install strike

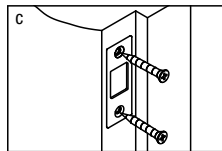
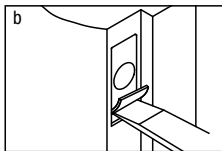
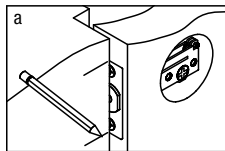

- Half-close the door to lay the latch bolt against the door frame. Mark the position of faceplate as an indication. Place the strike against the door frame and mark its perimeter. Make sure the center of strike is perfectly aligned with the center of faceplate.
- Drill a  $\varnothing 1"$  (25.4mm) hole with 1" (25.4 mm) depth on the center of strike outline. Then use the chisel to scrape out the door frame for 5/64" (2 mm) deep within the traced outline. Make sure to chisel deep enough to allow the strike to lay flush with the frame surface.
- Insert the strike and tighten it with screws.

Note: please use "tapping screws" for a metal door.

### 3. Install the keypad assembly

- Ensure the latch bolt is retracted.
- Follow the illustration below to install the cylinder. Place the cylinder into the keypad with the tailpiece in a horizontal position, and insert it through the hub of the latch.
- Pass the cable under the latch to the interior side of the door.

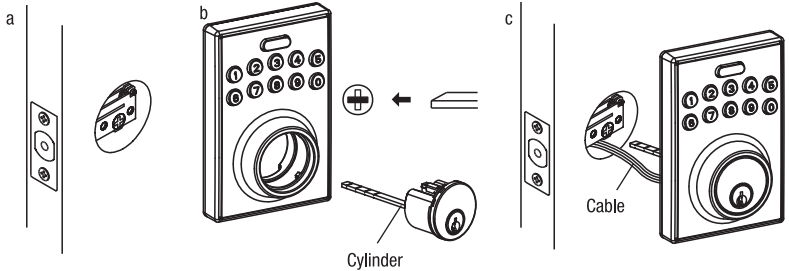

### 4. Install the interior mounting plate

- Pass the cable through the cable hole in the interior plate. Then fasten the interior plate with screws.
- Examine whether the exterior lock unit and the interior plate are tilted. If so, please loosen the screws for adjustment, and re-fasten the screws.

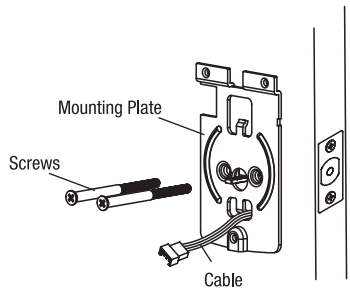

## 5. Identify door handing

Face the door from outside, the door is left handed if the hinge is on the left-hand side of the door, whereas the door is right handed if the hinge is on the right-hand side of the door.

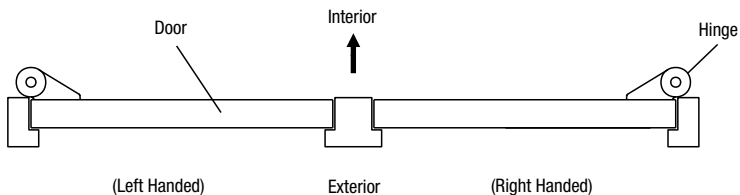

## 6. Adjust turn piece

If you have a right-handed door, turn the turn piece to the left 45°.

If you have a left-handed door, turn the turn piece to the right 45°.

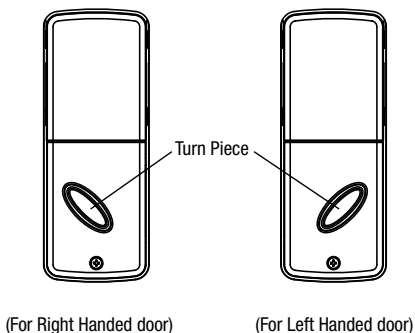

## 7. Install Receiver Module

- Remove the battery cover (push it up and pull it out).
- Connect the cable and ensure the tailpiece is engaged with the turn piece. Then attach the receiver module to the door with screws. The use of wood screws is optional (only use wood screws for wood doors).
- Insert 4 (AA) 1.5V alkaline batteries and reinstall the battery cover.

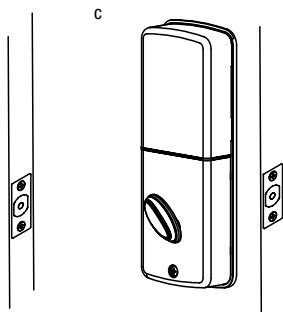
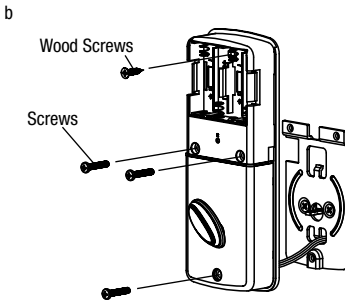
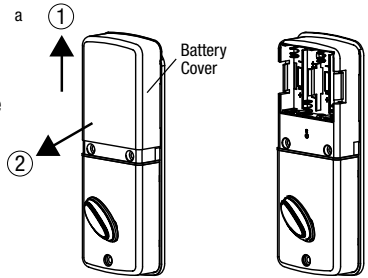

# Operational interface

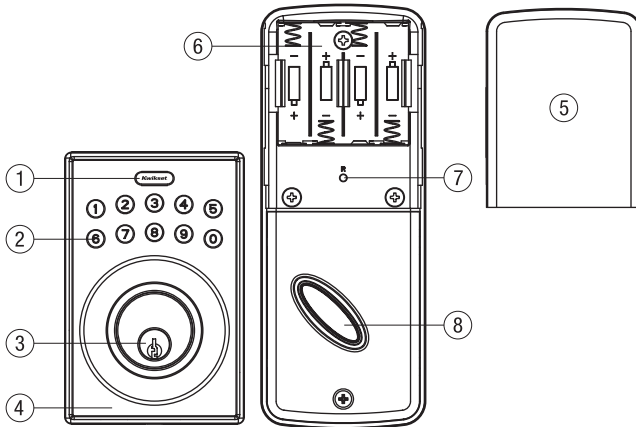

## 1. Program/Lock button

Used for entering codes, clearing errors, function setup, and locking and unlocking the door from the exterior.

## 2. Number buttons

To enter user codes. Each code must be 4-10 digits long.

## 3. Cylinder

Retracts/extends the latch bolt by key from the exterior.

## 4. Gasket

Prevents water from getting into the lockset.

## 5. Battery cover

Push it upward and outward to replace the batteries.

## 6. Battery holder

Uses 4 AA Alkaline batteries.

## 7. Reset Button ("R")

Restores settings to factory default.

## 8. Turn piece

Lock and unlock from the interior.

# Specifications and Functions

## 1. Power supply

4 AA, 1.5V Alkaline batteries

## 2. Low battery indication

- 2-1 During operation, if the LED on the battery cover flashes red and constant beeping is heard for 10 seconds, it means that the battery is low. The batteries need to be replaced immediately.
- 2-2 All settings will remain active and won't change or disappear even if the battery is down.
- 2-3 When the batteries are fully drained, the system can still be locked or unlocked manually with the key.

## 3. LED Indicator

- 3-1 LED flashes green once: successful operation
- 3-2 LED flashes green twice: successful programming
- 3-3 LED flashes red three times: operation error
- 3-4 LED flashes red 5 times: password operational error. The system will initiate the protective mode and stop functioning.
- 3-5 LED flashes orange 3 times: system is restored to default settings.
- 3-6 LED flashes orange slowly: lockset is in programming mode

## 4. Audio indication

- 4-1 1 beep means the operation is normal.
- 4-2 2 long beeps mean the setting is correct.
- 4-3 3 short beeps mean operational error.
- 4-4 3 long beeps mean the default password has been restored.
- 4-5 5 short beeps mean password operational error. The system will initiate the protective mode and stop functioning.
- 4-6 10 short beeps mean the battery is low.

## 5. Programming Code (PC)

- 5-1 The default programming code is "0000". It is recommended that the user change the programming code during initial installation.
- 5-2 There is only one programming code and is used to set all functions.
- 5-3 The programming code cannot be used to unlock the door.
- 5-4 The programming code must be 4-10 digits in length.
- 5-5 The programming code can be changed anytime as needed.



## **6. User Code (UC)**

- 6-1 The default user code is “1234”. During initial installation, delete the default user code, and then set the new user code.
- 6-2 A total of 6 user codes can be saved.
- 6-3 The user code cannot be used for programming functions.
- 6-4 The user code must be 4-10 digits in length.
- 6-5 The user code can be deleted or added at anytime as needed.

## **7. Delete individual user code**

- 7-1 User codes can be deleted individually. The same user code can be reset after being deleted.
- 7-2 The programming code is needed to delete individual codes.

## **8. Delete all user codes**

- 8-1 All user codes can be deleted at once. The original user codes can be reset again.
- 8-2 After deleting all user codes, the automatic lockup and the program button lockup functions set previously will automatically be disabled. The door can only be locked or unlocked with a key. The original functions will be restored once the user code is set.
- 8-3 The programming code is required to delete all user codes.

## **9. Temporarily disable user code**

- 9-1 This will temporarily disable all user codes. The automatic lockup and keypad lockup functions that were set previously will automatically be disabled. A key must be used to lock and unlock the door.
- 9-2 To restore the code function and other electronic functions, repeat the steps for “Temporarily disable user code”.

## **10. Create one-time user code**

- 10-1 After the one-time user code is entered and used, it is disabled and won't be able to open the door again.
- 10-2 The same one-time user code can be set repeatedly.
- 10-3 The programming code is needed for setup.

## **11. Restore Factory Default Codes**

11-1 Pressing the “R” button on the interior receiver module will cancel all previous settings.

11-2 After the system is restored, the PC will be 0000; the UC will be 1234.

## **12. Unlock**

12-1 The door can be unlocked by entering a registered user code or the key from outside, or by the turn piece from inside.

12-2 To unlock with the keypad, enter the UC and press the Program/Lock button.

## **13. Lock**

The door can be locked from the exterior by key or by pressing the Program/Lock button on the keypad. The door can be locked from the inside by turning the turn piece.

## **14. Incomplete Door Closing/Opening**

14-1 If the latch bolt is not fully extended when locked by the keypad, you will see the LED flash red 3 times and hear 3 beeps (unless muted). To correct this, enter the UC and unlock the door to fully retract the bolt, and then press the Program/Lock button.

14-2 If the latch bolt gets stuck and/or often will not extend/retract fully, check that the strike is aligned with the latch bolt and that the door hinges are not worn from long time use. Adjust strike and/or replace hinges as needed.

## **15. Automatic lockup**

15-1 The door will automatically lock itself when this function is programmed.

15-2 The timer (10-99 seconds) of automatic lockup can be set up by the user as needed. (The default timer is 30 seconds after the system is unlocked.)

15-3 The system will alarm twice if the latch bolt is stuck or is not fully extended.

15-4 To disable the automatic lockup, please repeat the steps for “Automatic lockup”.

## **16. Mute**

16-1 You will hear beep sounds when pressing the keypad or when there are programming/operating errors. The sound can be turned off if needed.

16-2 LED illumination will still function when the system is muted. Because warning alarms will not be audible, it is not recommended to mute the sound unnecessarily.

16-3 Motor operating sound cannot be muted.

## **17. Code protection**

If the user code is entered incorrectly over 5 times, the system will initiate the protective function and disable the keypad for 45 seconds.

## **18. Illumination**

The LED keypad will light up when any button is pressed to aid while operating in the dark.

## Code setup

1. The system should remain unlocked during programming.
2. The door-handing identification process (see “Function setup” instructions) must be performed before programming the lockset. This process must also be performed after restoring the default system settings.
3. During initial installation, it is recommended to change the default programming code (0000), delete the default user code (1234), and add the new personal user code prior to setting up other functions.
4. The LED will flash orange slowly during programming. The LED will flash green twice with 2 long beeps to indicate successful programming. The LED will flash red 3 times with 3 beeps if there is an operation error (in this case, wait 6 seconds or press the Program/Lock button, then reprogram the setting).
5. During the function setup, if it takes longer than 6 seconds to finish any step, the system will automatically leave the program.
6. This product can be operated with the keypad or key.
7. Please refer to the “Function setup” instructions.

## Notification

1. Alkaline batteries are recommended to maintain stable and prolonged power.
2. Do not mix the alkaline batteries with regular zinc-carbon batteries and avoid mixing batteries of different brands.
3. Do not use any chemicals or add any lubricants when cleaning the lock, to avoid damaging the panel and coating.
4. In case of malfunction, please contact Customer service at 01-800-327-5625.

## Function setup

PC	Programming code
UC	User code
	Program/Lock button

### Door-Handing Identification



Instruction: Run the door-handing identification process before setting up other functions. Perform this process after the system is restored to default settings. The system should remain unlocked during programming.

### Add new user code



Instruction: A total of 6 user codes with a combination of 4 to 10 digits can be set up.

### Delete individual user code

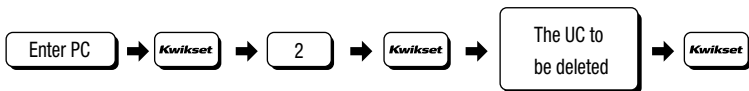

### Delete all user codes



Instruction: When all user codes are deleted and no new user code is set up, all electronic lockup functions will be disabled. (The electronic functions will be restored when a new user code is set.) During this time, the door must be locked or unlocked manually with a key.

### Change programming code

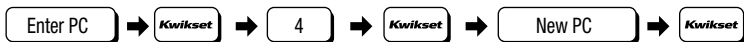

### Automatic lockup



Instruction: The default setup for the automatic lockup timer is 30 seconds. To modify the timer for the automatic lockup, please refer to the instructions for “Automatic lockup timer”. To cancel the automatic lockup, please repeat the setup procedure for “Automatic lockup”.

## Automatic lockup timer



Instruction: the timer can be set from 10 to 99 seconds.

## Toggle Mute On/Off



Note: LED illumination is still functioning when system is muted, but there will be no warning alarm.

## Temporarily disable user codes



Instruction: When all user codes are temporarily disabled, all electronic functions will be temporarily disabled as well. The door must be locked or unlocked manually with the key. To restore user code functions, please repeat the setup process for “Temporarily disable user code”.

## Use one-time user code

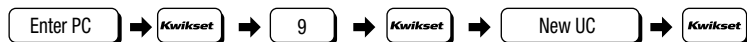

Instruction: Once this user code is entered and used, it is disabled and unable to open the door again. However, the same one-time user code can be set again.

## Restore factory default

 Instruction: Press button for over 5 seconds. The restoration is complete once you hear 3 long beeps. Make sure to run the door handing identification process before setting other functions.

## CAUTION

Prevent unauthorized entry. This lock can be opened using a default user code (1234) that is set at the factory. Upon installation and set-up, change the default programming code (0000), delete the default user code (1234), and add the new user code prior to setting up other functions. Since anyone with access to the power board can reset the codes to the factory default setting, you must restrict access to the power board (including the battery pack) and routinely check the codes to assure they have not been altered without your knowledge.

# Troubleshooting

## Scenario 1

After the installation is complete and the batteries are in place, the door cannot be locked, and three short beeps are emitted when you press the Program/Lock button.

Cause: The door handing identification process is not yet complete.

Solution: Perform the door handing identification process immediately after the installation is complete.

## Scenario 2

After the installation is complete and the batteries are in place, none of the buttons are responsive. (No sound, and no backlight)

Cause: Issues with batteries or the wiring.

Solution: Replace the batteries or make sure the batteries are installed correctly. Please check whether the cable from the interior lock unit is connected correctly.

## Scenario 3

The door handing identification process fails (LED flashes red three times with three short beeps).

Cause: Wrong door handing or change of door handing in the memory.

Solution: Press the "R" button to restore the system to factory default settings, and perform the door handing identification process again.

## Scenario 4

Latch does not work (latch bolt is stuck and the turn piece cannot be rotated), even though door handing identification process was successful.

Cause: Low battery

Solution: Replace with new batteries.

### **Scenario 5**

After the lockset has been functioning normally, the latch bolt suddenly locks up and the turn piece cannot be rotated.

Cause: Abnormal detection of latch bolt position

Solution: Take out one battery, press any button on the front panel for electrical discharge, and then replace the battery. The latch bolt will automatically re-detect its position.

Note: When the latch bolt gets stuck frequently, check that the strike is aligned with the latch bolt and that the door hinges are not deformed or tilted.

### **Scenario 6**

The door can be locked normally, but three short beeps are heard and door does not unlock when the UC is entered and the Program/Lock button is pressed.

Cause: Abnormal function of the micro-switch

Solution: Unlock the door with the key and contact the distributor for inspection and maintenance.

### **Scenario 7**

While the door is closed, the latch bolt can be heard coming out when the Program/Lock button is pressed to lock the door. However, three short beeps are heard. Conversely, while the door is open, no beeps are heard when locking the latch bolt.

Cause: (1) The depth of the latch bolt hole is insufficient.

(2) The latch bolt is not aligned with the strike.

Solution: (1) Drill deeper hole for latch bolt. Minimum depth of 1" (25.4 mm).

(2) Adjust strike to the appropriate position.