

GO[®] CHASSI[®]

HITCH AND GO![™]

Model: C1

GO! Chassi with Casters

Includes:

- C0:** Chassi Scissor Lift
- C.904:** Chassi Hitch
- C.906:** Chassi Caster Kit (6")

Tools Needed For Assembly

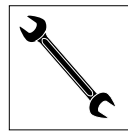
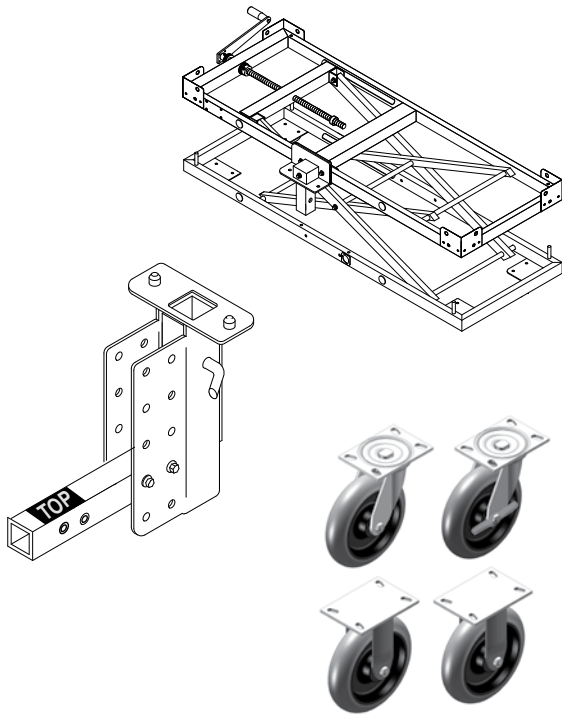

(2x)10 mm
Wrench

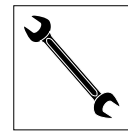

18 mm Wrench

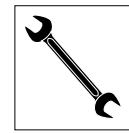

21 mm Wrench

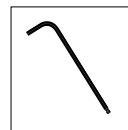

Allen Wrench



Phillips Screw
Driver

Thank You

Thank you for purchasing the GO! Chassi.

Thank you for choosing a GO! Chassi[®] branded product from GO! Products[®]. We want you to be completely satisfied with your new purchase.

At GO! Products, we believe our customers are our best advocates. We strive to provide world class customer support before and after each sale. We Want to Hear from You.

Please visit GoProductsUSA.com

- Find answers to commonly asked questions
- Watch Assembly & Maintenance videos
- Tell us how YOU are using our products
- View our entire line of *Hitch & GO!*[™] products and accessories
- Download the latest versions of our Assembly Guides

If you think something can be improved, please let us know!

Assembly Guide V1.0

Download the latest Assembly Guides at GoProductsUSA.com

Assembly & Operation Guide

ASSEMBLY C.906

Remove Protective Packaging

Remove the protective packaging and any loose boxes/items. Do not discard the protective packaging until the unit is completely assembled.

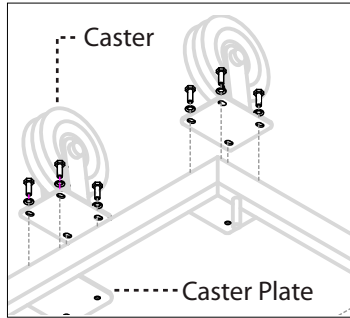

Install Chassi Casters

With two people, turn the GO! Chassi over and set it on a non-scratching surface. The unit will be resting on the four (4) Corner Irons, exposing the four (4) Caster Plates.

Locate the Chassi Hand Crank side of the unit and position the two (2) Swivel Casters onto the Caster Plates. On the opposite end, position the two (2) Rigid Casters onto the Caster Plates. Attach each Caster using four (4) M6 x 1.0 x 25 mm Hex Bolts (with M6 Lock Washers and M6 Fender Washers) through the corresponding threaded nuts on each Caster Plate.



Tighten using a 10mm wrench.

Maintenance

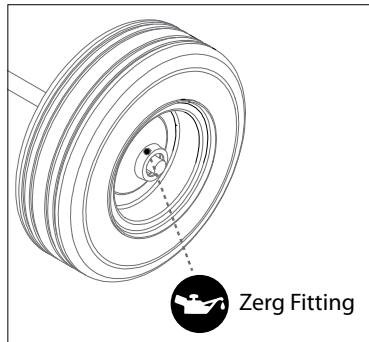

Lubricate Parts

Prior to each use, apply bearing grease to the Chassi Casters to insure smooth operation.

Replacement Parts C.906

REF #	DESCRIPTION	QTY
1	Rigid Caster	2
2	Swivel Caster	1
3	Swivel Caster W/ Break	1
4	M6 (1") x 1.0 x 25 mm Hex Bolt	16
5	M6 (1/4") Fender Washer	16
6	M6 Lock Washer	16

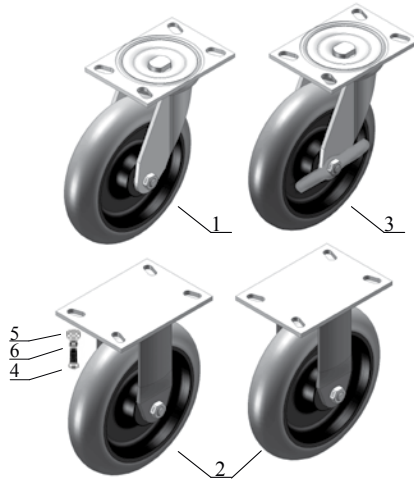

⚠ WARNING ⚠

Check all bolts prior to putting
GO! Chassi® into use

Assembly & Operation Guide

ASSEMBLY / Co

Remove Protective Packaging

Remove all parts from the protective packaging. Do not discard the protective packaging until the unit is completely assembled.

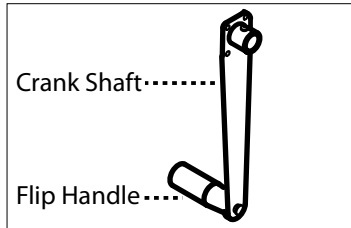

Install Chassi Hand Crank

Attach the Flip Handle to the Crank Shaft by applying a dab of Loctite 242 Thread Locker to the tip of the M6 x 1.0 x 16 mm Pan Head Bolt and pass it through the thru-hole in the end of the Crank Shaft and into the threaded end of the Flip Handle.



Tighten using an M6 Allen Wrench.

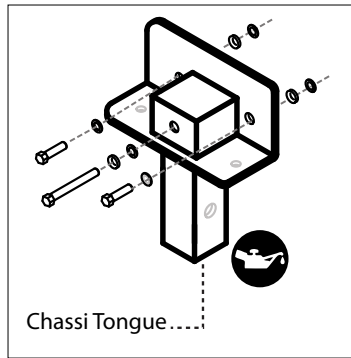

Install Chassi Tongue

Push the M12 x 1.75 x 130 mm Hex Head Cap Screw (with an M12 Fender Washer and Lock Washer) through the center hole of the Chassi Tongue and into the Upper Rail of the GO! Chassi and hand tighten.

Push two (2) M12 x 1.75 x 60 mm Hex Head Cap Screws (with M12 Fender Washers) through the thru-holes of both the Chassi Tongue and the welded Reinforcement Plate on the Upper Rail of the GO! Chassi. On the opposite side, slip M12 Fender Washers over each Cap Screw and secure with M12 x 1.75 Nylock Nuts.



Tighten and secure each Hex Head with an 18 mm wrench and the Nylock Nuts with a 21 mm wrench.



Grease Tongue to improve performance.

MAINTENANCE / Co

Lubricate Parts

Prior to each use, apply a bearing grease to the Acme Thread, Thrust Bearings and Chassi Tongue to ensure smooth operation.

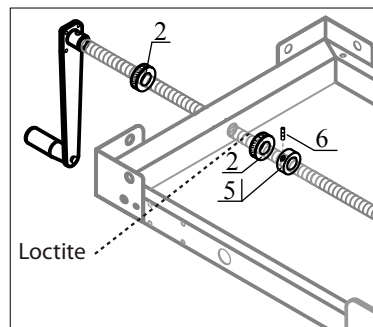
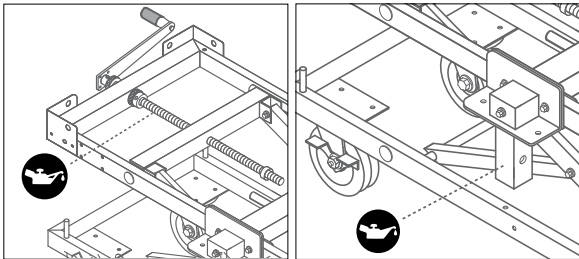

Repack Thrust Bearings

Over time, the Three Part Thrust Bearings (Part #2) that are used to convert the rotary motion of the Hand Crank to move the scissor assembly can become loose.



To correct this, first remove any payload from top of Chassi and crank scissor to its lowest point, then using an allen wrench, remove the two Set Screws (Part # 6) that are holding the inner Acme Nut in place.

Then loosen the Acme Nut (Part #5) roughly 1/2" - this will loosen the entire Crank Handle Assembly.

Dab Loctite 242 or Loctite 271 directly on the Acme Screw, beneath where the Acme Nut was. Tighten the Acme Nut until it is snug - (the Hand Crank should effortlessly and quietly be able to turn in either direction). Dab Loctite 242 on the tip of each Set Screw and retighten.

OPERATION / Co

Attaching GO! Chassi to an installed Chassi Hitch

- 1** Roll the collapsed GO! Chassi to the rear of the Transporting Vehicle (which is parked on level ground) and position it perpendicular to the Installed Chassi Hitch.
- 2** Turn the Chassi Hand Crank clockwise until the bottom of the Chassi Tongue is higher than the Chassi Hitch.
- 3** Maneuver the unit so the Chassi Tongue is directly above the Chassi Hitch and turn the Chassi Hand Crank counter clockwise, lowering the Chassi Tongue into the Chassi Hitch.
- 4** When the Stabilizing Plates of the Chassi Tongue and the Chassi Hitch are touching, push the 5/8" Hitch Pin through the thru-holes on the sides of the Chassi Hitch and secure by snapping in the Hitch Pin Clip. Continue to turn the Hand Crank counter clockwise until the Bumpers of the Lower Rail touch the Upper Rail. **Stow the Flip Handle.**
- 5** If equipped with the Chassi Taillight Kit, plug the four pin connector to your Vehicle Hitch Electrical system. Test to make sure the Stop, Tail and Turn lights function properly.

Just Hitch and GO!™

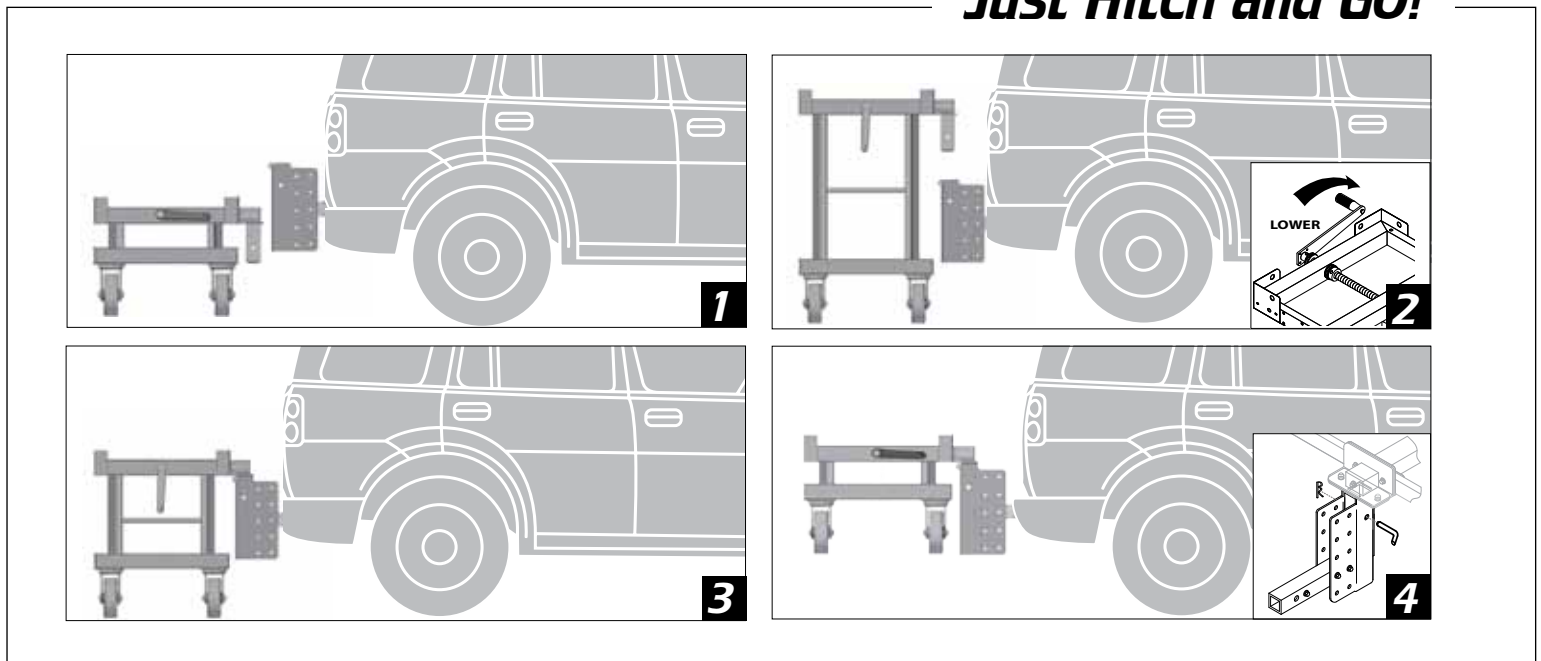

Detaching GO! Chassi From an installed Chassi Hitch

- 5** If equipped with Chassi Taillight Kit, unplug the four pin connector from your Vehicle Hitch Electrical system.
- 4** Remove the Hitch Pin Clip and the 5/8" Hitch Pin from the Chassi Receiver.
- 3** Turn the Chassi Hand Crank clockwise until the Chassi Tongue is above the Chassi Hitch.
- 2** Position the unit so that no part of the Hitch Tongue is above the Chassi Hitch.
- 1** Turn the Chassi Hand Crank counter clockwise, lowering the unit until the Bumpers of the Lower Rail touch the Upper Rail. **Stow the Flip Handle and roll the GO! Chassi into service.**

⚠ WARNING ⚠

Lower GO! Chassi® to lowest possible position before rolling into service

Assembly & Operation Guide

REPLACEMENT PARTS / C1

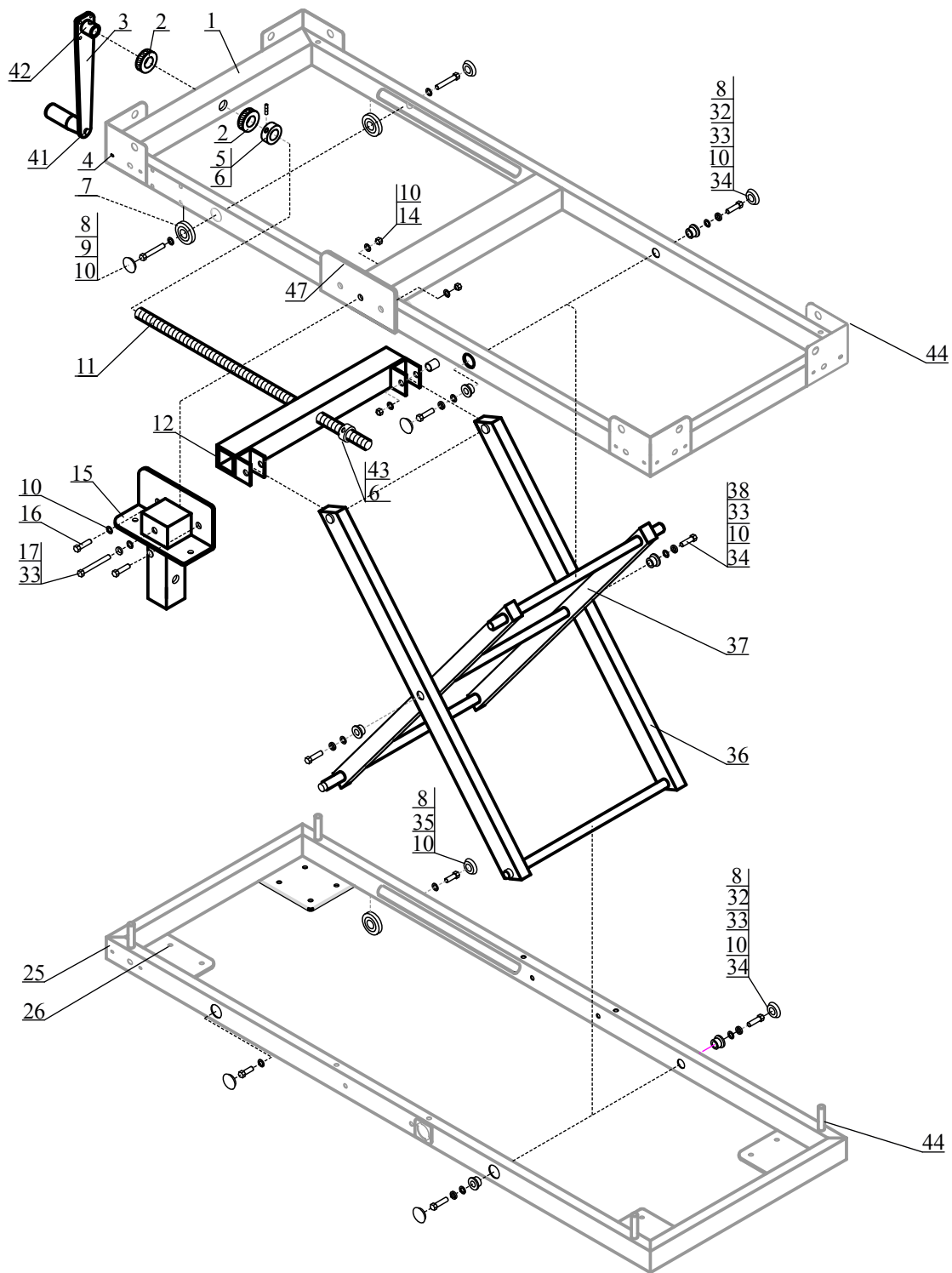

REPLACEMENT PARTS / C1

REF #	DESCRIPTION	QTY
1	GO! Chassi Upper Rail	1
2	Three Part Thrust Bearing	2
3	Crank Shaft	1
4	3/16" Rivet	16
5	.78" Left Handed Acme Nut	1
6	M8 x 1.25 x 8 Cup Point Set Screw	3
7	Chassi Linear Glide Wheel	4
8	Washer	8
9	M12 x 1.75 x 80 mm Hex Head Cap Screw	2
10	M12 Fender Washer	22
11	.78"-1 x 6 Left Handed Acme Screw	1
12	Acme Cross Bar	1
13	Bushing	2
14	M12 x 1.75 Nylock Nut	6
15	Chassi Tongue	1
16	M12 x 1.75 x 60 mm Hex Head Cap Screw	2
17	M12 x 1.75 x 130 mm Hex Head Cap Screw	1
21	M12 x 1.75 Hex Head Nut	1

REF #	DESCRIPTION	QTY
25	GO! Chassi Lower Rail	1
26	M6 x 1 Blind Rivet Nut	40
32	M12 x 1.75 x 35 mm Hex Head Cap Screw	4
33	M12 Lock Washer	8
34	Bronzed Flange Bushing	8
35	M12 x 1.75 x 20 mm Hex Head Cap Screw	2
36	Outer Scissor	1
37	Inner Scissor	1
38	M12 x 1.75 x 50 mm Hex Head Cap Screw	2
40	Flip Up Handle	1
41	M6 x 1.0 x 16 mm Pan Head Bolt	1
42	3/16" Cotter Roll Pin	1
43	Acme Stop Collar	1
44	Chassi Bumper	4
45	Corner Irons	4
47	Reinforcement Plate	1

Screw Identification Guide

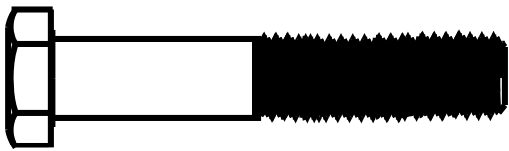

M12 x 1.75 x 60 mm Hex Head Cap Screw

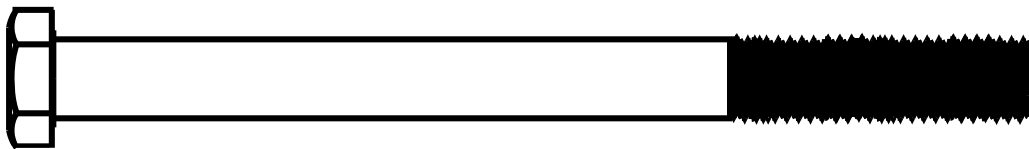

M12 x 1.75 x 130 mm Hex Head Cap Screw

Assembly & Operation Guide

ASSEMBLY / C.904

Remove Protective Packaging

Remove all parts from the protective packaging. Do not discard the protective packaging until the unit is completely assembled.

Measure Vehicle Hitch Height

The GO! Chassi is designed to accommodate various height vehicle hitches. To determine which setting is appropriate for your vehicle, first measure the distance from the ground to the top of your vehicle hitch.

Refer to the **Hitch Clearance Chart** below to determine the appropriate setting.

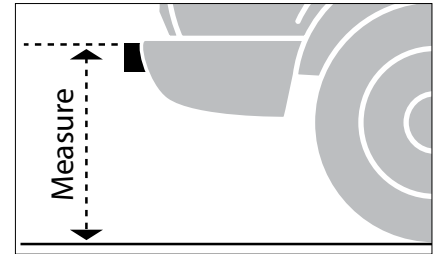

Assemble Chassi Hitch

Refer to the Hitch Clearance Chart below to determine your appropriate Chassi Hitch setting.

Attach the Shank to the Receiver using two (2) M12 x 1.75 x 80 mm Hex Head Cap Screws, passing each (with M12 Fender Washers) through the thru-holes on either side of the Receiver.

On the opposite side, slip M12 Fender Washers on each Cap Screw and secure with M12 x 1.75 Nylock Nuts.

On a properly installed Shank, the label TOP should face up.



Tighten and secure each Hex Head with an 18 mm wrench and the Nylock Nuts with a 21 mm wrench.

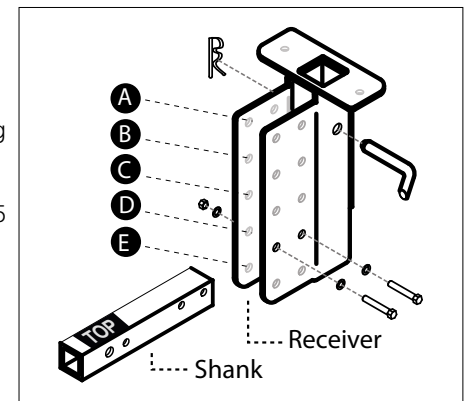

HITCH CLEARANCE CHART / C.904

		6" Casters				
Top of Receiver to Ground		A	B	C	D	E
	16"		8	10.5	13	15.5
	18"		10	12.5	15	
	20"	9.5	12	14.5		
	22"	11.5	14			
	24"	13.5				
	26"	15.5				

		8" Wheels				
Top of Receiver to Ground		A	B	C	D	E
	16"			8.5	11	13.5
	18"		8	10.5	13	
	20"		10	12.5		
	22"	9.5	12			
	24"	11.5				
	26"	13.5				

		10" Wheels				
Top of Receiver to Ground		A	B	C	D	E
	16"				9	12
	18"			9	11	
	20"		8	11		
	22"		10			
	24"	10				
	26"	12				



WARNING



Never Transport the GO! Chassi® Without Hitch Pin Secured



WARNING



Do Not Exceed Hitch Manufacturer's Maximum Tongue Weight



WARNING



Maximum Weight Capacity of GO! Chassi® + Payload is 500 LBS.

INSTALLATION / C.904

Installing the Assembled Chassi Hitch

The Chassi Hitch can either be bolted to a vehicle or secured with an optional 5/8" Hitch Pin. When attached using the 5/8" Hitch Pin, the GO! Chassi will have left-to-right sway when suspended from a vehicle.

To bolt to a vehicle, insert the Shank into the Vehicle Hitch Receiver, aligning the second set of Shank thru-holes with the thru-holes on the Vehicle Hitch Receiver. The first set of thru-holes are used with the 5/8" Hitch Pin option.

While facing the vehicle, insert a Bronze Flanged Bushing into the thru-hole on the right side of the Vehicle Hitch Receiver. Pass an M12 x 1.75 x 90 mm Head Cap Screw (with M12 Fender Washer) through the Bronze Flange Bushing and partially tighten with an 18 mm wrench. Ensure the Bronze Flanged Bushing is firmly seated into the thru-hole.

Before the bolt passes all the way through the Vehicle Hitch Receiver, insert a second Bronze Flanged Bushing into the thru-hole on the left side of the Vehicle Hitch Receiver and continue tightening the cap Screw with an 18 mm wrench.

 To secure, slip a M12 Fender Washer, a M12 Lock Washer and a M12 x 1.75 Hex Head Nut onto the Cap Crew and tighten with a 21 mm wrench.

 Prior to each use, apply a bearing grease to the Chassi Shank and inside the Chassi Receiver to ensure smooth operation.

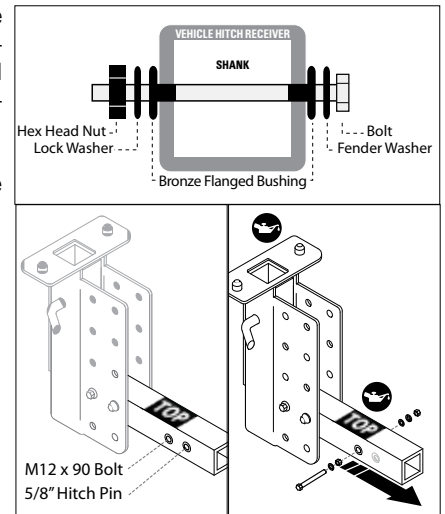

⚠ WARNING ⚠

Refer to your hitch manufacturer for recommendations. Select a hitch clearance setting that optimally provides 8-12 inches of clearance

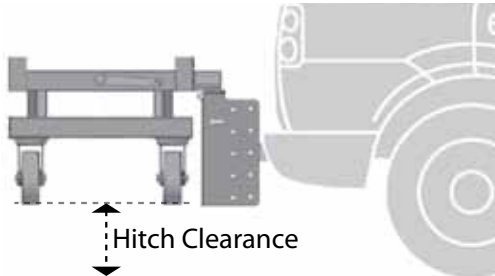

⚠ WARNING ⚠

Do not select a Hitch Clearance setting where a cranked unit height is greater than 33"

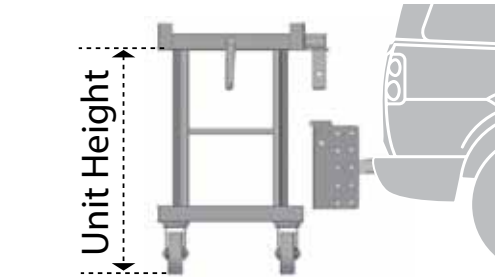

REPLACEMENT PARTS / C.904

REF #	DESCRIPTION	QTY
1	M12 Fender Washer	8
2	Hitch Pin Clip	1
3	Chassi Receiver	1
4	5/8" Hitch Pin	1
5	M12 x 1.75 Hex Head Nut	1
6	M12 x 1.75 x 85 mm Hex Head Cap Screw	2
7	Chassi Shank	1
8	M12 x 1.75 x 90 mm Hex Head Cap Screw	1
9	M12 Lock Washer	3
10	Bronzed Flange Bushing	2
11	Hitch Nipple	2
12	M12 x 1.75 Nylock Nut	4

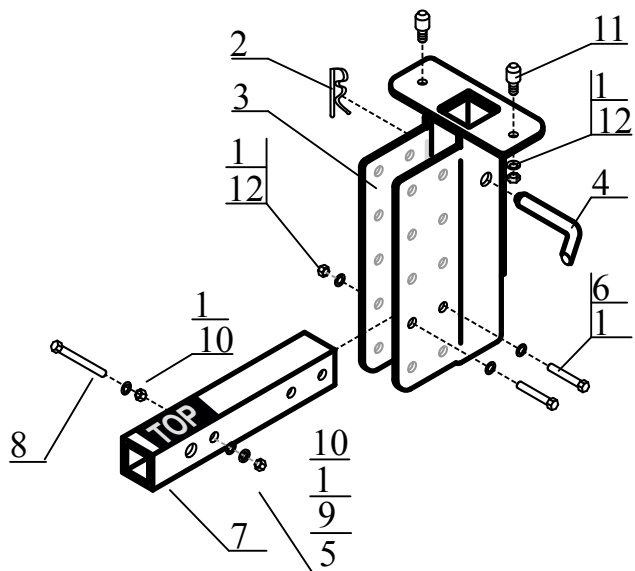

LIMITED WARRANTY

This limited warranty covers ONLY GO! Chassi branded products and it excludes the products of GO! Products direct or indirect subsidiaries. Products sold but not carrying the GO! Chassi brand will be subject to the terms and conditions of the original manufacturer's warranty only and are not warranted for any other purpose by GO! Products. Please review the terms and conditions of the limited warranties below.

All warranties and representations, except as set out below, are hereby disclaimed, (including fitness for purchaser's intended use or purpose and merchantability), all products being sold AS IS, without warranty beyond that made herein, with the purchaser assuming: 1) the entire risk as to the quality and performance of the goods, 2) the cost of any repairs not covered herein.

GO! Products warrants, as limited herein, to the original retail purchaser that its products, which have been properly installed per provided instructions, are free from defect in material and/or workmanship. At GO! Products option, the purchaser's remedy hereunder shall be limited to repair or replacement of defective parts returned to the place of purchase, or to GO! Products at the purchaser's expense.

GO! Chassi warranty, as limited herein, shall only be effective while the original retail purchaser owns the GO! Chassi branded product. The GO! Chassi warranty does not cover normal wear of parts or if any damage is due to misuse, abuse, neglect, accident, improper installation, misapplied, overloaded or contact with on-road or off-road hazards, product modification, improper or inadequate maintenance or any use contrary to the instructions accompanying the product. Further, the GO! Chassi warranty does not cover Acts of God, such as fire, flood, hurricanes or tornadoes.

The GO! Chassi warranty only covers the cost of the defective part and not the cost of removal, installation, painting or other incidental or consequential charges or damages, or personal injury damages, and does not cover use of any product on racing vehicles or vehicles without air-ride suspension. GO! Products does not warrant the paint or painting, including coating of its products. The GO! Chassi warranty is not transferable from the original purchaser.

Duration of limited Warranty

GO! Chassi branded products carry the foregoing limited repaired or replacement warranty for one (1) year period from the date of purchase.

To assure product quality, GO! Products reserves the right to change product designs, materials, specifications and finishes without prior notice to customers. The GO! Chassi warranty gives you specific legal rights and you may also have other rights, which vary, from state to state. Some states do not allow limitations on how long an implied warrant lasts, so the above limitations may not apply to you. Also, some states do not allow the exclusion or limitations of incidental or consequential damages so the above limitations or exclusions may not apply to you. GO! Products reserves the right to discontinue product lines and substitute products or provide other remedies than those listed in the limited warranty for those discontinued products.

Request Warranty Coverage

Replacement parts can be obtained by returning the part along with proof of purchase to the place of purchase. Any returned GO! Chassi branded product that is replaced or refunded becomes the property of GO! Products.

Returns made to GO! Products will not be accepted without prior authorization from GO! Products. This includes but is not limited to shipping costs and other incidental costs. Please call the customer service department at: 866.684.4646 to obtain a Return Material Authorization (RMA) number.

Remedy Limits

Replacement of the GO! Chassi branded products or refund in the manner provided above is Your exclusive remedy and shall constitute fulfillment of all liabilities of GO! Products to You whether based on contract or otherwise. GO! Products shall not be liable or assume responsibility for the loss of the use of any vehicle, loss of time, rental of vehicles, loss or damage to personal property, expenses such as gasoline, telephone, lodging, or towing, or any other incidental or consequential damages incurred as a result of the use or ownership of any GO! Chassi branded products. Some states do not allow the exclusion or limitation of incidental or consequential damages, so the above limitation or exclusion may not apply to You. Any of the above remedy limitations shall be inoperative to the extent they are not permitted by applicable state law.

Warranty

The information contained in this document is subject to change without notice. GO! Products makes no warranty of any kind with respect to this information. GO! Products specifically disclaims the implied warranty of merchantability and fitness for a particular purpose. GO! Products shall not be liable for any direct, indirect, incidental, consequential or other damage alleged in connection with the furnishing or use of this information.

GO! Products, Inc. Elmhurst, Illinois USA

866.684.4646 / GoProductsUSA.com

The particular products you purchase may differ from those shown in these photos. Copyright©2003-2010 GO! Products, Inc. All rights reserved. GO! Products®, GO! Chassi®, GO! Chassi® Box™, GO! Chassi® Chest™, GO! Chassi® Grill™, GO! Chassi® Grill N Chill®, GO! Chassi® Command Post™, GO! Chassi® CSI™, GO! Chassi® Homeland Security™, GO! Chassi® Jammer™, GO! Chassi® Inspector™, GO! Chassi® Lighthouse™, GO! Chassi® Outpost™, GO! Chassi® Powerhouse™, GO! Chassi® Rescue™, GO! Chassi® WildFire™, GO! Chassi® Skid™, GO! Chassi® Skin™, GO! Chassi® Hitch™, GO! Chassi® Taillight Kit™, GO! Chassi® All Terrain Kit™, GO! Chassi® Towers™, GO! Chassi® Tent™, Moving Tools and Applications™, Point to Point Application Delivery™, Serious Heat for Serious Grilling™, Ultimate Tailgating®, Ultimate Tailgating Experience®, Ultimate Fundraising™, Just Add Energy™, Get Your Skin in the Game™ and Just Hitch and GO™ are United States trademarks of GO! Products, Inc. in various international classes. U.S. Patent No. 6,575,155, U.S. Patent No. 6,725,855, U.S. Patent No. 7,249,771, other patents pending.