

Parts and Hardware Identification

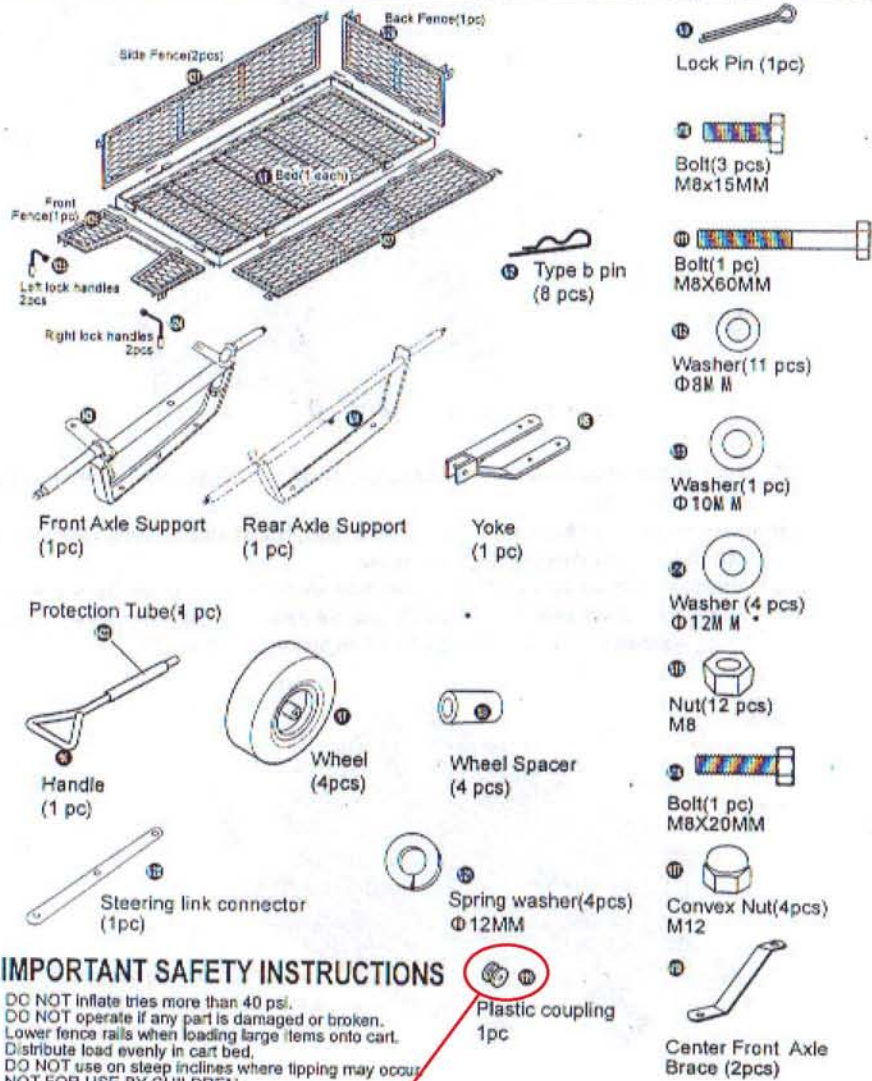

IMPORTANT SAFETY INSTRUCTIONS

DO NOT inflate tires more than 40 psi.
DO NOT operate if any part is damaged or broken.
Lower fence rails when loading large items onto cart.
Distribute load evenly in cart bed.
DO NOT use on steep inclines where tipping may occur.
NOT FOR USE BY CHILDREN.

Different number than illustration

GARDEN CART

Owner's Manual

Save This Manual for Future Reference

CAUTION:

Read, understand and follow ALL instructions before using this garden cart.

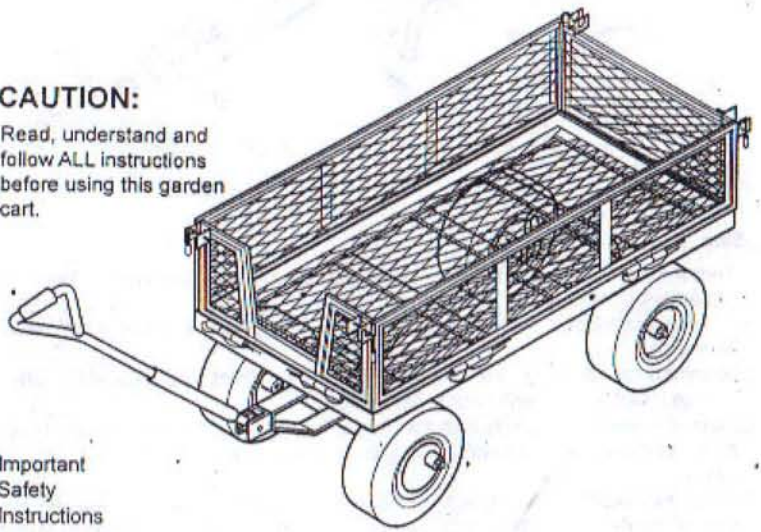

Important Safety Instructions

Assembly Instructions

Parts and Hardware Identification

Assembly Instructions

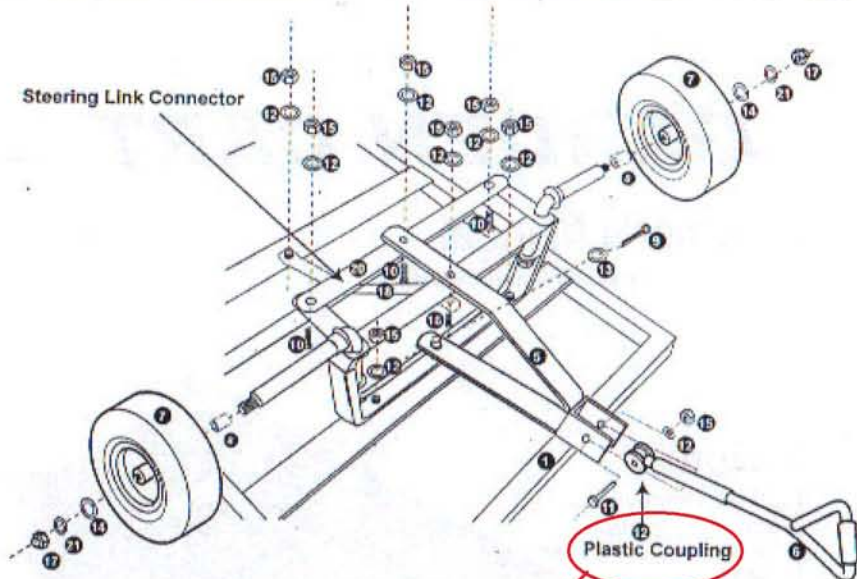

Step 1

Turn the cart Bed(1) upside down. Use the cardboard from the carton to keep from scratching or damaging the finish.

- Turn up the foldable Front Axle Support(3) by 90 degree and lock it with Hex Nut(15) and washer(12).
- Assemble the Steering Link Connector(20) on the Front Axle Support(3) with Nut(15), bolt (10) and washer(12). Don't need to fasten tightly.
- Insert the wheel spacers(8) onto the Front Axle Support(3). Then slide the Wheel(7) into the Axle with the valve stem facing out. Using Washer(14)(21) and Convex Nut(17) to fasten the Wheel(7).
- Place the Yoke(5) to the Front Axle Support(3). Put short side of the Yoke(5) onto the center stud of the Front Axle Support(3) use one Lock Pin(9) and Washer(13) to fasten it. Put long side of the Yoke(5) to the Front Axle Support(3) and Steering Link Connector with Bolt(10) and Nut(15).
- Assemble Center Front Axle Brace(18) on Bed(1) and Front Axle Support(3) with Nut(15) and Washer(12) then fasten.
- Put the Handle(6) and Plastic Coupling to the Yoke(5) using Bolt(11), Washer(12) and Nut(15).

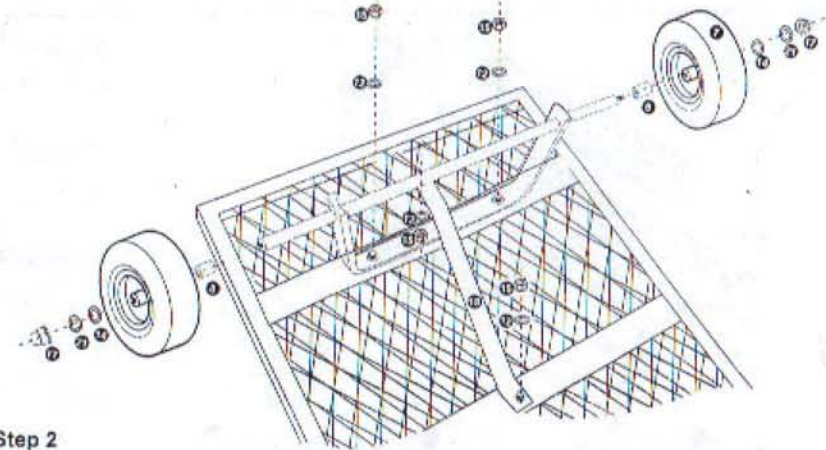

Step 2

- Turn up the foldable Rear Axle Support(4) by 90 degree and lock it with Hex Nut(15) and washer(12).
- Assemble Center Front Axle Brace(18) on Bed(1) and axle on Rear Axle Support(4), use Nut(15) and Washer(12), then tighten.
- Insert the Wheel Spacer(8) onto the extended threaded poles on the Rear Axle Support(4). Then slide the Wheel(7) into the Axle with the valve stem facing out. Using washer(14)(21) and Convex Nut(7) to fasten the Wheel(7).

Step 3

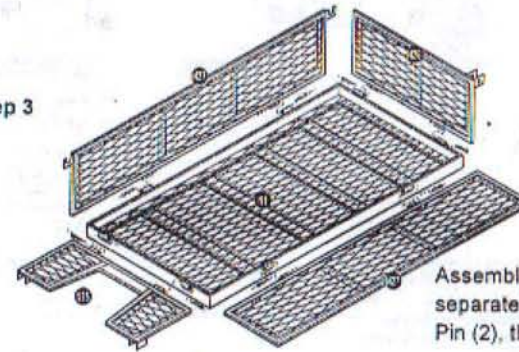

Assemble 4 fences(N25,N26,N27) separately on bed (1) with Type B Pin (2), then connect all the fences.