

- 8P8-PHHC Finish(C)
- 8P8-PHHK Finish(K)
- 8P8-WS1-PHHK Finish(K)

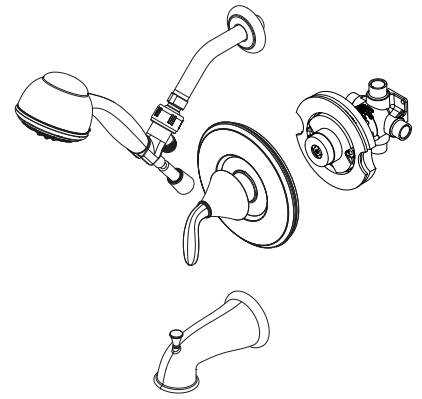

Specifications

Features

- 2.0 GPM (WS1 Only)
- 72" Hose
- OX8 Valve Included
- Multi-Function Handheld with Pause Feature
- Scald Free
- Temperature Control
- Pforever Warranty®

Code Compliance

Pfister products are designed and manufactured in compliance with the following standards and codes:

- IAPMO Certified
- CSA B125 Certified
- ASME A112.18.1
- ADA Compliant-ANSI A117.1 (Lever handles only)
- EPA WaterSense Certification 2.0 gpm, 7.8L/Min (WS1 Only)



Dimensions

