

HAIKE

SUBMERSIBLE AQUARIUM PUMP

OWNER'S MANUAL

HAIKE pumps are carefully tested and certified to ensure both safety and operating performance. Failure to follow the instructions and warnings in this manual may result in pump damage and/or serious injury. Be sure to read, thoroughly understand, and save this manual for future reference.

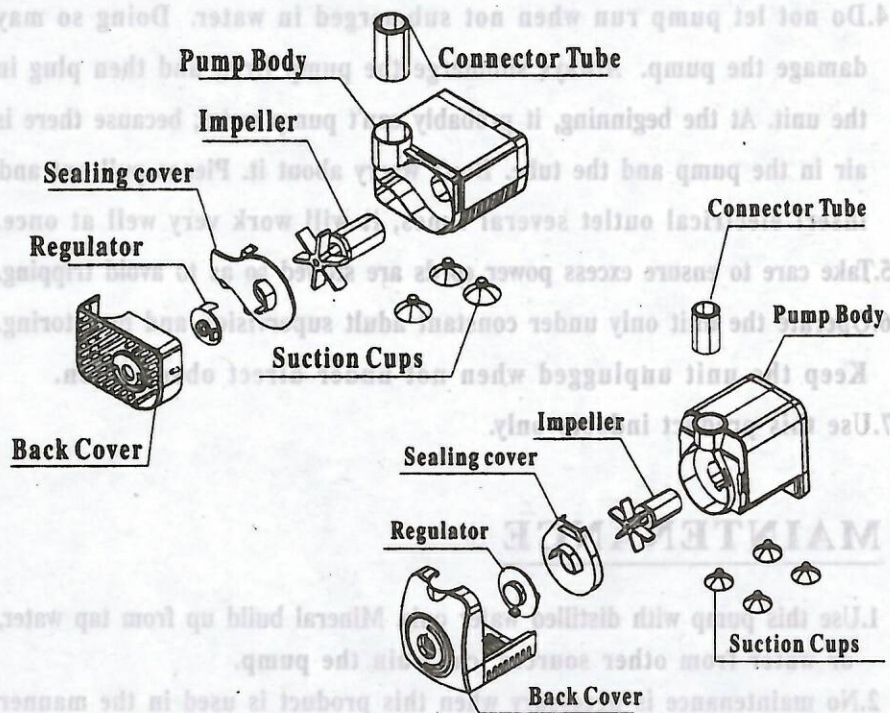

INSTRUCTIONS

1. Only the pump and the electrical cord directly connecting the two are to come in contact with water. Under no circumstances should the other parts come into contact with water.
2. Do not plug-in or otherwise use this product if any part of it appears to be damaged or operates abnormally. Have the product examined and repaired, if necessary, by a qualified electrician.
3. Make a "drip loop" on the electrical cord connecting the pump to the plug by letting a portion of the cord hang lower than either the pump or the plug.
4. Do not let pump run when not submerged in water. Doing so may damage the pump. Always submerge the pump first, and then plug in the unit. At the beginning, it probably can't pump water, because there is air in the pump and the tube. Don't worry about it. Please pull out and insert electrical outlet several times, it will work very well at once.
5. Take care to ensure excess power cords are stowed so as to avoid tripping.
6. Operate the unit only under constant adult supervision and monitoring. Keep the unit unplugged when not under direct observation.
7. Use this product indoors only.

MAINTENANCE

1. Use this pump with distilled water only. Mineral build up from tap water, or water from other sources, can ruin the pump.
2. No maintenance is necessary when this product is used in the manner described in this manual.
3. If debris is caught in the intake vents of the pump, disconnect the pump from any power sources and rinse the pump under clean running water.

PURE GARDEN TIERED COLUMN TABLETOP FOUNTAIN INSTRUCTIONS

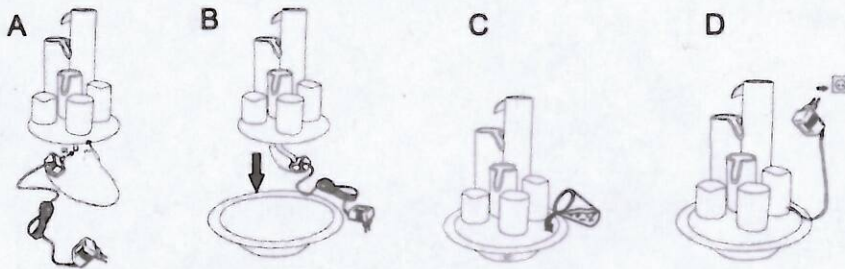

ASSEMBLY INSTRUCTIONS:

STEP 1 - POSITION STATUE PORTION OF FOUNTAIN ON AN EVEN SURFACE. PUSH LED TO THE SHORTER HOSE (A). CONNECT THE PUMP TO THE LONGER HOSE (B).

STEP 2 - POSITION BOWL ON EVEN SURFACE, FILL WITH WATER ©.

STEP 3 - PLACE STATUE PORTION OF FOUNTAIN ONTO BOWL-BASE, ENSURE THE PUMP IS COMPLETELY SUBMERGED IN WATER. LET OUT THE POWER CABLE FROM THE BACK OF THE FOUNTAIN.

STEP 4 - PLACE SMALL STONES AND CANDLES ON THE FOUNTAIN AS YOU LIKE.

STEP 5 - ENSURE THE CABLE IS POSITIONED TO FORM A DRIP LOOP SO THAT NO WATER CAN SEEP FROM THE BACK TO THE MAIN OUTLET/PLUG.

STEP 6 - ONCE FOUNTAIN IS ASSEMBLED, INSERT PLUG INTO PROPER OUTLET (D). WATER MAY TAKE A SHORT TIME TO BEGIN FLOWING AS AIR CLEARS FROM THE PUMP TO THE HOSE. WATER FLOW IS ADJUSTABLE BY LEVER ON SIDE OF THE PUMP.

BE SURE TO DISCONNECT FROM THE MAIN OUTLET BEFORE MAKING ANY FOUNTAIN ADJUSTMENTS

WARNINGS:

- FOR INDOOR USE ONLY.
- CHECK FOR LEAKS & SPLASHING AFTER INITIAL SET-UP.
- DO NOT LEAVE FOUNTAIN RUNNING FOR LONG PERIODS OF TIME AND NEVER UNATTENDED.
- CHECK THE AREA AROUND FOUNTAIN REGULARLY TO ENSURE NO LEAKAGE.

MAINTENANCE:

- KEEP WATER CLEAN TO REDUCE MINERAL BUILD-UP, CLEAN PERIODICALLY.
- ADD WATER PERIODICALLY TO ENSURE PUMP STAYS FULLY SUBMERGED.
- DISCONNECT THE POWER & EMPTY BASIN IF THE FOUNTAIN WILL NOT BE IN USE FOR AN EXTENDED TIME.