

Preparation and Safety Information

IMPORTANT-READ THROUGH ENTIRE INSTRUCTIONS BEFORE BEGINNING INSTALLATION

Safety:

Read and understand the warning on your stepladder and make sure the ladder is in good working order.

Examine all tools needed to insure they are in proper working order before starting.

Power tools that are not internally grounded require power cords and extension cords with a ground prong.

Always wear eye protection when drilling or installing parts.

HyLoft components are made of metal so beware of any sharp edges and do not let any components make contact with electrical current during installation.

DO NOT install more than two HyLoft units on any two framing members.

Preparation:

The HyLoft unit can be installed in any area of garage, provided there is adequate space. When possible install so that all four sides are accessible for convenient loading.

Take care not to block attic or crawl space access, or lights.

If ceiling height allows for it, the unit may also be installed above the open garage door. If installing above an open door, measure between the highest point of the opening garage door and the ceiling to determine if there is adequate room for the unit. You will need at least 25 inches of open space between the ceiling and the highest point of the door during operation.

Clear the area where the HyLoft unit is to be installed, and don't leave autos parked under the unit during installation.

Locate any gas, electrical, and plumbing lines in the garage before drilling holes in the drywall.

Tools Required for Installation:

Hammer

7/16" Nut Driver or Wrench(11.11 mm)

1/2" Wrench(12.7 mm)

Stud/Joist Finder

Eye Protection

Drill and 3/16"(4.76 mm) drill bit

Tape Measure

Pencil

Step Ladder

NOTE: We refer to Joists throughout the instructions. Joists are also called Ceiling Studs or Framing Members.

Knape & Vogt®
Grand Rapids, MI 49505 USA
1-800-253-1561

For more information , accessories and frequently asked questions, visit our web site:
www.Hyloft.com



ASSEMBLY INSTRUCTIONS

24" x 96" Ceiling Mounted Shelf

Item # 00181

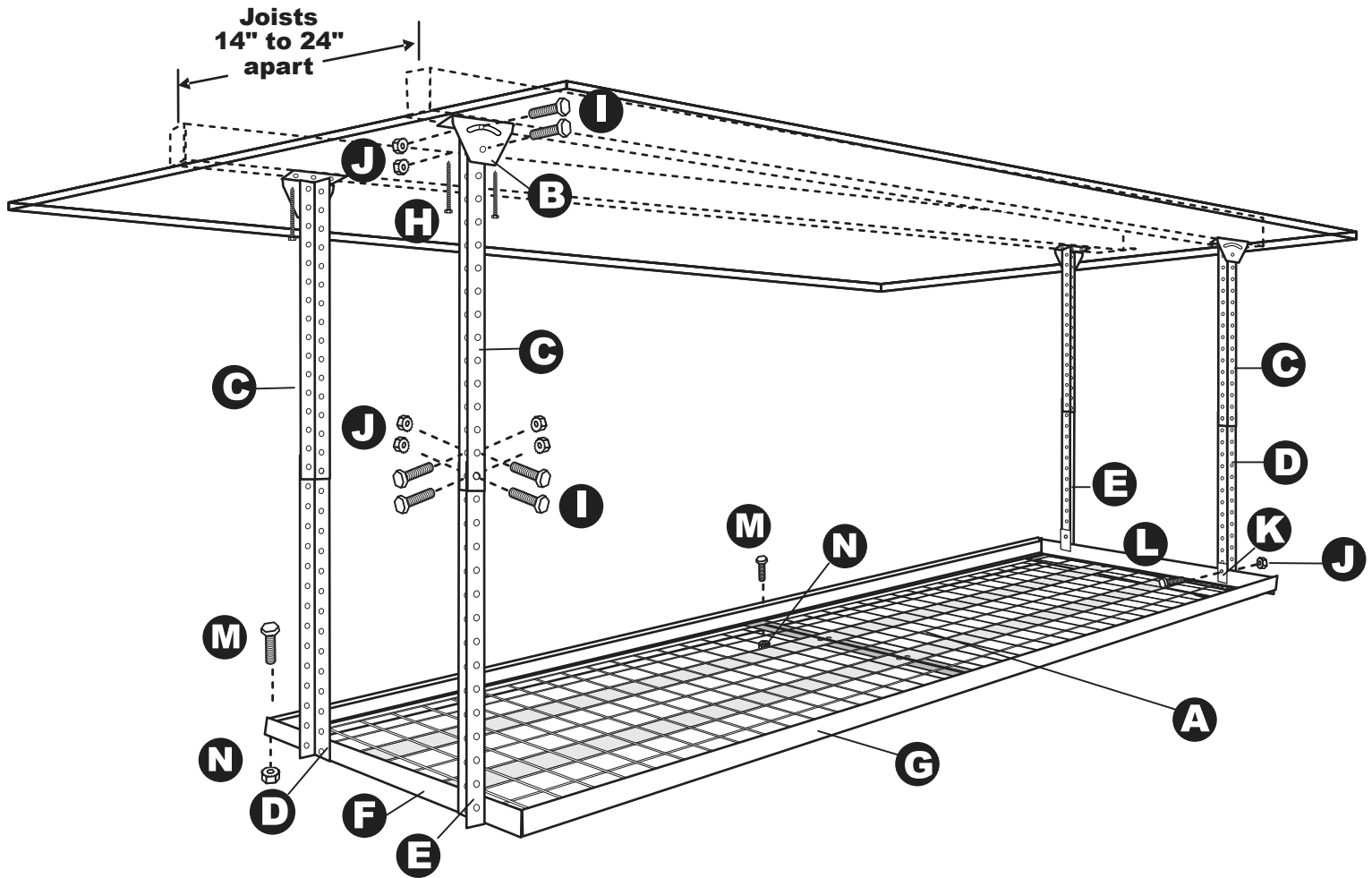

Identify and organize all parts before beginning installation. If any parts are missing, contact HyLoft @ 866-249-5638.

Parts Included:

- | | |
|---|--|
| A 2-Wire Grids-24" x 48" | I 28-Hex Bolts 5/16" X 1/2"(8mm x 13mm) |
| B 4-Angle Brackets | J 32-Hex Locking Nuts 5/16"(8mm) |
| C 4-Downrods Straight | K 4-Clamps |
| D 2-Left Facing Downrods with Feet | L 4-Hex Bolts 5/16" x 2" (8mm x 50mm) |
| E 2-Right Facing Downrods with Feet | M 8-Hex Bolts 1/4" x 1/2" (6mm x 13mm) |
| F 2-24" Support Frames | N 8-Hex Nuts Serrated 1/4" (6mm) |
| G 2-96" Support Frames | O 1-Grid Stiffener |
| H 8-Lag Screws 1/2" X 2 1/2" (1 mm x 63mm) | |

These Instructions and Limited Warranty

IMPORTANT-READ THROUGH ENTIRE INSTRUCTIONS BEFORE BEGINNING INSTALLATION

IMPORTANT-READ THROUGH ENTIRE INSTRUCTIONS BEFORE BEGINNING INSTALLATION

Locate the ceiling joists in the area of desired installation and determine the direction in which they are running. The ceiling Angle Brackets(B) are installed parallel to the ceiling joists. Refer to the diagram below for additional installation clarification.



INSTALL CEILING ANGLES ON 24" SIDE

See separate sheet for alternate mounting situations.

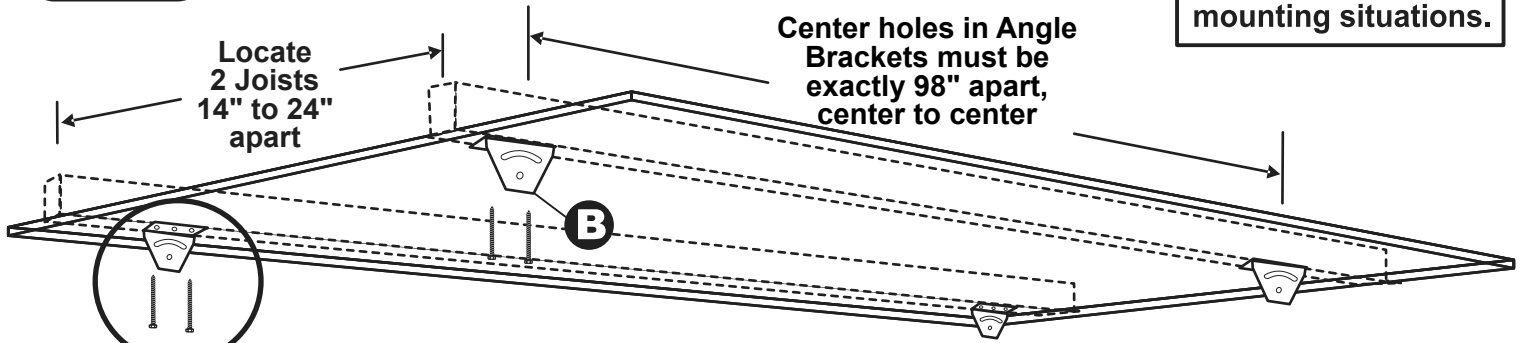

- 1A** Use Center Holes in Angle Brackets(B) as a template to mark holes on stud. Use adjacent joists 14"-24" apart. There must be exactly 98" center to center, measuring between center holes in Brackets(B) along the same joist **TIP**-It may be easier to measure from the outside of first bracket(B) to the inside of the next bracket (also 98").

IMPORTANT-Brackets must be mounted perfectly in line and square to each other.

- 1B** Pre-drill 3/16" holes for each screw. Use a 7/16" Socket Wrench or Nut Driver to install two of the 1/4 x 3" Lag Screws(H) into each Angle Bracket(B).

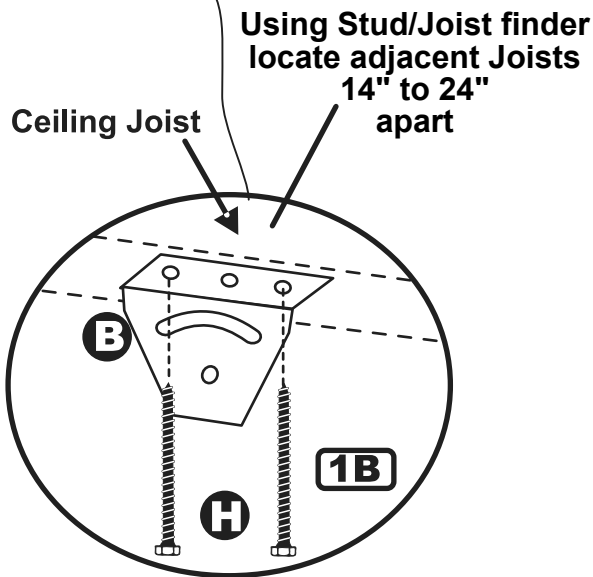

ATTACH DOWNRODS

Determine hanging height and overlap & attach 2 Left Facing Downrods(D) & 2 Right Facing Downrods(E) to each Straight Downrod(C) using 4 Hex Bolts(I) and Hex Nuts(J). Tighten with 1/2" Socket Wrench or Nut Driver.

Attach 4 straight Down Rods(C) to each Angle Bracket(B) using 2 Hex Bolts(I) and Hex Nuts(J). Tighten with 1/2" Socket Wrench or Nut Driver. Make sure one side of each Down Rod(C) is facing the inside where the grids will be and that the Feet on Left and Right Facing Downrods(D & E) are to the inside.

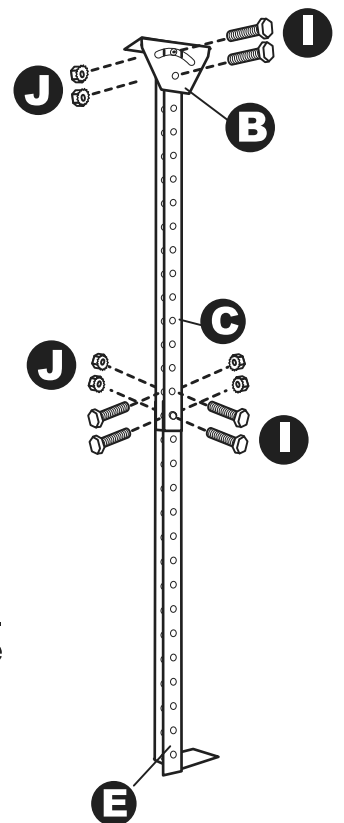

3 ATTACH SUPPORT FRAMES

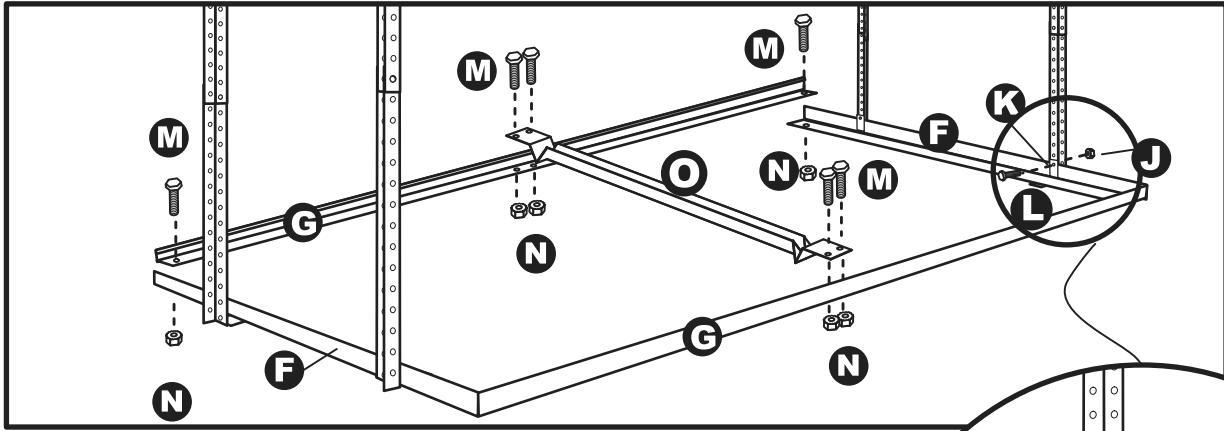

Place two 24" Support Frames(F) on top of feet and using Clamps(K) with thick part up, fasten to downrod using Hex Bolts(L) and Nuts(J). Make sure ends of Support Frames(F) are even and square. Place 96" Support Frames(G) on top of 24" Support Frames (F) and loosely bolt together in each corner using 1/4" Hex Bolts(M) and Nuts(N) using a 7/16" wrench or nut driver. Fasten Grid Stiffener(O) using 1/4" Hex Bolts(M) and Nuts(N) using a 7/16" wrench or nut driver. Do not tighten until after placing grids.

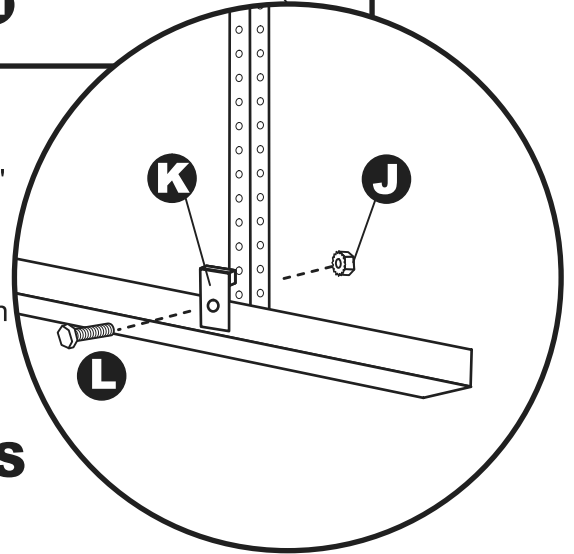

4 PLACE AND ATTACH GRIDS

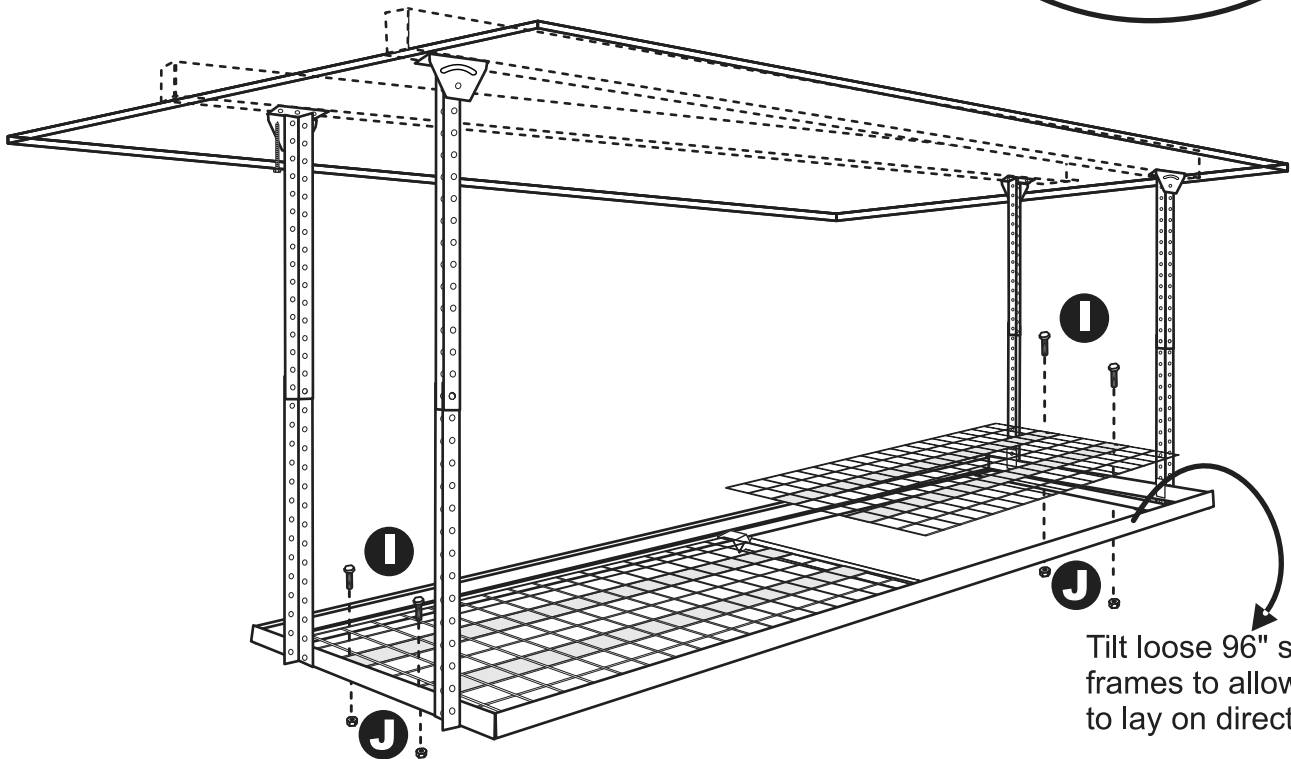

Tilt loose 96" support frames to allow grids to lay on directly on ledge.

Lay 2 Wire Grids(A) evenly on 96" Support Frames with grid stiffeners on the underside. Tilt loose 96" Support Frames if necessary. Ensure that 24" support frames are tight against the 96" support frames and tighten bolts in each corner of support frames using 1/4" Hex Bolts(M) & Nuts(N) with a 7/16" wrench or nut driver. Fasten Wire Grids(A) as shown using 4 Hex Bolts(I) & Hex Nuts(J) for each grid end.

Make sure that all nuts, bolts and screws are tight. Do not load with more than 300 lbs, evenly distributed.

ALTERNATE INSTALLATIONS

Multi-Directional Joists:

If joists change direction, 2 or all 4 Downrods (C&E) can be installed on the 96" side. Rotate direction of Angle Brackets (B) and Downrods (C&E) & install as shown in steps 1-3 of original instructions.

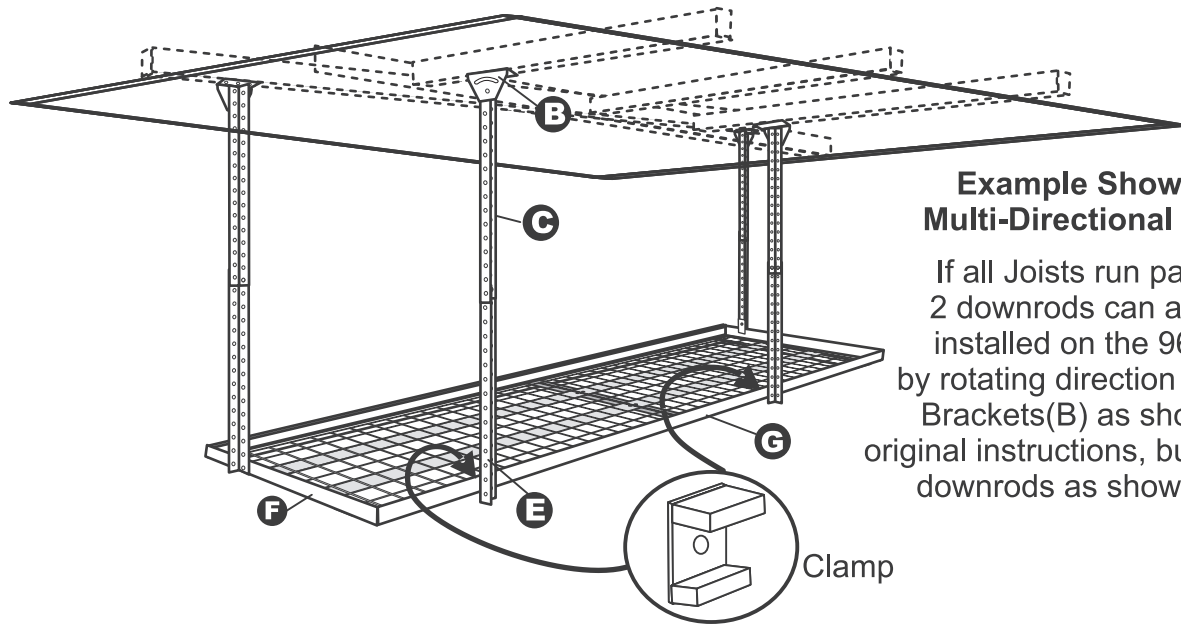

Example Shown of Multi-Directional Joists

If all Joists run parallel, 2 downrods can also be installed on the 96" side by rotating direction of Angle Brackets(B) as shown on original instructions, but installing downrods as shown here.

Peaked or Cathedral Ceilings:

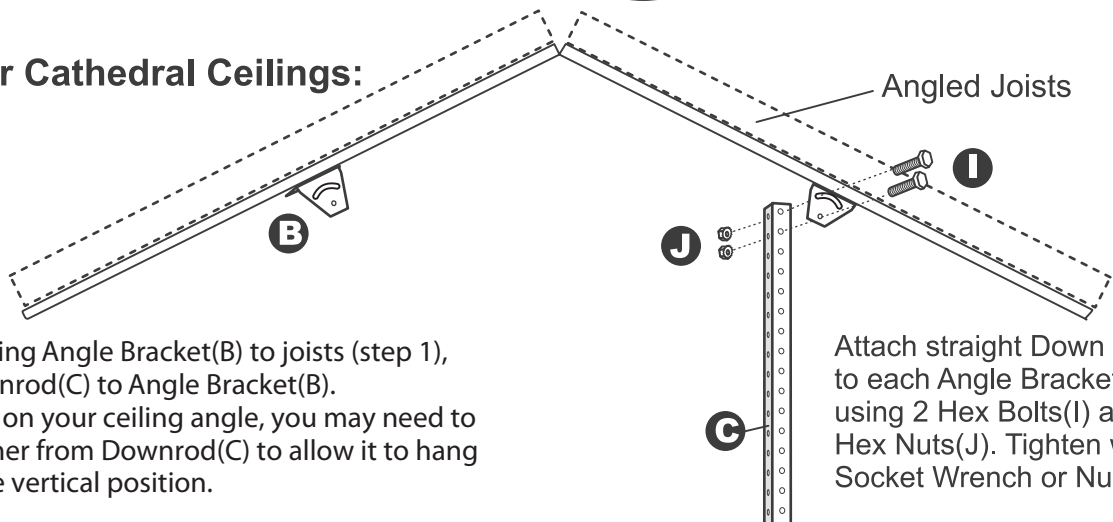

After installing Angle Bracket(B) to joists (step 1), attach Downrod(C) to Angle Bracket(B). Depending on your ceiling angle, you may need to cut the corner from Downrod(C) to allow it to hang down in the vertical position.

Attach straight Down Rods(C) to each Angle Bracket(B) using 2 Hex Bolts(I) and Hex Nuts(J). Tighten with 1/2" Socket Wrench or Nut Driver.

Adjust lower downrods at variable heights if needed so that Support Frames(F&G) will be level when installed. Continue with Steps 3 & 4.

Knape & Vogt®
Grand Rapids, MI 49505 USA