

## MasterBath & MasterBath Elite

Please read prior to installation

### Step 1. Preparation

#### UNEVEN FLOORS AND WALLS

Because floors and walls have uneven spots which will affect the installation, it will be necessary to locate these uneven areas. Wall and floor unevenness can cause cabinets to be misaligned resulting in "racking" or misalignment of the doors and drawer fronts. Uneven spots can be found with a straight edge or a 4' level. Simply run the straight edge along the floor and wall to identify any uneven areas. Where these uneven spots interfere, high spots can be removed by scraping or sanding the excess plaster. Low spots can be shimmed.

#### LOCATE STUDS

Locate the wall studs with a stud finder or tap on the wall to locate a "solid sound." This generally will tell you where the wall studs are located. You can verify this location by driving a small finishing nail into the wall. Make sure this is an area that will be covered by the base cabinets. Mark a chalk line at the center of the wall studs at the top and bottom of the cabinet position. Normally the wall studs are located 16" apart, center to center.

#### CABINET HEIGHT

To establish the height of your base cabinets, measure up and mark the wall at 33½" from the highest spot on the floor. Use this mark as a starting point and draw the lines around the bathroom. Mark the outlines of all cabinets on the wall to check actual cabinet dimensions against your layout (Figure 1).

#### HARDWARE

Decorative and installation hardware such as nails, screws, glue, tape, etc. are not included.

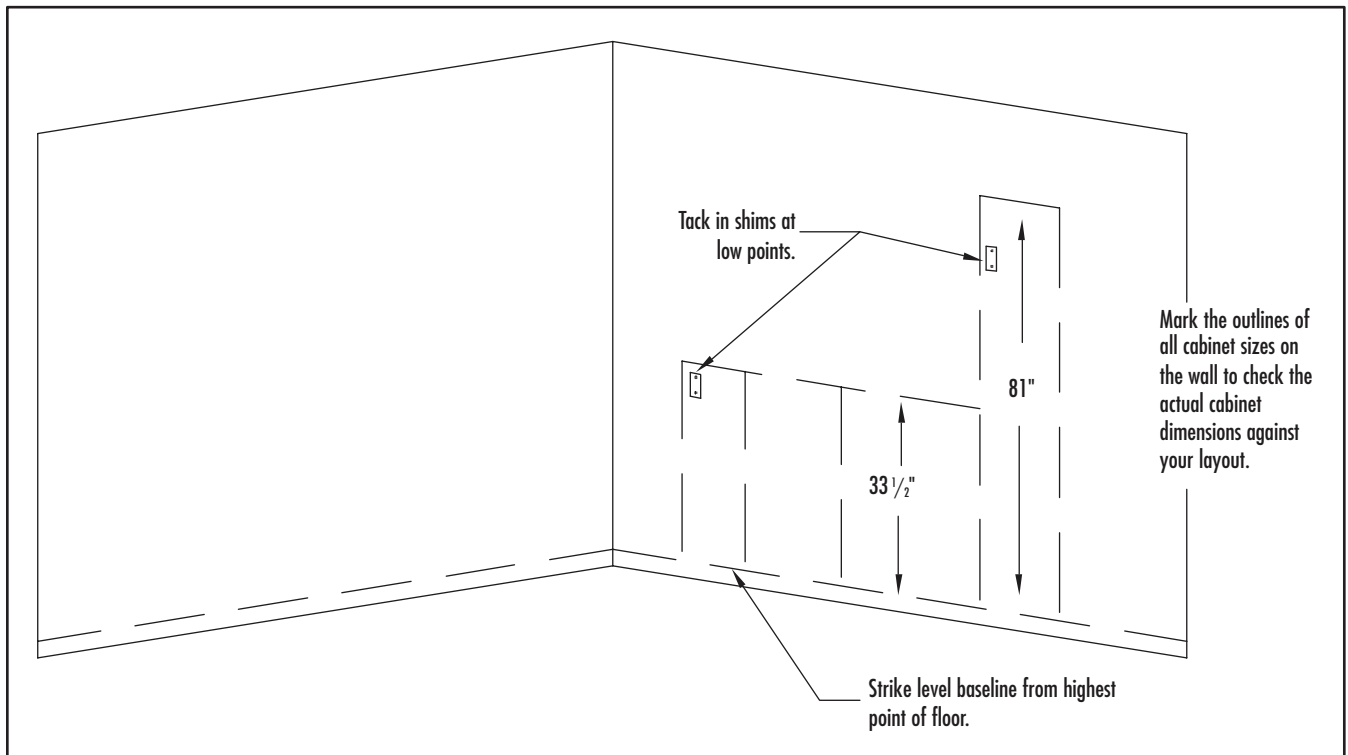

Figure 1

## Step 2. Flush Fit End Panel Application Instructions

Before beginning the cabinet installation, you will need to apply the finished overlays to the side (s) of the cabinet or run of cabinets that will be exposed to the room. Just follow the below simple steps to apply the flush fit end panels.

### Materials:

Finished Flush Fit End Panel, Roll of Double Sided Tape (Suggest 1 roll per flush fit end panel) or construction adhesive. (Neither are provided.)

### Toe Notch Instructions

Note: If flush fit end panel is on the left side of cabinet, the toe notch will be on the right side of the flush fit end panel. If the flush fit end panel is for the right side of the cabinet, the toe notch will be on the left side of the flush fit end panel.

Toe notch out the flush fit end panel.

- a) Line up the bottom of toe notch with the bottom of the overlay
- b) Using a pencil draw a line along the edge of the toe notch
- c) Using a jigsaw or hand saw, cut along the line. Make sure the saw blade is inside the toe notch area, which will be removed.
- d) Any left over pencil marks can be erased with a pencil eraser.

**1.** Cut and apply double sided tape to flush fit end panel or use construction adhesive (Figure 2). If using construction adhesive, use tape guidelines as glue guideline and then move to Step #2.

- a) Cut the roll of double sided tape into strips. Cut tape strips to the lengths and quantities listed on the tape template. You will need approximately one roll of tape for each flush fit end panel.
- b) Apply the tape to the flush fit end panel following the tape template diagram. Tape strips applied along the edges of the flush fit end panel should be 1/4" from the edge.
- c) As you apply each tape strip, run your finger along the strip, applying pressure to make sure the tape makes complete contact with the flush fit end panel.

**2.** Apply flush fit end panel to cabinet side panel

- a) Remove the backer from each tape strip.
- b) Holding the flush fit end panel at an angle from the cabinet side panel, slide the front edge of the flush fit end panel into the face frame groove. Make sure the entire edge of the flush fit end panel is seated inside the face frame groove.
- c) Align the top of the flush fit end panel with the top of the cabinet side panel and press the flush fit end panel against the side panel.
- d) Working from front to back, apply pressure along the entire surface of the flush fit end panel to make sure each tape/adhesive strip makes complete contact with the cabinet side panel.
- e) Allow the tape/adhesive to cure for 1 hour before proceeding with the cabinet installation.

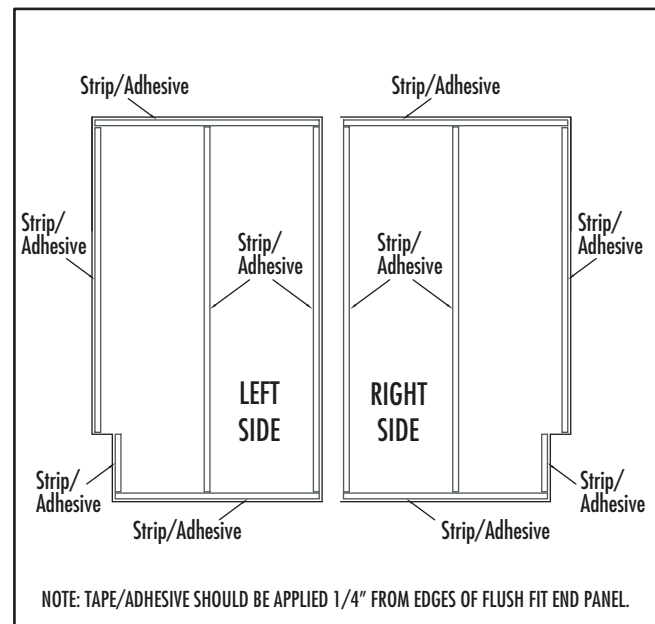

Figure 2

# Step 3. Cabinet Installation

## INSTALL HUTCH OR LINEN CROWN MOLDING (if necessary)

Crown molding, sold separately, can be installed on the Hutch or Linen cabinet. The length of crown molding pieces will need to be cut from the full length piece. You will need to miter the pieces to fit the Hutch or Linen. Please see Figures 3 and 4 on how to install the crown molding to the cabinet. If your Hutch or Linen will be installed with a side against a wall it is not necessary to attach molding to the side against the wall. Cut to fit your wall (Figure 5).

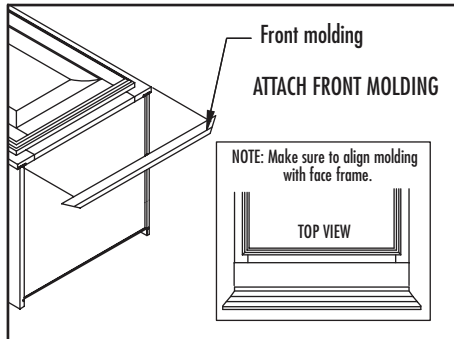

Figure 3

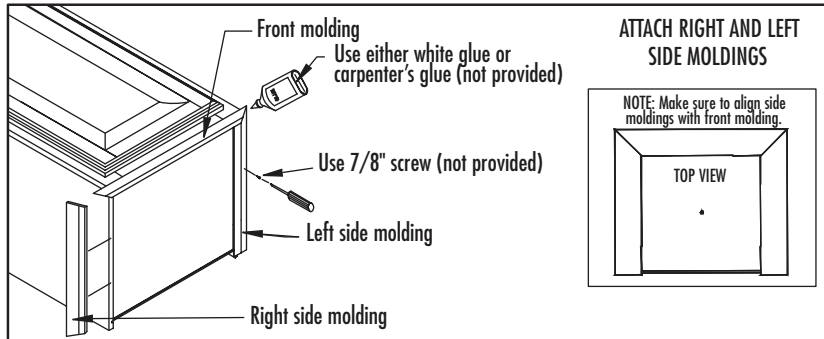

Figure 4

## 2-PIECE LINEN ASSEMBLY

The 15" Linen, 18" Linen with Drawers and 18" Linen with Doors are 2-piece units that require assembly prior to installation. Place the upper linen unit on top of the lower linen unit. The upper unit has six attachment brackets in place at the bottom, interior of the unit (Figure 6).

If you purchased a linen with drawers, you need to remove the drawers to have access to the attachment brackets on the upper unit. Reach through the back or front of the bottom unit to remove one screw on each attachment bracket so the bracket hangs down vertically (Figure 7). Align the upper and lower units, first making sure the front of the linens (face frame) line up, then the sides. (The overall width of one unit may be slightly larger than the other unit. This is normal and does not compromise the functionality or structural integrity of the units.)

Once the top and bottom units are aligned, secure the two together by screwing the front two brackets to the face frame of the lower unit first. Then repeat process for each side panel. Attaching the two front attachment brackets first and then the brackets on each side last will create proper alignments.

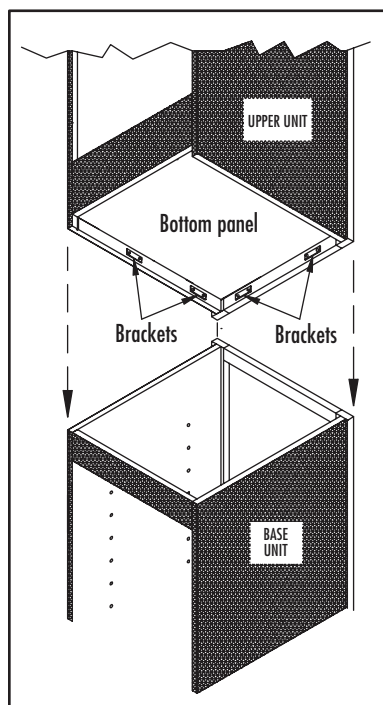

Figure 6

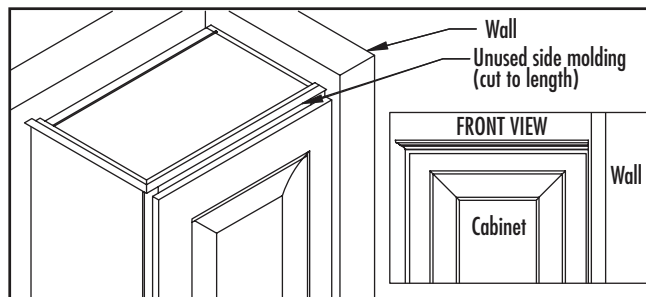

Figure 5

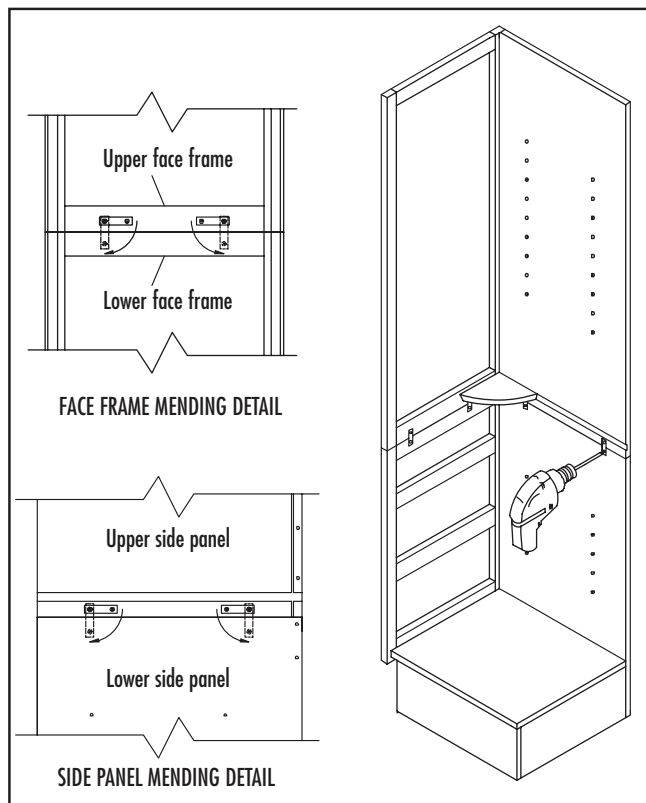

Figure 7

## LINEN INSTALLATION

Hardware for installation not included. To fasten the linen to the wall, drill pilot holes at the stud location through the top back rail, then fasten with #8 x 2" screws. If the linen sits in between the studs, you will need to use toggle bolts to fasten to the wall. It is not recommended to place the linen in a corner where the back is not against a wall.

**NOTE:** A 3" Linen Filler must be used if one side of the linen is placed next to a wall. This will prevent doors and drawers from rubbing.

The linen comes with two side molding pieces to install over the seam line between the upper and lower units. If a side of the linen is against a wall or cabinet DO NOT install these pieces on that side. If a side of the linen IS NOT against a wall or cabinet, use finishing nails (not provided) to nail the side molding over the seam line. Three to four finishing nails per side should be sufficient. Use the color stick provided in the parts bag to color over the top of the finishing nails to hide the nail heads. Install one side molding piece per side.

## INSTALL BASE CABINETS

**NOTE:** Fillers must be used when a drawer bank or vanity is next to a wall. Minimum of 1/4" or drawers will rub.

When starting the installation process, it is very important to start your installation from a corner wall and work out. If the wall is not straight, you may need to use a filler and scribe it to the wall's shape (Figure 8). Fillers may also be used to accommodate wall to wall installations where the cabinets do not fit exactly.

Once you have identified the starting point, take the first cabinet and shim it to the previously established level line. Drill pilot holes at the stud location, through the back rail and into the studs. Then securely fasten the cabinet to the wall, using #8 x 2 1/2" screws and appropriate anchors (Do Not Nail). Make sure the cabinet remains square and level after wall attachment.

## ATTACH CABINETS TOGETHER

Once you have securely fastened the starting cabinet to the wall, line up the front of the cabinets and use "C" clamps to simply join the next cabinet to it. Place the "C" clamps on the adjoining stiles and carefully clamp the two together. Carefully line up the top and shim the bottom of the cabinets. Now drill a pilot hole, using a 1/8" drill bit, through the adjoining stiles. Once done, draw the two together, use two #8 x 2 1/2" wood screws (Figure 9).

**NOTE:** When securing a 24" curved base cabinet to another cabinet, use two #8 x 2 1/2" woodscrews (Figure 10).

Installation Tip: Use a little wax on the screws to help seat them into the wood.

Continue installing the remaining base cabinets in the same manner. After joining all of your base cabinets together, verify all cabinets are level and secure each cabinet to the wall.

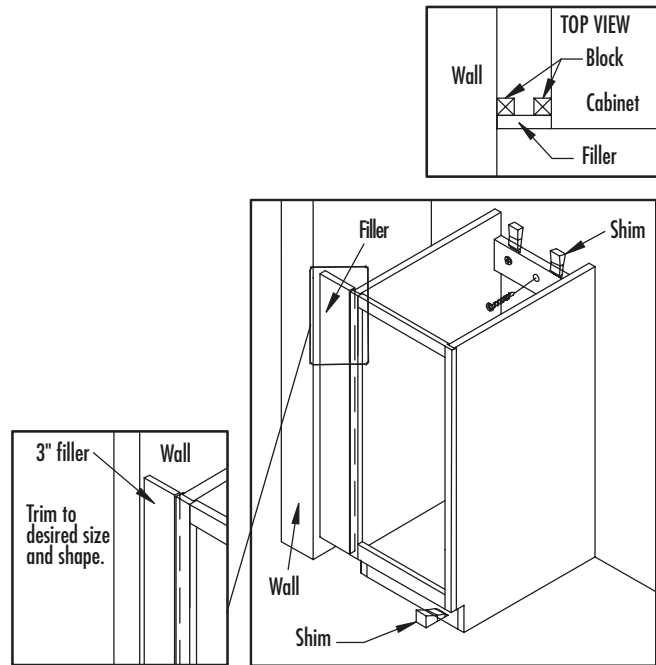

Figure 8

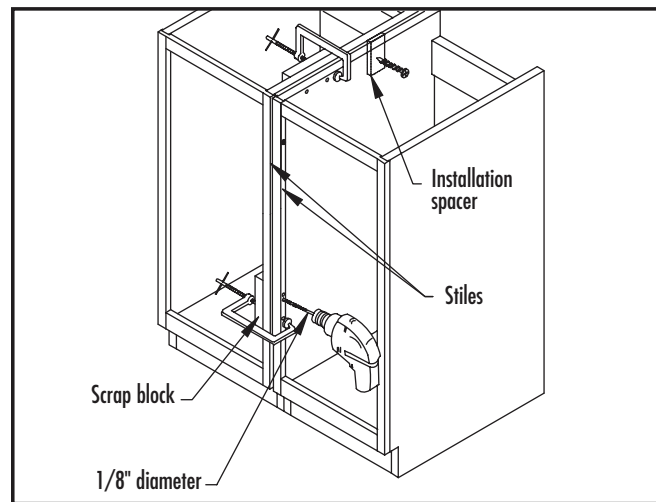

Figure 9

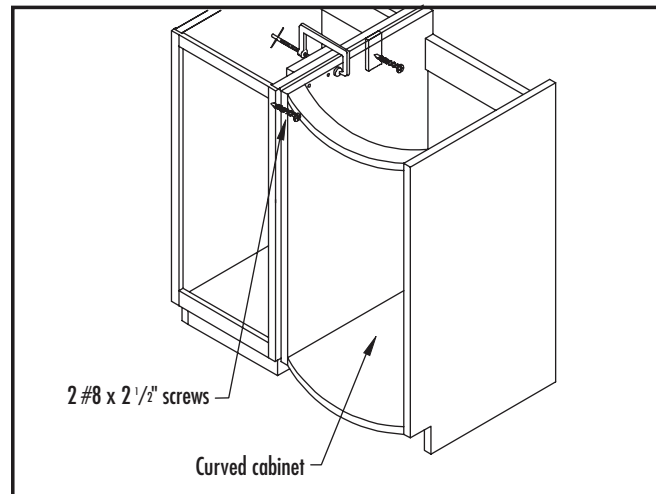

Figure 10

## Step 4. Specialized Cabinet Installations

### KNEE DRAWER

Your knee drawer can be installed by either mounting it to the sides of the adjacent cabinets or directly to the underside of your countertop.

#### A. COUNTERTOP INSTALLATION (recommended)

Start the knee drawer installation by using the screws provided to connect the angle brackets to the drawer glides (Figure 11), then install the knee drawer to the underside of the counter top (Figure 12).

#### B. CABINET TO CABINET INSTALLATION

Ensure that cabinets are approximately spaced at 24". (Figure 13) Attach to cabinet side with the #4 x 3/4" screws and plastic spacers as shown. (Figure 14)

### HUTCH

Install the hutch after you have completed installing all of the base cabinets and the counter top. Set the hutch on top of the counter top. Fasten the hutch by drilling pilot holes at the stud location through the back rail. Then fasten the hutch to the wall with #8 x 2" screws. If the hutch sits in between the studs, you will need to use toggle bolts to fasten the hutch to the wall. For water protection it is recommended that you caulk the hutch to the countertop or to install a side splash around the bottom edge of the hutch (Figure 15).

### LINEN

Your 15" or 18" Linen can be installed as part of a cabinet run, or as a standalone unit. In either case, fasten the linen by drilling pilot holes at the stud location through the back rail. Then fasten to the wall with #8 x 2" screws. If your linen sits in between the studs, you will need to use toggle bolts to fasten to the wall. If your linen is used in a corner where the back is not against a wall, secure your unit with furniture restraint hardware, such as wall anchor rings and cable restraints. This will prevent the linen from toppling over.

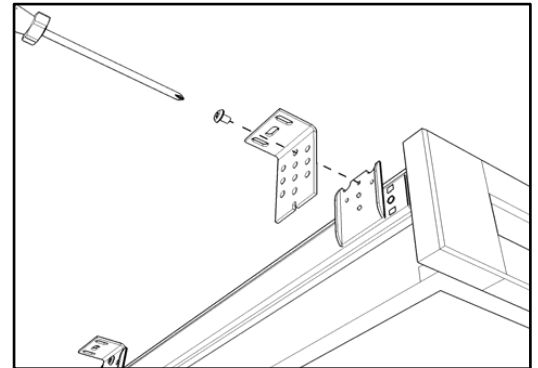

Figure 11

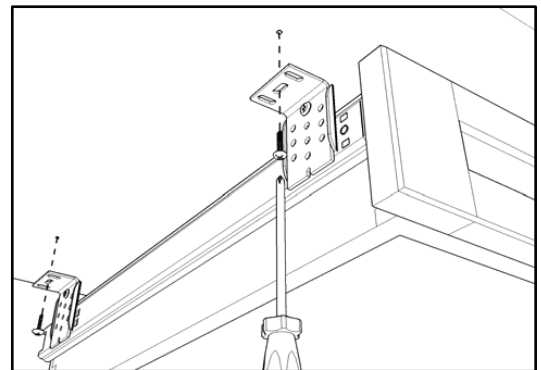

Figure 12

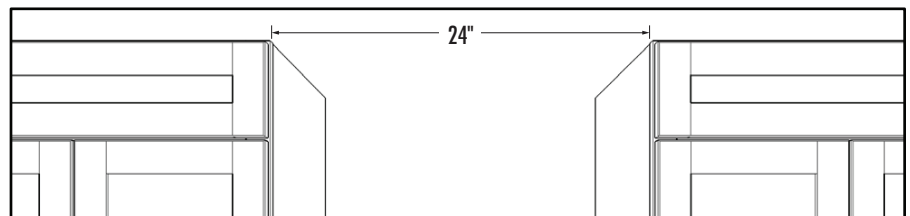

Figure 13

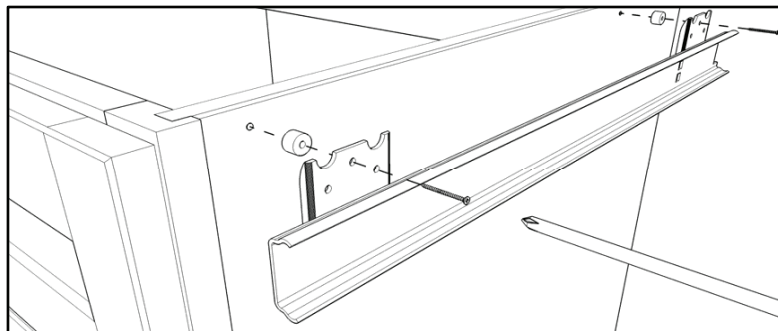

Figure 14

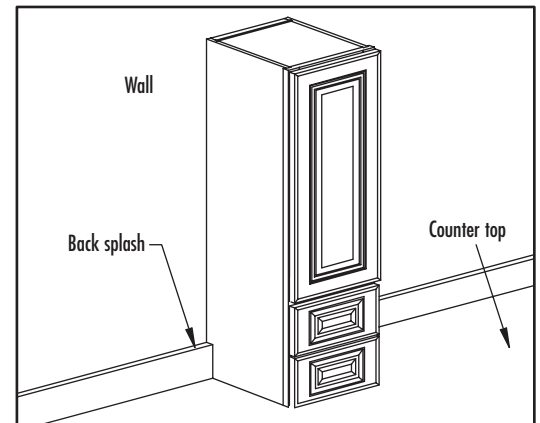

Figure 15

## Step 5. Changing the Door Swing

Because some installations require a cabinet door to open in the opposite direction, it may be necessary to switch the hinges from one side of the cabinet to the other. You must first remove the door by unscrewing the hinges from the face frame. Then using a  $\frac{3}{32}$ " diameter drill bit, drill holes  $\frac{3}{4}$ " deep on the other side of the face frame. Rotate the door 180 degrees and screw the hinge onto the opposite side of the face frame (Figures 16 and 17).

## Step 6. Hinge Adjustment

It usually is necessary to adjust your hinges once you have finished the installation of your cabinets (Figure 18).

## Step 7. Drawer Adjustment

### DRAWER GLIDES – MASTERBATH

To adjust the alignment of the glides you must first remove the drawer from the cabinet. Push both glides outward toward the sides of the cabinet until they stop (Figure 19). Set the drawer back in the glide tracks and push the drawer all the way into the cabinet. The glides will align automatically when the drawer box is pushed back in. Slide drawer back 5-6 times to self adjust.

### DRAWER GLIDES – MASTERBATH ELITE

To remove the drawer from the cabinet, extend the drawer to the outer most location. Then reach underneath the drawer to the attaching clips located at the front of the drawer box. Then squeeze the clips pulling toward you which will release the glides from the drawer box. The drawer will now be ready to be removed. Lift the drawer away. To reinstall the drawer, make sure glides are pushed in all the way into the cabinet. Set the drawer back in the glide tracks and push the drawer all the way into the cabinet. When the clips attach to the glide you will hear a click. The glides will align automatically when the drawer is pushed back in.

### DRAWER FRONT

Make all drawer front adjustments prior to installing handle hardware. Drawer fronts can be adjusted by simply loosening the screws that are screwed into the back, and adjusting the drawer fronts accordingly. The holes are oversized on the drawer box to allow for perfect drawer front alignment (Figure 20).

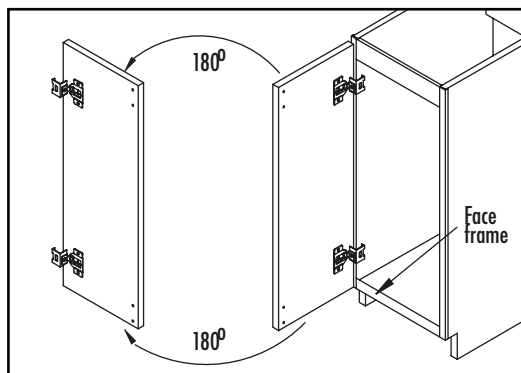

Figure 16

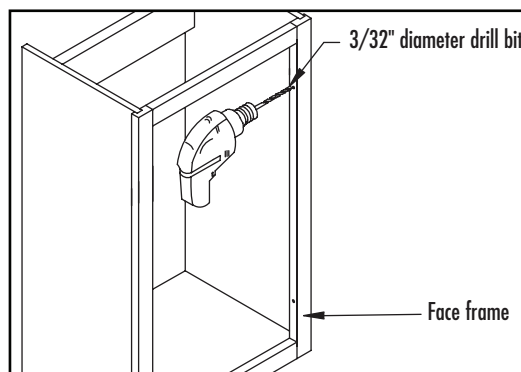

Figure 17

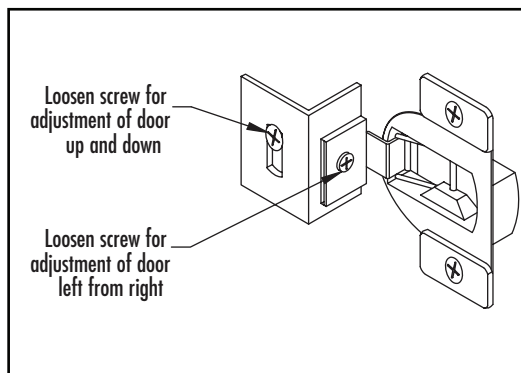

Figure 18

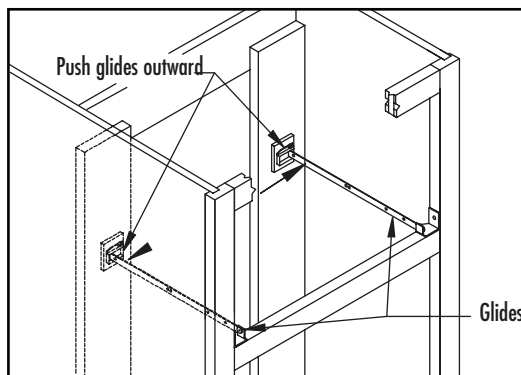

Figure 19

## Step 8. Drill for Hardware

(Hardware sold separately)

### DRAWER FRONT HARDWARE PLACEMENT

Hardware Placement Guide provided

Measure the exact width and determine the center point of the drawer front. Align the drawer hardware placement guide directly over the center point of the drawer front. For a knob, mark the center point. For a handle, mark the outside points that correspond to the exact width of the desired handle hardware. Drill from the outside of the drawer to the inside. A  $3/16''$  drill bit is recommended to allow for final adjustments for exact alignment (Figure 21).

### DOOR HARDWARE PLACEMENT

Hardware Placement Guide provided

Place the handle hardware guide on the corner of the cabinet door where you would like to have your handle located. Mark the point on your door that corresponds to the size of your handle hardware and your door finish. Please note that you must use the outside holes for the Satin White door finish. Drill through your marks from the outside of the door to the inside. A  $3/16''$  drill bit is recommended to allow for final adjustments to exact alignment (Figure 22).

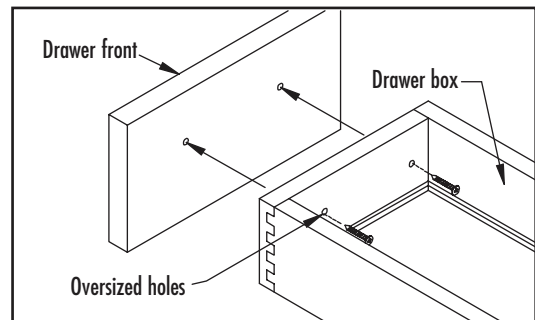

Figure 20

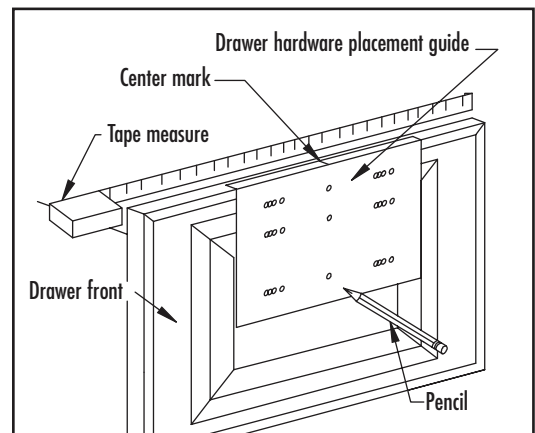

Figure 21

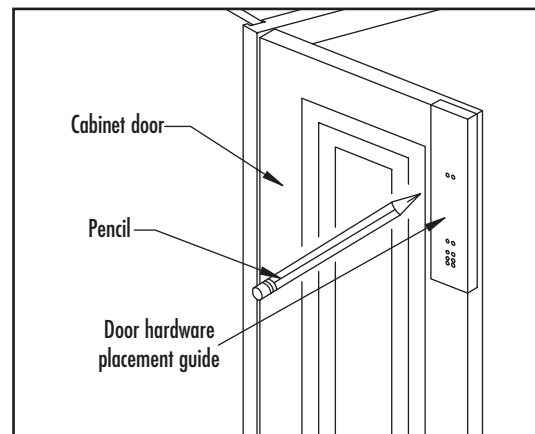

Figure 22

Every effort was made to provide you with an accurate template, but we cannot be held responsible for the final print quality. Always do a visual check prior to actual drilling.

## 9. Standard Fillers /Decorative Fillers

Decorative Fillers: In contrast to standard fillers, which are trimmed for a proper fit to complete a cabinet run, decorative fillers require a 3" spacing between cabinets.

### STANDARD CABINET INSTALLATION

- Space cabinets 3" apart.
- Clamp filler and any necessary shims in place just behind cabinet face frame (Figure 23).
- Pre-drill holes through cabinet side at a position 3/8" behind face frame (two holes on right side and two holes on left side). Use a 3/16" drill bit.
- Secure filler in place with #6 x 1 5/8" screws.
- Remove clamps.

### CURVED FRONT CABINET

- Space cabinets 3" apart.
- Clamp filler and any necessary shims in place. Shim to be used on cabinet adjacent to curved cabinet (Figure 24).
- Follow remaining instruction under "Cabinet Installation" above.

## Step 10. Toe Kick Installation

The toe kick should be attached once all of your cabinets have been installed and secured to the wall. Cut the toe kick to your exact dimensions. Use small finishing nails to attach the toe kick to your cabinets. It is recommended that a bead of high quality caulking material be used to seal the toe kick to the floor (Figure 25). Use touch up fill stick (provided) on any exposed edges of the toe kick.

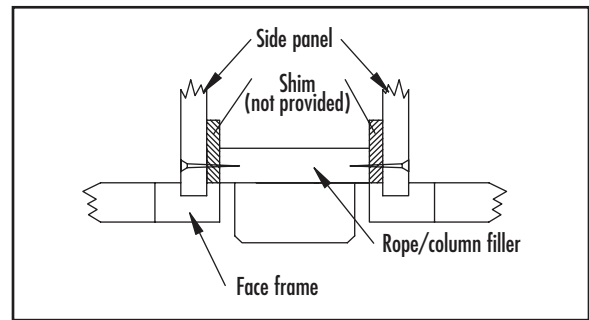

Figure 23

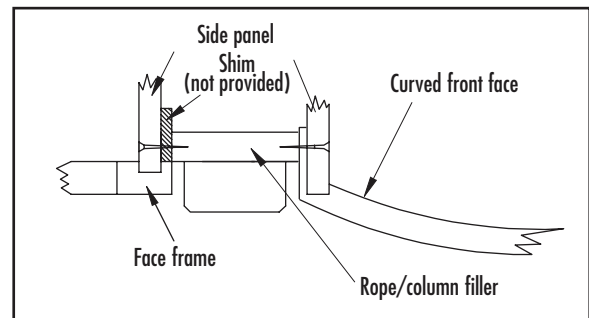

Figure 24

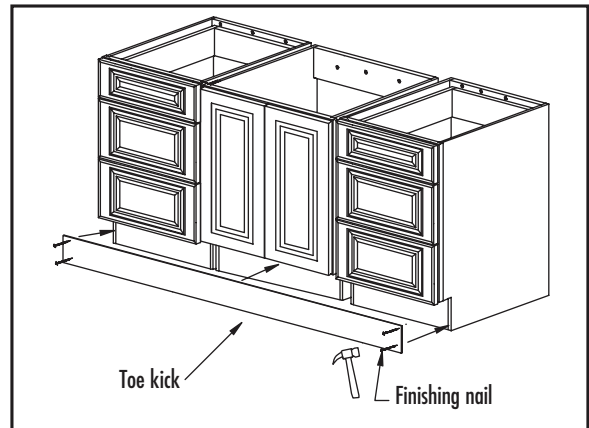

Figure 25



# 11. Bath Storage Topper/Wall Hatches

For your convenience, matching crown molding has been included with your Bath Storage Topper or Wall Hatch.

To install, simply set the molding on top of the cabinet. Make sure the molding is aligned side to side on the face frame. Additionally, make sure the front, bottom edge of the crown molding lines up with the outer edge of the door. Mark pre-boring locations on face frame with a pencil. Drill into face frame with a 3/16" drill bit. Screw crown to cabinet using #6 x 3/4" wood screws (not included) (Figure 26).

- To hang cabinet, it will first be necessary to locate the studs in the wall (in some cases where a stud location will not work, it will be necessary to use a Hollow Wall Anchor).
- After locating the studs, you will need to pre-drill holes through the back panel.
- Place the cabinet into place, and using a #8 x 2" wood screw, secure the cabinet to the wall (Figure 27).

## Step 12. Decorative End Panel

- Decorative End Panel is installed over the flush Fit End Panels. See Step 2.
- Remove the cabinet door. This allows access to clamp the end panel.
- Pre-drill eight holes around perimeter (1" from edge) of cabinet side panel from the inside (Figure 28).
- Measure down 1/4" from the top of the cabinet. Make a pencil mark. Align top edge of end panel with pencil mark and secure to cabinet with clamps.
- Secure the end panel to the cabinet using #6 x 1" wood screws (Figure 29).

**CAUTION:** Never secure decorative end panel by inserting screws into center of the panel.

## Step 13. Mirrors

Determine where to hang the mirror. Using the mirror clips on the mirror, measure the correct spacing and mark on to the wall. Determine if studs are located at the marks. Hollow wall anchors will need to be used if no studs are located in the desired hanging location. You may also use hanging wire to hang the mirror from a single stud or wall anchor. Hardware must be capable of supporting 75 lbs. (34 kg) minimum.

- Drive screws into studs or wall anchors, making sure the screws are level. Use at least a 1 1/4" wood screw.
- Clip mirror onto screw heads.

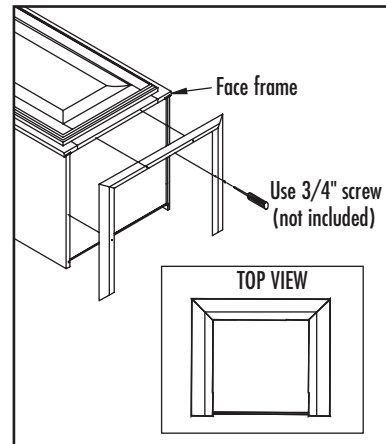

Figure 26

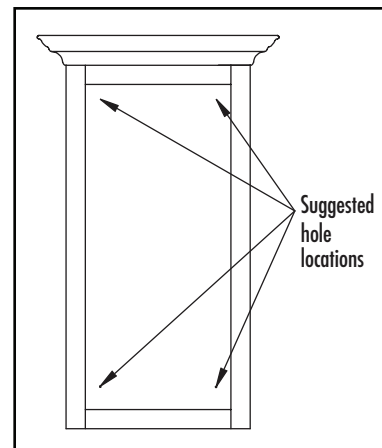

Figure 27

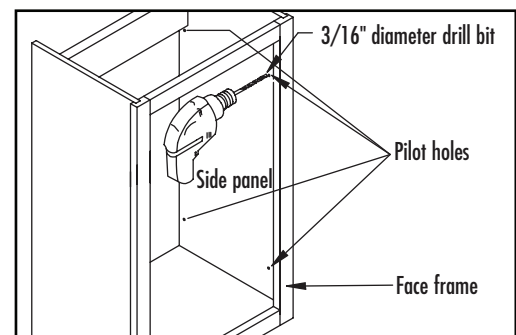

Figure 28

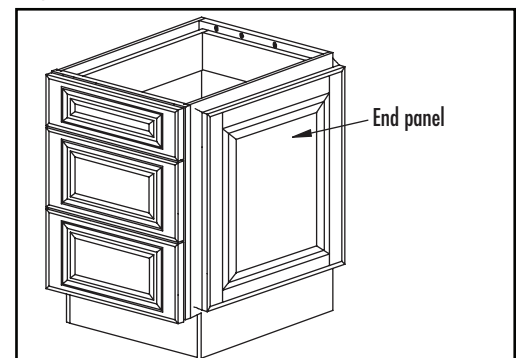

Figure 29

## Step 14. Furniture Rail

Before installing the Furniture Rail you will need to install the standard  $\frac{1}{8}$ " finish toe kick.

- Fit up furniture rail to cabinets. If trimming of the furniture rail is required, do not trim off one end. Cut the desired length out of the center of the furniture rail and rejoin. This will preserve the edge detail.
- Clamp the furniture rail into place.
- Measure 1" from front of cabinet bottom panel. Pre-drill into the furniture rail with a  $\frac{3}{16}$ " drill bit. Be careful NOT to drill too far into the furniture rail (Figure 30).
- Secure furniture rail into place with #6 x 1" wood screws.
- Remove clamps.

## Step 15. Toe Kicks

Before installing a Decorative Toe Kick, you will need to install the standard  $\frac{1}{8}$ " finish toe kick.

When installing the decorative toe kicks (straight or curved) it will be necessary to remove the doors or drawers from the sink base cabinets or drawer banks (the decorative toe kick is designed to fit under the sink base or drawer bank in the cabinet run).

- Once the doors are removed, clamp the toe kick into place.
- Measure in 1" from the front edge of the base cabinet floor (or just behind the face frame).
- Using a  $\frac{3}{16}$ " drill bit, pre-drill three holes.
- Using #6 x 1" wood screws, secure the toe kick into place (Figure 31).

## Step 16. Surface Mount Medicine Cabinet

**IMPORTANT:** Before beginning assembly, carefully remove all parts from carton. Make sure you have all the parts listed below. To make assembly easier, please review the assembly instructions prior to assembly.

### 1. ATTACH CROWN MOLDING TO CABINET.

For your convenience, matching crown molding has been included with your Medicine Cabinet. Determine location of hinge holes for left or right swing before you install crown. (Figure 32).

- Set the molding on top of the cabinet. Make sure the molding is aligned side to side on the face frame. Additionally, make sure the front, bottom edge of the crown molding lines up with the outer edge of the face frame.
- Mark pre-boring locations on face frame with a pencil.
- Drill into face frame with a  $\frac{3}{16}$ " drill bit.
- Screw crown to cabinet using #6 x  $\frac{3}{4}$ " wood screws (not included). Refer back to Figure 26 of Step 11 for diagram.

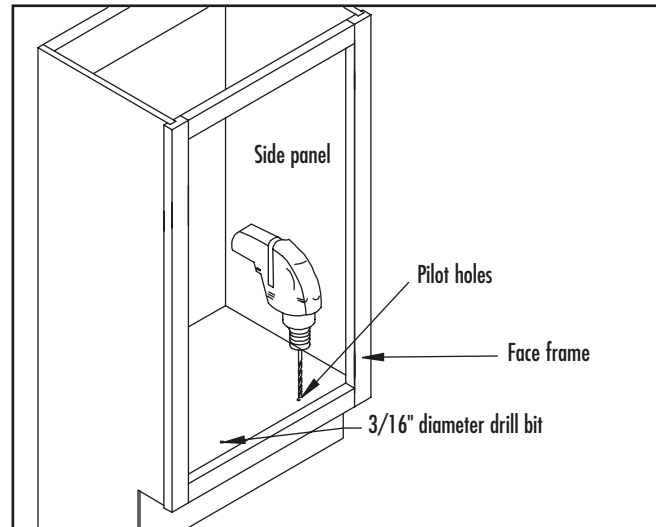

Figure 30

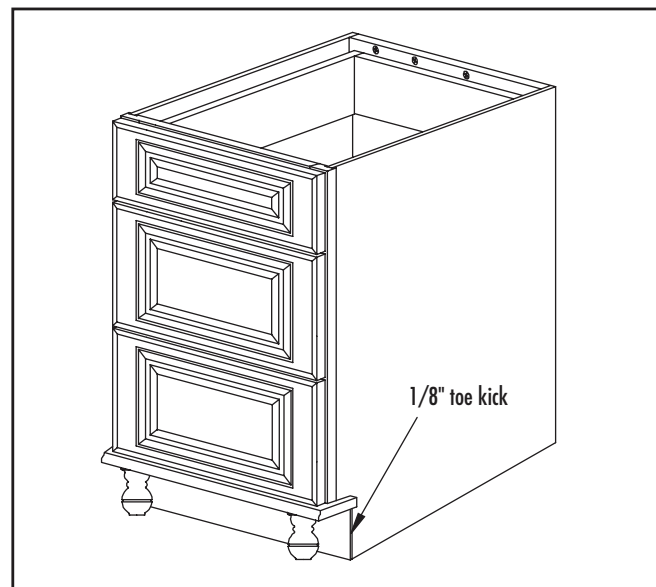

Figure 31

#### Parts List

#### Qty

Mirror	1
 Pivot Hinge & Hinge Plate	2 + 2
 Strike Plate	1
 Push Latch	1
 Push Latch Screw	2
 Shelf Support	12
Adjustable Shelves	3
 Hinge Bushing	2

## 2. ATTACH CABINET TO WALL.

The most secure way to hang this cabinet is by using four screws (not included) – two through upper and two through lower section of back panel into wall stud. If it is not possible to fasten to wall stud, we recommend using 3/16" toggle bolts or appropriate wall anchor. Hardware must be capable of supporting 75 lbs.(34.13 kg) minimum.

- Mark the location(s) of the wall studs (if available) on the inside of the cabinet and drill two 3/16" holes through the hanging rail and two 3/16" holes through the cabinet back (Figure 33).
- Attach the cabinet to the wall with four screws (not included) or appropriate fasteners.

**NOTE:** To ensure proper door alignment it may be necessary to shim one of the corners of the cabinet away from the wall in order to avoid racking (or twisting) the cabinet.

## 3. INSTALL SHELVES.

Place all adjustable shelves on top of shelf supports. Finished edge facing out.

## 4. INSTALL BOTTOM HINGE. (Figure 32)

**NOTE:** Make sure screws on Pivot Hinge are facing INTO the cabinet.

## 5. ATTACH TOP OF HINGE SET. (Figure 34)

## 6. ATTACH DOOR. (Figure 35)

Place hinge bushing onto pivot hinge. Insert pivot hinge into top rail. Slide bottom of mirror door into bottom pivot hinge. Tighten screw. **NOTE:** Doors require adjustment or glass could break.

## 7. INSTALL PUSH LATCH AND STRIKE PLATE. (Figure 36)

The side you put the hinge on will be opposite of the side you install the push latch. Install push latch with provided hardware.

Wipe area where strike plate will be attached, place strike plate onto face of magnet, peel paper from foam tape and close door, open door, press on strike plate to ensure good adhesion.

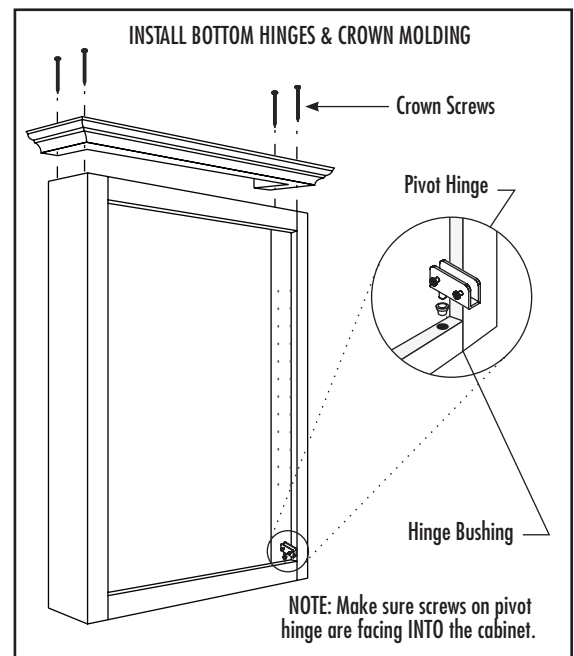

Figure 32

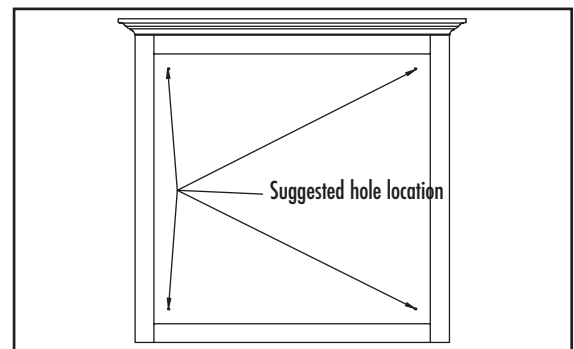

Figure 33

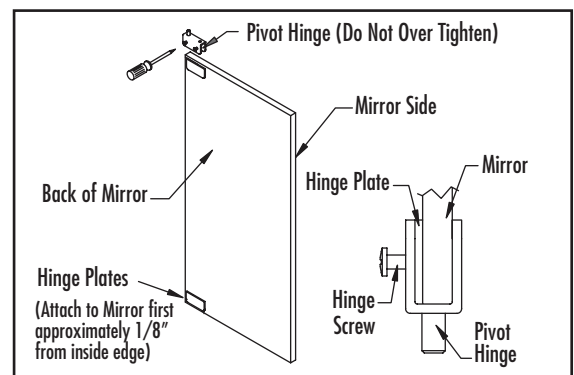

Figure 34

# Step 17. Care and Cleaning

## EXTERIOR CARE AND CLEANING

For normal spills, a damp cloth is sufficient. Remember to dry the surface immediately. Lemon oil is recommended for cleaning wood doors. Most furniture care products, not containing wax, petroleum solvents or silicone can be used for polishing. Do not use caustic agents and/or abrasive scrubbers. Nicks and dings can be repaired using the color sticks. Fill in the scratch or nick using the color stick. A Clear Coat spray may be applied if desired.

## INTERIOR CARE AND CLEANING

Cabinets can be cleaned with a damp sponge or cloth using soapy water. Do not use any type of abrasive scrubbers. Do not let liquids stay on the surfaces for a long period of time. The surface is water resistant, not waterproof.

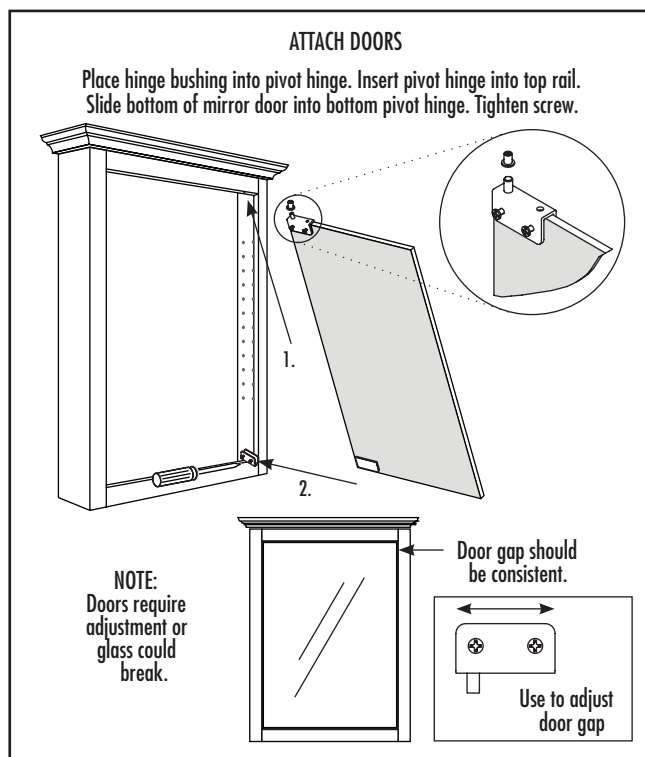

Figure 35

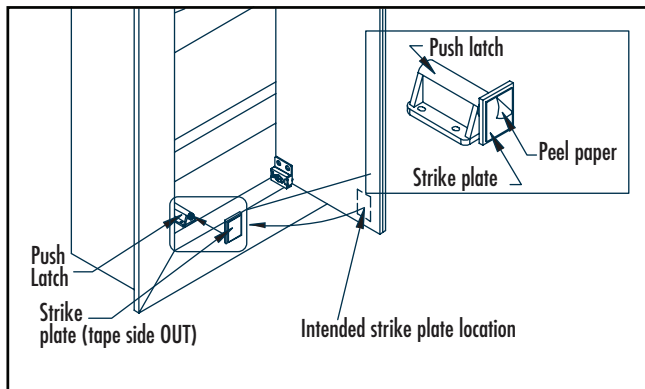

Figure 36

Customer Service and Parts Department  
Voice:(888) 829-1140 • Fax:(714) 449-2208  
Email: masterbathcs@rsihomeproducts.com