

# INSTALLATION INSTRUCTIONS

## INTERIOR PREHUNG, SLAB AND BIFOLD DOORS

### Prehung Unit Installation in 6 Easy Steps

For Proper Installation You Need:

measuring tape, screwdriver, hammer, level, framing square, 6d and 10d finishing nails, wood shims, trim of your choice and latching/locking hardware.

#### Step 1

Be sure opening in the wall is 1 1/2" HIGHER than the complete door unit.

#### Step 2

Plumb, square and level the wall opening BEFORE attempting to install the door unit. Wall must be in the same plane (NOT TWISTED) to ensure proper door installation and operation (*Figure A*).

#### Step 3

Lifting the door assembly, center it in the wall opening and slowly tilt the unit into position from the side opposite the OUTSWING of the door (*Figure B*).

#### Step 4

Check that HINGE SIDE is plumb, then nail HINGE SIDE ONLY at the top hinge, center hinge and bottom hinge locations.

#### Step 5

Shim the STRIKE SIDE and nail through shims approx. 12" from the bottom. At the same time be sure jamb is snug at the side and top of the door. The prepositioned spacer tabs will ensure proper clearance (*Figure C*).

#### Step 6

Set and using finishing nails, nail HEAD CASING (trim) to HEAD JAMB, leaving approx. 3/16" reveal (spacing from bottom of casing to bottom of jamb). Set and nail the SIDE JAMB, also with a 3/16" reveal. Countersink all nails. Paint, if desired, and install door latch hardware (*Figure D*).

Fig. A



Fig. B



Fig. C

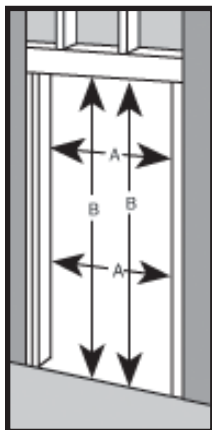

Fig. D



### PREHUNG UNIT SIZE SELECTOR

Before purchasing your prehung door unit from The Home Depot, check your opening measurements carefully. Measure the width (A) and the height (B) of the rough opening in two places shown. The rough opening should be 2" WIDER and 2 1/2" HIGHER than the door itself so you can shim and square the door frame.



DOOR SIZE	ROUGH OPENING	WALL THICKNESS
18"X80"	20"X82 1/2"	4 9/16"
(46X203 cm)	(51x210 cm)	(12 cm)
24"X80"	26"X82 1/2"	4 9/16"
(61X203 cm)	(66x210 cm)	(12 cm)
28"X80"	30"X82 1/2"	4 9/16"
(71X203 cm)	(76x210 cm)	(12 cm)
30"X80"	32"X82 1/2"	4 9/16"
(76X203 cm)	(81x210 cm)	(12 cm)
32"X80"	34"X82 1/2"	4 9/16"
(81X203 cm)	(86x210 cm)	(12 cm)
36"X80"	38"X82 1/2"	4 9/16"
(91X203 cm)	(96x210 cm)	(12 cm)

### Slab Installation in 4 Easy Steps

Before beginning your project, make sure you have the following items: slot head screwdriver, hinges, 1 1/4" wood chisel or electric router, jack plane (if door is not beveled), door hole installation kit, latching/locking hardware and paint or stain for finishing

#### Step 1 - How to Measure

Check measurements carefully, as shown (*Figure A*). Measure width of door opening between hinge jamb and lock jamb in two places (A). Measure height from the head jamb in two places (B). Choose the size from the matrix below.

#### Step 2 - Proper Fit

If necessary, trim your door at the top or the bottom to fit the size of the opening (*Figure B*). Hollow core and solid core doors should never be trimmed more than 1/2" top and bottom. If your door is not already beveled, use a jack plane to bevel the edge that is next to the lock jamb (about 3 degrees).

#### Step 3 - Hinge Placement

As a rule, most doors have three hinges. After marking the hinge placement with a pencil, use a 1 1/4" wood chisel or electric router to cut mortises in to the door's edge (*Figure C*). Then screw the hinges into place.

#### Step 4 - Final Steps

Remove hinge pins and screw the other hinge leaves into the door jamb. Place the door in the opening and insert the hinge pins into place. If door does not swing freely, adjust hinges or trim door. drill for lockset as per directions provided with the hardware of your choice. Attach knob hardware and stain or paint your doors.

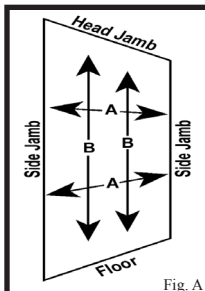

Fig. A

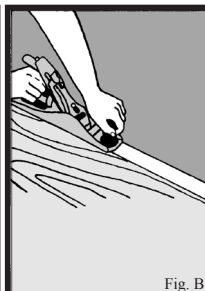

Fig. B

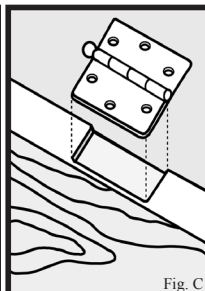
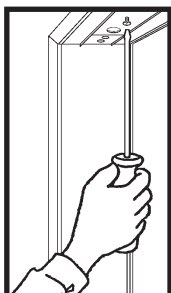
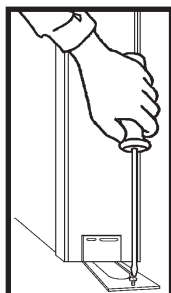

Fig. C

### Bifold Installation in 4 Easy Steps



1. Install the track to the top of the door jamb.



2. Install the floor bracket.

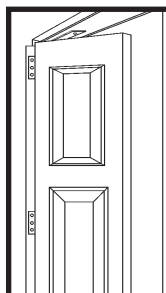

3. Align door pins, snap into place.

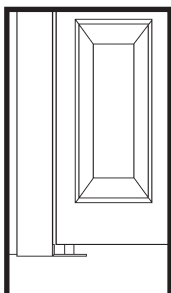

4. Adjust the height of bifold with leveler.

### BIFOLD SIZE SELECTOR

Before purchasing your bifold unit from The Home Depot, check your opening measurements carefully. Measure the width of the door opening between the side jambs in two places (A). Measure the height from the floor to the head jamb in two places (B). Please check with associate for available sizes.

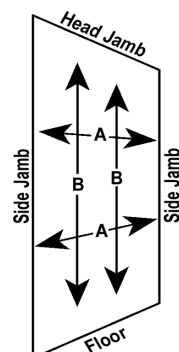

## INTERIOR DOORS

### Slab, Prehung and Bifold

Available in a variety of species and styles to match any decor  
Use for interior  
Ready for finishing

