

**RED^o
STONE**

TM

**FAN FORCED INFRARED UTILITY HEATER
USER MANUAL**



SH-J12



866-661-1218

Distributed by: TRACTOR SUPPLY COMPANY 200 POWELL
PLACE, BRENTWOOD, TN 37027

Safety Terms Used in this Manual

-  **Danger:** Indicates an imminently hazardous situation, which if not avoided, will result in death or serious injury.
-  **Warning:** Indicates a potentially hazardous situation, which, if not avoided, will result in death or serious injury.
-  **Caution:** Indicates a potentially hazardous situation, which, if not avoided, could result in death or serious injury.
- Notice:** Addresses practices not related to personal injury, such as product and/or property damage.

Consumer Safety Information

-  **Warning:** If the information in this manual is not followed exactly, an electric shock or fire may result causing property damage, personal injury or loss of life.
- Notice:** Do not store or use gasoline or other flammable vapors and liquids in the vicinity of this or any other appliance.
- Notice:** For Household use only.
- Notice:** Read all instructions before use.

Product Specifications

Voltage	Frequency	Wattage (Max)	Max. Amperage
120 Vac	60 Hz	1500W	12.5 A

Product Registration

For product warranty registration please visit:

www.tsicustomerservice.com

Before setting up this product please record the model number and serial number of this product in the spaces below for registration and warranty reference.

Heater Model Number

Serial Number

IMPORTANT INSTRUCTIONS

When using electrical appliances, basic precautions should always be followed to reduce the risk of fire, electrical shock, and injury to persons including the following: READ ALL INSTRUCTIONS BEFORE USE.

1. Keep the product out of the reach of children and pets. This product is not intended for use by children.
2. CAUTION: Never leave the heater operating unattended.
3. Do not let bare skin touch hot surfaces, as heater is hot! To avoid burns, use the handle when moving this heater. Keep combustible materials, such as furniture, pillows, bedding, papers, clothes, and curtains at least 3 feet (0.9m) from all sides of the heater.
4. Always unplug the heater when not in use.
5. Do not use this product in bathrooms, laundry areas, or similar damp/wet indoor locations. Do not place the product where it may fall into a bathtub or other water container.
6. Do not run the power cord under carpeting or cover it with throw rugs, runners, or similar coverings. Arrange the cord away from traffic areas where it will not be tripped over.
7. To disconnect the product from an electrical outlet, turn any controls to the Off position, and then pull directly on the plug to remove it from the outlet; do not pull on the power cord.
8. Do not insert or allow foreign objects to enter any ventilation or exhaust opening of the product as this may cause electric shock, fire, or damage the heater.
9. Do not block air intakes or exhaust, as this may cause a risk of fire. Do not use the product on soft surfaces, such as a bed, where openings may become blocked.
10. Do not use this product in an area where gasoline, paint, or flammable liquids are used or stored, as this product has hot and arcing or sparking parts inside.
11. Do not place the product near a bed as objects, such as pillows or blankets, can fall off and be ignited by the product.
12. Use this product only as described in this manual. Any other use not recommended by the manufacturer may cause fire, electric shock, or injury to persons.
13. Do not immerse or expose the power cord, plug, or product to water or other liquids. If the product falls into water, immediately unplug it from the electrical outlet; do not touch or reach into the water. If water or other liquids reach any internal areas of this product, permanently discontinue its use.
14. Ensure the product is unplugged from the electrical outlet and allowed to cool before relocating or cleaning it.
15. Use the heater in a vertical position only.
16. Do not place the product in or near an open window. Rain, snow, or other weather elements could cause electrical short-circuiting in the product.

IMPORTANT INSTRUCTIONS

17. Do not plug into or unplug the product from the electrical outlet with a wet hand.
18. Do not operate this product if it has a damaged power cord or plug, if it malfunctions, or if it has been dropped or damaged. This product has no user-serviceable parts. Do not attempt to examine or repair this product yourself. Only qualified service personnel should perform any servicing; take the product to an appliance repair shop of your choice for inspection and repair.
19. This appliance is not intended for use by persons (included children) with reduced physical, sensory or mental capability, or lack of experience and knowledge, unless they have been given supervision or instruction concerning use of the appliance by a person responsible for their safety.
20. Children should be supervised to ensure that they do not play with the appliance.
21. This product is intended solely for indoor, non-commercial, non-industrial use in temporarily heating rooms. Do not use this product outdoors.
22. Do not operate the product continuously. Portable electric heaters are designed for finite space heating or as a supplementary heat source. They are not intended to be main sources of heat during the normal heating season.
23. Do not hang or wall-mount the product.
24. Place the product upright on a flat, level, stable, heat-resistant surface.

WARNING: This product is equipped with a polarized plug (one blade is wider than the other blade). To reduce the risk of electrical shock, this plug will fit into a polarized outlet only one way. This is a safety feature.

If you are unable to insert the plug into the electrical outlet, try reversing the plug. If the plug still does not fit, contact a qualified electrician.

25. Always plug heaters directly into a wall outlet/receptacle. Never use with an extension cord or relocatable power tap (power strip).

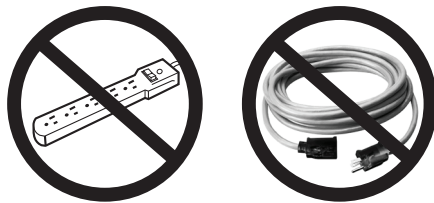

26. Do not attempt to disassemble heater for service or cleaning. Damage to the heater could occur and improper re-assembly could cause risk of fire or electric shock.

SAVE THESE INSTRUCTIONS

Product Orientation

To adjust the tilt angle of the heater press and hold in the angle adjustment button, adjust the leg height then release the button.

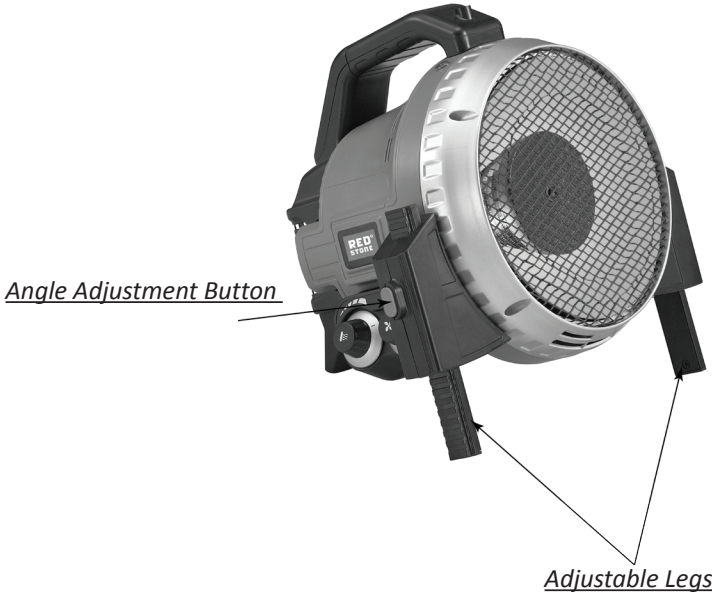

Operation Instructions

Thermostat Knob

Control Knob

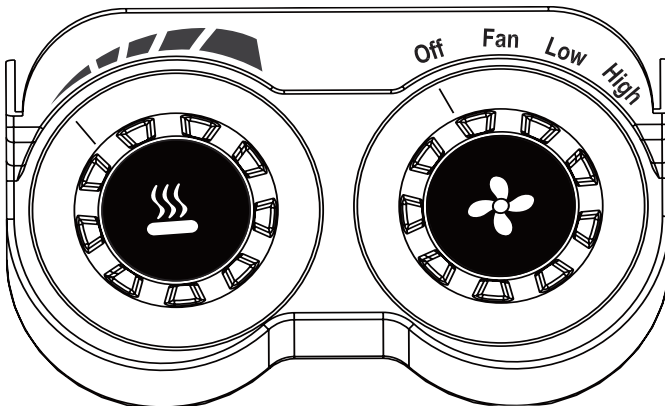



Turn the knob clockwise to increase the thermostat setting temperature.
The Power indicator will illuminate, indicating the heater is on. Turn the wheel counter-clockwise to decrease the thermostat setting temperature.

Off
Fan Only (No heat)
Low Heat (750W)
High Heat (1500W)

Safety Protection Systems

- This product has protection safeguards that shut off the product automatically when parts become excessively hot or if it tips over. If the product shuts off, immediately turn the Control to the "O" position and unplug it from the electric outlet.
- If overheated:
 - a. Remove any objects near the product that may cause overheating. Use the product in a well-ventilated area. Keep at least 3 feet (0.9 meters) of space on all sides of the product to allow adequate air circulation.
 - b. Allow the product to cool down for at least 10 minutes before plugging it back into an electric outlet for re-use.
- If tipped over place the product on a flat, level, stable surface in order to prevent the product from tipping over again.

Care And Maintenance

-  **WARNING:** Do not attempt to disassemble this product for any reason, as incorrect re-assembly could cause a risk of fire or electric shock. Only qualified service personnel should perform any servicing.
-  **WARNING:** Always unplug the product from the electrical outlet and allow it to cool before cleaning or storing it.
-  **WARNING:** Do not allow water or other liquids to enter the interior of the product.
- NOTICE:** This product is permanently lubricated at the factory before shipping and will not require further lubrication for the life of the product.
Clean only the exterior surface by wiping with a soft, damp cloth, and allow the product to dry completely before storing or using. Dust can be removed from any vents using a small vacuum.
- NOTICE:** Do not use abrasive cleaners/pads to clean the product.
To store, wind and secure the power cord using a twist tie or rubber band, and then place the product in a cool, dry location.

1-Year Limited Warranty

The manufacturer warrants that your new electric heater is free from manufacturing and material defects for a period of one year from date of purchase, subject to the following conditions and limitations.

1. Install and operate this electric heater in accordance with the installation and operating instructions furnished with the product at all times. Any unauthorized repair, alteration, willful abuse, accident, or misuse of the product shall nullify this warranty.
2. This warranty is non-transferable, and is made to the original owner, provided that the purchase was made through an authorized supplier of the product.
3. The warranty is limited to the repair or replacement of part(s) found to be defective in material or workmanship, provided that such part(s) have been subjected to normal conditions of use and service, after said defect is confirmed by the manufacturer's inspection.
4. The manufacturer may, at its discretion, fully discharge all obligations with respect to this warranty by refunding the wholesale price of the defective part(s).
5. Any installation, labor, construction, transportation, or other related costs/expenses arising from defective part(s), repair, replacement, or otherwise of same, will not be covered by this warranty, or shall the manufacturer assume responsibility for same.
6. The owner/user assumes all other risks, if any, including the risk of any direct, indirect or consequential loss or damage arising out of the use, or inability to use the product, except as provided by law.
7. All other warranties – expressed or implied –with respect to the product, its components and accessories, or any obligations/liabilities on the part of the manufacturer are hereby expressly excluded.
8. The manufacturer neither assumes, nor authorizes any third party to assume on its behalf, any other liabilities with respect to the sale of the product.
9. The warranties as outlined within this document do not apply to non accessories used in conjunction with the installation of this product.
10. This warranty gives you specific legal rights, and you may also have other rights which vary from state to state.

This warranty is void if:

- a. The heater is subjected to prolonged periods of dampness or condensation.
- b. Any unauthorized alteration, willful abuse, accident, or misuse of the product.
- c. You do not have the original receipt of purchase.

www.twinstarhome.com/blackanddecker

For Customer Service Call 1-866-661-1218

Questions? Our experts are standing by assist you at our help line, we can help you with assembly, and, if necessary replace damaged/missing parts. Assistance is available 7 days a week/24 hours a day/ 365 days per year.

IMPORTANT:

Before contacting Customer Service please have this information available:

- Serial Number
- Model Number
- Sales Receipt or Proof of Purchase