

# **2050 LBS UTILITY DUMP TRAILER KIT 60" x 96"**

## **ASSEMBLY GUIDE**

**MODEL: AT6096G**



### **SAVE THIS GUIDE & MANUAL**

**You will need this assembly guide & manual for safety instructions, Operating procedures and warranty. Put it and the original sales receipt in a dry place for future reference.**

**FREE CALL 888-878-1668**

## ATTENTION

IMPORTANT: When you open the carton carefully check the unit and make sure there is no damage. If you have any problems with assembling the unit, with how the various functions work, or with damage or missing parts, please go to our website [WWW.ALTOCRAFTTRAILER.COM](http://WWW.ALTOCRAFTTRAILER.COM) and click on customer support or call Altocraft at the number shown on the cover of this manual as soon as possible.

## SPECIFICATIONS

Gross Vehicle Weight (G.V.W)	2050 lbs (930 kgs)
Curb Weight	330 lbs (150 kgs)
Payload Capacity	1720 lbs (780 kgs)
Bad Dimensions	60" x 96" (152.4 cm x 243.8 cm)
Hitch Ball Size	2" (5 cm)
Wheel Rim Diameter x Width	12" x 4" (30.5 cm x 10 cm)
Quantity of Wheel Lug Nuts	5 Per Wheel
Tire Size	5.30-12, 6 Ply
Required of Tire Air Pressure	60PSI, Cold
Over Length	172" (436.8 cm)
Over Width	72" (182.8 cm)
Floor Height	18" (46 cm)
Hitch Height	14" (36 cm)
Lighting	12V DC, D.O.T.
Ship Weight	350lbs (159 kgs)

## ASSEMBLY PARTS LIST

NO	DESCRIPTION	QTY
1	Trailer frame(including pre-assembled real gate)	1

### TONQUE MOUNT KIT

NO	DESCRIPTION	QTY
2	Tongue assembly (including pre-assembled coupler and safety chains)	1
3	Front tongue holder	1
4	Rear tongue holder	1

5	M12 x 30 mm Bolts	6
6	M12 Nylon nuts	6
7	M12 Washers	12
8	M16 x 90 mm Bolt	1
9	M16 Nylon nut	1
10	M16 Flat washers	2

#### **LEFT SPRING MOUNT KIT**

NO	DESCRIPTION	QTY
11	Left springs	2
12	M12 x 80 mm bolts	4
13	M12 Nylon nuts	4
14	M12 Washers	8

#### **AXLE MOUNT KIT**

NO	DESCRIPTION	QTY
15	Axle (including hub and lug nuts)	1
17	M10 U Type bolts	4
18	M10 Washers	8
19	M10 Nylon nuts	8
19A	Leaf spring plates	2

#### **FENDER MOUNT KIT**

NO	DESCRIPTION	QTY
20	Fenders	2
21	M8 Nylon nuts	4
22	M8 Washers	8
22A	M8 x 25 mm bolts	4

#### **WHEELS/TIRES MOUNT KIT**

NO	DESCRIPTION	QTY
16	Wheels/Tires	2
16A	Lug nuts	10

### FRONT SLEIGH RAIL MOUNT KIT

NO	DESCRIPTION	QTY
23	Front sleigh rail	1
24	M6 x 45 mm Bolts	6
25	M6 Nylon nuts	6
26	M6 Spring washers	6
27	M6 Flat washers	6
28	M8 x 40 mm Bolts	2
29	M8 Nylon nuts	2
30	M8 Washers	4

### LIGHTING MOUNT KIT

NO	DESCRIPTION	QTY
31	12V Left rear light assembly (with license plate bracket)	1
32	12V Right rear light assembly	1
33	M6 x 60 mm Square neck bolts	4
34	M6 Washers	8
35	M6 Nylon nuts	4
36	12V Side markers	2
37	M4 Bolts	4
38	M4 Nuts	4

## ASSEMBLY

### PREPARATION

Unpack all parts and place them inside the top cover of the box. Leave the trailer frame in the box with its bottom facing up, as received.

### TONQUE ASSEMBLY

Place the tongue holders (3,4) on the holder brackets in the trailer frame. Mount the tongue holders using the M12 x 30 mm bolts (5), M12 nylon nuts (6) and M12 washers (7).

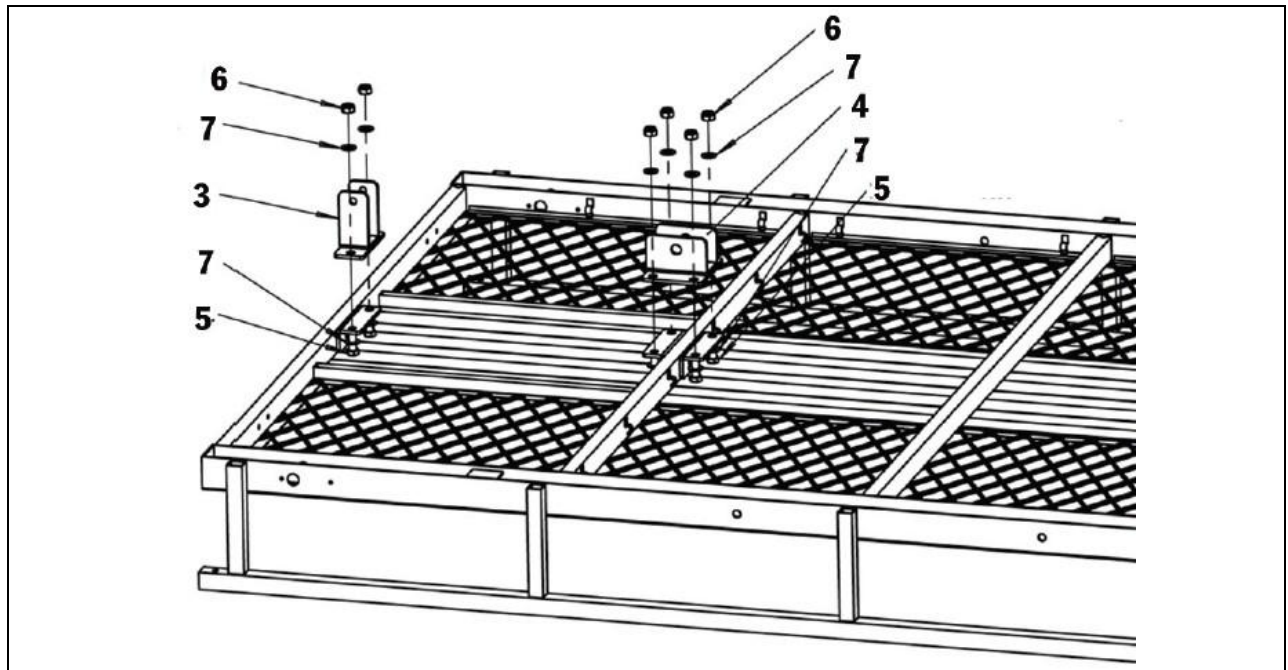

Place the tongue (2) on the tongue holder track. Mount the end of the tongue using the M16 x 90 mm bolt (8), M16 nylon nut (9) and M16 flat washers (10). Use the D-pin (which is attached to the trailerframe) to secure the front end of the tongue.

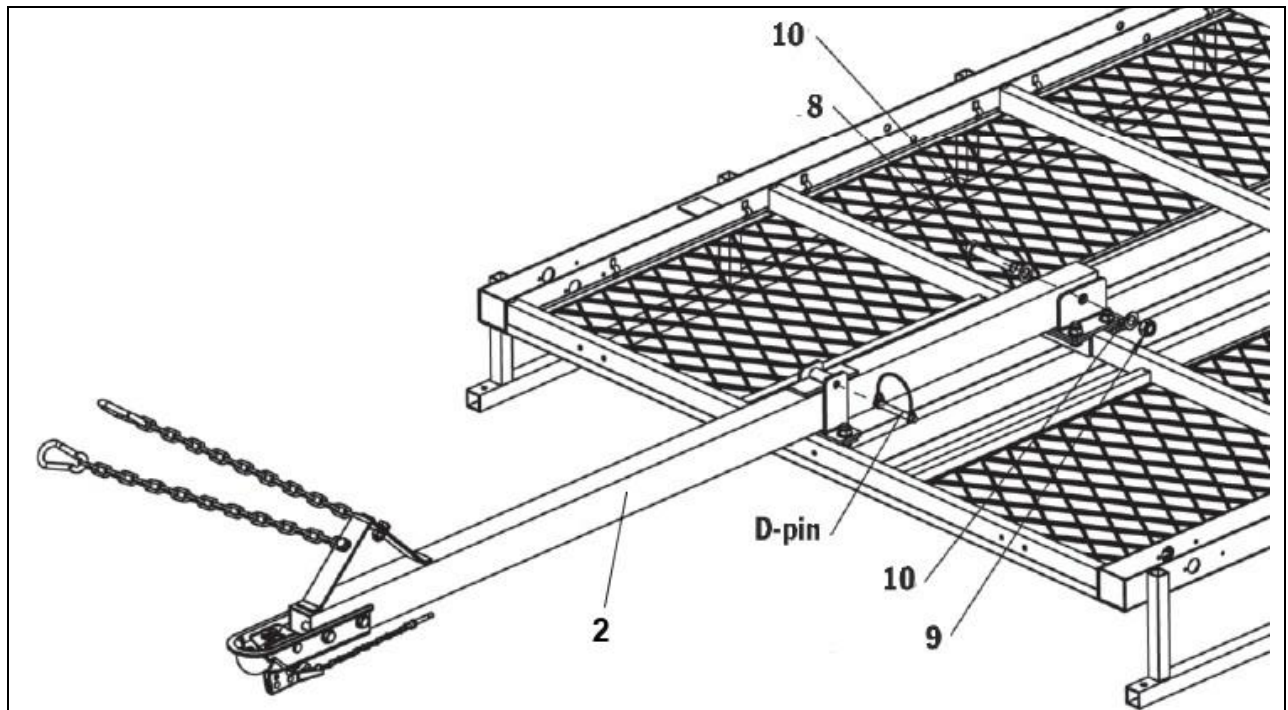

## LEFT SPRING ASSEMBLY

Place the leaf springs (11) on both the right and left side of the frame. Mount the leaf springs on the front and the rear using the M12 x 80 mm bolts (12), M12 nylon nuts (13) and M12 washers (14).

NOTE: The “eye” end of the leaf springs should face the front of the trailer.

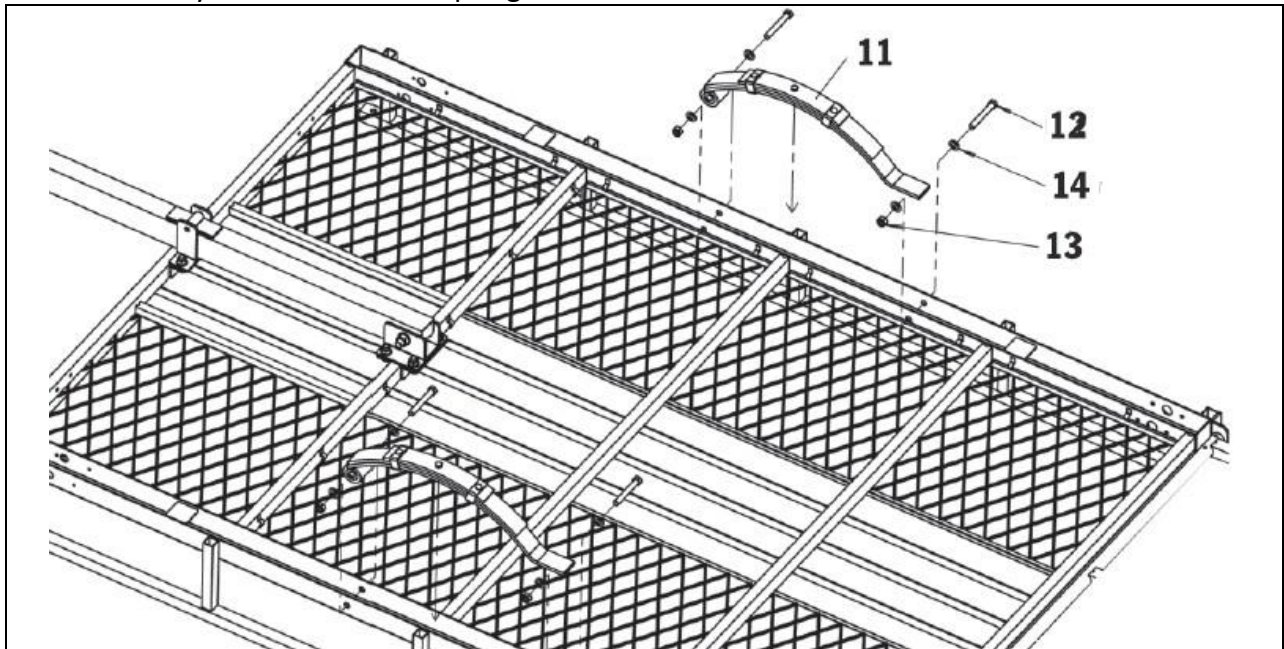

## AXLE ASSEMBLY

Lay the axle (15) across the leaf springs (11). Mount the axle to the leaf springs with the M10 U-type bolts (17), left spring plate (19A), M10 nylon nuts (18) and M10 washers (19).

NOTE: Insert the raised point on the leaf spring into the concave on the axle. Make sure that the axle is in the right position.

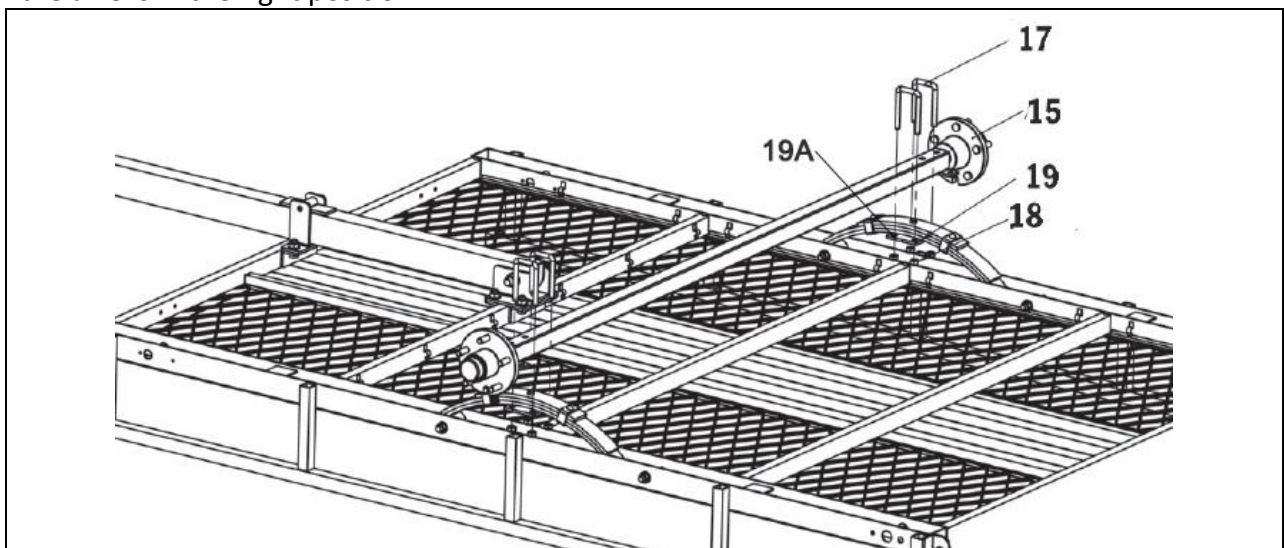

## FENDER ASSEMBLY

Place the fender (20) upside down below the axle. Mount the fender with the M8 x 25 mm bolts (22A), M8 washers (22) and M8 nylon nuts(21).

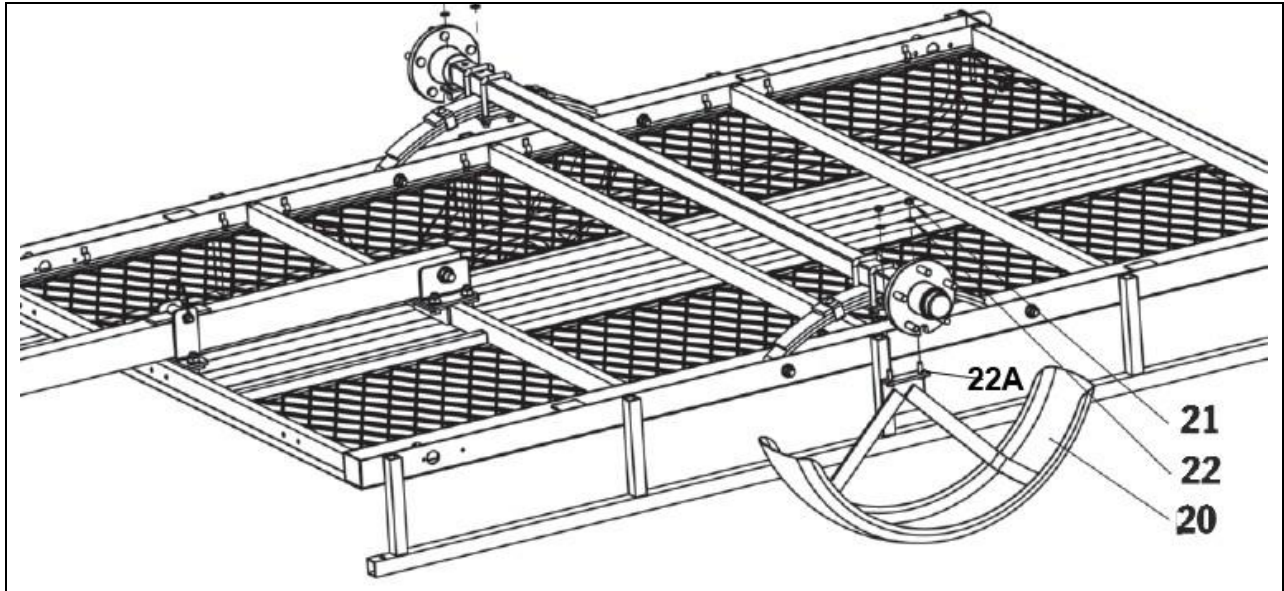

## WHEEL/TIRE ASSEMBLY

Loosen the five lug nuts (16A) on the hubs. Place the holes of each tire/wheel (16) onto the five bolts on each hub. Secure the wheel assemblies onto the hubs with 80-95 ft-lb torque, following 1-3-5-2-4 order to fasten the lug nuts.

NOTE: If you don't have a torque wrench to secure the wheel assemblies, first secure the assemblies onto the hub and then get any dealer or shop to secure them with 80-95 ft-lb torque.

**WARNING:** Over fasten the bolt may cause damage or lead to the steel deformation.

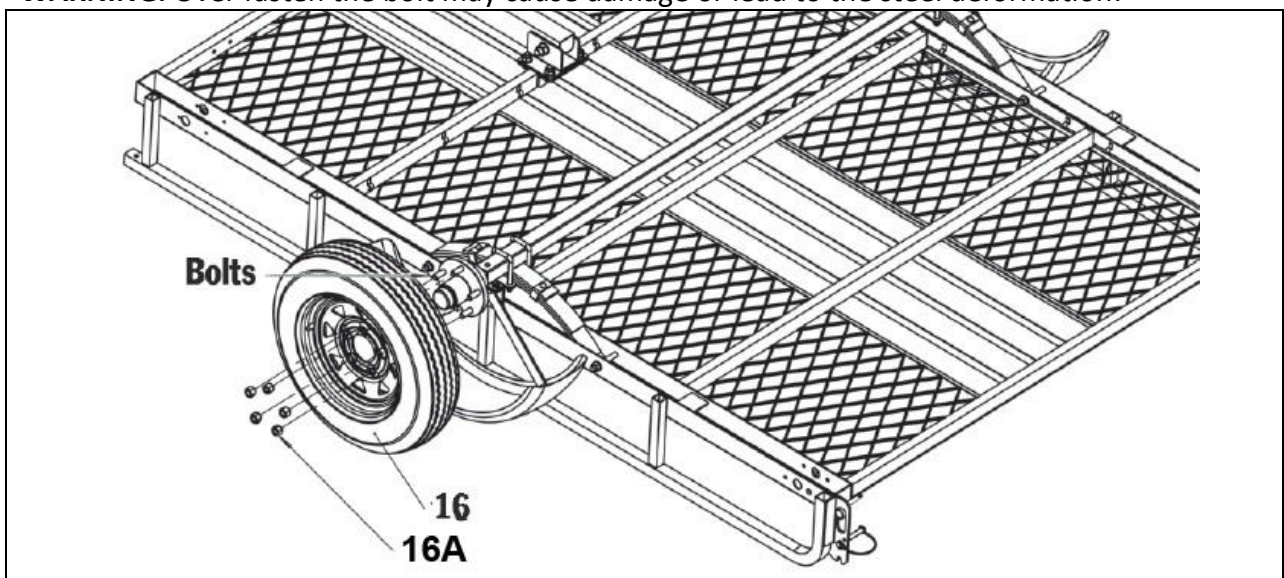

## FLIP THE TRAILER FRAME

Once the wheels/tires are attached, flip the frame over with extreme caution.

**WARNING:** Particularly avoid of accidents, at least two adults are needed to flip over the frame.

## FRONT SLEIGH RAIL ASSEMBLY

Place the front sleigh rail (23) on the trailer. Mount the front sleigh rail to the base of the trailer frame using the M6 x 45 mm bolts (24), M6 nylon nuts (25), M6 spring washers (26) and M6 flat washers (27). Mount the front sleigh rail to the side rails using the M8 x 40 mm bolts (28), M8 nylon nuts (29) and M8 washers (30).

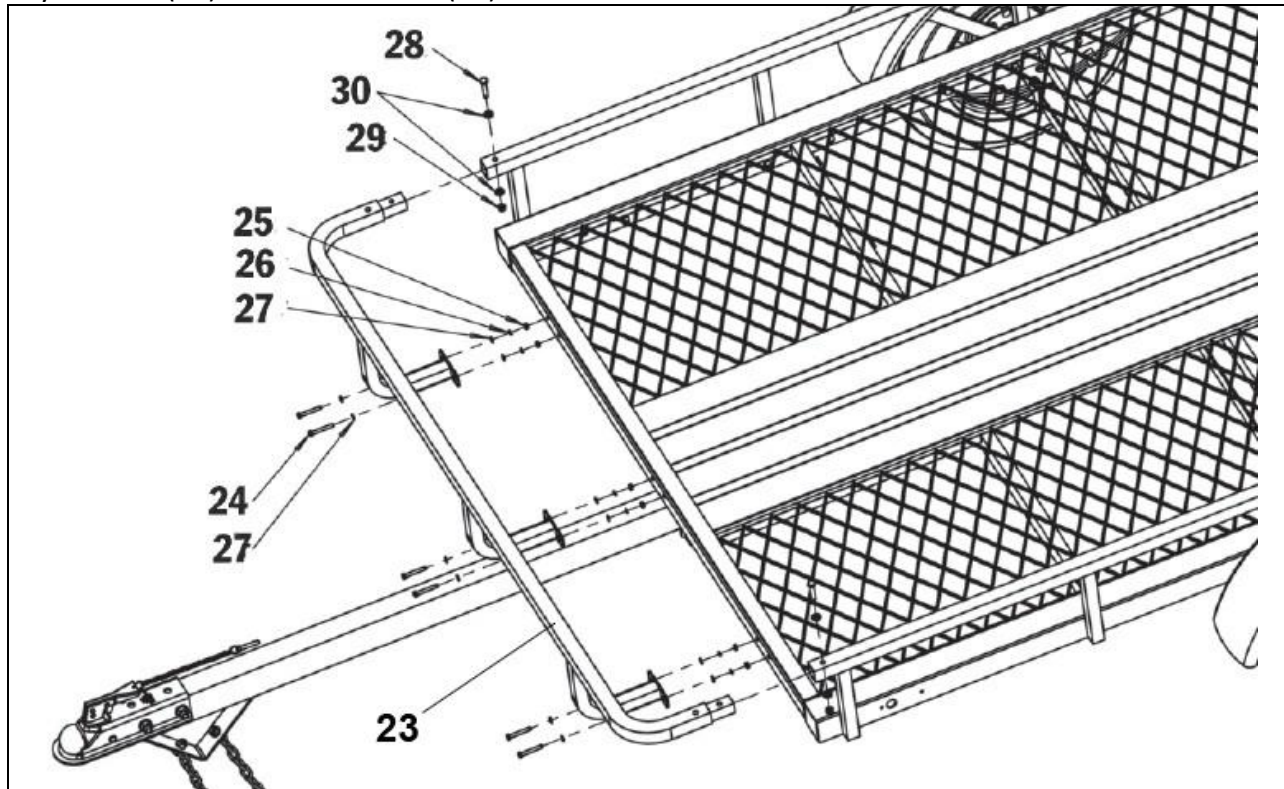

## LIGHTING ASSEMBLY

**WARNING:** According to DOT requirements, the rear light with the license plate bracket must be used on the driver side of the trailer.

Noted: The wire harness are pre-assembled under the frame.

The rear lights are assembled already. Mount the light assemblies (31, 32) onto the side of the rear portion of the frame using the M6 square neck bolts (33), M6 nylon nuts (34) and M6 washers (35). Plug the light connector into the wire harness.

Mount the side marker (36) onto the side of the front portion of the frame using the M4 bolts (37) and M4 nuts (38). Plug the light connector into the wire harness.



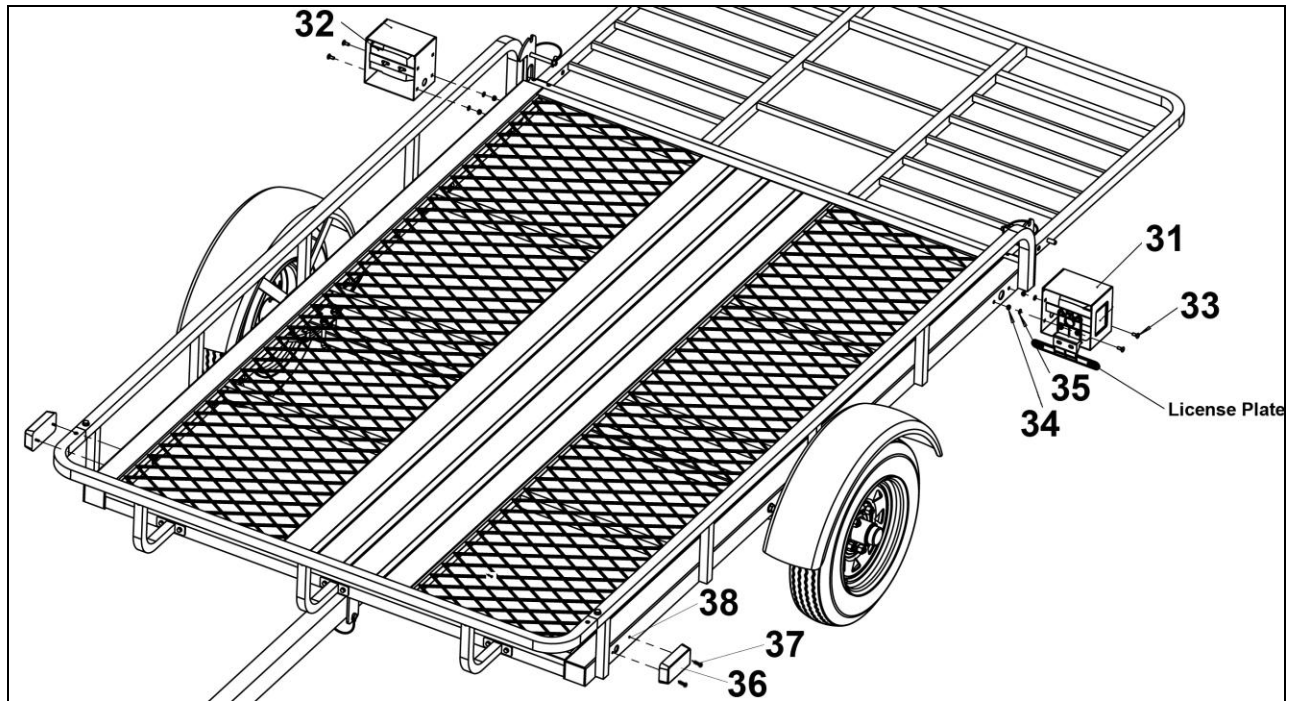

## VIN TAG AND TIRE PLACARD ASSEMBLY

Take the VIN tag and tire placard out from the manual package, stick them on the driver side of the trailer, and then stick the UV film to prevent from the water.

**WARNING:** The VIN (Vehicle Identification Number) tag and tire placard must be placed on the driver's side.

The serialized VIN tag number matches the number on the trailer's Certificate of Origin. The bill of sale and this certificate of origin will be all that you need to obtain license plates and registration in most states. VIN tags should be attached to the trailer before you receive your trailer tag.

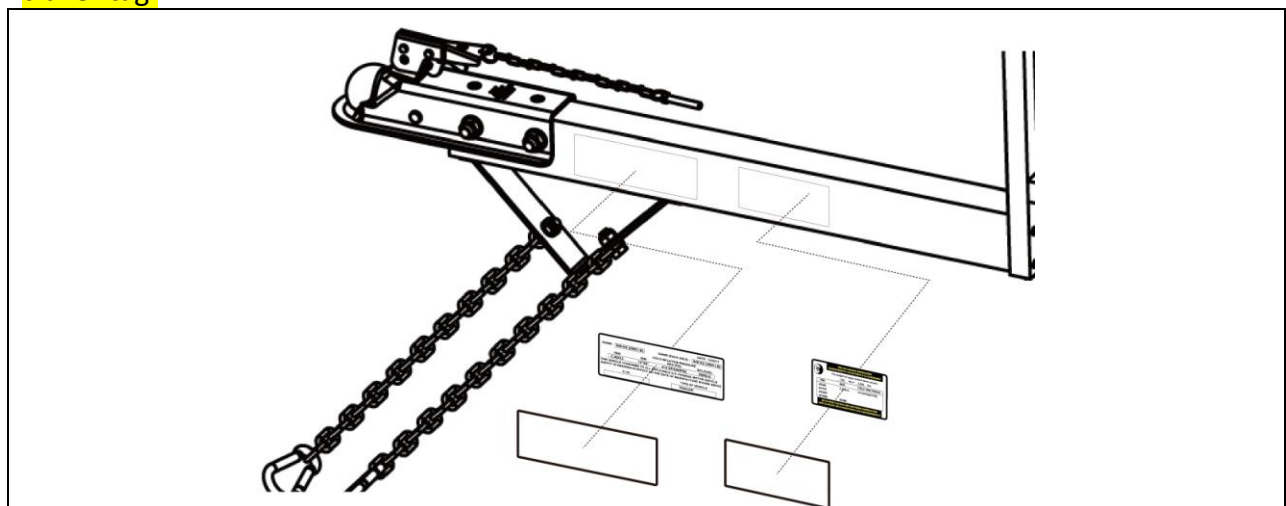

# WIRING DIAGRAM

