

Outdoor Hot Tub Pre-Delivery Guide



This guide will provide you with information you need to know about the delivery and installation of your new outdoor hot tub.

Introduction

Congratulations on the purchase of your new hot tub!

With some advance preparation, delivery of your new hot tub will be a breeze. We've prepared this planning guide to provide you with the information necessary for you to be ready for your hot tub's delivery. We recommend reading this guide completely prior to the scheduled delivery of your hot tub. Proper preparation and care of your new hot tub will give your family years of relaxation and enjoyment.

Important information

Please make a record of the following information. It will be valuable if service is required.

Model: _____

Serial Number: _____

Date Purchased: _____

Date Installed: _____

Dealer: The Home Depot _____

1. Things to determine before installation

- Will my spa be located inside or outside?
- How much space do I have available for a hot tub – the size of room, deck, or patio?
- What are the measurements of door openings, fence gates or deck stairs for getting your hot tub to its destination?
- Check the dimensions of your hot tub's length, width, and depth. Will it pass through interior doors or exterior gates?
- Check the weight of your hot tub without water and filled with water. Will your deck, patio, or room floor support its considerable weight?
- Does your home have a dedicated 50 AMP breaker in the house's main breaker box or will one have to be added by an electrician?
- How far is it from your main breaker box to where your hot tub will be located?
- Is there a water source available nearby to fill and drain the hot tub with a garden hose?

Commonly asked questions and answers

Do I need a building permit?

- Most cities and counties require permits for exterior construction and electrical circuits. Check with your county or city to see if a building permit is required for hot tub installation.

Do I need a fence or a gate around my hot tub?

- Some communities have codes requiring residential barriers such as fencing and/or self-closing gates on the property to prevent unsupervised access to a hot tub by children under five years of age. Consult your local or county building codes to determine the need for a fence or gate.

Do I need a Plumber?

- No plumbing is required; your hot tub is entirely self-contained. Fill it using a garden hose; to empty, siphon with garden hose or submersible pump.

Do I need an Electrician?

- Yes, you will need to hire an electrician to install the 240 volt 50 AMP neutrally protected GFCI (Ground Fault Circuit Interrupter) which is sold separately. Your main breaker box will also need to have a 50 AMP breaker. Your hot tub is hard-wired through the floor or side wall of the cabinet, directly into its control pack. The GFCI is installed next to the hot tub on an exterior wall at least 5 feet from the spa water. (Exception: The Model 100 and Model 175 come with a 15' GFCI protected cord and plug into any 120 V / 15 AMP wall outlet.)

2. Selecting the best location for your hot tub

Indoors or outdoors, it's up to you. But there are some things you will need to consider when determining your hot tub's placement.

Outdoor hot tub placement

Outdoor hot tub placement, such as decks, concrete or brick patios, is common. However, the hot tub can be placed on any solid, uniform, level surface. Do not place your hot tub on grass or bare ground. If placing your hot tub on a wooden deck, be sure to consider its weight (filled with water) and the weight bearing capacity of your deck.

Note: Damage caused by inadequate or improper foundation support is not covered by the manufacturer's warranty. A hot tub should rest completely flush with its foundation, therefore, do not endeavor to hand level it. The hot tub should not be shimmed in any way in an effort to level it. This may crack your hot tub shell or cause other internal damage. It is the responsibility of the owner to provide a proper foundation for the hot tub. Any attempt to manually level your hot tub will void the warranty.

A normal, code-compliant (2" x 10" joist) at 16" on center deck is adequate.

The floor load of a hot tub filled with water is around 115 lbs. per square foot. Your base should have at least 125 lbs. per square foot load capacity.

If you are not comfortable with your deck support, have it inspected and add bracing if necessary.

DO NOT place your hot tub directly under or within 12 feet of overhead power, telephone or cable lines.

Make sure the hot tub is positioned so you have full access to the equipment compartments located by the spa controls. Be sure to leave at least 30" around all sides and back panels for easy service access if needed.

Many people choose to build their hot tub into a deck or patio with custom tile or wood built up to the top of the hot tub cabinet for a built-in look. When designing your project, remember to allow for service access on all four sides of your hot tub, or access from beneath. It's always best to design an installation where the entire hot tub can be lifted or removed from the deck or patio, if needed.

Weather

If you live in a climate with a cold snowy winter and hot summer, you may want to place your hot tub close to an exterior door for easy access. A bathroom or changing room located close to your hot tub can also be convenient. A warmer climate may require shade from the hot sun. Consider placement of your hot tub next to trees, shrubs, patio cover, under a gazebo or hot tub umbrella.

Privacy

Keep in mind your hot tub's surroundings (trees, shrubs, fences) during all seasons to determine your best privacy. Consider the view of your neighbors and plan your location accordingly.

View

Think about the direction you will be facing when sitting in your hot tub. Facing the exterior siding of your house would not be very enjoyable. Place your hot tub where you will be facing a special landscaped area of your yard or a lovely evening sunset.

Keep dirt and debris out of your hot tub

Check the location of trees and spill paths from gutters to see if wind or rain will sweep debris into your hot tub. Prevent dirt and foliage from being tracked into your hot tub by providing a concrete path.

Indoor hot tub placement

For indoor hot tub placement, regular, code-compliant floors or level basement concrete are adequate to support the weight. Four-season rooms, screened-in rooms, and porches must be checked for adequate floor support.

Indoor installation requires adequate ventilation. When the cover is off and the hot tub is in use, considerable amounts of humidity and moisture are put into the air. This moisture can damage, walls, ceilings, carpeting, draperies and furniture. You will need to install a ventilation exhaust fan either above the hot tub in the ceiling or in a side wall or window, next to and above the spa water. We also recommend a humidistat that will automatically turn on the exhaust fan when moisture is present.

Exhaust fans are rated by CFMs (cubic feet per minute). The fan must be powerful enough to remove all the air in the room in 3 minutes. To determine what size fan you will need, measure the room's length x width x height and divide by 3 = CFMs. Example: 20' x 10' x 8' = 1600 cubic ft. / 3 = 533 CFMs. You would need at least a 533 CFM fan for this room.

We do not recommend placing your hot tub directly on household carpet or a wood floor. We recommend placing your hot tub on a ceramic tile or water resistant floor material. Extend this water resistant material at least 2 feet around the hot tub, in case of over splash and to catch water from bathers exiting the hot tub.

3. Plan a good foundation for your hot tub

Your hot tub needs a solid, level foundation. The area that your hot tub sits on must be able to support the weight of the hot tub, the water in it, and those who use it. If the foundation is inadequate, it may shift or settle after the hot tub is in place, causing stress to its shell.

Note: Damage caused by inadequate or improper foundation support is not covered by the manufacturer's warranty. A hot tub should rest completely flush with its foundation; therefore, do not endeavor to hand level your hot tub. The spa should not be shimmed in any way in an effort to level it. This may crack the shell or cause other internal damage. It is the responsibility of the hot tub owner to provide a proper foundation for the hot tub. Any attempt to manually level your hot tub will void the warranty.

A hot tub filled with water is very heavy. Existing decks and concrete patios must be inspected by a licensed contractor to determine adequate support. Your base must have a minimum of 125 pounds per sq. ft. load bearing capacity. Add additional bracing if necessary.

Place the hot tub on an elevated foundation so that water drains away from it. Proper drainage will keep components protected from rain and wet weather.

New concrete patios must be a 4" minimum depth with reinforced wire placed in the concrete.

New wood decks should have (2 x 10) floor joists and (4 x 4) or (6 x 6) post depending on deck height. Consult a structural engineer or contractor to ensure the proper support for the height and size of your deck.

We do not recommend placing your hot tub on a brick, stone, or gravel base.

DO NOT place your hot tub on bare ground!

4. Plan the delivery of your hot tub

Check the dimensions of your spa

The Specification chart on page 13 lists your spa model and its dimensions. Compare the dimensions to the width of gates, sidewalks, and doorways along the delivery route used to bring the hot tub into your yard. It may be necessary for you to remove a gate or partially remove a fence in order to provide an unobstructed passageway to the installation location.

How will your spa be delivered to you?

Curbside Delivery

Your hot tub will be delivered by common carrier or freight truck to your home curbside. Your hot tub will ship in 21 business days and usually arrives within 10 business days after it ships. An independent delivery carrier will unload the hot tub from the truck, but is **NOT** authorized to unwrap, set up, or do installation. The driver **will not** move your hot tub to the backyard or place it inside your home.

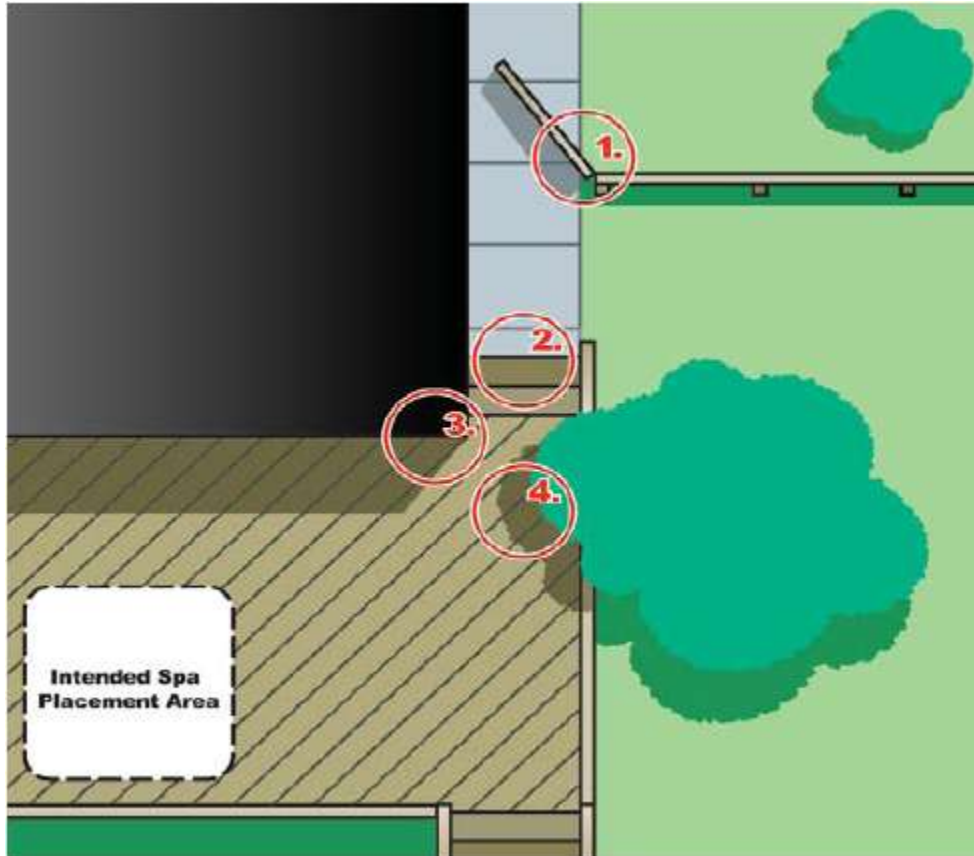

Plan your hot tub route

Use the diagram to plan your route. Consider the following when planning your hot tub route:

Check the width of gates (#1), doors, steps (#2) and sidewalks to make sure your hot tub will pass through unobstructed. You may have to remove a gate or part of a fence to allow for adequate width clearance.

If the route will require a 90° turn, check the measurements at the turn (#3) to ensure the hot tub will fit.

Are there protruding gas meters, water meters or A/C units on your home which will be an obstruction along the path to your yard?

Are there low roof eaves, overhanging branches (#4) or rain gutters that could be an obstruction to overhead clearance? Are there more than six (6) consecutive stairs without a landing in your route?

5. Electrical requirements before hot tub delivery

IMPORTANT

When installed in the United States, the electrical wiring of this hot tub must meet the requirements of the National Electric Code (NEC) and any applicable state or local codes. The electrical circuit must be installed by an electrical contractor and approved by a local building/electrical inspector.

Electrical setup before delivery of your hot tub

1. All 240V spas must be permanently connected (hardwired) to the power supply. Supplying power to the spa which is not in accordance with these instructions will void both the independent testing agencies' listing and the manufacturer's warranty.

2. The power supplied to the hot tub must be a dedicated circuit with no other appliances or lights sharing the power.

3. To determine the current, voltage and wire size required for the hot tub configuration to be connected:

- Wire size must be appropriate per NEC and/or local codes.
- Wire size is determined by length of run from breaker box to hot tub and maximum current draw.
- We recommend copper wire with THHN insulation.
- All wiring must be copper to ensure adequate connections. Do not use aluminum wire.
- When using wire larger than #6 (10mm²), add a junction box near the hot tub and reduce to short lengths of #6 (10mm²) wire between the junction box and the hot tub.

4. The electrical supply for the hot tub must include a suitable rated switch or circuit breaker to open all ungrounded supply conductors to comply with Section 422-20 of the National Electric Code, ANSI/NFPA 70.

5. The electrical circuit for the spa must include a suitable ground fault circuit interrupter (GFCI) as required by NEC Article 680-42. We recommend a Neutrally Protected (GFCI) Ground Fault Circuit Interrupter; see the illustration on the following page for the proper wiring for your hot tub's GFCI. The disconnecting means must be readily accessible to the spa's occupant but installed at least 5 feet (1.5 m) from the spa water. Check with local municipalities for additional code requirements.

6. GFCI wiring diagram

This diagram shows a "Three Wire Plus Ground" installation. It has a load Neutral connection, commonly required for hot tubs containing both 120 and 240 volt equipment. They need the load neutral connection to produce the 120 volt.

Siemens GFCI Breaker Box

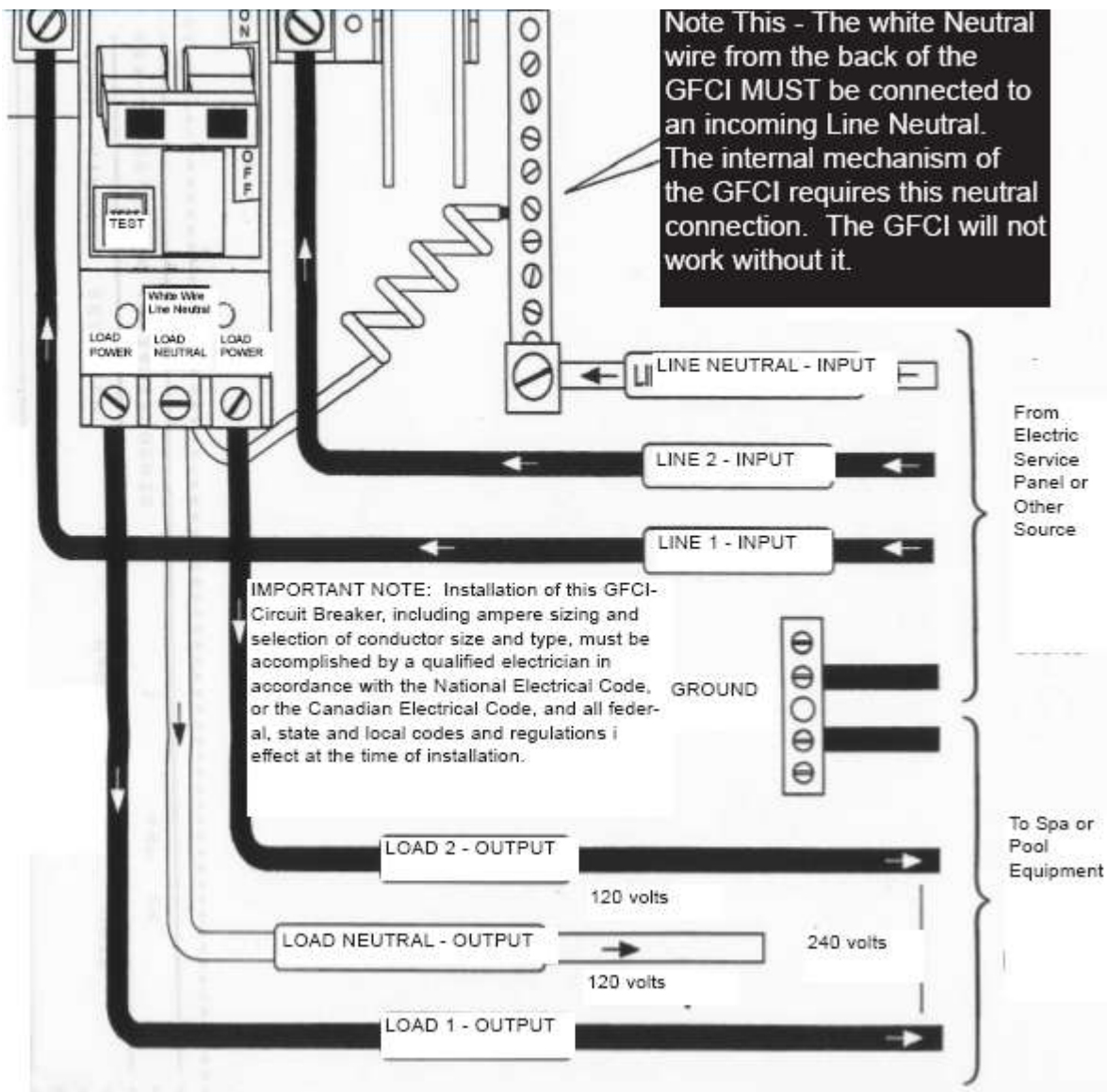

7. Electrical installation of hot tub after delivery (for use by licensed electricians only)

Important Safety notice for all models!

Proper grounding is extremely important. Homeowner should not wire 240 volt spas. Improper wiring will void spa pack warranty.

1. To gain access to the hot tub's control box, remove the cabinet panel on the front of the hot tub, under its topside control. After removing the cabinet panel, remove the two control box cover screws and cover.
2. Select the power wire inlet through the hot tub cabinet you want to use. (Either drill a hole through the cabinet or run wire in conduit through the base of the hot tub.) Then feed the power cable through it to the left side of the control box.
3. Install power cable through the 1 ³/₈" circular hole on the left-side of the control box.
4. Connect wires, color to color, into the terminal openings and tighten securely.
5. Secure the control box door by installing its screws, and then reinstall the cabinet panel under the topside control. Electrical installation is now complete.

8. Wiring placement underneath hot tub

HOT TUB WIRING PLACEMENT through base of hot tub

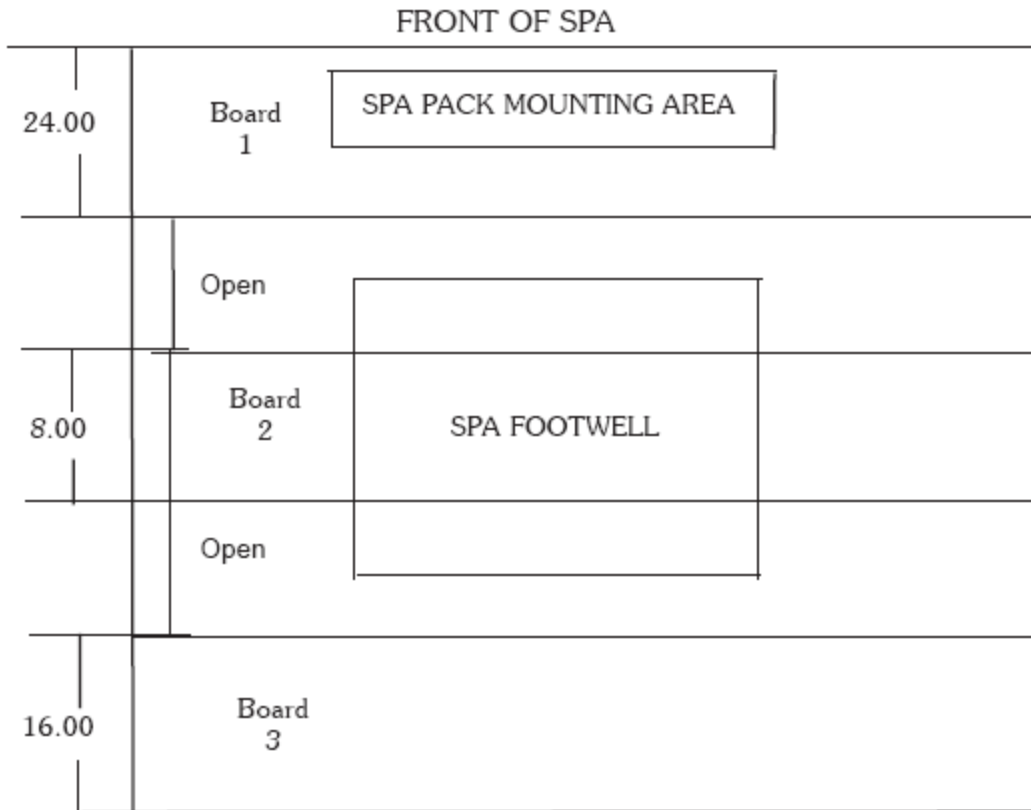

THIS VIEW IS THE BOTTOM SIDE OF THE HOT TUB.

NOTES

BOARD 1

Will always be 24" wide from the front of the hot tub.

BOARD 2

Will always be 8" wide centered on the center of the hot tub.

BOARD 3

Will always be 16" wide from the back side of the hot tub.

Do not put wires up through the footwell or hot tub pack area.

9. Wiring schematic

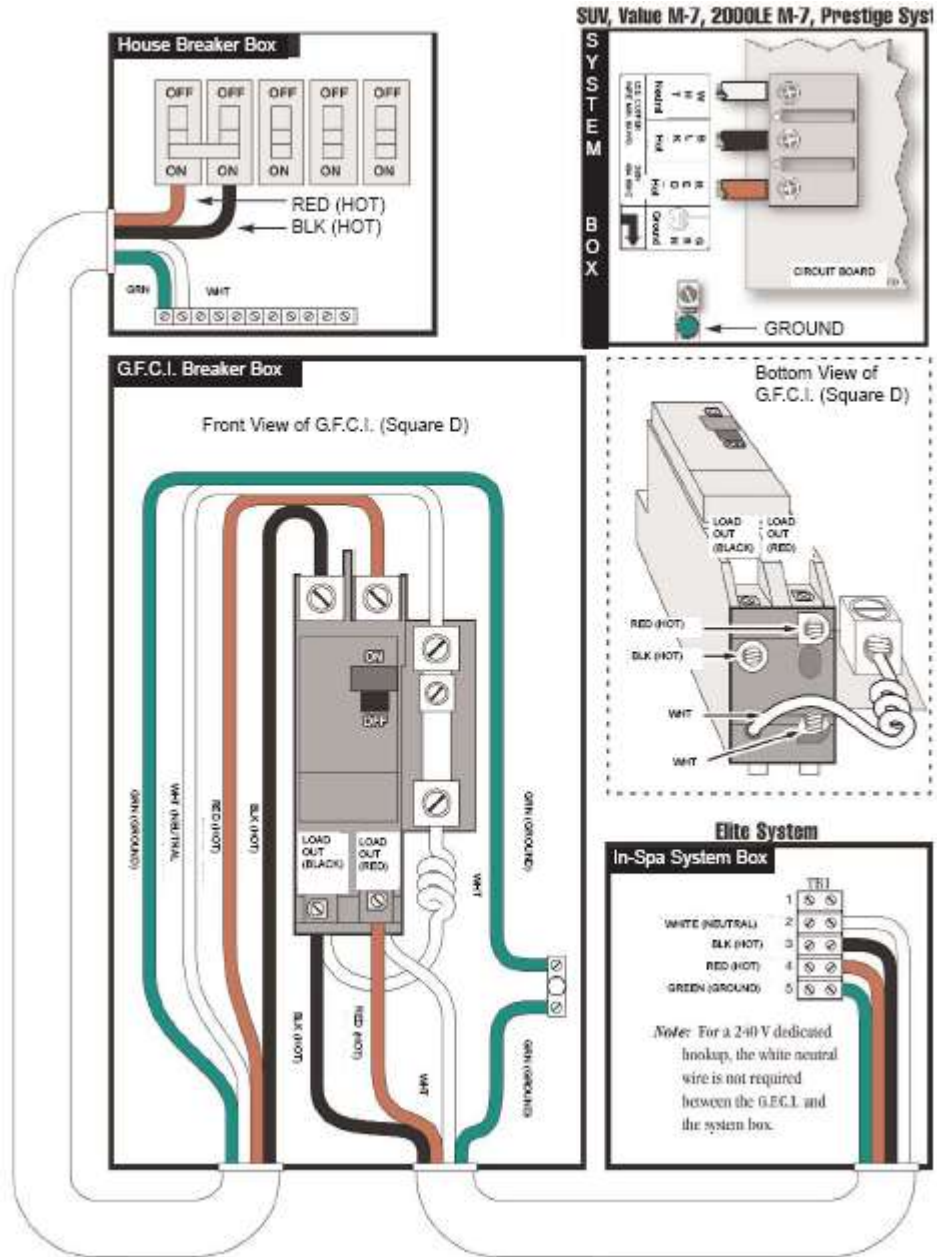

10. Hot tub model specifications

Name	Model #	Internet Catalog #	Description	Outside Dimensions	Gallons	Weight (in pounds)		Power (voltage/amp)
						Dry	Filled	
Capri	100AB	100632869	2 Person, 8 Jet Spa including Lockable Cover, 3/4 HP Pump	91"l x 42"w x 29"d	190	214	1734	120v / 15amp
Riviera	130SM	202059731	Riveria Silver Marble 3 Person 12 Jet Plug N' Play Spa with Lockable Flex Cover. Plugs into any 120 Volt/ 15 Amp Outlet	88"l x 50"w x 29.5"d	275	300	2500	120v / 15amp
Malta	175BD	100633057	Blue Denim 4 Person 10 Jet Spa including Lockable Cover	80.5"l x 56.5"w x 30"d	240	309	2229	120v / 15amp
Gibraltar	270BD	100662601	Blue Denim 6 Person 30 Jet Lounger Spa	82"l x 79"w x 36"d	400	563	3563	240v / 50amp
Gibraltar	270SM	100662602	Silver Marble 6 Person 30 Jet Lounger Spa	82"l x 79"w x 36"d	400	563	3563	240v / 50amp
Cypress	390SM	100657735	Cypress Silver Marble 8 Person 40 Jet Spa with 4 HP Pump, Dura-Frame Cabinet and Insulated, Lockable Hard Cover	82"l x 82"w x 36"d	475	563	4363	240v / 50amp
Cypress	390BD	100633058	Cypress Blue Denim 8 Person 40 Jet Spa with 4 HP Pump, Dura-Frame Cabinet and Insulated, Lockable Hard Cover	82"l x 82"w x 36"d	475	563	4363	240v / 50amp
Crete	390BD	100633062	Blue Denim 8 Person, 40 Jet Spa including WOW Sound Stereo System and Lockable Hard Cover	82"l x 82"w x 36"d	475	563	4363	240v / 50amp
Crete	390SM	100657736	Silver Marble 8 Person, 40 Jet Spa including WOW Sound Stereo System and Lockable Hard Cover	82"l x 82"w x 36"d	475	563	4363	240v / 50amp
Palmero	394SM	202059735	Silver Marble, 7 Person, 47 Jet, Dual Pump Spa With Wrap Around Lounger and Insulated, Lockable Hard Cover	82"l x 82"w x 36"d	475	570	4363	240v / 50amp
Palmero	394BD	202059733	Blue Denim, 7 Person, 47 Jet, Dual Pump Spa With Wrap Around Lounger and Insulated, Lockable Hard Cover	82"l x 82"w x 36"d	475	570	4363	240v / 50amp
Corsica	395BD	100633059	Blue Denim 8 Person, 60 Jet, 2 Pump Spa including WOW Sound Stereo System and LED Light	82"l x 82"w x 36"d	475	563	4363	240v / 50amp

Name	Model #	Internet Catalog #	Description	Outside Dimensions	Gallons	Weight (in pounds)		Power (voltage/amp)
						Dry	Filled	
Corsica	395WM	100657733	White Marble 8 Person, 60 Jet, 2 Pump Spa including WOW Sound Stereo System and LED Light	82"l x 82"w x 36"d	475	563	4363	240v / 50amp
Valencia	396BD	202059739	Valencia Blue Denim 8 Person, 70 Jet, Dual Pump, Non-Lounging Spa with Pulse Massage, LED Light and Waterfall	87"l x 87"w x 36"d	550	681	5081	240v / 50amp
Valencia	396SM	202059737	Valencia Silver Marble 8 Person, 70 Jet, Dual Pump, Non-Lounging Spa with Pulse Massage, LED Light and Waterfall	87"l x 87"w x 36"d	550	681	5081	240v / 50amp
Monaco	397BD	202059743	Monaco Blue Denim 8 Person, 70 Jet, Dual Pump, Non-Lounging Spa with Pulse Massage, LED Light, Waterfall and Stereo	87"l x 87"w x 36"d	550	681	5081	240v / 50amp
Monaco	397SM	202059743	Monaco Silver Marble 8 Person, 70 Jet, Dual Pump, Non-Lounging Spa with Pulse Massage, LED Light, Waterfall and Stereo	87"l x 87"w x 36"d	550	681	5081	240v / 50amp
Venice	370BD	100633061	Blue Denim 8 Person, 90 Jet, 3 Pump Spa	87"l x 87"w x 36"d	550	681	5081	240v / 50amp
Venice	370WM	100657734	White Sierra 8 Person, 90 Jet, 3 Pump Spa	87"l x 87"w x 36"d	550	681	5081	240v / 50amp
Morocco	370BD	100633060	Blue Denim 8 Person, 90 Jet 3 Pump Spa Includes WOW Sound Stereo System	87"l x 87"w x 36"d	550	681	5081	240v / 50amp
Morocco	370WM	100657732	White Marble 8 Person, 90 Jet, 3 Pump Spa Includes WOW Sound Stereo System	87"l x 87"w x 36"d	550	681	5081	240v / 50amp

SpaPreDeliveryGuide March 2010